

KOBANOICA KOBANOICA-XXX

KOBANOICA 7-inch Wireless CarPlay and Android Auto Screen User Manual

Model: KOBANOICA-XXX

Brand: KOBANOICA

[Introduction](#) [Package Contents](#) [Setup & Installation](#) [Operation](#) [Maintenance](#) [Troubleshooting](#) [Specifications](#) [Warranty & Support](#)

1. INTRODUCTION

Thank you for choosing the KOBANOICA 7-inch Wireless CarPlay and Android Auto Screen. This portable car display is designed to enhance your driving experience by integrating smartphone functionalities such as navigation, music, and communication directly into your vehicle's dashboard. It supports wireless Apple CarPlay and Android Auto, Mirror Link, voice control, and multiple audio output options.

Please read this manual thoroughly before use to ensure proper installation and operation. Keep this manual for future reference.

2. PACKAGE CONTENTS

Verify that all items listed below are included in your package. If any items are missing or damaged, please contact customer support.

- CarPlay Screen
- Power Cable
- AUX Cable
- Suction Mount Bracket
- Self-adhesive Bracket
- User Manual

Package includes

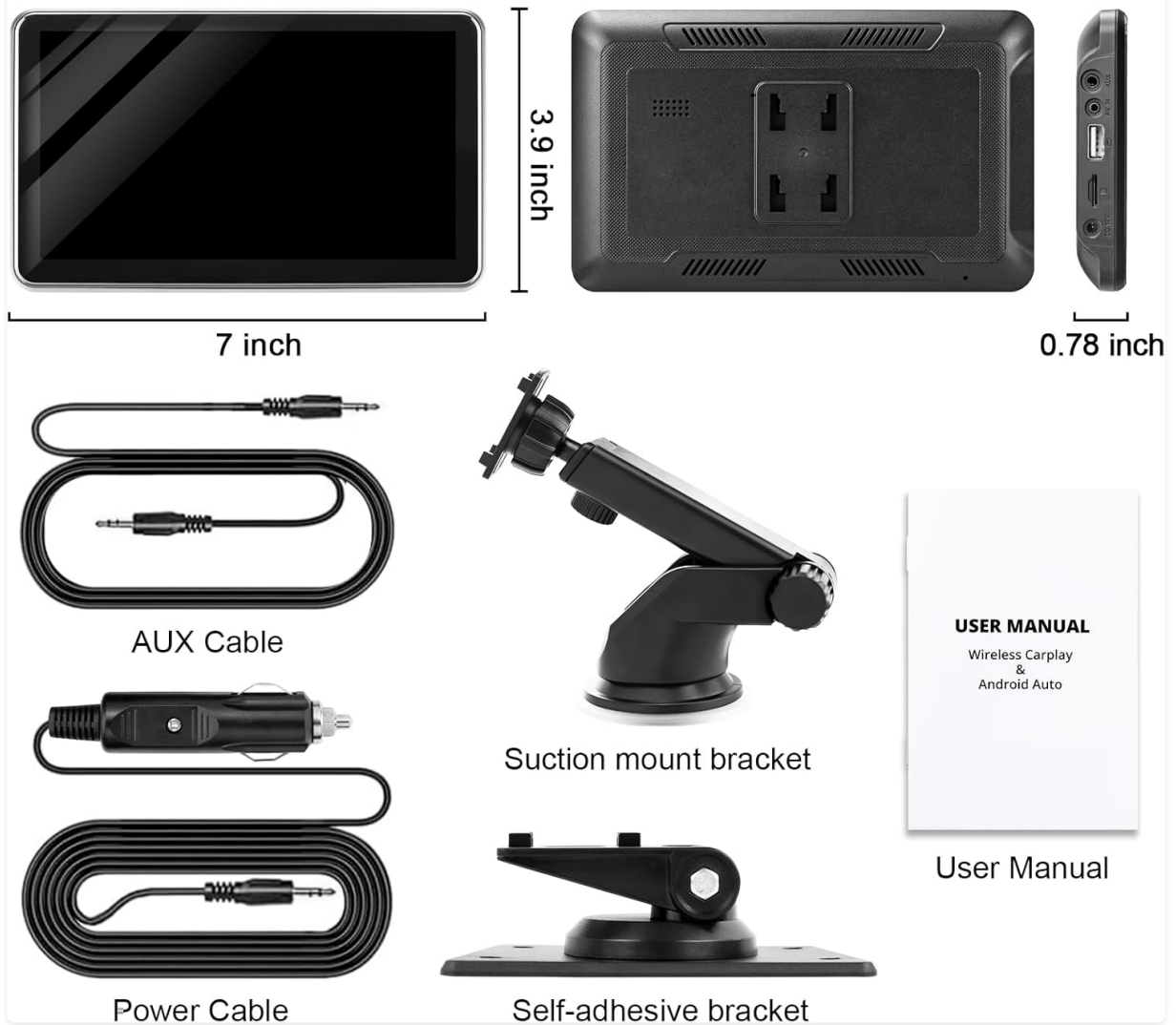

Figure 2.1: Package Contents

3. SETUP & INSTALLATION

3.1 Mounting the Device

The KOBANOICA screen offers two mounting options: a suction cup mount for windshields or smooth dashboards, and a self-adhesive bracket for dashboard consoles.

- 1. Choose a Location:** Select a position on your dashboard or windshield that does not obstruct your view or interfere with airbags. Ensure the surface is clean and dry.
- 2. Attach the Bracket:**
 - **Suction Mount:** Press the suction cup firmly onto the chosen surface and engage the lever to secure it. The mount is 360-degree rotatable for optimal viewing angles.
 - **Self-adhesive Bracket:** Peel off the protective film from the adhesive base and firmly press it onto the dashboard for at least 30 seconds. Allow the adhesive to cure for a few hours before attaching the screen.
- 3. Attach the Screen:** Slide the CarPlay screen onto the chosen bracket until it clicks securely into place.



Figure 3.1: Mounting Options and Installation

3.2 Power Connection

1. Insert the small end of the provided power cable into the DC IN port on the side of the CarPlay screen.
2. Plug the cigarette lighter adapter end of the power cable into your vehicle's 12V-24V power outlet.
3. The screen will power on automatically.

4. OPERATION

4.1 Wireless Apple CarPlay Connection

1. On the CarPlay screen, navigate to the Apple CarPlay icon and tap it.
2. On your iPhone, turn on Wi-Fi and Bluetooth.
3. Go to your iPhone's Bluetooth settings, find the CarPlay screen's Bluetooth name (e.g., "CarPlay-XXXX"), and tap to connect.
4. Confirm the pairing code displayed on both devices.
5. A prompt will appear on your iPhone asking to "Use CarPlay". Tap "Use CarPlay".

- Wait for a moment; your iPhone will connect wirelessly, and the CarPlay interface will appear on the screen.

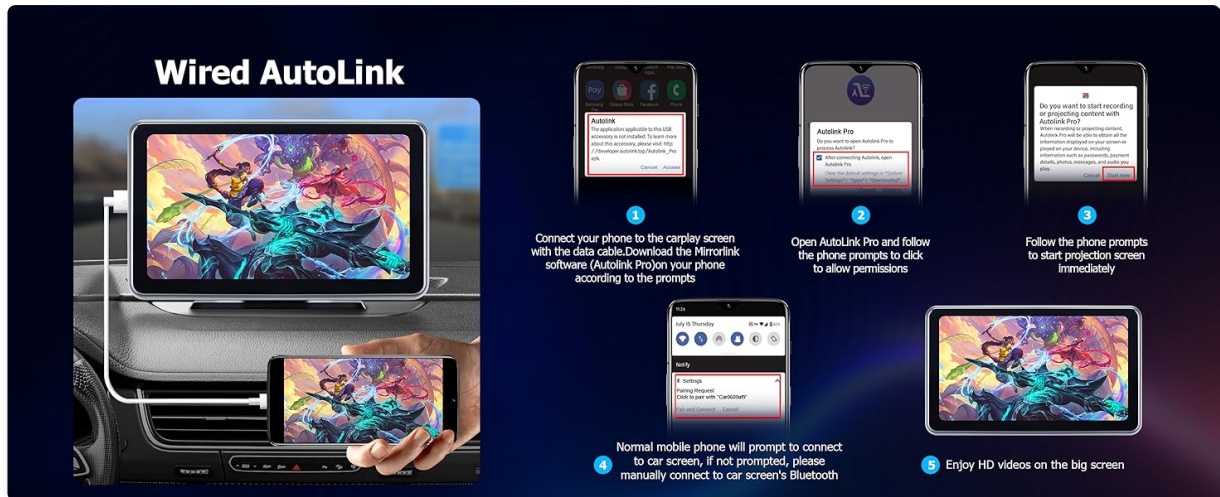

Figure 4.1: Wireless Apple CarPlay Connection Steps

4.2 Wireless Android Auto Connection

- On the CarPlay screen, navigate to the Android Auto icon and tap it.
- On your Android phone, turn on Wi-Fi and Bluetooth.
- Go to your Android phone's Bluetooth settings, find the CarPlay screen's Bluetooth name, and tap to connect.
- Confirm the pairing code displayed on both devices.
- Wait for a moment; your Android phone will connect wirelessly, and the Android Auto interface will appear on the screen.



Figure 4.2: Wireless Android Auto Connection Steps

4.3 Mirror Link Functionality

The Mirror Link function allows you to display your smartphone's screen directly onto the CarPlay screen. This is useful for viewing videos or other content.

4.3.1 iOS Mirror Link (Wireless AirPlay)

- On the CarPlay screen, select the iOS Mirror Link option.
- Ensure your iPhone's Wi-Fi is on and connected to the CarPlay screen's Wi-Fi network (if prompted). Bluetooth should be off for this function.

3. On your iPhone, open Control Center and tap "Screen Mirroring".
4. Select the CarPlay screen's name (e.g., "8369u-AirPlay") from the list.
5. Your iPhone screen will now be mirrored on the CarPlay display.

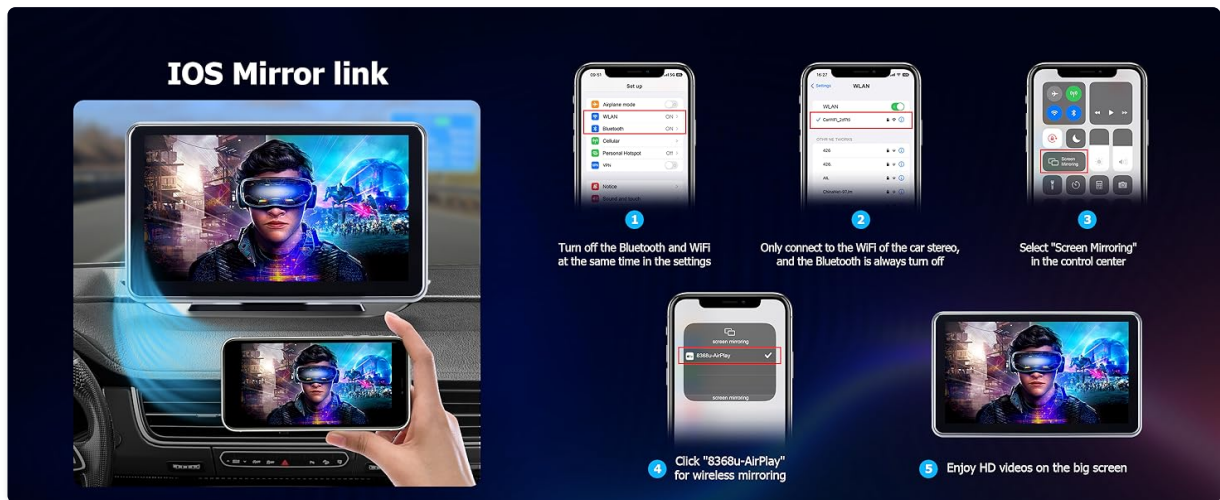

Figure 4.3: iOS Mirror Link Connection Steps

4.3.2 Android AutoLink (Wired)

1. On the CarPlay screen, select the Android AutoLink option.
2. Connect your Android phone to the CarPlay screen using a USB data cable.
3. Download and install the "AutoLink Pro" application on your Android phone if prompted.
4. Open "AutoLink Pro" and grant necessary permissions.
5. Your Android phone screen will now be mirrored on the CarPlay display.

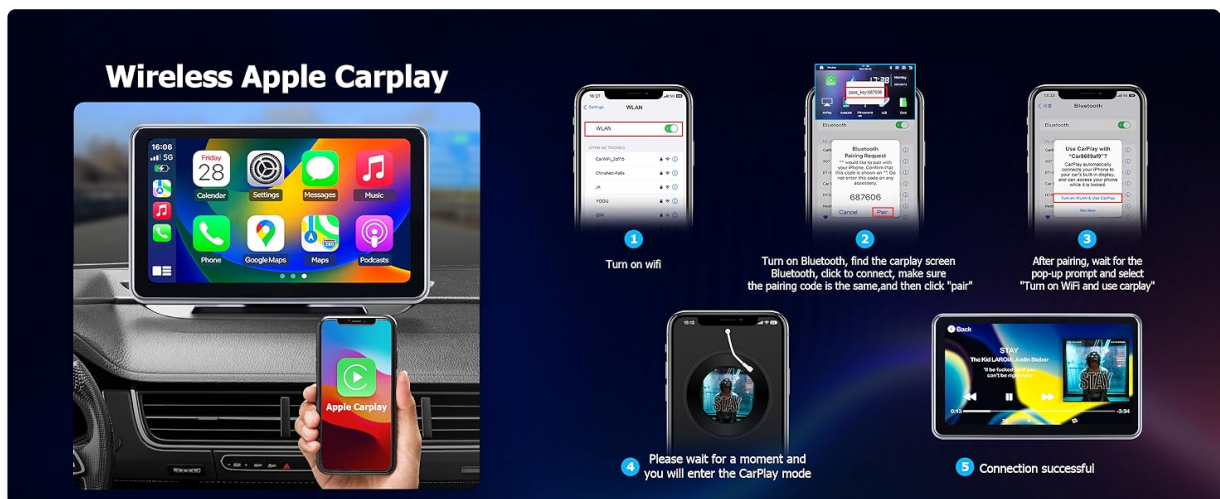

Figure 4.4: Wired Android AutoLink Connection Steps

4.4 Audio Output Options

The device offers several ways to output audio to your car's sound system:

- **Built-in Speaker:** The screen has an integrated speaker for direct audio output.
- **Bluetooth Audio:** Connect your phone to the CarPlay screen via Bluetooth. The screen can then transmit audio wirelessly to your car's Bluetooth-enabled stereo system for a lossless experience.
- **FM Transmitter:** Select an unused FM frequency on the CarPlay screen and tune your car's radio to the same frequency. Audio will be transmitted wirelessly to your car speakers. Experiment with different frequencies for optimal clarity.

- **AUX Cable:** Connect the provided 3.5mm AUX cable from the CarPlay screen's AUX output to your car's AUX input jack. Select AUX input on your car stereo.



Figure 4.5: Multiple Audio Output Methods

4.5 Voice Control (Siri/Google Assistant)

Once connected via CarPlay or Android Auto, you can use voice commands for hands-free operation.

- Activate Siri (for Apple CarPlay) or Google Assistant (for Android Auto) by saying "Hey Siri" or "Hey Google", or by tapping the voice assistant icon on the screen.
- Issue commands such as:
 - "Play music"
 - "Navigate to [address/destination]"
 - "Call [contact name]"
 - "Send a message to [contact name]"
 - "What's the weather like?"

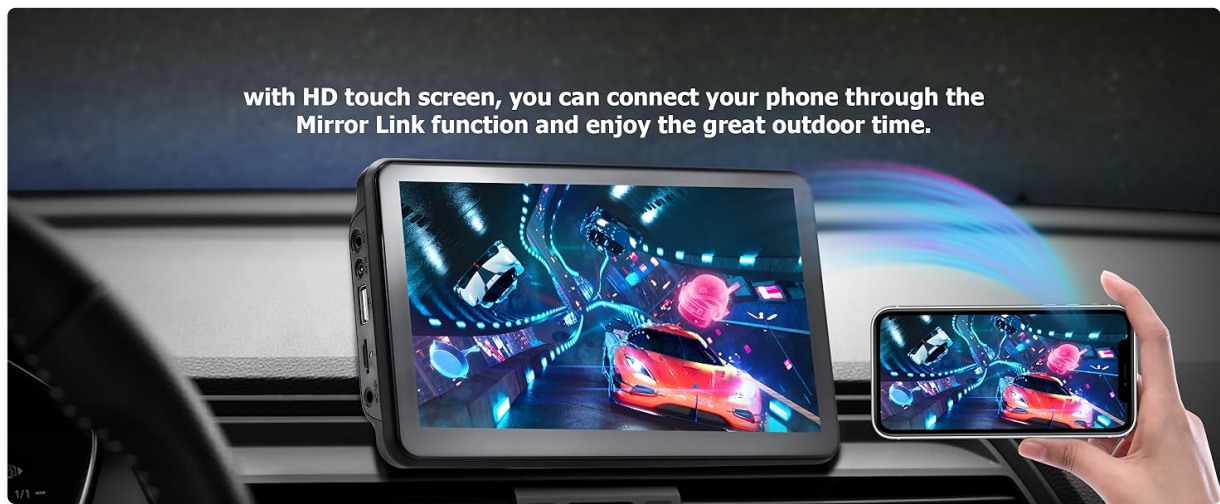

Figure 4.6: Voice Control Features

4.6 Navigation

Utilize your smartphone's navigation apps (e.g., Apple Maps, Google Maps, Waze) directly on the CarPlay screen for real-time directions and traffic updates.

- Access your preferred navigation app from the CarPlay or Android Auto interface.
- Enter your destination using the touchscreen or voice commands.
- Follow the on-screen directions and audio prompts.

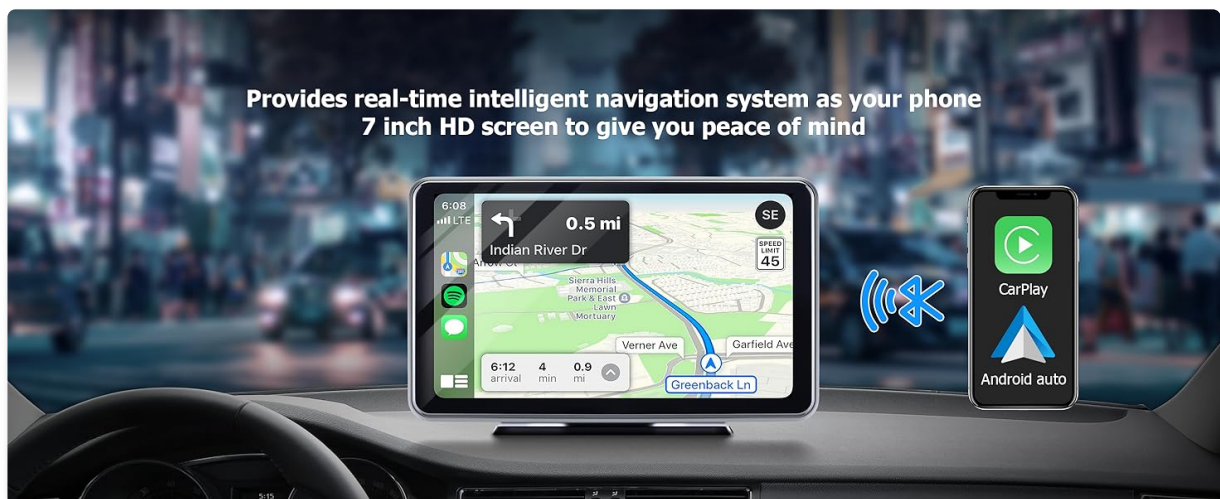

Figure 4.7: Navigation Display

5. MAINTENANCE

- **Cleaning:** Use a soft, dry, lint-free cloth to clean the screen. For stubborn smudges, lightly dampen the cloth with water or a screen-safe cleaner. Avoid abrasive materials or harsh chemicals.
- **Temperature:** Avoid exposing the device to extreme temperatures (hot or cold) for extended periods, as this can affect its performance and lifespan.
- **Storage:** If storing the device for a long time, disconnect it from power and store it in a cool, dry place.
- **Cable Care:** Handle all cables gently. Avoid sharp bends or excessive pulling to prevent damage.

6. TROUBLESHOOTING

Problem	Possible Cause	Solution
Device does not power on.	No power connection; faulty power cable/outlet.	Ensure the power cable is securely plugged into both the screen and the car's 12V-24V outlet. Check if the car outlet is functional.
Wireless CarPlay/Android Auto fails to connect.	Bluetooth/Wi-Fi issues; incorrect pairing; phone settings.	<ul style="list-style-type: none"> • Ensure Bluetooth and Wi-Fi are enabled on your smartphone. • Forget the device in your phone's Bluetooth settings and try pairing again. • Restart both the CarPlay screen and your smartphone. • Ensure the CarPlay screen is selected in your phone's CarPlay/Android Auto settings.
No audio or poor audio quality.	Incorrect audio output setting; FM interference; loose AUX cable.	<ul style="list-style-type: none"> • Check the selected audio output method on the CarPlay screen (Built-in, Bluetooth, FM, AUX). • If using FM, try a different, clear FM frequency. • If using AUX, ensure the cable is fully inserted into both the screen and car's AUX port. • Adjust volume levels on both the screen and your car stereo.
Mirror Link not working.	Incorrect connection type (wired/wireless); app not installed (Android); Wi-Fi/Bluetooth conflicts.	<ul style="list-style-type: none"> • For iOS AirPlay, ensure Bluetooth is OFF on your iPhone and Wi-Fi is connected to the screen. • For Android AutoLink, ensure the "AutoLink Pro" app is installed and permissions are granted, and use a reliable USB data cable. • Restart both devices.
Mounting bracket does not hold securely.	Surface not clean/smooth; adhesive worn out; extreme heat.	<ul style="list-style-type: none"> • Clean the mounting surface thoroughly before attachment. • For suction mounts, ensure the lever is fully engaged. • For adhesive mounts, ensure sufficient curing time and consider replacing the adhesive if it loses stickiness. Avoid direct prolonged sunlight in hot climates.

7. SPECIFICATIONS

Feature	Detail
Brand	KOBANOICA

Feature	Detail
Model Number	KOBANOICA-XXX
Screen Size	7 inches
Connectivity Technology	Wireless (Bluetooth, Wi-Fi)
Special Features	Apple CarPlay, Android Auto, Mirror Link, Voice Control (Siri/Google Assistant), FM Transmitter
Compatible Devices	Smartphones (iOS and Android)
Power Input	12V-24V (Vehicle cigarette lighter)
Audio Output Mode	Stereo
Connector Type	3.5mm Jack (AUX)
Item Weight	9.6 ounces (approx. 0.6 lbs)
Package Dimensions	8.62 x 5.35 x 3.82 inches

8. WARRANTY AND SUPPORT

KOBANOICA products are designed and manufactured to the highest quality standards. For information regarding warranty coverage, please refer to the warranty card included in your package or visit the official KOBANOICA website.

If you encounter any issues or have questions about your product, please contact KOBANOICA customer support. Details for contacting support can typically be found on the product packaging, the official website, or through your purchase platform.

Please have your model number (KOBANOICA-XXX) and purchase date ready when contacting support.