

Manuals+

[Q & A](#) | [Deep Search](#) | [Upload](#)

manuals.plus /

- › [Hinkley](#) /
- › [Hinkley Swell Flush Illuminated 56" LED Smart Fan Instruction Manual](#)

Hinkley 903456FBB-LDD

Hinkley Swell Flush Illuminated 56" LED Smart Fan

MODEL: 903456FBB-LDD

User Instruction Manual

1. Safety Information

Read all instructions carefully before beginning installation. Failure to follow these instructions may result in electric shock, fire, or serious personal injury. This product must be installed in accordance with the applicable installation code by a person familiar with the construction and operation of the product and the hazards involved.

- Always disconnect power at the circuit breaker before installation or servicing.
- Ensure all electrical connections are secure and comply with local codes and ordinances.
- The fan is damp rated, suitable for indoor and covered outdoor use. Do not expose to direct water spray.
- Mount the fan to a ceiling joist or a securely anchored outlet box capable of supporting the fan's weight.

2. Package Contents

Verify that all components listed below are present before beginning installation. If any parts are missing or damaged, contact Hinkley customer support.



SUMMER MODE

PUSHES AIR DOWN FROM THE CEILING
TO CREATE A COOLING EFFECT



WINTER MODE (REVERSE)

PULLS AIR UP AND REDISTRIBUTES
WARM AIR HOVERING AROUND THE CEILING

Figure 2.1: Included components for the Hinkley Swell Smart Fan.

- Ceiling Canopy
- Hanger Bracket
- Mounting Hardware
- Fan Blades (3)
- Fan Housing + Motor
- Light Kit Cover
- Light Kit
- HIRO Remote Control
- Wall Control Components (Face Plate Bracket, Decorative Face Plate, Wall Cradle, Switch Cradle)
- Balance Kit
- Ball Moisture Cap
- Installation Instructions



CHOOSING THE RIGHT FAN SIZE	
SIZE OF ROOM	BLADE SWEEP
<100 SQ. FT.	 36-44"
100-150 SQ. FT.	 52-56"
>150 SQ. FT.	 60-72"

Figure 2.2: Exploded view of Hinkley Swell Smart Fan components.

3. Setup and Installation

Professional installation is recommended. Ensure power is OFF at the circuit breaker before proceeding.

3.1. Pre-Installation Considerations

- **Room Size:** For optimal performance, select the appropriate fan size for your room. This 56-inch fan is generally suitable for rooms between 100-150 sq. ft.
- **Mounting Location:** The fan must be mounted to a structurally sound ceiling joist or an approved outlet box.

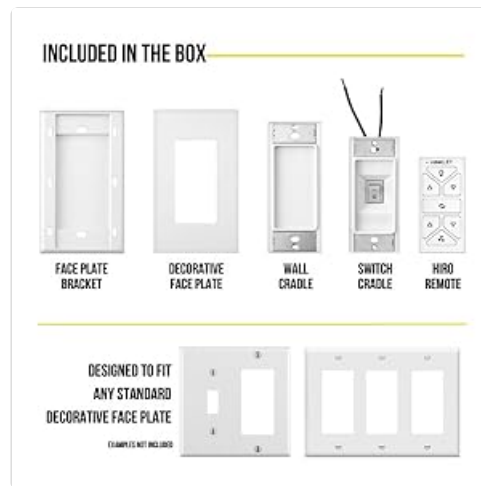

Figure 3.1: Guide for choosing the correct fan size based on room area.

3.2. Mounting the Hanger Bracket

1. Secure the hanger bracket to the ceiling outlet box using the provided mounting hardware. Ensure the bracket is firmly attached and can support the fan's weight.
2. For outdoor or damp locations, ensure the ball moisture cap is correctly installed to protect electrical components.

3.3. Wiring Connections

1. Connect the fan's electrical wires to the household wiring according to the wiring diagram in the full installation manual.
2. Ensure all wire nuts are securely fastened.

3.4. Assembling the Fan

1. Attach the fan blades to the motor housing.
2. Install the integrated LED light kit and its cover.
3. Carefully lift the fan assembly and hang it onto the hanger bracket.
4. Secure the ceiling canopy to cover the wiring and mounting hardware.

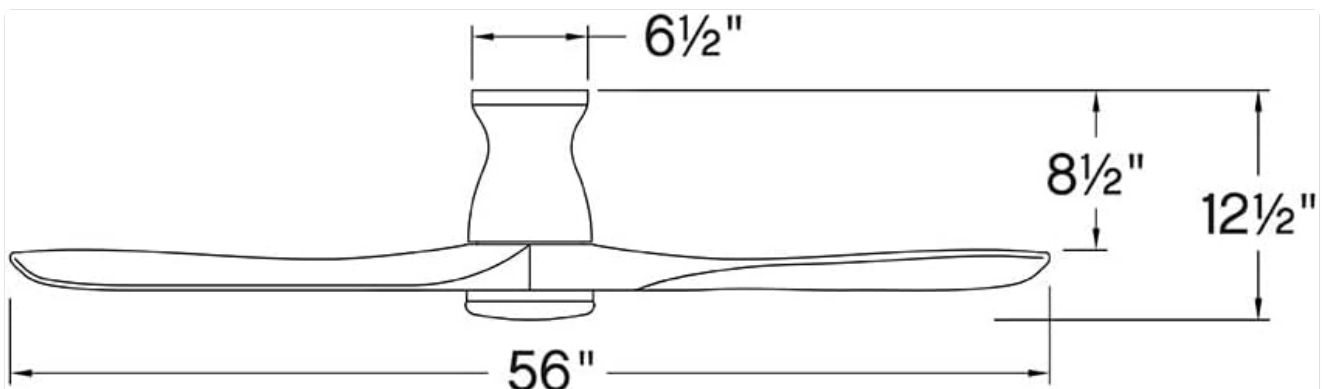

Figure 3.2: Product dimensions for installation planning.

4. Operating Instructions

The Hinkley Swell Smart Fan offers multiple control options for convenience.

4.1. HIRO Remote Control

The included HIRO remote allows for direct control of fan speed, light, and direction.



Figure 4.1: HIRO Remote Control functions.

- **Fan On/Off:** Press the fan icon button to turn the fan on or off.
- **Fan Speed:** Use the 'up' and 'down' arrow buttons below the fan icon to adjust between 6 speeds.
- **Light On/Off:** Press the light bulb icon button to toggle the integrated LED light.
- **Light Dimming:** Use the 'up' and 'down' arrow buttons below the light icon to adjust brightness.
- **Reverse Fan Direction:** Press the circular arrow button to change the blade rotation direction.

4.2. Smart Home Integration (Wi-Fi, App, Voice Control)

The Hinkley Swell Smart Fan is Wi-Fi compatible, allowing integration with smart home systems for advanced control.



Figure 4.2: HIRO Smart Home features for the fan.

- Download the Hinkley smart app (refer to the full installation manual for app details and setup).
- Follow the in-app instructions to connect your fan to your home Wi-Fi network.
- Once connected, you can control the fan via the app, set schedules, and integrate with compatible voice assistants.

4.3. Seasonal Operation (Summer/Winter Modes)

Adjust the fan's direction to optimize air circulation for different seasons.

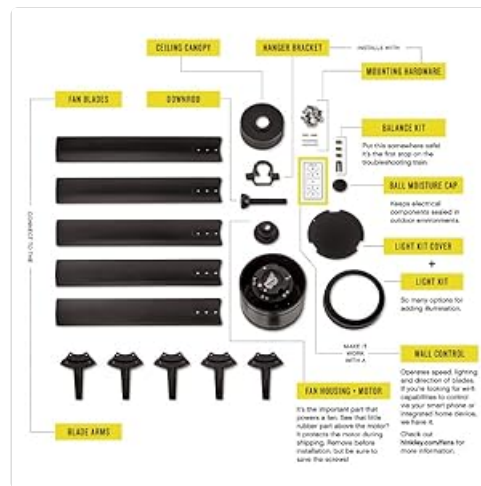

Figure 4.3: Understanding Summer and Winter fan modes.

- **Summer Mode:** Blades rotate counter-clockwise, pushing air downwards to create a cooling breeze.
- **Winter Mode (Reverse):** Blades rotate clockwise, pulling air upwards to redistribute warm air trapped near the ceiling.

Video 4.1: This video from Hinkley Store provides an overview of various fan styles and features, which may offer visual context for fan operation and selection.

5. Maintenance

Regular maintenance ensures optimal performance and longevity of your Hinkley Swell Smart Fan.

- **Cleaning:** Dust the fan blades and motor housing periodically with a soft, damp cloth. Do not use abrasive cleaners or solvents.
- **Blade Balance:** If the fan wobbles, use the included balance kit to correct any imbalance. Refer to the full installation manual for detailed balancing instructions.
- **Electrical Connections:** Periodically check all electrical connections for tightness. Ensure power is disconnected at the circuit breaker before inspection.

6. Troubleshooting

If you encounter issues with your fan, refer to the following common troubleshooting steps. For more complex problems, consult the full installation manual or contact customer support.

- **Fan Does Not Operate:** Check that the circuit breaker is on and the wall switch (if applicable) is in the 'on' position. Ensure all wiring connections are secure.
- **Light Does Not Work:** Verify the light switch on the remote or wall control is on. Check wiring connections to the light kit.
- **Excessive Wobbling:** Ensure all blade screws are tightened. Use the provided balance kit to correct any blade imbalance. Confirm the hanger bracket is securely mounted.
- **Remote Control Not Responding:** Check the battery in the remote control. Ensure the fan's receiver is not obstructed.

- **Smart Features Not Connecting:** Verify your Wi-Fi network is active and the fan is within range. Re-attempt the pairing process via the Hinkley smart app.

7. Specifications

Brand	Hinkley
Model Name	Swell Flush Illuminated 56" LED Smart Fan
Model Number	903456FBB-LDD
Color	Matte Black with Black Blades
Product Dimensions	56"D x 56"W x 12.75"H
Item Weight	28.6 Pounds
Number of Blades	3
Blade Length	24.76 Inches
Motor Type	DC (6-speed)
Light Source	Integrated 16W LED
Light Output	1320 lumens at 3000K
Air Flow Capacity	4946 Cubic Feet Per Minute
Voltage	120 Volts
Power Source	Corded Electric
Control Method	App, Remote, Voice
Indoor/Outdoor Usage	Indoor, Outdoor (Damp Rated)
Special Feature	Dimmable, Hardwired, Integrated, Smart Fan
UPC	640665025958

8. Warranty and Support

For warranty information, please refer to the documentation included with your purchase or visit the official Hinkley website. For technical support, replacement parts, or further assistance, please contact Hinkley customer service directly.

Hinkley Customer Service: Refer to your product packaging or the Hinkley website for current contact information.

