

VTech ES2050

VTech ES2050 DECT Cordless Phone User Manual

Model: ES2050

1. PRODUCT OVERVIEW

The VTech ES2050 is a DECT cordless phone designed for home and office use, featuring an integrated digital answering machine, call blocking capabilities, and enhanced audio functions. This manual provides detailed instructions for setting up, operating, and maintaining your phone.



The VTech ES2050 DECT Cordless Phone with its base unit, showcasing the handset's backlit display and keypad, and the base unit's answering machine controls.

vtech®



DECT Cordless Phone with Call Blocker

ES2050

The VTech ES2050 DECT Cordless Phone positioned in a contemporary living space, highlighting its sleek design and integration into a home environment.

Call Blocker



*Nuisance and
unwanted call
blocker**

*Save up to 100 names and numbers in the call blocklist to stop
unwanted calls from ringing through.*

Illustration of the VTech ES2050's Nuisance Call Blocker feature, showing how it helps prevent unwanted calls from ringing through. Up to 100 numbers can be blacklisted.

Digital Answering System

“

Hey, Millie. Don't forget our meeting.

”



With up to 30 minutes of recording time, the digital answering system grabs calls when you can't.

The VTech ES2050's Digital Answering System, capable of recording up to 30 minutes of messages, with a digital message counter on the base unit.

Easy, One-touch Features



Mute/Alarm



Adjustable
ring volume and melodies



High quality
handsfree speakerphone

Depiction of the VTech ES2050's easy one-touch features, including Mute/Alarm, adjustable ring volume and melodies, and a high-quality handsfree speakerphone.

Volume Booster



Amplifies incoming sounds to enhance the clarity and loudness.

Visual representation of the VTech ES2050's Volume Booster function, which amplifies incoming sounds for enhanced clarity and loudness, beneficial for hearing-impaired users.

Backlit Display and Keypad



The entire LCD and keypad illuminates, allowing for easier viewing in dim light.

The VTech ES2050 handset with its backlit display and keypad illuminated, demonstrating improved visibility in low-light conditions.



100 name and number phonebook



**Calling numbers displayed with
20 number calls lists**



10 last number redial



**Up to 18 hours talk time /
250 hours standby time**

A composite image illustrating key features: 100 name and number phonebook, calling numbers displayed with 20 call list records, 10 last number redial, and up to 18 hours talk time / 250 hours standby time.

Key Features



High quality handsfree speakerphone on handset



5 polyphonic and 5 simple handset ring melodies



*Nuisance and unwanted call blocker**



Adjustable ring volume and melodies



Dot matrix plus segment display



Alarm function



Display and keypad backlight



Mute function



Volume booster function



Keypad lock



100 name and number phonebook



Up to 18 hours talk time/ 250 hours standby time



*Calling numbers displayed with 20 number calls list**



Operating range up to 300m (outdoor)/ 50m (indoors)



10 last number redial



Digital message counter

*This feature will only work if the user subscribes to a caller display service from the network provider, which may be chargeable.

An infographic summarizing the VTech ES2050's key features, including speakerphone, call blocker, polyphonic ringtones, alarm, mute, keypad lock, volume booster, phonebook, call list, redial, talk time, operating range, and digital message counter.

Key Features:

- **Digital Answering Machine:** 30 minutes recording time.
- **Nuisance Call Blocker:** Block up to 100 blacklisted numbers.
- **Volume Booster:** Amplifies incoming sounds for enhanced clarity.
- **Long Battery Life:** Up to 18 hours talk time / 250 hours standby time.
- **Backlit Display & Keypad:** Easy viewing in dim light.
- **Handsfree Speakerphone:** High-quality speakerphone on handset.
- **Phonebook:** 100 name and number capacity.
- **Speed Dial:** 3 speed dial numbers.

- **ECO Mode:** For reduced power consumption.
- **Caller ID / Call Waiting:** Stores 20 records.
- **Redial:** 10 last number redial.
- **Alarm Function:** Integrated alarm.
- **Mute Function:** For privacy during calls.
- **Keypad Lock:** Prevents accidental dialing.

2. WHAT'S IN THE BOX

Before you begin, ensure all components are present:

- 1 Base Unit
- 1 Cordless Handset
- 1 Charger (for handset)
- 1 Battery Pack (2 AAA batteries included)
- Telephone Line Cord
- Quick Start Guide (refer to this manual for full details)

3. SETUP GUIDE

3.1. Battery Installation and Charging

1. Locate the battery compartment cover on the back of the handset. Slide it open.
2. Connect the battery pack plug securely into the jack inside the compartment.
3. Place the 2 AAA batteries (included) into the compartment, ensuring correct polarity (+ and -).
4. Replace the battery compartment cover.
5. Place the handset on the base unit or charger. The charging indicator light on the handset should illuminate.
6. Allow the handset to charge for at least 16 hours before initial use to ensure full battery capacity.

3.2. Connecting the Base Unit

1. Connect one end of the telephone line cord to the TEL LINE jack on the back of the base unit.
2. Connect the other end of the telephone line cord to your telephone wall jack.
3. Plug the small end of the power adapter into the POWER jack on the back of the base unit.
4. Plug the large end of the power adapter into a standard electrical outlet.
5. Ensure all cables are securely connected and routed to prevent tripping hazards.

3.3. Initial Setup (Date and Time)

After the handset is charged, you will need to set the date and time. Follow the on-screen prompts on the handset display. If prompted multiple times, ensure each step is confirmed before proceeding.

- Press the **MENU/OK** button.
- Navigate to **Date & Time** using the arrow keys.
- Press **MENU/OK** to select.

- Enter the current date and time using the keypad.
- Press **MENU/OK** to save.

4. OPERATING INSTRUCTIONS

4.1. Making and Receiving Calls

- **To Make a Call:** Pick up the handset or press the **TALK** button. Dial the number.
- **To Receive a Call:** When the phone rings, pick up the handset or press the **TALK** button.
- **To End a Call:** Place the handset back on the base unit/charger or press the **END** button.

4.2. Using the Speakerphone

During a call, press the **SPEAKER** button to activate the handsfree speakerphone. Press it again to switch back to the handset earpiece.

4.3. Digital Answering Machine

- **Playing Messages:** On the base unit, press **PLAY/STOP**.
- **Deleting Messages:** During message playback, press **DELETE** on the base unit.
- **Recording Outgoing Message (OGM):** Refer to the handset menu for OGM recording options.

4.4. Nuisance Call Blocker

This feature allows you to block unwanted calls. You can add numbers to a blacklist.

- **To Block a Number from Call History:** Access the Call History, select the number, and choose the "Block" option.
- **To Manually Add a Number to Blacklist:** Navigate to the Call Blocker menu in the handset settings and add the number.
- The phone can store up to 100 blacklisted numbers.

4.5. Volume Booster

To amplify the incoming sound during a call, press the **BOOST** button (often marked with a speaker icon or "+") on the handset. Press it again to deactivate.

4.6. Phonebook and Speed Dial

- **Adding Contacts:** Access the Phonebook menu, select "Add New Entry", and enter the name and number.
- **Dialing from Phonebook:** Press the **PHONEBOOK** button, scroll to the desired contact, and press **TALK**.
- **Speed Dial:** Assign frequently called numbers to speed dial keys (e.g., 1, 2, 3). Refer to the handset menu for speed dial setup.

4.7. ECO Mode

The phone automatically enters ECO mode when the handset is close to the base unit, reducing power consumption and transmission power. This mode is indicated by an ECO icon on the display.

5. MAINTENANCE

- **Cleaning:** Wipe the phone and base unit with a soft, damp cloth. Do not use abrasive cleaners or solvents.
- **Battery Care:** For optimal battery life, avoid overcharging by leaving the handset off the charger for extended periods once fully charged. If the phone will not be used for a long time, remove the batteries.
- **Location:** Place the base unit in a central location away from other electronic devices that may cause interference.

6. TROUBLESHOOTING

If you experience issues with your VTech ES2050 phone, try the following solutions:

Problem	Possible Solution
No dial tone / Cannot make or receive calls.	<p>Ensure the telephone line cord is securely connected to both the base unit and the wall jack.</p> <p>Verify the power adapter is plugged into the base unit and a working electrical outlet.</p> <p>Check if the handset battery is charged.</p> <p>Temporarily disconnect the base unit power, wait a few seconds, then reconnect it.</p>
Poor sound quality / Static.	<p>Move the handset closer to the base unit.</p> <p>Ensure the base unit is not near other electronic devices (e.g., Wi-Fi routers, microwaves) that may cause interference.</p> <p>Check the telephone line cord for damage.</p>
Answering machine not recording messages.	<p>Check if the answering machine is turned ON.</p> <p>Ensure there is sufficient recording time available (max 30 minutes).</p> <p>Verify the phone line is active and not in use.</p>
Handset display is blank or unresponsive.	<p>Place the handset on the base unit or charger to ensure it is charging.</p> <p>If the battery is fully charged and the issue persists, try removing and reinserting the battery pack.</p>
Difficulty with menu navigation or settings.	<p>Carefully follow the on-screen prompts and instructions in this manual.</p> <p>If issues persist, a factory reset may be necessary. Consult the VTech support website for specific instructions on resetting your ES2050 to default settings.</p>

7. SPECIFICATIONS

Feature	Detail
Model Number	ES2050
Telephone Type	Cordless DECT
Answering System Type	Digital
Recording Capacity	30 minutes
Phone Talk Time	Up to 18 Hours
Phone Standby Time	Up to 250 Hours

Feature	Detail
Batteries	2 AAA batteries (included)
Power Source	Battery Powered
Dialler Type	Single Keypad
Compatible Devices	Standard Landline Telephone Networks
Colour	Black
Manufacturer	VTech
Country of Origin	China

8. WARRANTY AND SUPPORT

For warranty information and technical support, please refer to the official VTech website or contact VTech customer service. Keep your purchase receipt as proof of purchase.

Manufacturer: VTech

For the most up-to-date support resources, visit the VTech support page or refer to the contact information provided with your product packaging.

Documents - VTech – ES2050

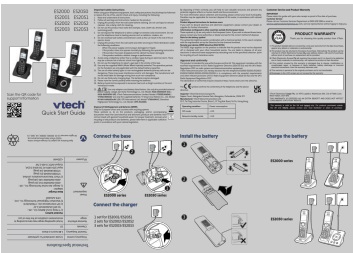

[\[pdf\]](#) Quick Start Guide Instructions Guide
English Product Support Official VTech ES200X ES205X QSG UK v1 20221128 cdn vtech jouets assets dd4f4827 2155 415a 92f2 7b0f82fd4b |||
ES2000 **ES2050** ES2001 ES2051 ES2002 ES2052 ES2003 ES2053 Scan the QR code for support information Quick Start Guide Important safety instructions When using your telephone equipment, basic safety precautions should always be followed to reduce the risk of fire, electric shock and injury, including t...
lang:en **score:25** filesize: 4.96 M page_count: 2 document date: 2022-11-28



[\[pdf\]](#) User Manual Installation Guide Instructions Troubleshooting Guide

English Product Support Official VTech ES200x ES205x UK WEBCIB v1 221214 cdn vtech jouets assets e66f8653 ce2c 4582 b0e0 3171ed492604 |||

ES 2000 2001 2002 2003 ES 2050 2051 2052 2053 Scan the QR code for support information Congratul ... pment. VTech Telecommunication Ltd. hereby declares that this telephone ES2000/ES2001/ES2002/ES2003/**ES2050**/ ES2051/ES2052/ES2053 is in compliance with the essential requirements and other relevant pro...

lang:en score:25 filesize: 17.49 M page_count: 28 document date: 2022-12-14

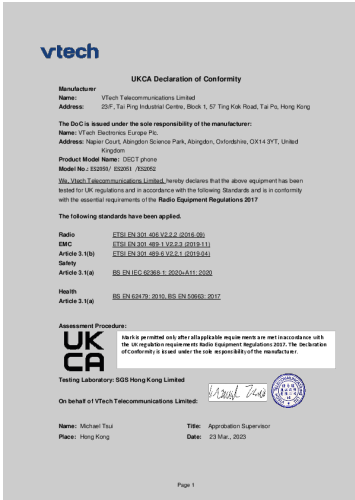

[\[pdf\]](#) Decleration of Conformity

Microsoft Word ES205X Declaration of Conformity docx VTT07806 EnglishProduct Support Official

VTechcdn vtech jouets assets d283785e ecc7 4fc1 af02 1453b3ed1a92 |||

UKCA Declaration of Conformity Manufacturer Name: VTech Telecommunications Limited Address: 23/ ... nce Park, Abingdon, Oxfordshire, OX14 3YT, United Kingdom Product Model Name: DECT phone Model No.: **ES2050**/ ES2051 /ES2052 We, Vtech Telecommunications Limited. hereby declares that the above equipmen...

lang:en score:22 filesize: 114.61 K page_count: 1 document date: 2023-03-24



[\[pdf\]](#) Decleration of Conformity

Microsoft Word ES205X Declaration of Conformity docx VTT07806 English Product Support Official

VTech vtechphones eu assets d283785e ecc7 4fc1 af02 1453b3ed1a92 |||

UKCA Declaration of Conformity Manufacturer Name: VTech Telecommunications Limited Address: 23/ ... nce Park, Abingdon, Oxfordshire, OX14 3YT, United Kingdom Product Model Name: DECT phone Model No.: **ES2050**/ ES2051 /ES2052 We, Vtech Telecommunications Limited. hereby declares that the above equipmen...

lang:en score:21 filesize: 114.61 K page_count: 1 document date: 2023-03-24