

rackchoice N4058

Rackchoice 4U Rackmount Server Chassis User Manual

Model: N4058

INTRODUCTION

This manual provides comprehensive instructions for the installation, operation, and maintenance of your Rackchoice 4U Rackmount Server Chassis. Please read this manual thoroughly before beginning any procedures to ensure proper handling and optimal performance of your server chassis.

The Rackchoice 4U Rackmount Server Chassis is designed for robust server applications, supporting EATX, ATX, Micro ATX, and Mini-ITX motherboards. It features versatile drive bay configurations and efficient cooling solutions, making it suitable for various professional and home lab environments.



Figure 1: Front view of the Rackchoice 4U Rackmount Server Chassis.

SAFETY INFORMATION

Always observe the following safety precautions:

- Ensure the chassis is properly grounded before connecting power.
- Disconnect all power sources before performing any installation or maintenance.
- Avoid placing the chassis in areas with excessive dust, humidity, or extreme temperatures.
- Use appropriate tools and follow anti-static procedures when handling internal components.
- Do not block ventilation openings.

PACKAGE CONTENTS

Verify that all components are present in the package:

- Rackchoice 4U Rackmount Server Chassis (N4058)
- Mounting screw kit
- Power cable (region specific)
- User Manual (this document)
- Optional accessories (if purchased separately)

SETUP AND INSTALLATION

1. Chassis Overview

Familiarize yourself with the chassis components and layout.



Figure 2: Rear view showing expansion slots and fan mounts.

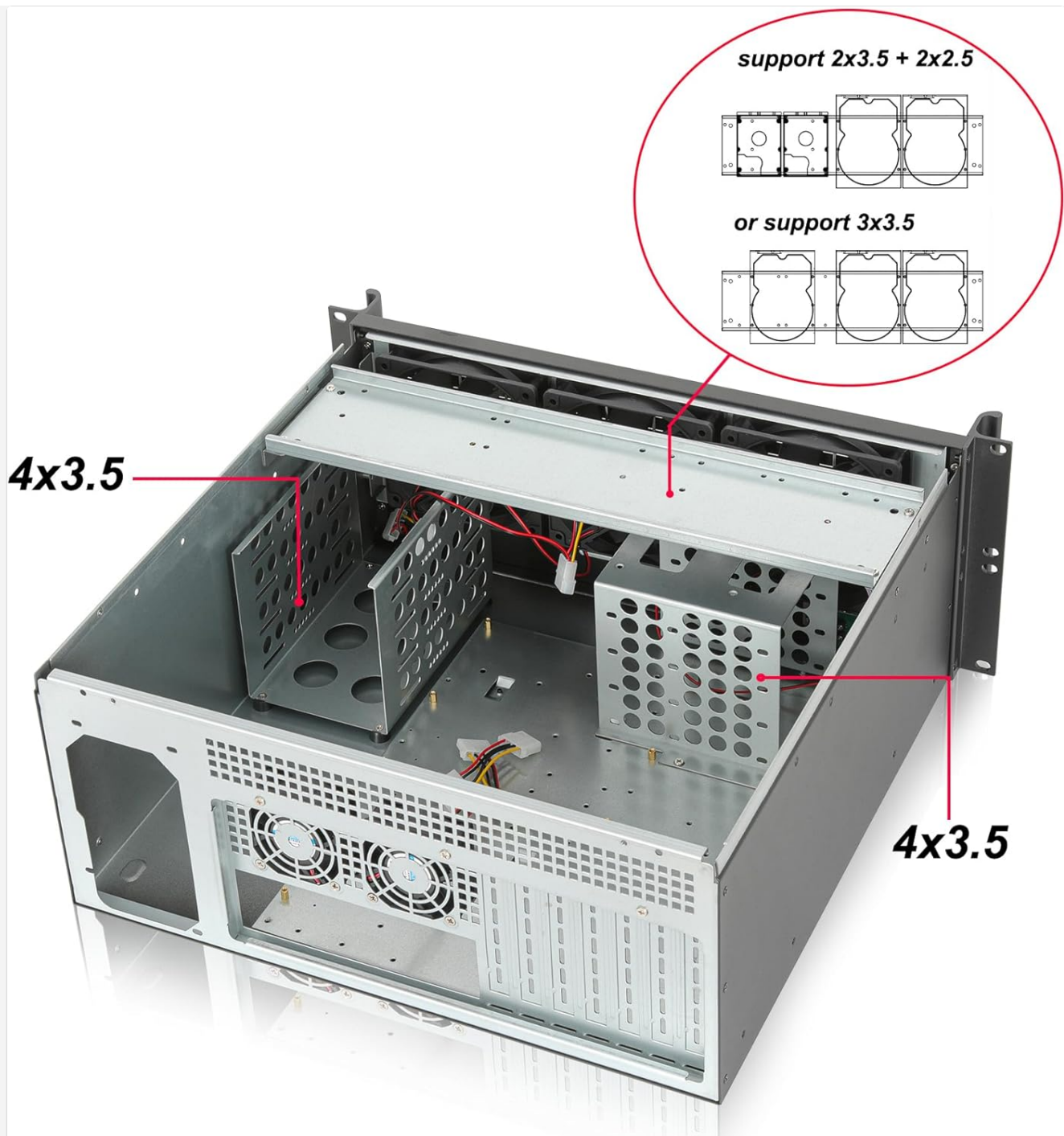

Figure 3: Internal layout with 4x3.5" drive bays and flexible 3x3.5" or 2x3.5"+2x2.5" support.



Figure 4: Motherboard mounting area supporting EATX, CEB, ATX, and MicroATX form factors.

2. Motherboard Installation

1. Remove the chassis cover by unscrewing the retaining screws.
2. Install the I/O shield into the rear panel opening.
3. Align the motherboard with the standoffs inside the chassis. Ensure compatibility with EATX, ATX, Micro ATX, or Mini-ITX motherboards.
4. Secure the motherboard using the provided screws.
5. *Note: For EATX motherboards, the front HDD bracket may need to be removed.*

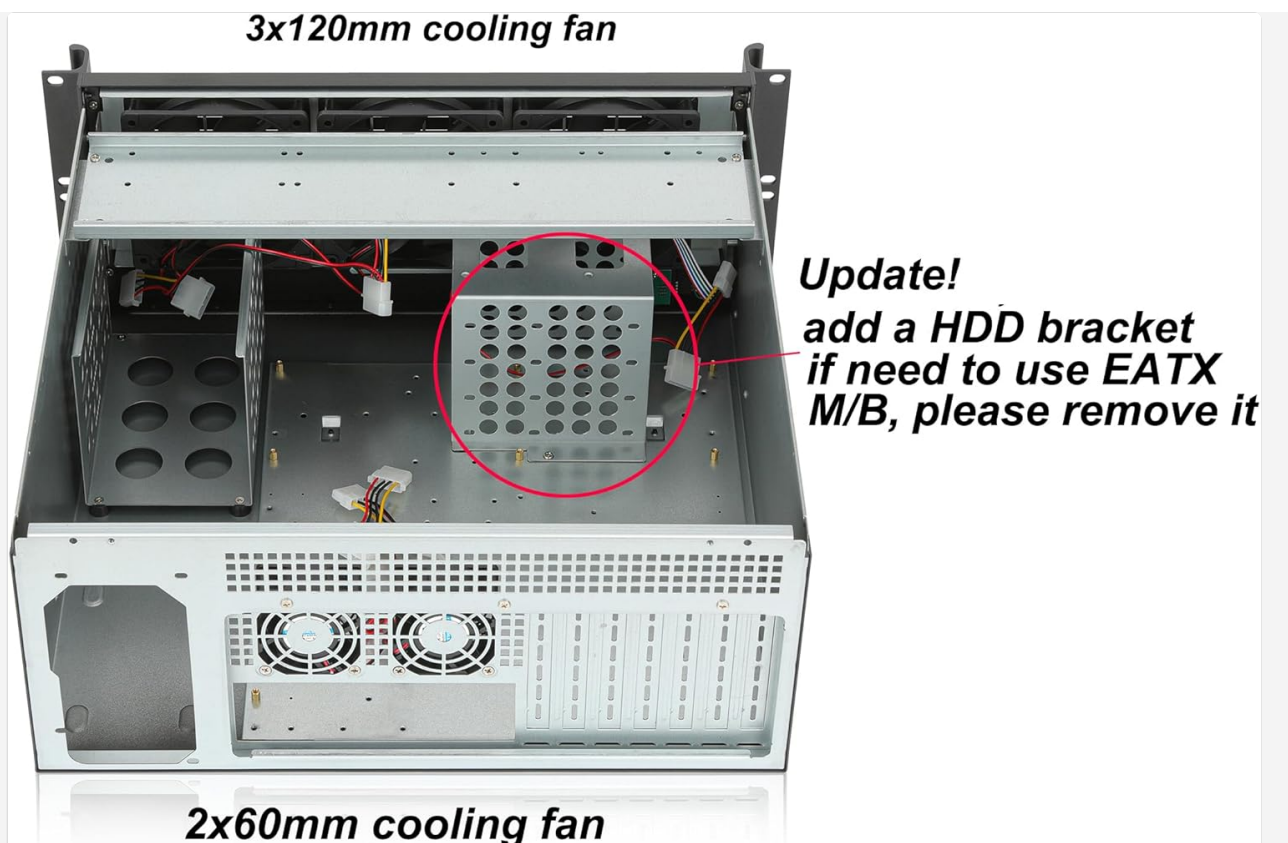

Figure 5: Location of the removable HDD bracket for EATX motherboard clearance.

3. Drive Installation

The chassis supports various drive configurations:

- Internal 4x3.5" drive bays.
 - Additional 3x3.5" or 2x3.5" + 2x2.5" drive bays.
1. Mount 3.5" HDDs into the designated drive cages using screws.
 2. For 2.5" SSDs/HDDs, use appropriate adapters if mounting in 3.5" bays.
 3. Secure the drive cages within the chassis.

4. Power Supply Installation

This chassis supports a standard ATX PS-2 PSU.

1. Insert the ATX power supply into its designated bay at the rear of the chassis.
2. Secure the power supply with screws.
3. Connect the necessary power cables to the motherboard and other components.

5. Cooling Fan Installation

The chassis comes with pre-installed fans and options for additional cooling:

- 3 x 12cm fans pre-installed at the front.
 - Option for 2 x 6cm fans at the rear.
1. Ensure all pre-installed fans are securely connected.
 2. If installing optional 6cm fans, secure them to the rear fan mounts.
 3. Connect fan power cables to the motherboard or power supply.

6. Expansion Card Installation

The chassis provides 7 full-height expansion slots, supporting large GPUs.

1. Remove the appropriate slot covers from the rear of the chassis.
2. Insert the expansion card (e.g., GPU, network card) into the corresponding PCIe slot on the motherboard.
3. Secure the expansion card with a screw.

7. Front Panel Connections

Connect the front panel cables to your motherboard:

- Power switch
- Reset switch
- Power LED
- HDD LED
- 2 x front access USB 3.0 ports (with 2.0 adaptor)



Figure 6: Front panel with USB 3.0 ports and power/reset buttons. Dimensions: 16.53"D x 19"W x 7"H.

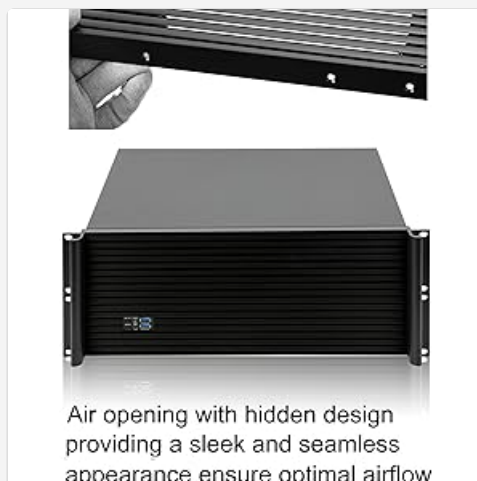

8. Rack Mounting

The chassis is designed for 4U rackmount installations.

1. Ensure your server rack is compatible with 4U equipment.
2. Attach the chassis to the rack rails using appropriate rack screws.
3. Secure the chassis firmly in place.



Figure 8: The Rackchoice 4U chassis integrated into a typical server rack environment.

OPERATING INSTRUCTIONS

Once all components are installed and secured, and the chassis is mounted in the rack:

1. Connect the power cable from the power supply to a suitable power outlet.
2. Press the power button on the front panel to turn on the system.
3. Observe the power and HDD activity LEDs for system status.
4. For system shutdown, use the operating system's shutdown procedure or press and hold the power button.

MAINTENANCE

Regular maintenance ensures the longevity and optimal performance of your chassis:

- **Dust Removal:** Periodically clean the interior of the chassis and fan blades to prevent dust buildup, which can impede airflow and cause overheating. Use compressed air or a soft brush.
- **Fan Inspection:** Check cooling fans for proper operation and replace any noisy or malfunctioning fans.
- **Cable Management:** Ensure internal cables are neatly routed to avoid obstructing airflow.
- **Handle Updates:** The chassis handles have been updated for improved ergonomics. If you have an older version and require updated handles, please contact customer support.



***Update handles easier to use and ergonomically optimized
(In June 2025 in USA)***

***If need before handles
please email to us***

by amazon service



Figure 9: Updated handles for easier and more ergonomically optimized use (available from June 2025 in USA).

TROUBLESHOOTING

Problem	Possible Cause	Solution
System does not power on.	No power connection; faulty power supply; loose front panel connector.	Check power cable, power supply, and front panel power switch connection to motherboard.
Overheating.	Blocked airflow; malfunctioning fans; excessive dust buildup.	Ensure proper ventilation, clean dust, check fan operation, and consider adding optional rear fans.

Problem	Possible Cause	Solution
Drives not detected.	Loose data/power cables; incorrect drive installation.	Verify all drive cables are securely connected and drives are properly seated in bays.

SPECIFICATIONS

Feature	Detail
Case Type	4U Rackmount
Motherboard Compatibility	EATX (12" x 13"), ATX, Micro ATX, Mini-ITX
Drive Bays	Internal 4x3.5" + (3x3.5" or 2x3.5"+2x2.5")
Cooling	3 x 12cm front fans (pre-installed), 2 x 6cm rear fans (optional)
Front I/O	2 x USB 3.0 (with 2.0 adaptor)
Power Supply Support	Standard ATX PS-2 PSU (Bottom Mount)
Expansion Slots	7 Full Height
Dimensions (LxWxH)	16.53"D x 19"W x 7"H
Material	Metal (Aluminum front panel)
Color	Black
Item Weight	22.6 pounds
Country of Origin	China

WARRANTY AND SUPPORT

Rackchoice products are designed for reliability and performance. For warranty information and technical support, please refer to the official Rackchoice website or contact your local distributor.

For inquiries regarding updated handles or other product versions, please contact Rackchoice customer service via the Amazon service platform or directly through the manufacturer's contact channels.

Manufacturer: RackChoice

Model: N4058



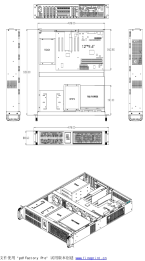

[5502 Model 2U Rackmount Server Chassis Technical Specifications and Dimensions](#)

Detailed technical drawings and dimensions for the 5502 Model 2U rackmount server chassis by RackChoice, supporting ATX/MATX motherboards and ATX PSUs. Includes front, side, top/bottom, and isometric views with component descriptions.