

CATCHFACE C6 Black

CATCHFACE Smart Lock Instruction Manual

Model: C6 Black

1. INTRODUCTION

Thank you for choosing the CATCHFACE C6 Smart Lock. This advanced 5-in-1 keyless entry door lock offers multiple convenient and secure unlocking methods, including fingerprint, passcode, IC card, mechanical key, and control via the TTLock mobile application. Designed for easy installation and robust security, this smart lock is an ideal solution for enhancing access control in homes, bedrooms, and apartments.

This manual provides detailed instructions for the proper installation, setup, operation, and maintenance of your C6 Smart Lock. Please read this manual thoroughly before installation and use to ensure optimal performance and safety.

2. SAFETY INFORMATION

- Do not expose the lock to direct water or extreme humidity. This lock is designed for indoor use only and is not weatherproof.
- Use only specified batteries (4x AAA alkaline batteries). Do not mix old and new batteries or different types of batteries.
- Keep mechanical keys in a safe place outside the property to be used for emergency access.
- Avoid using abrasive cleaners or solvents on the lock surface.
- Ensure proper installation to prevent damage to the lock or door.
- Regularly check the battery level and replace batteries promptly when indicated by the low battery alarm.

3. PACKAGE CONTENTS

Verify that all components are present before beginning installation:

- CATCHFACE C6 Smart Lock (1 unit)
- IC Cards (5 units)
- Mechanical Keys (2 units)
- Installation Hardware (screws, spindle, etc.)

- User Manual (this document)

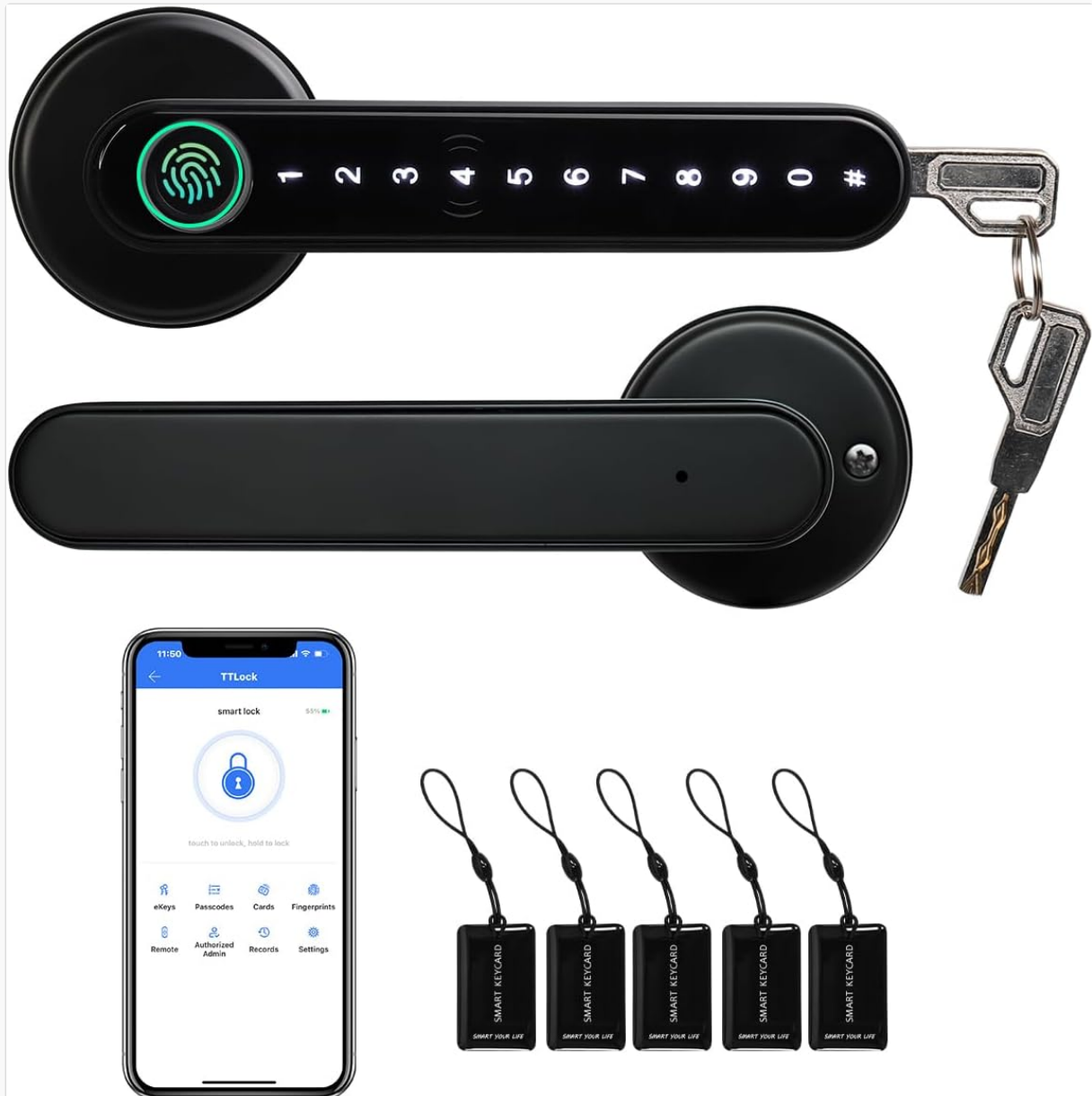

Image: Overview of the CATCHFACE C6 Smart Lock, including the main unit, mechanical keys, IC cards, and a smartphone displaying the TTLock app interface.

4. INSTALLATION

The CATCHFACE C6 Smart Lock is designed for easy installation and can directly replace most standard spherical door locks with a width of 55-75mm and a door thickness of 35-55mm. No extensive drilling or professional assistance is typically required.

4.1 Door Compatibility

Fits On 99% Doors



This type of spherical door lock can be directly replaced
width of 55~75cm spherical lock hole
Suitable Door Thickness: 35~55mm

Image: Diagram illustrating the compatible door dimensions (55-75mm spherical lock hole width, 35-55mm door thickness) and examples of traditional door knobs that can be replaced by the C6 Smart Lock.

4.2 Handle Orientation

The lock supports universal left and right door orientations. Ensure the handle is correctly oriented during installation for proper function.

Application Scenarios

Universal Left and Right door

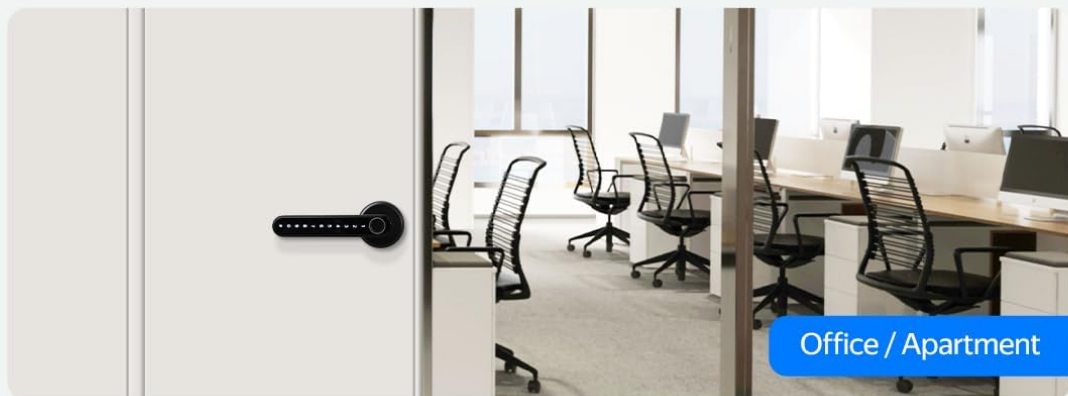
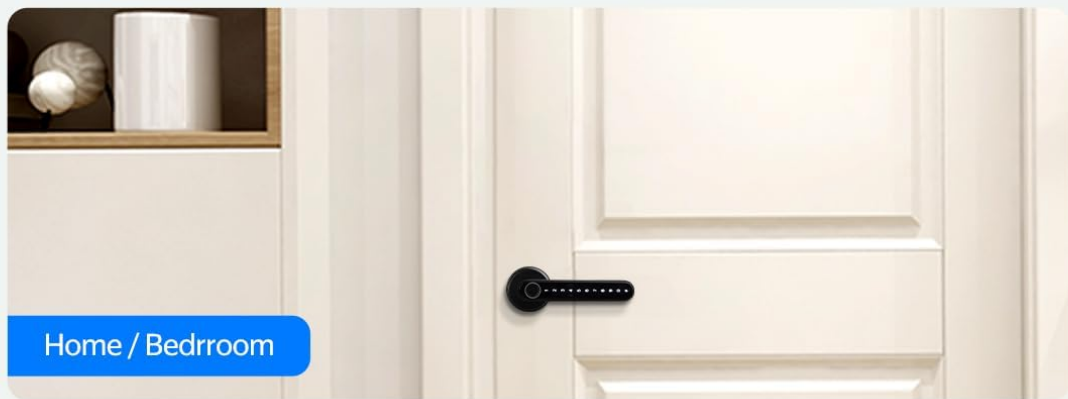
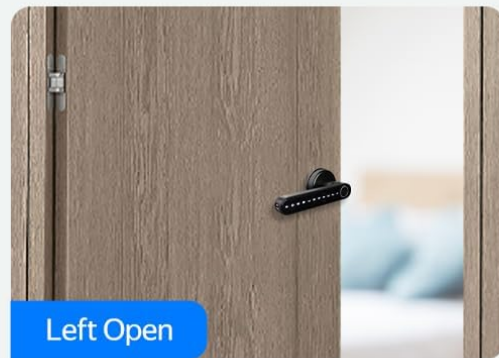
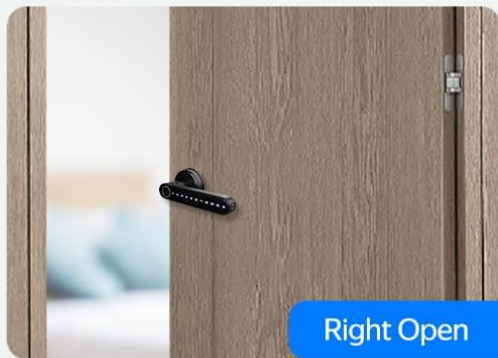

Image: Visual examples of the CATCHFACE C6 Smart Lock installed on both left-opening and right-opening doors, as well as in home/bedroom and office/apartment settings.

For detailed step-by-step installation instructions, please refer to the included installation guide or the manufacturer's official installation video.

5. SETUP

After physical installation, the smart lock requires initial setup, primarily through the TTLock application.

5.1 TTLock App Pairing

1. Download the TTLock app from your smartphone's app store.
2. Create an account and log in.

3. Enable Bluetooth on your smartphone and ensure it is close to the lock.
4. In the app, tap 'Add Lock' and select 'Door Lock'. The app will search for nearby locks.
5. Select your C6 Smart Lock from the list and follow the on-screen prompts to pair.

5.2 User Management

Once paired, you can manage users and access methods:

- **Adding Fingerprints:** Follow the app's instructions to register fingerprints for quick and secure access. The lock features a high-precision fingerprint sensor for fast verification.
- **Setting Passcodes:** Generate permanent, timed, one-time, or custom passcodes for various users. The anti-peeping virtual password feature allows you to enter random digits before or after your actual code to prevent onlookers from guessing your entry.
- **Registering IC Cards:** Enroll the included IC cards for convenient tap-to-unlock access. If a card is lost, it can be easily deleted from the app.
- **Granting eKeys:** Share temporary or permanent eKeys with family, friends, or housekeepers directly through the app.

WITH TTLock APP

Remote Manage Your Smart Lock

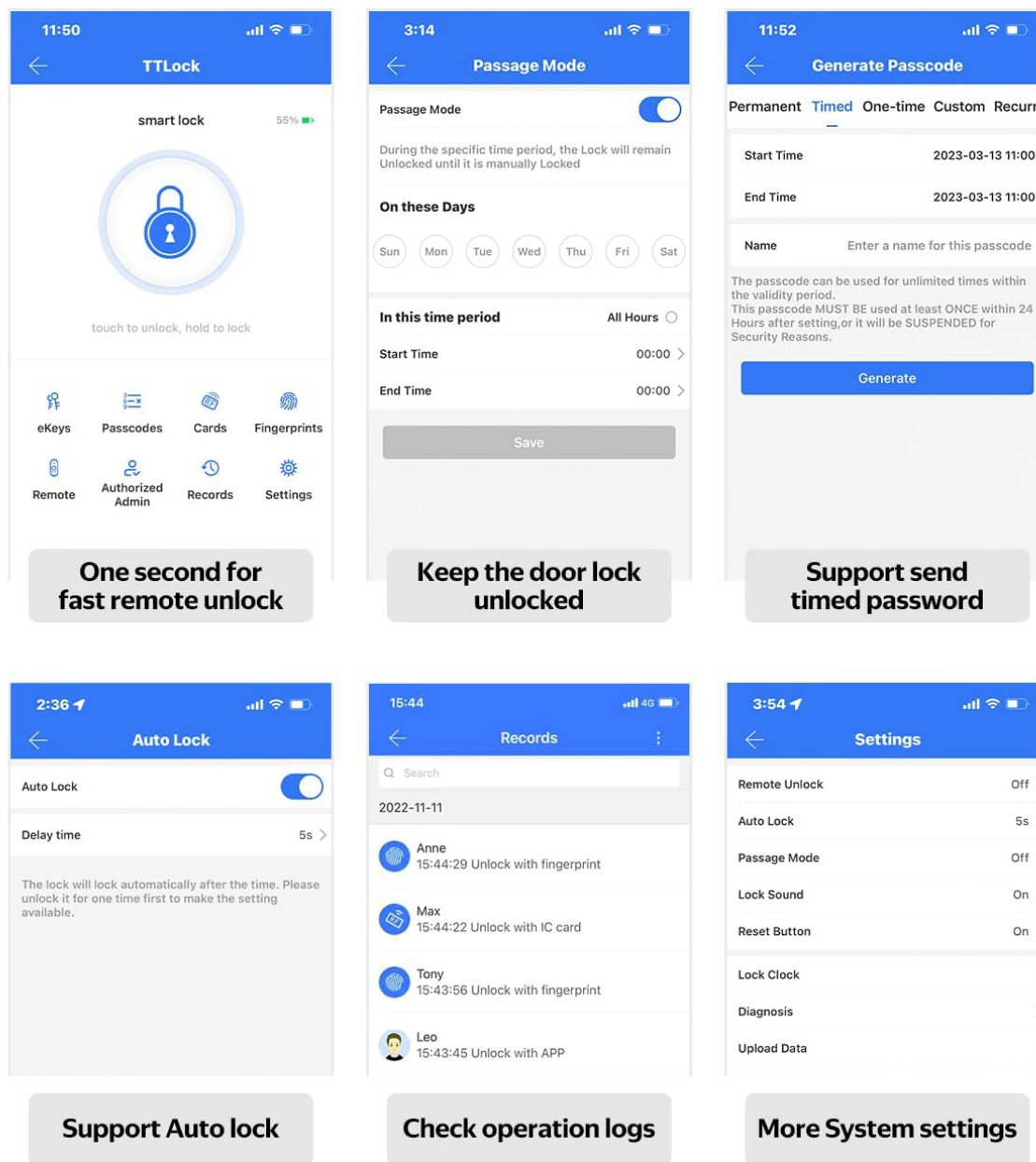

Image: Screenshots of the TTLock app demonstrating features such as remote unlock, passage mode, generating timed passcodes, auto-lock settings, operation logs, and other system settings.

6. OPERATING

The CATCHFACE C6 Smart Lock offers multiple ways to unlock and lock your door.

6.1 Unlocking Methods

- **TTLock App Unlock:** Open the TTLock app, ensure Bluetooth is on, and tap the unlock icon.
- **Fingerprint Unlock:** Place your registered finger on the fingerprint sensor. The lock will unlock in approximately 0.5 seconds.
- **Passcode Unlock:** Enter your valid passcode on the keypad. You can use the anti-peeping feature by entering random digits before or after your actual code.

- **IC Card Unlock:** Tap a registered IC card against the card reader area on the lock.
- **Mechanical Key Unlock:** Insert the mechanical key into the keyhole and turn to unlock. This is for emergency use.

Multiple Unlock Ways

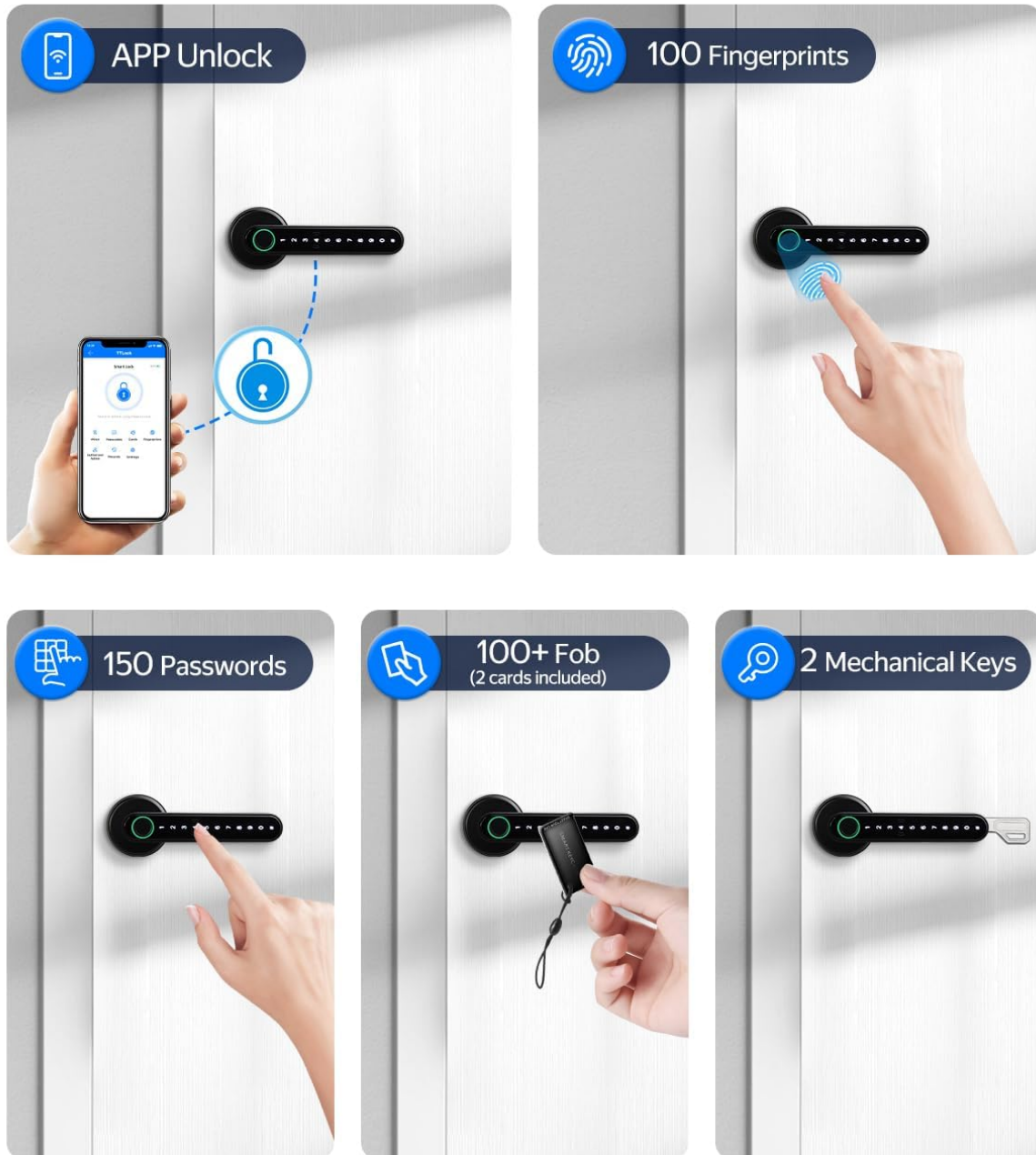

Image: Visual representation of the five unlock methods: App Unlock, Fingerprint Unlock (up to 100 fingerprints), Passcode Unlock (up to 150 passwords), Fob/IC Card Unlock (100+ fobs, 2 cards included), and Mechanical Key Unlock (2 mechanical keys included).

6.2 Locking Methods

- **Automatic Locking:** The lock can be configured via the TTLock app to automatically lock after a set delay once the door is closed.
- **Manual Locking:** Press and hold the '#' key on the keypad for a few seconds to manually lock the door from the outside.

6.3 Additional Features

- **Passage Mode:** Set a specific time period during which the lock will remain unlocked until manually locked, useful for gatherings or busy periods.
- **Silent Mode:** Adjust the volume of voice prompts from the lock via the app.
- **Operation Logs:** View unlock records and attendance logs through the TTLock app.

Video: Demonstrates the various unlocking methods of the CATCHFACE Smart Lock, including app, fingerprint, password, IC card, and mechanical key unlocking.

7. MAINTENANCE

7.1 Battery Replacement

The C6 Smart Lock is powered by 4 AAA alkaline batteries (not included). When the battery level is low, the lock will emit a low battery alarm. Replace all four batteries promptly to ensure continuous operation.

Ultra-long Battery Life

Powered by
4pcs AAA alkaline batteries



✓ Smart Power Saving

✓ Lagre Power Range

✗ Batteries are not included

What if the smart lock is out of battery?



Mechanical Key

Emergency unlocking with
mechanical key



USB Power Outlet

Emergency power for door locks
with power band

Image: Illustrates the use of 4 AAA alkaline batteries for ultra-long battery life and shows emergency unlocking options: mechanical key and USB power outlet for temporary power with a power bank.

7.2 Emergency Power

If the batteries completely drain, you can use a mechanical key for emergency unlocking or connect a power bank to the USB power outlet on the lock for temporary power to unlock.

7.3 Cleaning

Wipe the lock surface with a soft, dry cloth. Do not use harsh chemicals or abrasive materials that could damage the finish or electronic components.

8. TROUBLESHOOTING

- **Lock not responding:** Check battery levels and replace if necessary. Ensure the lock is properly

installed and aligned.

- **Fingerprint not recognized:** Ensure your finger is clean and dry. Re-register your fingerprint if issues persist.
- **Passcode not working:** Verify the correct passcode is entered. Ensure the lock is not in passage mode if you expect it to lock.
- **App connectivity issues:** Ensure Bluetooth is enabled on your phone and the lock is within range. Restart the app or your phone.
- **Lock is not weatherproof:** This lock is designed for indoor use only. Exposure to rain or high humidity will cause damage and is not covered under warranty.

9. SPECIFICATIONS

Key technical specifications for the CATCHFACE C6 Smart Lock:

Specification

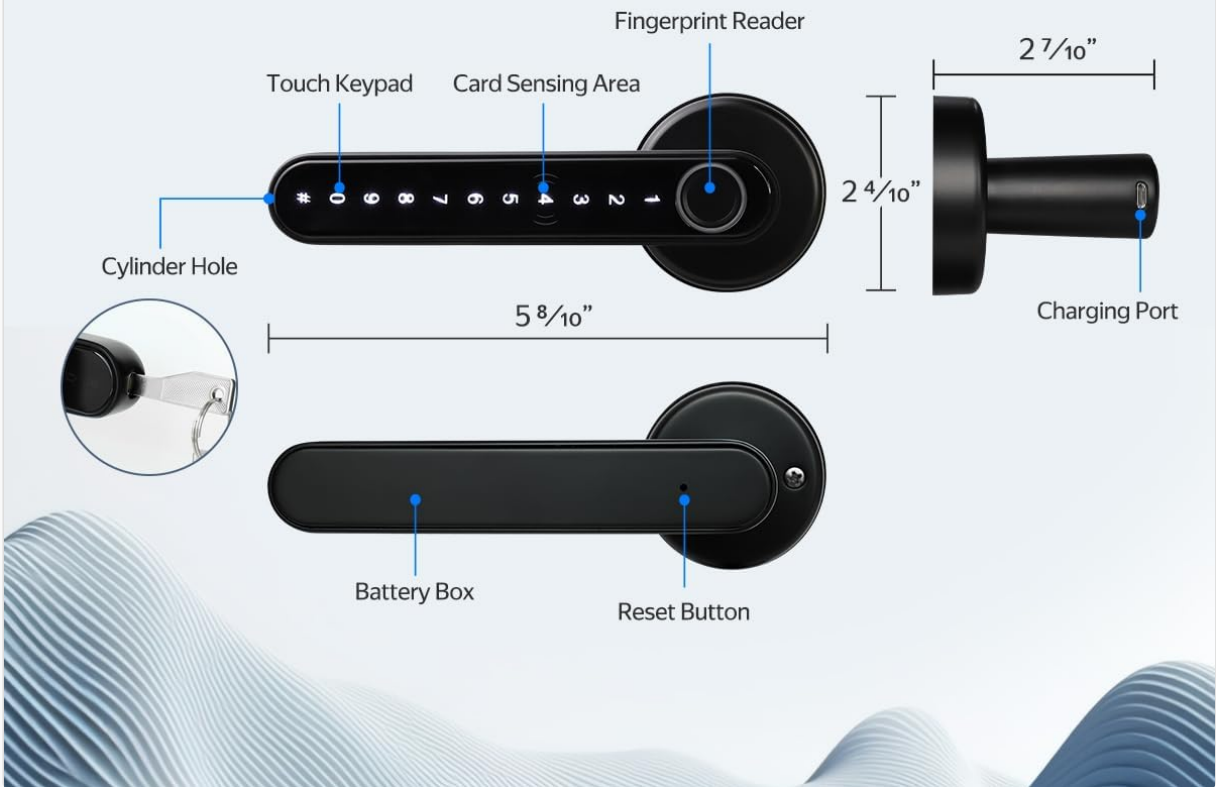
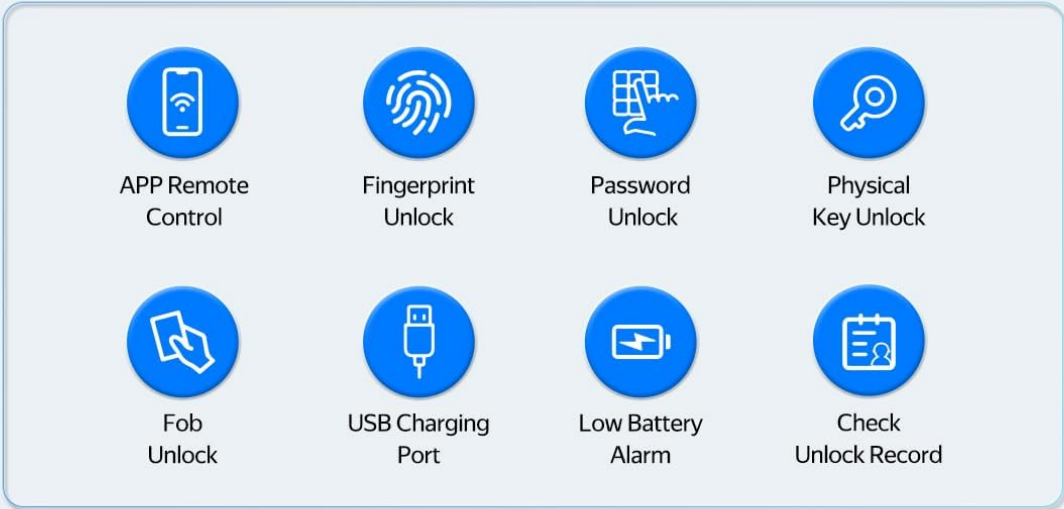

Image: A detailed diagram of the CATCHFACE C6 Smart Lock, highlighting its various components such as the fingerprint reader, touch keypad, card sensing area, cylinder hole, battery box, reset button, and charging port, along with key dimensions.

Feature	Detail
Brand	CATCHFACE
Model Name	C6 TTLock Smart Lock Black
Lock Type	Biometric, Deadbolt, TTLock door lock
Material	Zinc
Color	C6-Black





Item Dimensions (L x W x H)	5.8 x 2.5 x 2.8 inches
Item Weight	2.3 pounds
Special Features	Alarm, Anti-Peeping Password, Back-Lit Keypad, Multiple Unlock Ways, One-Touch Lock
Connectivity Protocol	Bluetooth, Wi-Fi (with gateway, sold separately)
Controller Type	Amazon Alexa, Android, Google Assistant, iOS (via TTLock app)
Power Source	4x AAA Batteries (not included)
Emergency Power	USB Power Outlet

10. WARRANTY AND SUPPORT

Specific warranty details and direct support contact information are not provided in this manual. Please refer to the product packaging or the seller's information on the purchase platform for warranty terms and customer support contacts. Keep your purchase receipt as proof of purchase for any warranty claims.

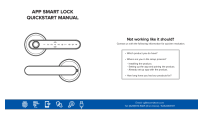
© 2025 CATCHFACE. All rights reserved.

Related Documents - C6 Black

	CATCHFACE APP Smart Lock Quickstart Manual - Installation, Features, and FAQs Comprehensive quickstart guide for the CATCHFACE APP Smart Lock. Learn about installation, safety warnings, accessories, product specifications, operation videos, and frequently asked questions for keyless entry and smart home security.
	TFX1 Smart Lock Quick Start Manual: Installation and Operation Guide Comprehensive quick start guide for the TFX1 Smart Lock by CATCHFACE, covering unboxing, handle direction, installation, TTLock app operation, and frequently asked questions. Learn how to install and use your keyless entry smart lock.
	CATCHFACE APP Smart Lock Quickstart Manual and Installation Guide Comprehensive guide to installing and operating the CATCHFACE APP Smart Lock, including safety warnings, troubleshooting, and FAQs. Learn how to set up your keyless entry door lock.
	TTLock APP User Guide - CATCHFACE Smart Lock Instructions Comprehensive user guide for the TTLock App, detailing how to register, pair, and operate CATCHFACE smart locks, including features like passcodes, eKeys, fingerprints, and remote access.

1. FAQs

Question 1: How to install the door lock, any installation guide or video?

Answer: Yes, there is an installation guidelet, it is on this manual and an installation video on the A02 product page.

Question 2: Why other unregistered fingerprints can also unlock the lock?

Answer: Before the first fingerprint is registered successfully, it is the experience mode, any fingerprint can unlock the lock in experience mode. Please check if the first fingerprint is registered successfully.

Question 3: Why my fingerprints cannot be registered successfully?

Answer: One fingerprint needs to be collected 5 times that will be registered successfully. Or you should enter the same fingerprint 5 times instead of entering 5 different fingerprints when registering a fingerprint.

Question 4: Why does the lock sometimes sleep after entering the setup command?

Answer: Because it cannot be set up after unlocking, it may be unlocked by touching the fingerprint-reading area, so you can unlock the lock by touching the sensor's support surface and then entering the command to setup.

[eLinkSmart T8 Door Lock FAQs: Installation, Fingerprint Registration & Sleep Mode Troubleshooting](#)

Find answers to common questions about the eLinkSmart T8 Door Lock. This FAQ covers installation guides, troubleshooting fingerprint registration, and resolving issues with the lock's sleep mode. Learn more about your keyless entry smart lock.