

Omezify PM245-BT

Omezify PM245-BT Bluetooth Thermal Label Printer

USER MANUAL

Introduction

This manual provides detailed instructions for the setup, operation, maintenance, and troubleshooting of your Omezify PM245-BT Bluetooth Thermal Label Printer. Please read this manual thoroughly to ensure proper use and optimal performance of your device.

The Omezify PM245-BT is a versatile thermal label printer designed for efficiency and convenience. It supports both Bluetooth and USB connectivity, making it compatible with a wide range of operating systems including Android, iOS, Mac, Windows, ChromeOS, and Linux. This printer is ideal for various labeling needs, from shipping labels to product identification.

What's in the Box

Upon unpacking, please verify that all the following components are included:

- PM-245-BT Label Printer
- Power Adapter & Cable
- USB Cord
- USB Type-C Converter
- Quick Start Guide
- Sample 4"x6" Labels (10+ sheets)



Image: All components included in the Omezizy PM245-BT thermal label printer package.

Setup

1. Physical Setup

1. **Connect Power:** Plug the power adapter into the printer's power port and then into a wall outlet. The power indicator light on the printer should illuminate.
2. **Load Labels:** Open the printer cover. Ensure your thermal labels are properly aligned and facing upwards. Feed the labels into the rear slot of the printer. The printer will automatically detect and calibrate the label size.



Image: The Omezizy PM245-BT printer with a label roll correctly inserted and ready for printing.

2. Software Installation & Connection

The Omezizy PM245-BT offers both Bluetooth and USB connectivity. For Bluetooth functionality, the 'Labelife' editing app is required.

- **Bluetooth Connection:**

- a. Download the 'Labelife' app from your device's app store (available for Android and iOS). You can also scan the QR code provided in the quick start guide or visit [Labelife App](#).
- b. Enable Bluetooth on your smartphone, tablet, or computer (Mac/Windows).
- c. Open the 'Labelife' app and follow the in-app instructions to connect to your PM245-BT printer.

- **USB Connection:**

- a. Connect the printer to your computer (Windows, Mac, ChromeOS, Linux) using the provided USB cable.
- b. Install the necessary drivers from the included CD or the manufacturer's website.



Image: Overview of the printer's operating system compatibility for both Bluetooth and USB connections.



Image: Visual representation of connecting the printer via USB to a computer and via Bluetooth to a mobile device.

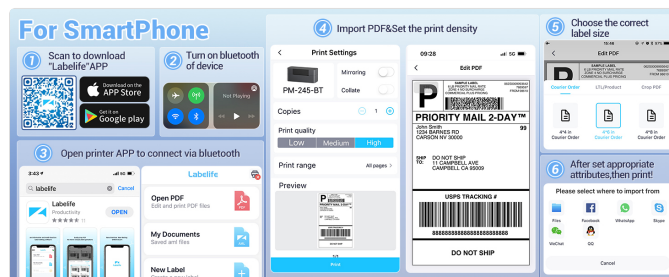

Image: Detailed steps for connecting and printing from a smartphone using the Labelife application.

Operating Instructions

1. Printing Process (via Labelife App)

For Bluetooth printing, the 'Labelife' app streamlines the process:

1. **Prepare Label:** Download the label to be printed from your chosen platform (e.g., USPS, UPS, eBay, Etsy, Shopify, Amazon, PayPal, Poshmark).
2. **Import & Edit:** Open the 'Labelife' app, import your label file (e.g., PDF), and adjust print settings such as density and orientation.
3. **Select Label Size:** Choose the correct label size within the app to match your physical labels.
4. **Print:** Initiate the print command from the app.



Image: A user printing a label wirelessly from a smartphone to the Omezizy PM245-BT printer.



Image: The printer's compatibility with various online sales and shipping platforms.

2. Supported Label Types and Sizes

The Omezizy PM245-BT supports thermal labels with a width ranging from 1 inch to 4.6 inches. This flexibility allows for printing various label types:

- Shipping Labels (e.g., 4"x6")
- Address Labels
- Barcode Labels
- QR Code Labels
- Thanks Labels
- Jar Labels
- DIY Labels



Image: Examples of different label sizes and shapes that can be printed by the device.



Image: Practical applications of the printer for shipping, food, pricing (example barcode: 123456), and thank you labels.



Image: A range of label types suitable for small businesses and daily use.

Maintenance

The Omeziy PM245-BT is a thermal printer, meaning it does not require ink cartridges or toner. This simplifies maintenance and reduces operational costs.

- **Cleaning the Print Head:** Periodically clean the print head with an alcohol wipe or a specialized thermal printer cleaning pen to ensure clear print quality. Ensure the printer is turned off and cooled down before cleaning.
- **General Care:** Keep the printer free from dust and debris. Avoid placing heavy objects on top of the printer.



Image: Features of the thermal printer, emphasizing its inkless operation and environmental benefits.

Troubleshooting

If you encounter issues with your Omezizy PM245-BT printer, consider the following common solutions:

- **Connection Issues:**
 - Ensure Bluetooth is enabled on your device and the printer is within range.
 - Verify the 'Labelife' app is updated to the latest version.
 - For USB, check cable connections and driver installation.
- **Poor Print Quality:**
 - Clean the print head as described in the Maintenance section.
 - Ensure you are using high-quality thermal labels.
 - Adjust print density settings in the 'Labelife' app or printer preferences.
- **Labels Not Feeding/Error Code:**
 - Check for any label jams and ensure labels are loaded correctly and aligned.
 - To reset the printer and clear certain error codes, press and hold the button on the top of the unit until the light flashes twice, then feed in your label.

If problems persist, please contact customer support for assistance.

Specifications

Feature	Specification
Model	PM245-BT
Product Dimensions	21.3D x 9.5W x 8H Centimetres
Connectivity Technology	Bluetooth, USB
Printing Technology	Thermal
Maximum Media Size	4 x 6 inch (supports 1 - 4.6 inches width)
Maximum Print Resolution	203 DPI (Dots Per Inch)
Maximum Print Speed	72 ppm (pages per minute) / 150mm/s
Compatible Operating Systems	Android, iOS, Mac, Windows, ChromeOS, Linux
Printer Output	Monochrome
Item Weight	0.72 Kilograms



Warranty and Support

Omezizy provides lifetime customer support for the PM245-BT printer. If you require assistance, please use the following contact methods:

- **Phone Support:** Available Monday - Friday, 9:00 AM - 5:00 PM EST.
- **Email / Live Chat Support:** Available Monday - Friday, 7:30 PM - 4:30 AM EST.

Support options include phone calls, email, and remote desktop operations to help resolve any issues you may encounter.

Related Documents - PM245-BT

	<p>Omezizy WiFi Thermal Label Printer 4x6 - User Tips and Maintenance</p> <p>Provides essential pre-operation tips and maintenance advice for the Omezizy WiFi Thermal Label Printer 4x6, including label handling and troubleshooting common issues like paper jams.</p>
	<p>Labelife Software: Bluetooth Thermal Label Printer Setup Guide</p> <p>Step-by-step guide to setting up and connecting your Labelife thermal label printer via Bluetooth using the Labelife software. Learn how to create labels, configure paper settings, and establish a Bluetooth connection for printing.</p>

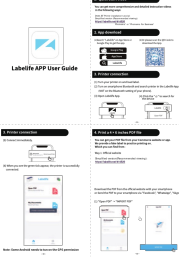
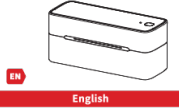
<p>PL70e-BT Manual</p> 	<p>PL70e-BT Bluetooth Thermal Label Printer User Manual</p> <p>Comprehensive user manual for the POLONO PL70e-BT Bluetooth Thermal Label Printer, covering setup, operation, troubleshooting, and specifications for Windows and Mac.</p>
	<p>Labelife App User Guide: Printing and Connecting Your Label Printer</p> <p>Comprehensive user guide for the Labelife mobile app, detailing how to connect Phomemo printers via Bluetooth, download the app, and print PDF files including shipping labels and custom designs.</p>
<p>Quick Start Guide PM-241-BT</p> 	<p>Phomemo PM-241-BT Quick Start Guide: Setup and Operation</p> <p>A quick start guide for the Phomemo PM-241-BT thermal label printer, covering unboxing, setup, connecting to power and devices, installing the app and drivers, and printing labels via mobile and computer.</p>