

SONGMICS UGLR040E02

SONGMICS 5-Tier Heavy-Duty Shelving Units (Set of 2) Instruction Manual

Model: UGLR040E02 | Brand: SONGMICS

1. INTRODUCTION

Thank you for choosing the SONGMICS 5-Tier Heavy-Duty Shelving Units. This manual provides essential information for the safe assembly, operation, and maintenance of your new storage solution. Please read these instructions carefully before beginning assembly and retain them for future reference.

1.1 Safety Information

- Always fix the shelving units to the wall using the included anti-tipping kits before use to prevent accidental tipping.
- Do not exceed the maximum load capacity per shelf (175 kg) or the total maximum distributed load (875 kg) for each unit.
- Distribute weight evenly across shelves to maintain stability.
- Assemble on a flat, stable surface.
- Wear protective gloves during assembly to prevent injury from sharp edges.

2. COMPONENTS LIST

Please verify that all components are present before starting assembly. If any parts are missing or damaged, contact customer support.

- Upright Posts (Vertical Supports)
- Long Crossbeams (Horizontal Supports for length)
- Short Crossbeams (Horizontal Supports for width)
- MDF Panels (Shelf surfaces)

- Foot Caps (Protective caps for upright posts)
- Anti-Tipping Kit (Wall anchors and straps)



Image 2.1: Overview of two assembled shelving units, demonstrating their capacity and structure.

3. SETUP AND ASSEMBLY

The shelving units feature a boltless assembly design for quick and easy setup. A rubber mallet (not included) may be helpful for securing connections.

3.1 Step-by-Step Assembly

1. **Prepare the Base:** Attach the foot caps to the bottom ends of the upright posts. Ensure they are securely fitted.
2. **Assemble the First Level:** Connect the long and short crossbeams to the upright posts to form the base

frame of the first shelf. Ensure the tongues on the crossbeams are inserted **inside** the slots of the upright posts for a secure fit. Use a rubber mallet to gently tap connections into place if needed.

3. **Install MDF Panel:** Place an MDF panel onto the assembled crossbeams for the first shelf.
4. **Build Subsequent Levels:** Repeat step 2 and 3 for the remaining four shelves, ensuring all connections are firm.
5. **Complete the Top:** Secure the top crossbeams to the upright posts.
6. **Install Anti-Tipping Kit:** Once the unit is fully assembled and in its desired location, use the provided anti-tipping kit to secure the shelving unit to a wall. This is crucial for stability and safety.

Easy to Assemble and Disassemble

The bolt-free design makes assembly and disassembly a breeze

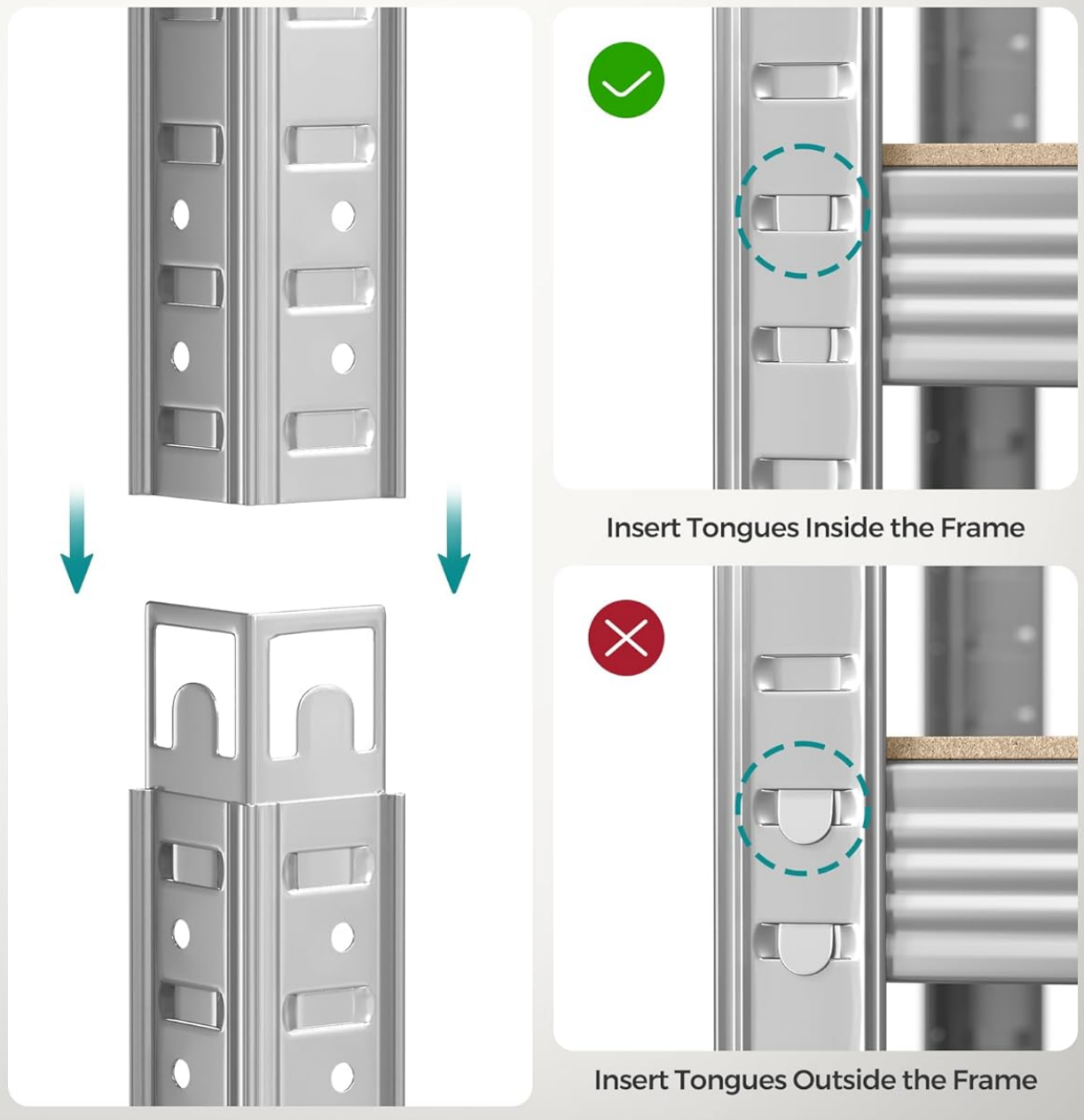

Image 3.1: Correct insertion of crossbeam tongues into the upright post slots is essential for stability.

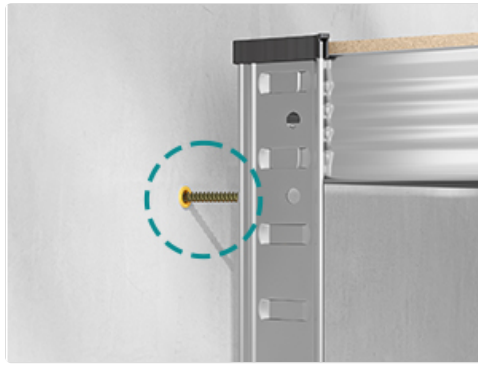

Image 3.2: Secure the unit to the wall using the anti-tipping kit for enhanced safety.

4. OPERATING INSTRUCTIONS

4.1 Adjusting Shelf Height

The shelves can be adjusted at 3 cm (approximately 1.2 inches) intervals to accommodate items of various sizes. To adjust a shelf:

1. Empty the shelf of all contents.
2. Carefully lift the MDF panel off the crossbeams.
3. Disengage the crossbeams from the upright posts by gently tapping them upwards with a rubber mallet.
4. Re-attach the crossbeams at the desired height, ensuring the tongues are fully inserted into the new slots.
5. Replace the MDF panel.



Adjustable Shelves

Customisable with 5 cm increments to fit short and tall items



Image 4.1: Shelves can be adjusted to different heights to suit various storage needs.

4.2 Dividing the Unit

Each 5-tier shelving unit can be divided into two smaller, separate units (e.g., two 2-tier or 3-tier units, or one 2-tier and one 3-tier unit) to fit your space or function as workbenches. To divide a unit:

1. Disassemble the unit down to the desired separation point.
2. Use the remaining components to construct two smaller, independent units. Ensure each new unit has its own set of foot caps and is secured with an anti-tipping kit if it is a tall configuration.



Total Max.
Distributed Load



Image 4.2: The shelving unit can be divided into two smaller units for versatile use.

5. MAINTENANCE

- **Cleaning:** Wipe down the steel frame and MDF panels with a damp cloth. Avoid abrasive cleaners that may damage the finish.
- **Inspection:** Periodically check all connections to ensure they remain secure. Re-tap with a rubber mallet if any connections feel loose.
- **Stability Check:** Regularly verify that the unit remains stable and the anti-tipping kit is securely fastened to the wall.
- **Load Management:** Ensure weight is always distributed evenly and does not exceed the specified load

capacities.

6. TROUBLESHOOTING

- **Unit feels wobbly or unstable:**

- Ensure all crossbeam tongues are fully inserted **inside** the upright post slots.
- Verify that the unit is placed on a flat, level surface.
- Confirm the anti-tipping kit is correctly installed and securely fastened to the wall.
- Check that weight is evenly distributed and not exceeding capacity.

- **Difficulty assembling parts:**

- A rubber mallet can assist in gently tapping components into place.
- Ensure correct orientation of parts as shown in the assembly diagrams.

7. SPECIFICATIONS

Feature	Detail
Model Number	UGLR040E02
Dimensions (L x W x H)	40 x 90 x 180 cm (15.7 x 35.4 x 70.9 inches)
Material	Steel Frame, MDF (Medium Density Fibreboard)
Number of Tiers	5
Maximum Weight Capacity per Shelf	175 kg (385 lbs)
Total Maximum Distributed Load	875 kg (1929 lbs)
Adjustable Shelves	Yes, at 3 cm intervals
Assembly Type	Boltless Interlocking Design
Item Weight	24.3 kg (53.6 lbs)

SONGMICS

by SONGMICS HOME



Image 7.1: Key dimensions and load capacities of the shelving unit.

8. WARRANTY AND SUPPORT

For specific warranty details, please refer to the product packaging or contact your retailer directly. SONGMICS is committed to providing quality products and customer satisfaction.

If you encounter any issues or have questions regarding your shelving units, please contact SONGMICS customer support through the retailer's platform or the official SONGMICS website. Please have your model number (UGLR040E02) and purchase information ready when contacting support.

