

FEIYUE FY515

FEIYUE FY515 Serger Overlock Machine Instruction Manual

1. INTRODUCTION

This manual provides detailed instructions for the safe and efficient operation of your FEIYUE FY515 Serger Overlock Machine. The FY515 is a versatile 2/3/4 thread serger designed for a variety of sewing projects, featuring a durable heavy-duty metal frame, a high sewing speed of up to 1,200 stitches per minute, adjustable differential feed, and a built-in rolled hem capability. Please read this manual thoroughly before using the machine to ensure proper setup, operation, and maintenance.

2. IMPORTANT SAFETY INSTRUCTIONS

- Always unplug the machine from the electrical outlet immediately after using, before cleaning, or when making any adjustments.
- Keep fingers away from all moving parts. Special care is required around the sewing machine needle.
- Use the proper power supply as indicated on the machine.
- Never operate the machine if it has a damaged cord or plug, if it is not working properly, or if it has been dropped or damaged.
- Do not use outdoors.
- Do not allow to be used as a toy. Close attention is necessary when the machine is used by or near children.
- Never drop or insert any object into any opening.
- Do not use where aerosol (spray) products are being used or where oxygen is being administered.

3. PACKAGE CONTENTS

Please ensure all items are present before beginning operation:

- FEIYUE FY515 Serger Overlock Machine

- Foot Pedal
- Power Cord
- Standard Accessories (e.g., Screwdrivers, Tweezers, Needles, Cleaning Brush, Spool Caps)
- Instruction Manual

4. PARTS IDENTIFICATION

Familiarize yourself with the key components of your serger:



Figure 4.1: Overall view of the FEIYUE FY515 Serger Overlock Machine.

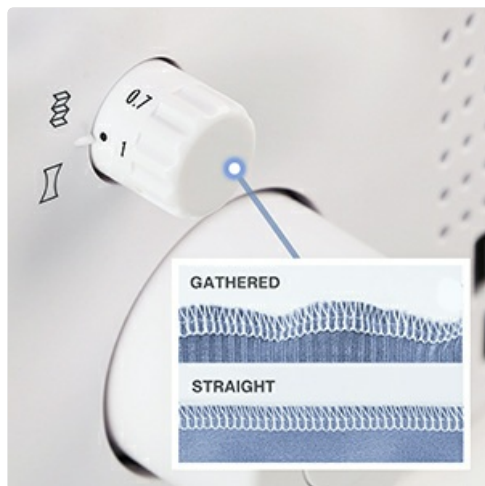

Figure 4.2: The heavy-duty metal interior frame ensures stability and durability.



Figure 4.3: Close-up of the needle and looper area, showing the precision components.



Figure 4.4: The color-coded threading guide simplifies the threading process.



Figure 4.5: Individual tension dials for precise thread control.



Figure 4.6: Spool pins for holding multiple thread cones.

5. SETUP INSTRUCTIONS

5.1 Threading the Machine

The FEIYUE FY515 features a user-friendly, color-coded threading system. Follow the numbered and color-coded guides inside the looper cover for each thread path. Ensure the presser foot is raised and tension discs are disengaged during threading.

Your browser does not support the video tag.

Video 5.1: Detailed threading guide for the FEIYUE FY515 Serger Overlock Machine. This video demonstrates the step-by-step process of threading all 2, 3, or 4 threads, following the color-coded paths and numbered guides for optimal machine performance.

Your browser does not support the video tag.

Video 5.2: General guide on how to thread a serger sewing machine. This video provides visual instructions on the threading process, which can be applied to various serger models, including the FY515, to ensure correct thread pathing.

Your browser does not support the video tag.

Video 5.3: Instructions on how to string wires (threads) on a serger. This video focuses on the technique of guiding threads through the machine's various points, which is crucial for proper stitch formation.

6. OPERATING INSTRUCTIONS

6.1 Stitch Length and Width Adjustment

Adjust the stitch length and width using the dedicated dials on the machine. Experiment with different settings on scrap fabric to achieve the desired stitch appearance for your project.



Figure 6.1: Dial for adjusting stitch length. A smaller number results in shorter stitches, while a larger number creates longer stitches.



Figure 6.2: Control for adjusting stitch width, allowing for wider or narrower seams.

Your browser does not support the video tag.

Video 6.1: Demonstration of 4-Thread Overlock Stitch on a FEIYUE FY505 machine. This video illustrates how to adjust stitch length and width, and how to change threads, providing visual guidance for achieving desired stitch results.

6.2 Differential Feed

The adjustable differential feed allows you to control the feeding of fabric, preventing stretching or puckering on various fabric types. Adjust the dial to match your fabric's needs.



Figure 6.3: Dial for adjusting the differential feed, crucial for handling different fabric types without distortion.



Figure 6.4: The high-durability carbon steel blade ensures precise cutting for a clean finish.

6.3 2/3/4 Thread Capability

The FY515 serger can operate with 2, 3, or 4 threads, offering flexibility for various stitch patterns and fabric types. Refer to the threading guide for specific configurations.

Your browser does not support the video tag.

Video 6.2: Demonstration of 3-Thread and 2-Thread Overlock stitches on a FEIYUE FY505 machine. This video shows how to configure the machine for different thread counts to achieve various overlock finishes.

7. MAINTENANCE

7.1 Cleaning

Regularly clean lint and thread scraps from the looper area and under the needle plate using the provided cleaning brush. This prevents build-up that can affect stitch quality and machine performance.

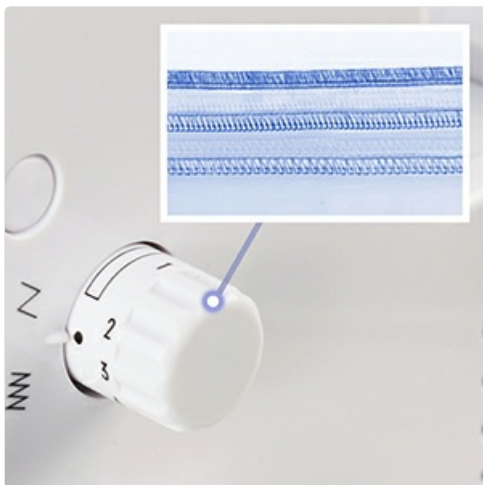

Figure 7.1: The integrated waste collector helps keep your workspace tidy by catching fabric scraps.

7.2 Changing Serger Blades

Over time, the serger blades may become dull and require replacement to maintain precise cutting. Use the provided tools to carefully replace the upper and lower blades as demonstrated in the video below.

Your browser does not support the video tag.

Video 7.1: Instructions on how to change your serger blades. This video provides a clear demonstration of the blade replacement process, ensuring your serger maintains its cutting precision.

8. TROUBLESHOOTING

If you encounter issues with your serger, please refer to the following common troubleshooting tips:

- **Skipped Stitches:** Check if needles are inserted correctly and are not bent. Ensure proper threading and tension.
- **Thread Breakage:** Verify that threads are not tangled, tension is correct, and needles are not dull or bent.
- **Fabric Puckering/Stretching:** Adjust the differential feed setting according to your fabric type.
- **Uneven Stitches:** Re-thread the machine completely, ensuring all threads are seated correctly in their tension discs and guides.
- **Machine Not Starting:** Check if the power cord is securely plugged in and the power switch is on. Ensure the presser foot is lowered.

9. SPECIFICATIONS

Feature	Detail
Product Dimensions	12.59 x 13.78 x 11.81 inches
Item Weight	20.9 pounds
Manufacturer	FEIYUE
Item Model Number	FY515
Brand	FEIYUE
Color	Grey
Material	Metal, Plastic
Power Source	Corded Electric
Stitches Per Minute	Up to 1,200
Thread Capability	2/3/4 Thread

10. WARRANTY AND SUPPORT

For warranty information, technical support, or to order replacement parts, please refer to the contact

information provided with your purchase documentation or visit the official FEIYUE website. Keep your purchase receipt as proof of purchase for warranty claims.