

Uineer M1LBS

Uineer M1LBS Rechargeable Dual Mode Bluetooth Wireless Mouse User Manual

Model: M1LBS

1. INTRODUCTION

Thank you for choosing the Uineer M1LBS Rechargeable Dual Mode Bluetooth Wireless Mouse. This manual provides detailed instructions for setting up, operating, and maintaining your new mouse. Please read this manual carefully before use to ensure proper functionality and to maximize your user experience.

2. PACKAGE CONTENTS

- Uineer M1LBS Wireless Mouse
- USB Nano Receiver (stored in the mouse's bottom compartment)
- USB Charging Cable
- User Manual

3. PRODUCT OVERVIEW

The Uineer M1LBS mouse features a sleek design with dual connectivity options (2.4G wireless and Bluetooth 5.1), adjustable DPI, silent click buttons, and a rechargeable battery. It is designed for comfortable and efficient use across various devices.



Figure 3.1: Uineer M1LBS Wireless Mouse (Gold). This image displays the top-down view of the gold-colored mouse, highlighting its ergonomic shape and the integrated LED strip along the sides.

DURABLE DESIGN

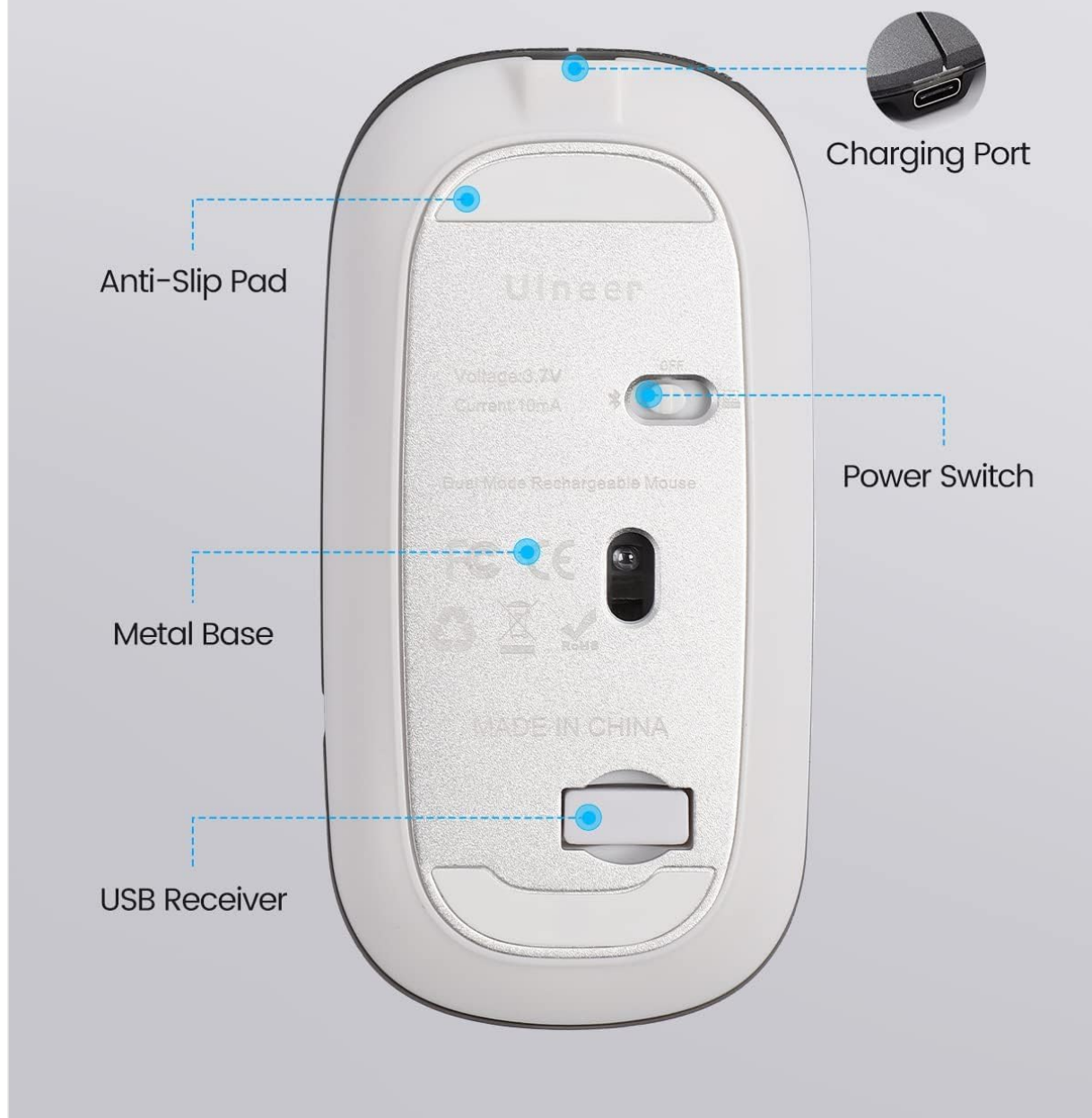

Figure 3.2: Bottom View and Components. This image shows the underside of the mouse, indicating the charging port, anti-slip pads, power switch, and the compartment for the USB receiver.

4. SETUP

4.1 Charging the Mouse

Before first use, it is recommended to fully charge the mouse. Connect the provided USB charging cable to the mouse's charging port and to a USB power source (e.g., computer, power bank, wall charger). The LED indicator will show charging status and turn off when fully charged.

RECHARGEABLE WIRELESS MOUSE

Built-in 500mAh rechargeable battery, no need to replace.
Convenient and energy saving



Laptop



Power Bank



WallCharger



Figure 4.1: Charging the Mouse. This image illustrates the mouse connected via its USB charging cable to a power source, with icons representing compatible charging methods like laptops, power banks, and wall chargers.

4.2 Connecting via 2.4G Wireless (USB Receiver)

1. Locate the USB Nano Receiver in the compartment on the bottom of the mouse.
2. Insert the USB Nano Receiver into an available USB port on your computer.
3. Slide the power switch on the bottom of the mouse to the '2.4G' position (indicated by a USB icon).
4. The mouse will automatically connect to your computer.

4.3 Connecting via Bluetooth 5.1

1. Slide the power switch on the bottom of the mouse to the 'Bluetooth' position (indicated by a Bluetooth icon).
2. On your computer or device, open Bluetooth settings.

3. Search for new devices. The mouse should appear as 'Uineer Mouse' or similar.
4. Select the mouse to pair. Once paired, the connection is established.

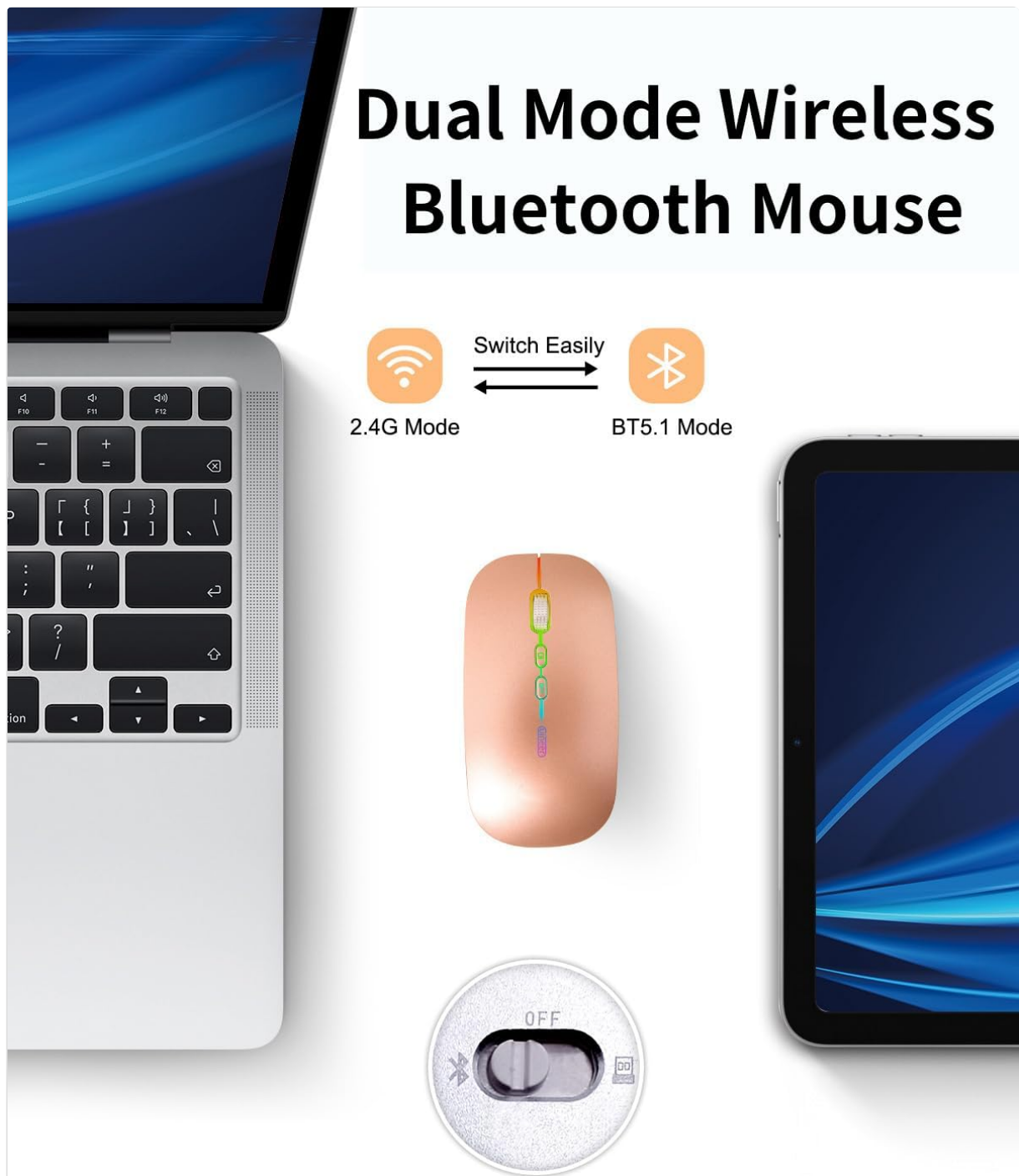

Figure 4.2: Dual Mode Connection. This diagram illustrates how to switch between 2.4G wireless mode (using the USB receiver) and Bluetooth 5.1 mode, showing connectivity to a laptop and a tablet.

5. OPERATING INSTRUCTIONS

5.1 Power On/Off and Mode Switching

Use the switch on the bottom of the mouse to select your desired connection mode (2.4G or Bluetooth) or to turn the mouse off. The middle position is 'OFF'.

5.2 Adjusting DPI Sensitivity

The mouse features 3 adjustable DPI levels (800/1200/1600). Press the 'DPI' button located on the top of the mouse, below the scroll wheel, to cycle through the sensitivity settings. Each press changes the cursor speed, allowing you to customize it to your preference.

3 Levels DPI

can freely adjust based on your needs



Figure 5.1: DPI Adjustment. This graphic visually represents the three adjustable DPI levels (800, 1200, 1600) and how they affect cursor sensitivity, with the mouse positioned centrally.

5.3 Silent Click Feature

The Uineer M1LBS mouse is designed with silent click buttons, reducing operational noise by approximately 90% compared to traditional mice. This feature is ideal for quiet environments such as libraries, offices, or late-night use.

Silent Click

work without disturbing those around you



Figure 5.2: Silent Click Operation. This image depicts the mouse in use near a sleeping baby, emphasizing its silent click feature that allows work without disturbing others.

5.4 LED Lighting

The mouse features a colorful breathing LED light effect that cycles slowly. This aesthetic feature can be turned on or off by a long press of the DPI button. The lights do not affect the mouse's functionality.

6. MAINTENANCE

- Clean the mouse regularly with a soft, dry cloth. Avoid using harsh chemicals or abrasive materials.
- Keep the mouse away from liquids and extreme temperatures.
- Store the USB Nano Receiver in its designated compartment on the bottom of the mouse when not in use to prevent loss.

- Charge the mouse when the battery is low to ensure continuous operation.

7. TROUBLESHOOTING

Problem	Solution
Mouse not responding	<p>Ensure the mouse is powered on and the correct mode (2.4G/Bluetooth) is selected.</p> <p>Check battery level and charge if necessary.</p> <p>For 2.4G mode, ensure the USB receiver is securely plugged in.</p> <p>For Bluetooth mode, ensure Bluetooth is enabled on your device and the mouse is paired.</p> <p>Try restarting your computer.</p>
Cursor movement is erratic or slow	<p>Clean the optical sensor on the bottom of the mouse.</p> <p>Ensure you are using the mouse on a suitable surface (non-reflective, opaque).</p> <p>Adjust the DPI sensitivity using the DPI button.</p>
Cannot pair via Bluetooth	<p>Ensure the mouse is in Bluetooth mode.</p> <p>Make sure your device's Bluetooth is on and discoverable.</p> <p>Remove any previous pairings of the mouse from your device's Bluetooth list and try pairing again.</p> <p>Ensure the mouse is within the effective Bluetooth range (typically 10 meters).</p>
LED lights are off	<p>Perform a long press on the DPI button to toggle the LED lights on/off.</p>

8. SPECIFICATIONS

Feature	Detail
Model	M1LBS
Connectivity	Bluetooth 5.1, 2.4G Wireless (USB Receiver)
DPI Levels	800 / 1200 / 1600
Battery Type	Rechargeable Lithium Polymer (500mAh)
Charging Port	USB (cable included)
Silent Click	Yes
LED Lighting	Colorful Breathing LED
Product Dimensions	3.94 x 1.97 x 0.04 inches
Item Weight	2.79 ounces
Compatibility	Windows, Mac OS, Laptop, Desktop, MacBook

9. WARRANTY AND SUPPORT

Uineer products are designed for reliability and performance. For specific warranty information, please refer to the warranty card included with your purchase or visit the official Uineer website. For technical support or further assistance, please contact Uineer customer service through the retailer where the product was purchased or visit the [Uineer Brand Store](#).