

## Maxcio ZigbeeGateway

# Maxcio Zigbee Hub Gateway User Manual

Model: ZigbeeGateway

## 1. INTRODUCTION

The Maxcio Zigbee Hub Gateway serves as a central bridge for your smart home devices, enabling seamless communication between Zigbee-enabled products and your Wi-Fi network. This manual provides comprehensive instructions for setting up, operating, maintaining, and troubleshooting your gateway, ensuring optimal performance and integration with your smart home ecosystem.

## 2. PRODUCT OVERVIEW

The Maxcio Zigbee Hub Gateway is a compact and efficient device designed to extend the capabilities of your smart home. It acts as a translator, allowing Zigbee devices to communicate with your Wi-Fi network and be controlled via compatible applications like the Maxcio app or Smart Life app, as well as voice assistants such as Amazon Alexa and Google Assistant.

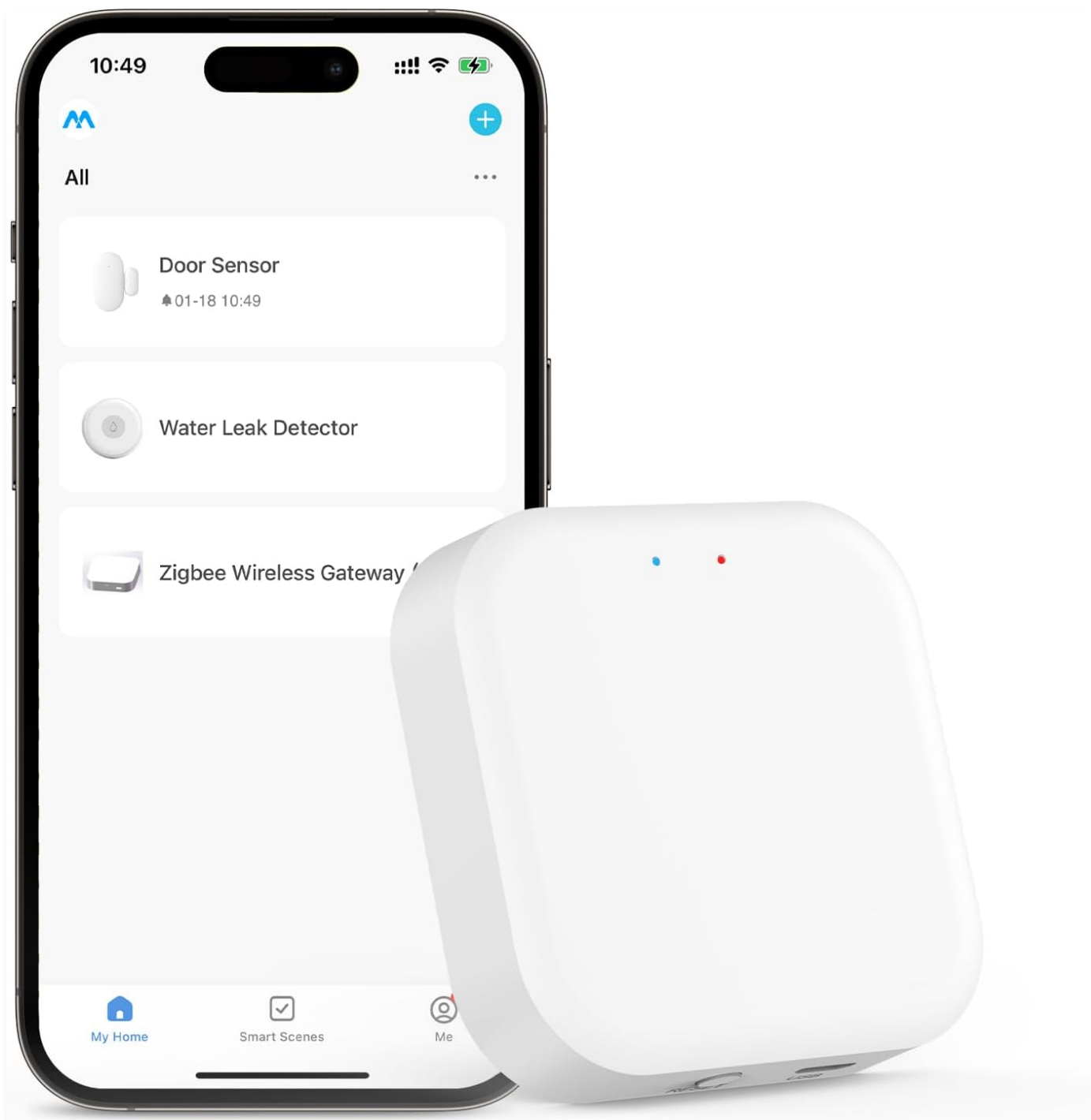

Figure 2.1: Maxcio Zigbee Hub Gateway with smartphone app interface.

### 3. FEATURES

- **Broad Compatibility:** Exclusively designed for seamless compatibility with Maxcio smart home devices (e.g., water leak detectors, temperature and humidity sensors, door sensors) and also compatible with all Tuya ZigBee smart products.
- **Stable and Reliable Wireless Networking:** Provides wide Wi-Fi signal coverage, ensuring stable and reliable operation for all connected devices. Operates on the 2.4GHz Wi-Fi frequency band.
- **Remote Control:** Supports adding, resetting, third-party control, and group control of devices via the Maxcio app, allowing remote monitoring from your smartphone.
- **Easy Installation:** User-friendly setup requiring no network cables. Simply power on the hub and connect it to the Maxcio app for quick automation.
- **Voice Control:** Integrates with Amazon Alexa and Google Assistant, enabling voice commands for device control

and smart linkage with other smart devices.

# Compatible with Alexa & Google Assistant

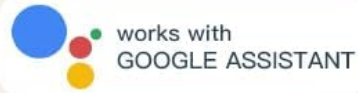

Alexa, Is my window closed?

Yes, the window is closed.



Figure 3.1: Voice control capabilities with Alexa and Google Assistant.

## 4. PACKAGE CONTENTS

Upon opening the package, verify that all components are present and in good condition:

- Maxcio Zigbee Hub Gateway
- USB Cable
- User Manual (this document)



Figure 4.1: Package contents including the gateway and USB cable.

## 5. SETUP INSTRUCTIONS

Follow these steps to set up your Maxcio Zigbee Hub Gateway:

1. **Power On:** Connect the provided USB cable to the gateway and plug the other end into a USB power supply (e.g., a power brick or USB port). The device will power on.
2. **App Installation:** Scan the QR code in the included small instruction manual or search for "Maxcio app" or "Smart Life app" in your device's app store (iOS/Android) and install it.
3. **Account Login:** Open the installed app and sign in to your account. If you don't have one, register for a new account.
4. **Add Gateway:** In the app, navigate to the "Add Device" section, then select "Gateway Control," and choose "Wireless Gateway (Zigbee)."
5. **Network Configuration:** Input your Wi-Fi password. Ensure your Wi-Fi network is operating on the 2.4GHz frequency band, as the Zigbee hub only supports this band.
6. **Pairing Mode:** Press and hold the "RESET" button on the gateway for approximately 5 seconds until the red light on the device flashes rapidly. This indicates it is in pairing mode.
7. **Complete Pairing:** The app should automatically detect and pair with the gateway. Follow any on-screen prompts to complete the process.
8. **Firmware Update:** If prompted by the app, perform any available firmware updates to ensure optimal performance and access to the latest features.

# How to Connect the Gateway Hub?



Step 1: Power ON

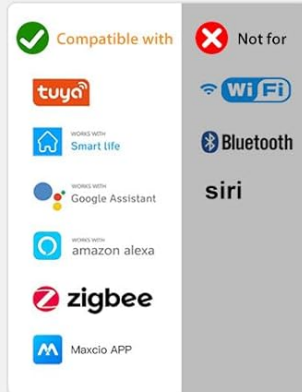

Step 2: Open the supported app, and sign in your account

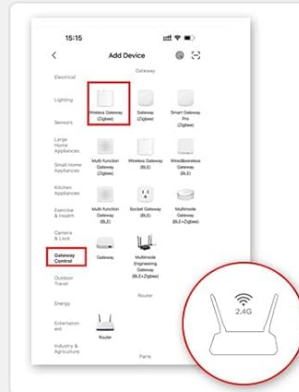

Step 3: Add the gateway and input the wifi password (make sure it's 2.4G wifi)



Step 4: Press and hold the "reset" button for 5 seconds until the red light flash fast, then pairing

# How to Connect with Other device?

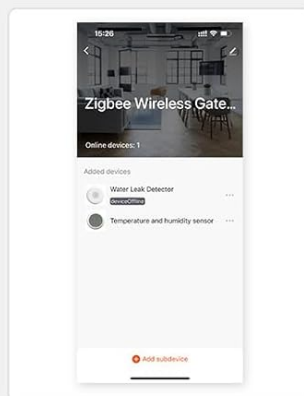

Step 1: Enter the gateway page

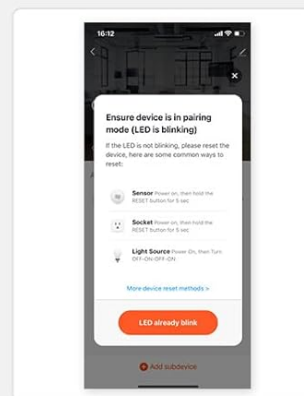

Step 2: Follow the tips and add the relevant device

Figure 5.1: Visual guide for connecting the gateway hub.

## 6. OPERATING INSTRUCTIONS

Once your Maxcio Zigbee Hub Gateway is set up, you can begin controlling your smart devices:

### 6.1 Connecting Other Devices

To add other Zigbee smart devices (e.g., door sensors, water leak detectors, temperature/humidity sensors) to your gateway:

1. **Enter Gateway Page:** In the Maxcio or Smart Life app, navigate to the gateway's dedicated page.
2. **Add Device:** Follow the on-screen tips within the app to add the relevant Zigbee device. This typically involves putting the new device into pairing mode as per its own instructions.



Figure 6.1: Compatible smart devices that can be connected to the gateway.

## 6.2 Remote Control via App

The Maxcio app allows you to remotely control and monitor your connected smart devices from anywhere with an internet connection. You can add devices, reset them, control them individually or in groups, and check their status in real-time.

### How to Connect the Gateway Hub?

Step 1: Plug the cable for power ON

Step 2: Open the supported app, and sign in your account

Step 3: Add the gateway and input the wifi password (make sure it's 2.4G wifi)

Step 4: Press and hold the "reset" button for 5 seconds until the red light flash fast, then pairing

### How to Connect with Other device?

Step 1: Enter the gateway page

Step 2: Follow the tips and add the relevant device

Figure 6.2: Remote control functionality through the app.

## 6.3 Voice Control

Integrate your Maxcio Zigbee Hub Gateway with Amazon Alexa or Google Assistant for convenient voice control of your smart devices. Once linked, you can use voice commands to operate lights, adjust blinds, or check the status of sensors.

## 6.4 Smart Linkage and Automation

Create smart scenes and automations within the app to enhance your home's intelligence. For example, you can set a routine for lights to turn on when a door sensor is triggered, or have your blinds open at a specific time.



Figure 6.3: Smart linkage capabilities within a home environment.

## 7. MAINTENANCE

To ensure the longevity and optimal performance of your Maxcio Zigbee Hub Gateway:

- Keep the device clean and free from dust. Use a soft, dry cloth for cleaning.
- Avoid exposing the device to extreme temperatures, humidity, or direct sunlight.
- Do not attempt to disassemble or repair the device yourself. Refer to qualified personnel for any issues.
- Ensure the USB cable is not bent or damaged, as this can affect power supply.

## 8. TROUBLESHOOTING

If you encounter issues with your Maxcio Zigbee Hub Gateway, refer to the following common problems and solutions:

Problem	Possible Cause	Solution
Gateway fails to pair with the app.	Incorrect pairing mode, Wi-Fi issues, or temporary glitch.	<p>Ensure the gateway's red light is flashing rapidly (pairing mode).</p> <p>Verify your smartphone is connected to a 2.4GHz Wi-Fi network.</p> <p>Press and hold the "RESET" button on the gateway for 5 seconds to re-enter pairing mode.</p> <p>Restart the app and try pairing again.</p>
Connected devices are unresponsive or offline.	Weak Zigbee signal, Wi-Fi interference, or device battery low.	<p>Ensure the gateway is within optimal range of your Zigbee devices.</p> <p>Check for Wi-Fi interference and try repositioning the gateway or router.</p> <p>Verify the batteries in your Zigbee devices are not depleted.</p>

Problem	Possible Cause	Solution
Voice control not working.	Incorrect linking with Alexa/Google Assistant, or device naming issues.	<p>Confirm the Maxcio/Smart Life skill/action is enabled in your Alexa/Google Home app.</p> <p>Ensure device names in the app are consistent and easily recognizable by voice assistants.</p> <p>Try re-linking the Maxcio/Smart Life account in your voice assistant app.</p>

## 9. SPECIFICATIONS

Attribute	Value
Brand	Maxcio
Model Number	ZigbeeGateway
Item Weight	2.39 ounces
Product Dimensions	2.5 x 2.5 x 0.6 inches
Color	White
Included Components	USB cable
Batteries Included?	No
Batteries Required?	No
Date First Available	November 27, 2023

## 10. WARRANTY AND SUPPORT

Information regarding product warranty and customer support is typically provided with your purchase documentation or on the manufacturer's official website. Please refer to those resources for details on warranty coverage, technical assistance, and contact information.