

HOFTRONIC 2707699

HOFTRONIC Huron Classic E27 LED Wall Light with Motion Sensor

Model: 2707699 | Brand: HOFTRONIC

1. INTRODUCTION

Thank you for choosing the HOFTRONIC Huron Classic E27 LED Wall Light with Motion Sensor. This outdoor wall light is designed to provide reliable illumination with the added convenience of motion detection. Its robust construction and IP44 rating ensure durability and performance in various outdoor conditions. This manual provides essential information for safe installation, operation, and maintenance of your new wall light.



Image 1.1: The HOFTRONIC Huron Classic E27 LED Wall Light, showcasing its traditional design and integrated motion sensor.

2. SAFETY INFORMATION

Please read all safety instructions carefully before installation and use. Failure to follow these instructions may result in electric shock, fire, or other hazards.

- **Electrical Safety:** Installation must be performed by a qualified electrician or competent person in accordance with local electrical codes and regulations. Always disconnect power at the main circuit breaker before installation or maintenance.
- **Voltage:** Ensure the supply voltage matches the product's specified voltage (230 Volts).
- **Mounting:** Mount the fixture securely on a stable surface. Do not install on unstable or vibrating surfaces.
- **Environment:** This product is rated IP44 for outdoor use, protecting against splashes of water and solid objects larger than 1mm. Do not submerge in water.
- **Bulb Type:** Use only E27 bulbs with a maximum power of 70W. Ensure the bulb is correctly seated before restoring power.

3. PACKAGE CONTENTS

Verify that all components are present before beginning installation:

- 1x HOFTRONIC Huron Wall Light fixture with integrated motion sensor
- Mounting screws
- Wall plugs
- Allen key

*Note: An E27 light bulb is **not included** and must be purchased separately.*

4. SETUP AND INSTALLATION

Follow these steps for proper installation of your wall light:

1. **Prepare the Installation Area:** Choose a suitable outdoor location for wall mounting. Ensure the surface is flat and capable of supporting the fixture's weight. Disconnect power at the main circuit breaker.
2. **Mark Drilling Points:** Hold the mounting bracket against the wall at the desired installation height. Use a pencil to mark the drilling points for the screws.
3. **Drill Holes:** Drill holes at the marked points using an appropriate drill bit for your wall material. Insert the wall plugs into the drilled holes.
4. **Connect Wiring:** Carefully connect the electrical wires from your mains supply to the terminal block inside the fixture. Ensure correct polarity (Live, Neutral, Earth). Secure all connections.
5. **Mount the Fixture:** Align the fixture with the drilled holes and secure it to the wall using the provided screws. Ensure the fixture is firmly attached.
6. **Install E27 Bulb:** Carefully screw an E27 bulb (max 70W) into the lamp holder.
7. **Restore Power:** Once installation is complete and all connections are secure, restore power at the main circuit breaker.



Image 4.1: Product dimensions for installation planning. The light measures 17cm (L) x 21.5cm (W) x 37.5cm (H).



Image 4.2: Detailed view of the fixture's construction, highlighting the robust aluminum and glass components.

5. OPERATING INSTRUCTIONS: MOTION SENSOR ADJUSTMENT

The integrated motion sensor is fully adjustable to suit your specific needs. The sensor controls are located at the bottom of the fixture's base.

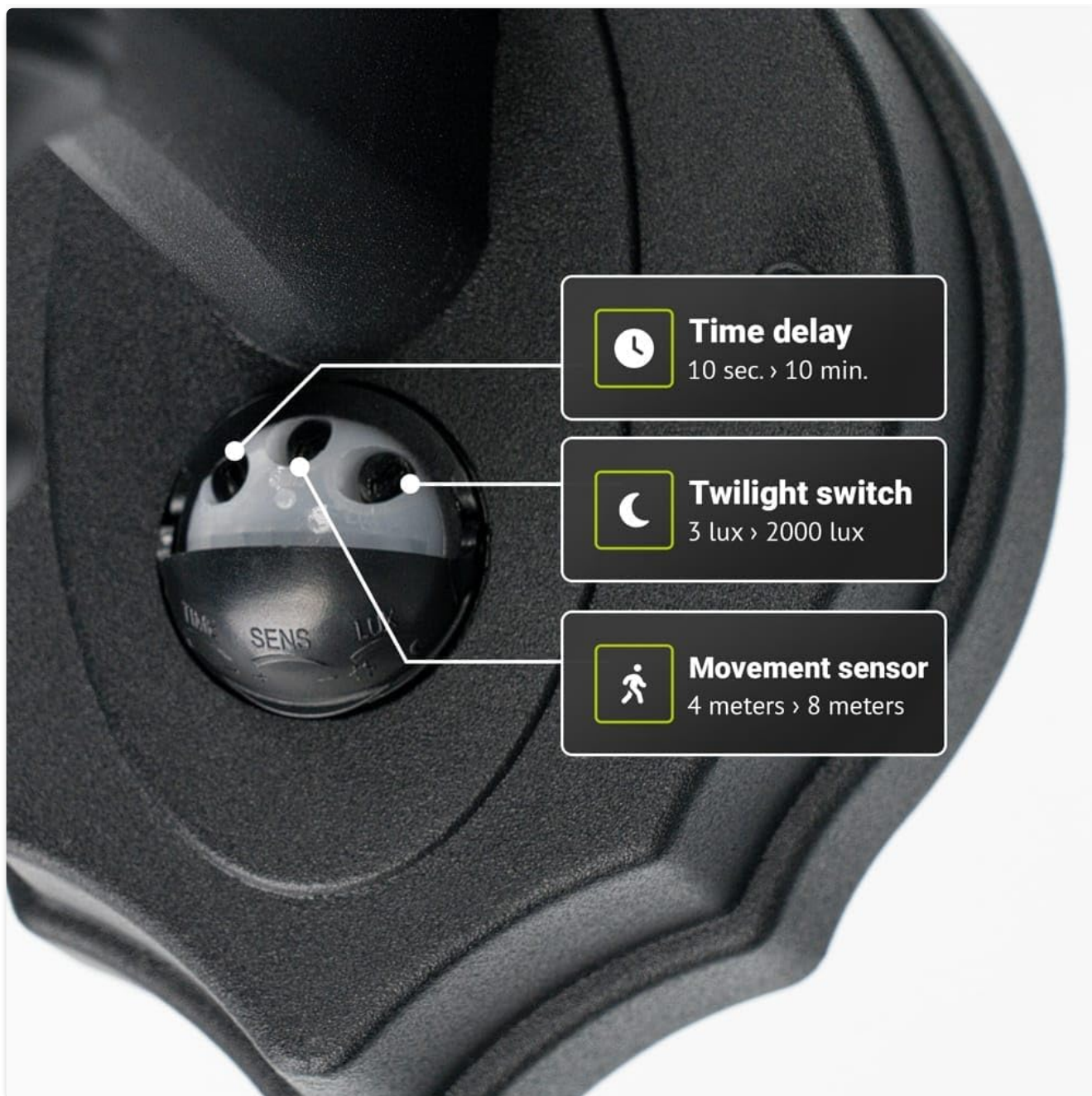

Image 5.1: The adjustable dials for the motion sensor, controlling time delay, twilight sensitivity, and detection range.

- **Time Delay (TIME):** This dial adjusts how long the light remains on after motion is detected and then stops. The delay time can be set between 5 seconds and 5 minutes.
- **Twilight Switch (LUX):** This dial determines the ambient light level at which the sensor becomes active. You can set it to activate the light only in darkness (e.g., 3 lux) or during brighter conditions (up to 2000 lux).
- **Movement Sensor Range (SENS):** This dial adjusts the detection distance of the motion sensor. The detection range can be set between 4 and 8 meters, with a 120-degree detection angle.

Adjust these dials using a small screwdriver or the provided Allen key to achieve your desired settings. Test the settings after each adjustment to ensure optimal performance.

6. MAINTENANCE

Regular maintenance ensures the longevity and optimal performance of your HOFTRONIC Huron wall light.

- **Cleaning:** Clean the fixture periodically with a soft, damp cloth. Do not use abrasive cleaners or solvents, as these can damage the finish or glass. Ensure the power is off before cleaning.

- **Bulb Replacement:** Disconnect power before replacing the E27 bulb. Allow the old bulb to cool down completely before removing it. Screw in the new E27 bulb firmly but gently.
- **Inspection:** Periodically check the fixture for any signs of damage, loose connections, or wear. If any issues are found, disconnect power and consult a qualified electrician.



Image 6.1: The IP44 rating ensures the light is protected against various outdoor elements, including rain, heat, and cold.

7. TROUBLESHOOTING

If you encounter issues with your wall light, refer to the following common problems and solutions:

- **Light does not turn on:**
 - Check if the power supply is connected and the circuit breaker is on.
 - Ensure the E27 bulb is correctly installed and not faulty.
 - Adjust the 'LUX' (Twilight Switch) setting on the sensor; it might be set too high for current ambient light.
- **Light stays on constantly:**

- Check the 'TIME' (Time Delay) setting; it might be set to its maximum duration.
- Ensure there is no continuous motion within the sensor's detection range.
- **Motion sensor is not detecting movement:**
 - Adjust the 'SENS' (Movement Sensor Range) setting to increase sensitivity.
 - Ensure there are no obstructions blocking the sensor's field of view.
 - Verify the 'LUX' setting is appropriate for the current light conditions.

If problems persist after attempting these solutions, please contact customer support.







8. SPECIFICATIONS

Feature	Specification
Brand	HOFTRONIC
Model Number	2707699
Dimensions (L x W x H)	17 x 21.5 x 37.5 cm
Weight	5 Kilograms
Material	Aluminum, Glass
Color	Black
Voltage	230 Volts
Bulb Socket	E27
Max. Bulb Wattage	70W
IP Rating	IP44 (Waterproof and Rustproof)
Motion Sensor Angle	120 degrees
Motion Sensor Range	4 - 8 meters
Motion Sensor Time Delay	5 seconds - 5 minutes
Installation Type	Wall Mount
Specific Uses	Indoor and Outdoor use

9. WARRANTY AND SUPPORT

HOFTRONIC products are manufactured to high-quality standards. This product comes with a standard manufacturer's warranty against defects in materials and workmanship. For specific warranty terms and conditions, please refer to the documentation provided at the time of purchase or contact HOFTRONIC customer service. For technical support, troubleshooting assistance, or warranty claims, please contact your retailer or visit the official HOFTRONIC website for contact information.

Related Documents - 2707699

	<p>Hoftronic Blenda PIR Sensor LED Wall Light User Manual</p> <p>This user manual provides comprehensive instructions for the Hoftronic Blenda PIR Sensor LED Wall Light (SKU 5427015). It covers essential safety details, installation procedures, and operational adjustments for timer settings, sensor sensitivity, and detection range. The manual also includes guidance on switching to manual mode and environmental protection information, presented in English, German, and Dutch.</p>
	<p>Hoftronic Huron PIR Sensor LED Wall Light - Installation Manual</p> <p>Comprehensive installation guide for the Hoftronic Huron PIR Sensor LED Wall Light. Covers essential safety instructions, intended use, detailed mounting procedures with textual descriptions of diagrams, functional characteristics, usage guidelines, maintenance, environmental protection information, and important comments. This manual is primarily in English, with references to other languages.</p>
	<p>HOFTRONIC Ceiling Light with CCT & Remote User Manual</p> <p>User manual for the HOFTRONIC Ceiling Light with CCT and Remote control. Includes important safety details, installation instructions, functional characteristics, usage guidelines, maintenance, and environmental protection information.</p>
	<p>Hoftronic Selma PIR Sensor LED Wall Light - Installation Guide</p> <p>Installation manual for the Hoftronic Selma PIR Sensor LED Wall Light, detailing safety, mounting, usage, and maintenance instructions for indoor and outdoor use.</p>
	<p>HOFTRONIC Rome Dimmable LED Downlight User Manual Installation & Safety Guide</p> <p>User manual for the HOFTRONIC Rome Dimmable LED Downlight (SKUs 4400316, 4400323, 4400330). Provides essential safety instructions, detailed installation guidance, technical specifications, usage tips, maintenance advice, environmental considerations, and declaration of conformity. Features include dimmability, IP44 rating, and a 5-year warranty.</p>
	<p>Hoftronic Dally PIR Sensor LED Pathway Light Installation Guide</p> <p>Official installation guide for the Hoftronic Dally PIR Sensor LED Pathway Light. Includes safety precautions, mounting instructions, functional details, maintenance advice, and environmental disposal information.</p>