

GROWATT SPH 5000TL3 BH UP

Growatt SPH 5000TL3 BH UP VDE Approved Hybrid Inverter User Manual

Model: SPH 5000TL3 BH UP | Brand: GROWATT

[Introduction](#) [Safety Information](#) [Product Overview](#) [Setup & Installation](#) [Operating Instructions](#) [Maintenance](#) [Troubleshooting](#) [Specifications](#) [Warranty & Support](#)

1. INTRODUCTION

This manual provides comprehensive instructions for the installation, operation, and maintenance of the Growatt SPH 5000TL3 BH UP Hybrid Inverter. Please read this manual thoroughly before installation and operation to ensure proper use and safety.

The compact Growatt SPH 5000TL3 BH UP inverter features a maximum PV power of 7500 W and a 2 MPP tracker. It boasts a maximum efficiency of 97.2%. The OLED touchscreen allows for simple and modern operation. The device offers 24-hour self-consumption monitoring and is suitable for photovoltaic installations in residential settings.

Key Features:

- 100% three-phase unbalanced output
- Intelligent phase-level power export limitation
- Wide battery voltage range: 100-550 V
- UPS function, 10ms transition
- VPP interface ready

2. SAFETY INFORMATION

Important Safety Instructions: Read and follow all instructions carefully. Keep this manual for future reference.

- Installation must be performed by qualified personnel only.
- Ensure all electrical connections comply with local and national electrical codes.
- Do not attempt to repair the inverter yourself. Refer all servicing to qualified service personnel.

- Disconnect all power sources before performing any maintenance or installation procedures.
- The inverter can generate high voltages and currents. Exercise extreme caution.
- Ensure proper grounding of the inverter.
- Do not operate the inverter if it has been physically damaged or if any components are missing.

3. PRODUCT OVERVIEW

The Growatt SPH 5000TL3 BH UP is a hybrid inverter designed for photovoltaic systems, capable of managing solar power generation, battery storage, and grid interaction. It features a robust design and an intuitive OLED touchscreen for monitoring and control.



Figure 3.1: Growatt SPH 5000TL3 BH UP Hybrid Inverter with accompanying Smart Meter and Data Logger. The inverter is a white and black rectangular unit, while the smart meter is a white rectangular device and the data logger is a black cylindrical device.



Figure 3.2: Front view of the Growatt SPH 5000TL3 BH UP Hybrid Inverter. The inverter features a prominent Growatt logo at the top, a black lower section with a green-lit OLED display and control buttons labeled 'ESC', 'OK', and arrow keys.

Components:

- **Inverter Unit:** The main device responsible for converting DC power from solar panels to AC power for home use or grid export, and managing battery charging/discharging.
- **OLED Touchscreen Display:** Provides real-time operational data, system status, and allows for configuration adjustments.
- **Control Buttons:** Used for navigating the menu and confirming selections on the OLED display.
- **PV Input Terminals:** Connections for solar panel strings.
- **Battery Terminals:** Connections for the battery bank.
- **AC Output/Grid Connection:** Connection for household loads and the utility grid.
- **Communication Ports:** For monitoring and external device connections (e.g., RS485, CAN/USB).
- **Smart Meter (Optional/Included):** For precise energy measurement and export limitation.
- **Data Logger (Optional/Included):** For remote monitoring and data collection.

4. SETUP & INSTALLATION

Proper installation is crucial for the safe and efficient operation of your Growatt SPH 5000TL3 BH UP inverter. This section provides a general overview; refer to the detailed installation guide provided with your product for specific wiring diagrams and procedures.

4.1 Site Selection

- Choose a cool, dry, and well-ventilated location.
- Avoid direct sunlight exposure.
- Ensure adequate clearance around the inverter for heat dissipation.
- Mount on a sturdy, non-flammable surface.
- The inverter is designed for indoor photovoltaic installations in residential settings.

4.2 Mounting the Inverter

Securely mount the inverter to a wall using appropriate mounting brackets and hardware. Ensure it is level and firmly attached.

4.3 Electrical Connections

All electrical wiring must be performed by a certified electrician in accordance with local and national electrical codes.

1. **PV Input Connection:** Connect the DC cables from your solar panels to the PV input terminals. Ensure correct polarity.
2. **Battery Connection:** Connect the battery cables to the battery terminals. Observe correct polarity and ensure the battery voltage is within the specified range (100-550 V).
3. **AC Output/Grid Connection:** Connect the AC output to your household electrical panel and the utility grid. This inverter supports 100% three-phase unbalanced output.
4. **Grounding:** Ensure the inverter chassis is properly grounded.
5. **Communication Connections:** Connect the smart meter and data logger (if included) to the appropriate communication ports for monitoring and intelligent power export limitation.

5. OPERATING INSTRUCTIONS

Once installed and all connections are verified, you can power on your Growatt SPH 5000TL3 BH UP inverter.

5.1 Powering On

1. Ensure all DC and AC breakers are in the OFF position.
2. Turn on the DC disconnect switch for the solar panels.
3. Turn on the battery disconnect switch.
4. Turn on the AC breaker for the inverter output.
5. The inverter will perform a self-test and then begin operation.

5.2 OLED Touchscreen Display

The OLED touchscreen provides real-time information and allows for system configuration. Use the 'ESC', 'OK', and arrow buttons to navigate the menus.



Figure 5.1: Angled view of the Growatt SPH 5000TL3 BH UP Hybrid Inverter, highlighting the OLED display and control buttons. The display shows "Hybrid" and "Normal" status.

Common Display Information:

- PV Power (W)
- Battery State of Charge (SOC %)
- Load Power (W)
- Grid Power (W) - import/export
- System Status (e.g., Normal, Fault, Standby)
- Daily/Total Energy Generation (kWh)

5.3 System Modes

The inverter operates in various modes to optimize energy flow, including self-consumption, grid-tied with export, and off-grid (UPS function).

- **Self-Consumption:** Prioritizes using solar power for household loads, then charging batteries, and finally exporting excess to the grid.
- **Backup Mode (UPS Function):** In case of grid failure, the inverter can provide power from the battery to critical loads with a 10ms transition time.
- **Export Limitation:** The intelligent phase-level power export limitation feature ensures compliance with

local grid regulations.

6. MAINTENANCE

Regular maintenance ensures the longevity and optimal performance of your Growatt inverter. Always disconnect all power sources before performing any maintenance.

- **Periodic Inspection:** Visually inspect the inverter and all connections for any signs of damage, corrosion, or loose wiring at least once every six months.
- **Cleaning:** Keep the inverter's ventilation openings clear of dust and debris to ensure proper airflow and cooling. Use a soft, dry cloth for cleaning the exterior. Do not use liquid cleaners.
- **Firmware Updates:** Check the Growatt website or contact support for available firmware updates to ensure your inverter has the latest features and bug fixes.
- **Battery Health:** If connected to a battery system, monitor battery health and perform maintenance as recommended by the battery manufacturer.

7. TROUBLESHOOTING

This section provides solutions to common issues you might encounter. For problems not listed here or if issues persist, contact Growatt technical support.

Problem	Possible Cause	Solution
Inverter not powering on	No AC input, DC input, or battery connection; tripped breaker.	Check all breakers (AC, DC, battery). Verify all connections are secure. Ensure sufficient PV voltage and battery charge.
Low power output	Insufficient solar irradiance; dirty PV panels; shading; PV string issue.	Check weather conditions. Clean PV panels. Remove any shading. Inspect PV string connections and voltage.
Error code on display	Internal fault; grid issue; over-temperature.	Note the error code and refer to the detailed error code list in the full manual. Ensure proper ventilation. If persistent, contact support.
No grid export	Export limitation enabled; grid connection issue; smart meter fault.	Check export limitation settings on the display. Verify grid connection. Check smart meter status and connections.

8. SPECIFICATIONS

The following table outlines the key technical specifications for the Growatt SPH 5000TL3 BH UP Hybrid Inverter.

Datenblatt	SPH 4000TL3 BH-UP	SPH 5000TL3 BH-UP	SPH 6000TL3 BH-UP	SPH 7000TL3 BH-UP	SPH 8000TL3 BH-UP	SPH 10000TL3 BH-UP
Eingang (PV)						
Max. empfohlene PV-Leistung (für STC Module)	6000W	7500W	9000W	10500W	12000W	15000W
Max. DC-Spannung	1000V					
Startspannung	120V					
MPP-Spannungsbereich	120V-1000V/600V					
Anzahl von MPP-Trackern	2					
Anzahl der PV-Strings pro MPP-Tracker	1					
Max. Eingangsstrom pro MPP-Tracker	13.5A					
Max. Kurzschlussstrom pro MPP-Tracker	16.9A					
Ausgang (AC)						
AC-Nennleistung	4000W	5000W	6000W	7000W	8000W	10000W
Max. AC-Scheinleistung	4000VA	5000VA	6000VA	7000VA	8000VA	10000VA
AC-Nennspannung (Bereich)	230V/400V (310–476V)					
AC-Netzfrequenz (Bereich)	50Hz/60Hz (45Hz-55Hz/55Hz-65Hz)					
Max. Ausgangsstrom	6.1A	7.6A	9.1A	10.6A	12.1A	15.2A
Einstellbarer Leistungsaktor	0.8 kapazitiv...0.8 induktiv					
THDi	<3%					
AC-Netzanschlussart	3W+N+PE					
Batteriedaten (DC)						
Batteriespannungsbereich	100–550V					
Maximaler Lade- und Entladestrom	25A					
Kontinuierliche Lade- und Entladeleistung	4000W	5000W	6000W	7000W	8000W	10000W
Typ der Batterie	Lithium Akkumulator					
Backup Leistung (AC)						
Max. AC-Ausgangsleistung	4000W	5000W	6000W	7000W	8000W	10000W
Max. AC-Scheinleistung	4000VA	5000VA	6000VA	7000VA	8000VA	10000VA
Max. Ausgangsstrom	6.1A	7.6A	9.1A	10.6A	12.1A	15.2A
Nominale AC-Ausgangsspannung	230V/400V					
Nominale AC-Ausgangsfrequenz	50/60HZ					
THDv	<3%					
Umschaltzeit	<10ms					
Wirkungsgrad						
Max. Wirkungsgrad	97.6%	97.8%	98.0%	98.2%	98.2%	98.2%
Europäischer Wirkungsgrad	97.0%	97.2%	97.3%	97.4%	97.4%	97.5%
Schutzvorrichtungen						
DC-Schalter	Ja					
DC-Verpolungsschutz	Ja					
AC/DC-Überspannungsschutz	Typ II					
Batterieverpolungsschutz	Ja					
AC-Kurzschlussschutz	Ja					
Erdchlussüberwachung	Ja					
Überwachung des Netzes	Ja					
Inselschutz (Anti-Islanding-)Schutz	Ja					
Fehlerstrom-Überwachungseinheit	Ja					
Überwachung des Isolationswiderstandes	Ja					
Allgemeine Daten						
Abmessungen (B/H/T)	505/453/198mm					
Gewicht	30kg					
Betriebstemperaturbereich	-25 °C ... +60 °C					
Stromverbrauch in der Nacht	<13W					
Topologie	Transformatorlos					
Kühlung	Natürliche Konvektion					
Schutzklasse	IP65					
Relative Luftfeuchtigkeit	0–100%					
Höhenlage	3000m					
DC-Anschluss	H4 / MC4 (Optional)					
AC-Anschluss	Schraubklemmen					
Anzeige	LCD+LED					
Schnittstellen: RS485/CAN/USB	Ja					
Display: RF/WiFi/GPRS	Optional					
Garantie	10 Jahre					
CE, IEC62109, IEC 62040, VDE-AR-N 4105, VDE 0126, UTE C 15-712, C10/C11 , EN50549, CEI 0-21, CEI 0-16, IEC62116, IEC61727, AS/NZS 4777 , G98, TOR Erzeuger						

Figure 8.1: Detailed technical specifications table for the Growatt SPH 5000TL3 BH UP inverter, showing various electrical and physical parameters.

Feature	Detail
Brand	GROWATT
Model Name	SPH 5000TL3 BH UP
Item Model Number	20712

Feature	Detail
Manufacturer	Growatt
Recommended Product Uses	Solar power generation for domestic use or self-consumption
Power Source	Solar Energy
Output Power	7500 Watts (Max PV Power)
Efficiency	97.2 %
Display Type	Touch (OLED)
Peak Output Power (watts)	7500
Electrical Output Waveform	Pure Sine Wave
Battery Voltage Range	100-550 V
UPS Transition Time	10 ms
Date First Available on Amazon.com.be	November 20, 2023
Spare Parts Availability	Information unavailable
Software Updates Guaranteed Until	Information not available

9. WARRANTY & SUPPORT





9.1 Warranty Information

The Growatt SPH 5000TL3 BH UP Hybrid Inverter typically comes with a **10-year warranty**. Please refer to your purchase documentation or contact your supplier for specific warranty terms and conditions, as these may vary by region and distributor.

9.2 Technical Support

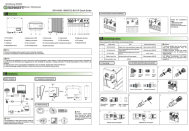
For technical assistance, troubleshooting beyond this manual, or warranty claims, please contact Growatt customer support or your authorized Growatt dealer. Have your inverter's model number (SPH 5000TL3 BH UP) and serial number ready when contacting support.

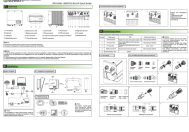
You can find more information and support resources on the official Growatt website: www.growatt.com

	Growatt SPH TL3 BH-UP Series Installation and Operation Manual Comprehensive guide for installing and operating the Growatt SPH TL3 BH-UP Series hybrid solar inverters and energy storage systems. Covers safety, product description, installation, commissioning, operation, maintenance, and specifications.
	Growatt SPH TL3 BH-UP Series Installation and Operation Manual This manual provides detailed product information and installation instructions for the Growatt SPH TL3 BH-UP Series hybrid inverters. It covers safety precautions, product descriptions, installation procedures, commissioning, operation modes, troubleshooting, and technical specifications.
	Growatt SPH TL3 BH-UP Serie: Installations- und Betriebsanleitung Umfassende Installations- und Betriebsanleitung für die Growatt SPH TL3 BH-UP Serie Hybrid-Wechselrichter. Enthält detaillierte Anleitungen, Sicherheitshinweise und Produktspezifikationen für sichere und effiziente Energieverwaltung.
	Growatt SPH 4000-10000TL3 BH-UP Hybrid Inverter Quick Guide Concise installation guide for the Growatt SPH 4000-10000TL3 BH-UP series hybrid solar inverter, detailing component identification, installation requirements, cable connections, grounding, post-installation checks, and status indicators.
	GROWATT SPH-UP Series Hybrid Inverter Installation Manual Comprehensive installation manual for GROWATT SPH-UP series hybrid inverters, detailing setup, safety, operation, and troubleshooting for professional installers.
	Growatt SPH 10000TL-HU-US Grid-Hybrid Inverter User Manual User manual providing detailed information on the Growatt SPH 10000TL-HU-US Grid-Hybrid Inverter, covering installation, operation, system configuration, and troubleshooting for optimal performance.

Documents - GROWATT – SPH 5000TL3 BH UP



Installation & Operation Manual

[\[pdf\]](#) User Manual Instructions Specifications Decleration of Conformity Label

Growatt SPH4 10KTL3 Residential Storage Inverter Instruction Manual Administrator manual internal 2024 03 |||

Installation Operation Manual Contents 1 Brief Introduction 1.1 Preface 1.2 Target Group 1.3 Product Description 1.4 Safety Instructions 2 Safety 2.1 Purpose Use 2.2 Safety Measure 2.3 Symbols introduction on the SPH inverter 3 Product Description 4 Unpacking 5 Installation 3.1 Growatt SPH...

lang:en score:47 filesize: 5.83 M page_count: 69 document date: 2024-03-09

[\[pdf\]](#) User Manual Installation Guide Instructions Troubleshooting Guide Specifications Decleration of Conformity Label

044 0088203 SPH4 10KTL3 BH UP 2024 1 8 cdr Administrator Installation Operation Manual

StralendgroenDanger to life due high voltage in SPH There is residual requires 5 minutes discharge Please wait before you open the SPH 4000 10000TL3 UP User EN 202401stralendgroen nl 2020 09 202401 srsltid AfmBOOp7xmfKc REw7u0J5MakKOpe7FT6 P0 NjL5mnLqx eT4zPwB0O

StralendgroenInstallation the Any modifications of Growatt new energy we will not notify the user TL3 inverter must be installed by professional electrical personnel who SPH 202401SPH eT4zPwB0Ostralendgroen AfmBOOo4jbQN8eFQevraVywInoMgUHIJfScMbIOqj4seq7VAfPfc9y1 who Installer can install storage machine Series rapidly and troubleshooting build communication system through read this manual SPH AfmBOOo4jbQN8eFQevraVywInoMgUHIJfScMbIOqj4seq7VAfPfc9y1stralendgroen

AfmBOOpFZslPnFPnERjkZUfr5npntvHNrzo3cZnBxpZflf l8lgZefDd l8lgZefDdstralendgroen

AfmBOOrBI8LlZgS2fphhnLmnoUjTnlct1Sz bO0ckCUOEApkLIERgRR2

bO0ckCUOEApkLIERgRR2stralendgroen AfmBOOrBimwkH

0msklIOOpBXDGT1Nka1mIUhy2iTtkFjcSEYgmDATX9 StralendgroenDownlodDanger manual Growatt

manual Download 2025SPH 0msklIOOpBXDGT1Nka1mIUhy2iTtkFjcSEYgmDATX9igrowattinverter 2025

02 0msklIOOpBXDGT1Nka1mIUhy2iTtkFjcSEYgmDATX9stralendgroen

AfmBOooexbJrv0fBjczNS6KgT8k5PPyHsvq5c6btcqcvwtHwJtbcDZnigrowattinverter

AfmBOooexbJrv0fBjczNS6KgT8k5PPyHsvq5c6btcqcvwtHwJtbcDZnstralendgroen

AfmBOoo9wctuJ1v4DfcD y10hiNQvl3BgaXfVbV2EFL6yQmxB99q2L7Yigrowattinverter

y10hiNQvl3BgaXfVbV2EFL6yQmxB99q2L7Ystralendgroen

AfmBOOpUVYypXrlBc0QA7Zv2UXI3wZfyx40lcrtgwuk2KSkqnEljcqeHigrowattinverter

AfmBOOpUVYypXrlBc0QA7Zv2UXI3wZfyx40lcrtgwuk2KSkqnEljcqeHstralendgroen

AfmBOOr7uG8g3XlrHOWuRFMnd2x34pxOUxBXs 1SPyjsue11A 3PAqLigrowattinverter

3PAqLstralendgroen AfmBOOr4IFC v5fdaXW O WhiDDqFbWemXGTq6zAwHnRs0ICbs

HxvJaigrowattinverter who have obtained certification relevant departments We have Growatt AfmBOOr

eWVT0xARnpWrtWGya 5YPSxNHuusoS0gG7VoeZb3kffS bZystralendgroen HxvJastralendgroen

AfmBOOpLsC6ExaTI5oLIO9sURJdkMVKQmYQBd5UJdu4ibtcT652vDj3Xigrowattinverter

AfmBOOpLsC6ExaTI5oLIO9sURJdkMVKQmYQBd5UJdu4ibtcT652vDj3Xstralendgroen

AfmBOOrM3l3B3uLPqkKU3L1ZMxOPQOoZcPjDCENlnbT6Z1wX3Yfps9xRigrowattinverter

AfmBOOpVyKTKdA cMAduC wbc01fBLzFmLldw1sEW er0Wwdu1 FL1Jcstralendgroen have Installer

AfmBOOpMy2AXyr1if9LAbAdizDi8PYhOXDZgDrktf4lz61nnKsrEJKsmstralendgroen

AfmBOOrzik3p5TLCcXzcq1OqSCiCxhzqMgmib3owFljulqfuuUH1jCF0stralendgroen

AfmBOOrDrPflbMcCoYMCpvWxcXYSpcHMQfd3O3ebf0YmAr 5ZmzZYDEuustralendgroen

AfmBOOrM3l3B3uLPqkKU3L1ZMxOPQOoZcPjDCENlnbT6Z1wX3Yfps9xRstralendgroen

AfmBOooMoYhHjmTwiSGFMo6qhGqEAcFiBHUt 7dEBUFotWopitFdySjdigrowattinverter manual This

provides detailed product information installation instructions for series which certified Growatt

AfmBOooKvMQrlWMj5sJqKaOkYex41uWW9wGR7cP8YWtuVwghOeJgLowystralendgroen

AfmBOoo4OEdr2HYVPwKbxCPnjT2kXPMJL23Mdk24l1XbA i7wKvnGSQWstralendgroen

AfmBOoq1HmVx 93zpdB0hCXk2tdXsgG4w GhhFyHYUBkt6XPY8KEwJVSstralendgroen ||| ||| Installation

Operation Manual Contents 1 Brief Introduction 1.1 Preface 1.2 Target Group 1.3 Product Description 1.4

Safety Instructions 2 Safety 2.1 Purpose Use 2.2 Safety Measure 2.3 Symbols introduction on the SPH

inverter 3 Product Desc ||| Installation Operation Manual Contents 1 Brief Introduction 1.1 Preface 1.2

Target Group 1.3 Product Description 1.4 Safety Instructions 2 Safety 2.1 Purpose Use 2.2 Safety

Measure 2.3 Symbols introduction on the SPH inverter 3 Product Desc ||| Installation Operation Manual

Contents 1 Brief Introduction 1.1 Preface 1.2 Target Group 1.3 Product Description 1.4 Safety Instructions

2 Safety 2.1 Purpose Use 2.2 Safety Measure 2.3 Symbols introduction on the SPH inverter 3 Product

Desc ||| Installation Operation Manual Contents 1 Brief Introduction 1.1 Preface 1.2 Target Group 1.3

Product Description 1.4 Safety Instructions 2 Safety 2.1 Purpose Use 2.2 Safety Measure 2.3 Symbols

introduction on the SPH inverter 3 Product Desc ||| Installation Operation Manual Contents 1 Brief

Introduction 1.1 Preface 1.2 Target Group 1.3 Product Description 1.4 Safety Instructions 2 Safety 2.1

Purpose Use 2.2 Safety Measure 2.3 Symbols introduction on the SPH inverter 3 Product Desc |||

Installation Operation Manual Contents 1 Brief Introduction 1.1 Preface 1.2 Target Group 1.3 Product

Description 1.4 Safety Instructions 2 Safety 2.1 Purpose Use 2.2 Safety Measure 2.3 Symbols

introduction on the SPH inverter 3 Product Desc ||| Installation Operation Manual Contents 1 Brief

Introduction 1.1 Preface 1.2 Target Group 1.3 Product Description 1.4 Safety Instructions 2 Safety 2.1

Purpose Use 2.2 Safety Measure 2.3 Symbols introduction on the SPH inverter 3 Product Desc |||

Installation Operation Manual Contents 1 Brief Introduction 1.1 Preface 1.2 Target Group 1.3 Product

Description 1.4 Safety Instructions 2 Safety 2.1 Purpose Use 2.2 Safety Measure 2.3 Symbols

introduction on the SPH inverter 3 Product Desc ||| Installation Operation Manual Contents 1 Brief

Introduction 1.1 Preface 1.2 Target Group 1.3 Product Description 1.4 Safety Instructions 2 Safety 2.1

Purpose Use 2.2 Safety Measure 2.3 Symbols introduction on the SPH inverter 3 Product Desc |||

Installation Operation Manual Contents 1 Brief Introduction 1.1 Preface 1.2 Target Group 1.3 Product



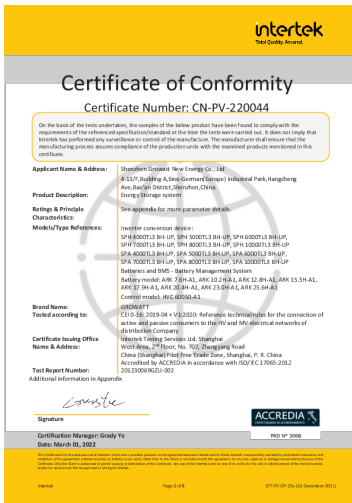

[pdf] Specifications Declaration of Conformity

GFT OP 11a ChXie Download Growatt SPH 7000TL3 BH UP 7kW Hybridwechselrichter 3 phasig 4000 10000TL3 CEI 0 16 b2b offgridtec media product attachements |||

Certificate of Conformity Certificate Number: CN-PV-220044 On the basis of the tests undertaken, the samples of the below product have been found to comply with the requirements of the referenced specification/standard at the time the tests were carried out. It does not imply that Intertek has per...

lang:en score:33 filesize: 306.71 K page_count: 6 document date: 2022-03-01



[pdf] Specifications Declaration of Conformity

GFT OP 11a ChXie Download Growatt SPH 6000TL3 BH UP 6kW Hybridwechselrichter 3 phasig 4000 10000TL3 CEI 0 21 offgridtec media product attachements |||

Certificate of Conformity Certificate Number: CN-PV-210174 On the basis of the tests undertaken, the samples of the below product have been found to comply with the requirements of the referenced specification/standard at the time the tests were carried out. It does not imply that Intertek has per...

lang:en score:33 filesize: 341.41 K page_count: 6 document date: 2021-07-16

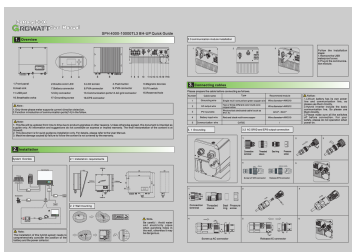

[pdf] User Manual Instructions Declaration of Conformity Label

044 0088200 Installation Manual of SPH4 10KTL3 BH UP series English 20210127 cdr Administrator as 60247353media hornbach lu hb ownersmanual 60247353 |||

Download Manual Growatt New Energy Shenzhen Growatt New Energy CO.,LTD No.28 Guangming Road, Shiyan Street, Bao an District, Shenzhen, P.R.China T 86 0755 2747 1942 E service ginverter.com W www.ginverter.com GR-UM-226-A-01 Installation Operation Manual Contents 1 Brief Introduction 1.1 ...

lang:en score:33 filesize: 4.8 M page_count: 9 document date: 2022-10-29

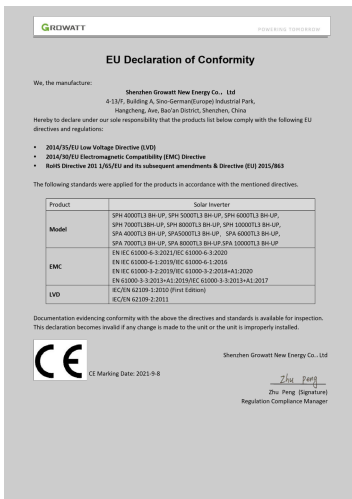

[pdf] Documentation Declaration of Conformity

Administrator EU Declaration SPH SPA 4 10KTL3 BH UP EN 202408 4000 10000TL3 Three Phase Hybrid Growatt en growatt upload file |||

EU Declaration of Conformity We, the manufacture: Shenzhen Growatt New Energy Co.Ltd 4-13/F, Building A, Sino-German Europe Industrial Park, Hangcheng, Ave, Bao an District, Shenzhen, China Hereby to declare under our sole responsibility that the products list below comply with the following EU di...

lang:en score:32 filesize: 169.89 K page_count: 1 document date: 2023-11-15

Ръководство на потребителя за инвертори Growatt SPH 4000TL3 BH-UP, Growatt SPH 5000TL3 BH-UP, Growatt SPH 6000TL3 BH-UP, Growatt SPH 7000TL3 BH-UP, Growatt SPH 8000TL3 BH-UP и Growatt SPH 10000TL3 BH-UP

1. Целева група на тема ръководство:

Няколко рута бивали трябвало да бъдат изгнани от суртфидриери поради некомпетентност, както и от съответните пакети на работата с административна *обслужованост*. Тя на улеснява криво в продължение на 10-15 минути, а в някои фидриери дори една. Използването на периферия на херо, както на суртфидриери от съответните разветвления изпитания. Използването на периферия на херо в бучен да се справя с аналитическите, суртнал и експертни на административна услуга.

[illegible]

II. Представление на устройството

Серията SPH TLS 38H-UP се използва за съхранение на енергия, т.е. електричество от панелите на фотонапреителните клетки или енергия от земята (заемане на енергия от батерията). Освен това енергията може да бъде изпратена към електрическата мрежа чрез SPH TLS 38H-UP или да използват SPH TLS 38H-UP за редовно захранване, а когато няма електричество захранване.

III. Ваажна информация и информации за безбедност и употреба:

- [illegible]

3

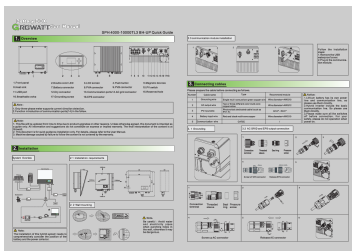

[\[pdf\]](#)

Ръководство на потребителя за SPH4000 10000TL3 BH UP Инвертор Growatt SPH 5000TL3

5000TL3BH JAR Computers 1653358930 jarcomputers images custom docs |||

Growatt SPH 4000TL3 BH-UP, Growatt SPH 5000TL3 BH-UP, Growatt SPH

6000TL3 BH-UP, Growatt SPH 7000TL3 BH-UP, Growatt SPH 8000TL3 BH-UP

Growatt SPH 10000TL3 BH-UP I. : Growatt , Growatt - . . , Growatt ...

lang:i-klinton score:32 filesize: 273.13 K page_count: 4 document date: 2022-03-30

[Growatt SPH TL3 BH-UP Series Installation and Operation Manual](#)

Comprehensive guide for installing and operating the Growatt SPH TL3 BH-UP Series hybrid solar inverters and energy storage systems. Covers safety, product description, installation, commissioning, operation, maintenance, and specifications.

lang:en score:31 filesize: 4.8 M page count: 9 document date: 2022-10-29

[\[pdf\]](#)

TC GCC DNVGL SE 0124 08048 0 Ulgård Liselotte CERTYFIKAT URZĄDZENIA Growatt Télécharger

24 mai 2022 — 1 Warunki Zmiany w projekcie systemu sprzęcie lub oprogramowaniu certyfikowanych

falowników PV muszą być zatwierdzone przez DNV Ensembles photovoltaïques prêts GROWATT

Onduleurs PVGroup pl Tout pour le photovoltaïque 08780 SPA SPH4000 10000TL3 BH UP growatt 05 |||

Tłumaczenie z j. angielskiego CERTYFIKAT URZDZENIA Nr wiadectwa:

Wystawionego: TC-GCC-DNVGL-SE-0124-08780-0 24 maj 2022 Wanego do: Bez

ogranicze Klasa GCC TCI Wystawionego dla: Falownikw PV SPA/SPH 4000-10000

TL3 BH-UP PPM Typ A Ze specyfikacjami i wersj oprogramowania wymienionymi w

zalcz...

lang:pl score:31 filesize: 285.32 K page_count: 5 document date: 2022-05-26

GFT OP 11a ChXie Download Baixar recursos úteis Growatt05813a7a984d431eccbc3ebe843aaf67br
growatt upload file 20220829 05813a7a984d431eccbc3ebe843aaf67 GrowattSPA 4000 10000TL3 BH
UP Onduleur à couplage AC Growatt979197309e38bdacadce40f28895d209br
05813a7a984d431eccbc3ebe843aaf67fr 979197309e38bdacadce40f28895d209 Growattbr
GrowattDownload 979197309e38bdacadce40f28895d209br GrowattDescargar Descargar útiles
979197309e38bdacadce40f28895d209latam 979197309e38bdacadce40f28895d209es SPA CEI 16SPA
Konut Tipi Depolama İnverter Growatttr 05813a7a984d431eccbc3ebe843aaf67latam GrowattTélécharger
Télécharger des ressources utiles 979197309e38bdacadce40f28895d209tr

lang:en score:30 filesize: 345.91 K page_count: 6 document date: 2022-03-01



3rd Party Service

Certificate of Conformity

Certificate Number: CN-PV-220004

On the basis of the test undertaken, the completion of the below program has been found to comply with the requirements of the information specification(s) as stated on the test form the tested product is. It does not imply that Intertek has performed any surveillance or control of the manufacturing. The beneficiaries of this certificate are the manufacturing process ensuring compliance of the production units with the examined products mentioned in this certificate.

Applicant Name & Address: Product Description: Rated/ & Specific Characteristics: Model/Type References:	Specification/ Test Program / CUL : 1. 21W, Building A, 2nd Floor, Guangming Industrial Park, Jiangtang Ave, Dongguan, China 2. Energy Efficiency system See appendices for more parameter details. Intertek examination device: SP4 EX002713 10-30V, SP4 EX000713 80-10V, SP4 EX000712 80-10V, SP4 EX000711 80-10V, SP4 EX000710 80-10V, SP4 EX000709 80-10V, SP4 EX000708 80-10V, SP4 EX000707 80-10V, SP4 EX000706 80-10V, SP4 EX000705 80-10V, SP4 EX000704 80-10V, SP4 EX000703 80-10V, SP4 EX000702 80-10V, SP4 EX000701 80-10V, SP4 EX000700 80-10V, SP4 EX000699 80-10V, SP4 EX000698 80-10V, SP4 EX000697 80-10V, SP4 EX000696 80-10V, SP4 EX000695 80-10V, SP4 EX000694 80-10V, SP4 EX000693 80-10V, SP4 EX000692 80-10V, SP4 EX000691 80-10V, SP4 EX000690 80-10V, SP4 EX000689 80-10V, SP4 EX000688 80-10V, SP4 EX000687 80-10V, SP4 EX000686 80-10V, SP4 EX000685 80-10V, SP4 EX000684 80-10V, SP4 EX000683 80-10V, SP4 EX000682 80-10V, SP4 EX000681 80-10V, SP4 EX000680 80-10V, SP4 EX000679 80-10V, SP4 EX000678 80-10V, SP4 EX000677 80-10V, SP4 EX000676 80-10V, SP4 EX000675 80-10V, SP4 EX000674 80-10V, SP4 EX000673 80-10V, SP4 EX000672 80-10V, SP4 EX000671 80-10V, SP4 EX000670 80-10V, SP4 EX000669 80-10V, SP4 EX000668 80-10V, SP4 EX000667 80-10V, SP4 EX000666 80-10V, SP4 EX000665 80-10V, SP4 EX000664 80-10V, SP4 EX000663 80-10V, SP4 EX000662 80-10V, SP4 EX000661 80-10V, SP4 EX000660 80-10V, SP4 EX000659 80-10V, SP4 EX000658 80-10V, SP4 EX000657 80-10V, SP4 EX000656 80-10V, SP4 EX000655 80-10V, SP4 EX000654 80-10V, SP4 EX000653 80-10V, SP4 EX000652 80-10V, SP4 EX000651 80-10V, SP4 EX000650 80-10V, SP4 EX000649 80-10V, SP4 EX000648 80-10V, SP4 EX000647 80-10V, SP4 EX000646 80-10V, SP4 EX000645 80-10V, SP4 EX000644 80-10V, SP4 EX000643 80-10V, SP4 EX000642 80-10V, SP4 EX000641 80-10V, SP4 EX000640 80-10V, SP4 EX000639 80-10V, SP4 EX000638 80-10V, SP4 EX000637 80-10V, SP4 EX000636 80-10V, SP4 EX000635 80-10V, SP4 EX000634 80-10V, SP4 EX000633 80-10V, SP4 EX000632 80-10V, SP4 EX000631 80-10V, SP4 EX000630 80-10V, SP4 EX000629 80-10V, SP4 EX000628 80-10V, SP4 EX000627 80-10V, SP4 EX000626 80-10V, SP4 EX000625 80-10V, SP4 EX000624 80-10V, SP4 EX000623 80-10V, SP4 EX000622 80-10V, SP4 EX000621 80-10V, SP4 EX000620 80-10V, SP4 EX000619 80-10V, SP4 EX000618 80-10V, SP4 EX000617 80-10V, SP4 EX000616 80-10V, SP4 EX000615 80-10V, SP4 EX000614 80-10V, SP4 EX000613 80-10V, SP4 EX000612 80-10V, SP4 EX000611 80-10V, SP4 EX000610 80-10V, SP4 EX000609 80-10V, SP4 EX000608 80-10V, SP4 EX000607 80-10V, SP4 EX000606 80-10V, SP4 EX000605 80-10V, SP4 EX000604 80-10V, SP4 EX000603 80-10V, SP4 EX000602 80-10V, SP4 EX000601 80-10V, SP4 EX000600 80-10V, SP4 EX000599 80-10V, SP4 EX000598 80-10V, SP4 EX000597 80-10V, SP4 EX000596 80-10V, SP4 EX000595 80-10V, SP4 EX000594 80-10V, SP4 EX000593 80-10V, SP4 EX000592 80-10V, SP4 EX000591 80-10V, SP4 EX000590 80-10V, SP4 EX000589 80-10V, SP4 EX000588 80-10V, SP4 EX000587 80-10V, SP4 EX000586 80-10V, SP4 EX000585 80-10V, SP4 EX000584 80-10V, SP4 EX000583 80-10V, SP4 EX000582 80-10V, SP4 EX000581 80-10V, SP4 EX000580 80-10V, SP4 EX000579 80-10V, SP4 EX000578 80-10V, SP4 EX000577 80-10V, SP4 EX000576 80-10V, SP4 EX000575 80-10V, SP4 EX000574 80-10V, SP4 EX000573 80-10V, SP4 EX000572 80-10V, SP4 EX000571 80-10V, SP4 EX000570 80-10V, SP4 EX000569 80-10V, SP4 EX000568 80-10V, SP4 EX000567 80-10V, SP4 EX000566 80-10V, SP4 EX000565 80-10V, SP4 EX000564 80-10V, SP4 EX000563 80-10V, SP4 EX000562 80-10V, SP4 EX000561 80-10V, SP4 EX000560 80-10V, SP4 EX000559 80-10V, SP4 EX000558 80-10V, SP4 EX000557 80-10V, SP4 EX000556 80-10V, SP4 EX000555 80-10V, SP4 EX000554 80-10V, SP4 EX000553 80-10V, SP4 EX000552 80-10V, SP4 EX000551 80-10V, SP4 EX000550 80-10V, SP4 EX000549 80-10V, SP4 EX000548 80-10V, SP4 EX000547 80-10V, SP4 EX000546 80-10V, SP4 EX000545 80-10V, SP4 EX000544 80-10V, SP4 EX000543 80-10V, SP4 EX000542 80-10V, SP4 EX000541 80-10V, SP4 EX000540 80-10V, SP4 EX000539 80-10V, SP4 EX000538 80-10V, SP4 EX000537 80-10V, SP4 EX000536 80-10V, SP4 EX000535 80-10V, SP4 EX000534 80-10V, SP4 EX000533 80-10V, SP4 EX000532 80-10V, SP4 EX000531 80-10V, SP4 EX000530 80-10V, SP4 EX000529 80-10V, SP4 EX000528 80-10V, SP4 EX000527 80-10V, SP4 EX000526 80-10V, SP4 EX000525 80-10V, SP4 EX000524 80-10V, SP4 EX000523 80-10V, SP4 EX000522 80-10V, SP4 EX000521 80-10V, SP4 EX000520 80-10V, SP4 EX000519 80-10V, SP4 EX000518 80-10V, SP4 EX000517 80-10V, SP4 EX000516 80-10V, SP4 EX000515 80-10V, SP4 EX000514 80-10V, SP4 EX000513 80-10V, SP4 EX000512 80-10V, SP4 EX000511 80-10V, SP4 EX000510 80-10V, SP4 EX000509 80-10V, SP4 EX000508 80-10V, SP4 EX000507 80-10V, SP4 EX000506 80-10V, SP4 EX000505 80-10V, SP4 EX000504 80-10V, SP4 EX000503 80-10V, SP4 EX000502 80-10V, SP4 EX000501 80-10V, SP4 EX000500 80-10V, SP4 EX000499 80-10V, SP4 EX0
---	---

[pdf] Specifications Decleration of Conformity

GFT OP 11a ChXie Download Baixar recursos úteis Growatt72956b31af253981a99b92384a0f2739br
growatt upload file 20220829 72956b31af253981a99b92384a0f2739 GrowattSPA 4000 10000TL3 BH UP
Onduleur à couplage AC Growattcac48f5bfcd4702279f7f138ca0c6e73br
72956b31af253981a99b92384a0f2739fr cac48f5bfcd4702279f7f138ca0c6e73 GrowattDownload
Growattbr cac48f5bfcd4702279f7f138ca0c6e73br GrowattDescargar Descargar útiles
cac48f5bfcd4702279f7f138ca0c6e73latam cac48f5bfcd4702279f7f138ca0c6e73es SPA CEI 21SPA
Konut Tipi Depolama İnverter Growatttr Certificate of Conformity for GR 341 41KBSPA 21GROWATT
HVC 60050 A1SPA GrowattGROWATT CN PV 210174panpower eu en index controller attachment id
10188tr 72956b31af253981a99b92384a0f2739latam GrowattTélécharger Télécharger des ressources
utiles cac48f5bfcd4702279f7f138ca0c6e73tr 72956b31af253981a99b92384a0f2739es ||| ||| Certificate of
Conformity Certificate Number: CN-PV-210174 On the basis of the tests undertaken, the samples of the
below product have been found to comply with the requirements of the referenced specification/standard
at the time the tests ||| Certificate of Conformity Certificate Number: CN-PV-210174 On the basis of the
tests undertaken, the samples of the below product have been found to comply with the requirements of
the referenced specification/standard at the time the tests ||| Certificate of Conformity Certificate Number:
CN-PV-210174 On the basis of the tests undertaken, the samples of the below product have been found
to comply with the requirements of the referenced specification/standard at the time the tests ||| Certificate
of Conformity Certificate Number: CN-PV-210174 On the basis of the tests undertaken, the samples of
the below product have been found to comply with the requirements of the referenced
specification/standard at the time the tests ||| Certificate of Conformity Certificate Number: CN-PV-210174

On the basis of the tests undertaken, the samples of the below product have been found to comply with
the requirements of the referenced specification/standard at the time the tests ||| Certificate of Conformity
Certificate Number: CN-PV-210174 On the basis of the tests undertaken, the samples of the below
product have been found to comply with the requirements of the referenced specification/standard at the
time the tests ||| Certificate of Conformity Certificate Number: CN-PV-210174 On the basis of the tests
undertaken, the samples of the below product have been found to comply with the requirements of the
referenced specification/standard at the time the tests ||| Certificate of Conformity Certificate Number: CN-
PV-210174 On the basis of the tests undertaken, the samples of the below product have been found to
comply with the requirements of the referenced specification/standard at the time the tests ||| Certificate of
Conformity Certificate Number: CN-PV-210174 On the basis of the tests undertaken, the samples of the
below product have been found to comply with the requirements of the referenced specification/standard
at the time the tests ||| Certificate of Conformity Certificate Number: CN-PV-210174 On the basis of the tests
undertaken, the samples of the below product have been found to comply with the requirements of the
referenced specification/standard at the time the tests ||| Certificate of Conformity Certificate Number: CN-
PV-210174 On the basis of the tests undertaken, the samples of the below product have been found to
comply with the requirements of the referenced specification/standard at the time the tests ||| Certificate of
Conformity Certificate Number: CN-PV-210174 On the basis of the tests undertaken, the samples of the
below product have been found to comply with the requirements of the referenced specification/standard
at the time the tests

Certificate of Conformity Certificate Number: CN-PV-210174 On the basis of the tests
undertaken, the samples of the below product have been found to comply with the
requirements of the referenced specification/standard at the time the tests were
carried out. It does not imply that Intertek has per...

lang:en score:30 filesize: 341.41 K page_count: 6 document date: 2021-07-16



[pdf]

Frejvald Luděk Protokol PPDS P4 100MEGA Distribution s r o Váš kvalitní B2B distributor IT EGD
Growatt SPH TL BH UP protokol img4 cz i4wifi attach |||

PROTOKOL O SOULADU ZAZEN S POZADAVKY PPDS P4 Cslo protokolu:
EGD2024-P015 Drzitel protokolu: SOLSOL s.r.o., Technick 3029/17, Brno 616 00,
Cesk republika Pozadavky: Oven pozadavk PPDS Ploha 4 2022 Nesynchronn vrobnn
moduly Kategorie A1 a A2 Metoda zkousek: Metodika pro testovn komponenty...

lang:hr score:29 filesize: 303.1 K page_count: 1 document date: 2024-12-13



[\[pdf\]](#)

Manuale SPH TL3 BH UP 5000 10000 Rev01072022 Administrator Preview Downloads Growatt
European Distributor growatt tech shared files |||

Download Manuale Growatt New Energy Shenzhen Growatt New Energy Co., Ltd 4-13/F,Building A,Sino-German Europe Industrial Park, Hangcheng Ave,Guxing Community,Xixiang Subdistrict, Bao an District, Shenzhen, China T 86 0755 2747 1942 E service ginverter.com W www.ginverter.com GR-UM-226-A-00 Insta...
lang:it **score:29** filesize: 3.06 M page_count: 34 document date: 2022-07-01

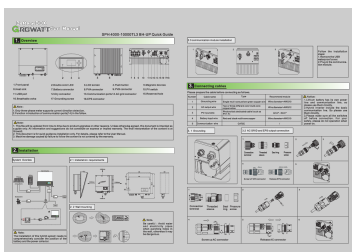

[\[pdf\]](#) User Manual Instructions Declaration of Conformity Label

044 0088200 Installation Manual of SPH4 10KTL3 BH UP series English 20210127 cdr Administrator 31 ott 2022 — This manual will provide the users who use Growatt SPH TL3 When using CAN communication with lithium batteries for example PYLONTECH X1 Anleitung elektro hausbedarf de 10 |||
Download Manual Growatt New Energy Shenzhen Growatt New Energy CO.,LTD No.28 Guangming Road, Shiyan Street, Bao an District, Shenzhen, P.R.China T 86 0755 2747 1942 E service ginverter.com W www.ginverter.com GR-UM-226-A-01 Installation Operation Manual Contents 1 Brief Introduction 1.1 ...
lang:en **score:29** filesize: 11.41 M page_count: 34 document date: 2022-10-14



[\[pdf\]](#) User Manual Instructions Declaration of Conformity Label

044 0088200 SPH4 10KTL3 BH UP 2022 01 05 Administrator Manual de utilizare inverter GROWATT SPH 10000TL3 BH UP Allview Solar Energy Casa Verde 2023 centrale fotovoltaice industriale și rezidențiale Green by manual growatt sph 10000tl3 bh up allview ro green cms atasamente 341 |||
Download Manual Growatt New Energy Shenzhen Growatt New Energy Co., Ltd 4-13/F,Building A,Sino-German Europe Industrial Park, Hangcheng Ave, Bao an District, Shenzhen, China T 86 0755 2747 1942 E service ginverter.com W www.ginverter.com GR-UM-226-A-01 Installation Operation Manual Content...
lang:en **score:29** filesize: 4.55 M page_count: 34 document date: 2022-01-13



[\[pdf\]](#) Specifications Declaration of Conformity Test Report

GFT OP 11a Sarah Linn Intertek Certificate of Conformity Growatt 31 lug 2021 — This is for the exclusive use s client and provided pursuant to agreement between its Client certificat de conformitate invento growatt sph 10000tl3 bh up ce lvd allview ro green cms atasamente 336 |||

Certificate of Conformity Certificate Number: CN-PV-210189 On the basis of the tests undertaken, the samples of the below product have been found to comply with the requirements of the referenced specifications/standards at the time the tests were carried out. It does not imply that Intertek has pe...

lang:en **score:28** filesize: 222.46 K page_count: 3 document date: 2021-08-25



[\[pdf\]](#)

SPH4000 10000TL3 BH UP Fr cdr Administrator Télécharger des ressources utiles GrowattFiche

technique de SPH 4 10KTL3 202311fr growatt upload file Fiche 202311 |||

SPH 4000-10000TL3 BH-UP Sortiede desequilibretriphase 100 Limitation de l exportation des phases Large tension de batterie 100-550V Fonction UPS, transition de 10ms Configuration volutive du systme Interface VPP prte SPD DC/AC type II 1.5 DC/AC Ratio www.ginverter.com Fiche technique SPH 400...

lang:fr **score:28** filesize: 3.08 M page_count: 2 document date: 2023-11-15



[\[pdf\]](#) Specifications Declaration of Conformity Test Report

GFT OP 11a Sarah Linn Intertek Certificat de conformitate invento GROWATT SPH 10000TL3 BH UP C10 11 Sisteme panouri solare și kit uri fotovoltaice cu montaje în toată țara Green by Allview certificat growatt sph 10000tl3 bh up c1011 allview ro green cms atasamente 334 |||

Certificate of Conformity Certificate Number: CN-PV-210131 On the basis of the tests undertaken, the samples of the below product have been found to comply with the requirements of the referenced specifications /standards at the time the tests were carried out. It does not imply that Intertek has p...

lang:en **score:27** filesize: 268.79 K page_count: 4 document date: 2021-06-04

intertek

Test Quality Assurance

Certificate of Conformity

Certificate Number: CN-PV-210128

On the basis of the tests undertaken, the samples of the below product have been found to comply with the requirements of the referenced specifications /standards at the time the tests were carried out. It does not imply that Intertek has performed any surveillance or control of the manufacturer. The manufacturer shall ensure that the manufacturing process ensures compliance of the production units with the examined products mentioned in this certificate.

Applicant:

Shenzhen Growatt New Energy Co., Ltd.
28 and 30 Building, Kexue, Campus Huashan Park, Xixiang, Shanghai
Village, Shimen Street, Baotian District, Shanghai, China

Product:

Hybrid inverter / AC Coupled inverter

Rating & Principle

See Appendix to Certificate of Conformity

Characteristics

Models:

SPH 4000TL3 BH-UP, SPH 5000TL3 BH-UP, SPH 6000TL3 BH-UP,
SPH 7000TL3 BH-UP, SPH 8000TL3 BH-UP, SPH 10000TL3 BH-UP,
SPH 4000TL3 BH-UP, SPH 5000TL3 BH-UP, SPH 6000TL3 BH-UP,
SPH 7000TL3 BH-UP, SPH 8000TL3 BH-UP, SPH 10000TL3 BH-UP
GROWATT

Brand Name:

GROWATT

Tested according to:

IEC 61727-3004 Photovoltaic (PV) systems – Characteristics of the utility interface
IEC 62109-2018 Test procedure of standing prevention measures for utility-
interconnected photovoltaic inverters

Certificate Issuing

Intertek Testing Services Ltd, Shanghai
Village, Kexue, 2nd Floor, No. 702, Zhongxing Road Chong (Shanghai) Pilot Free Trade
Zone, Shanghai, P.R. China

Office Name & Address

210121014020-008
210121014020-008

Test Reports No:

210121014020-008

Additional information in Appendix:

Signature

Certification Manager: Grady Yu

Date: 03 June 2021

Intertek

Page 1 of 4

017 PV-01b-03a-03a-0002

[pdf] Specifications Declaration of Conformity

GFT OP 11a Sarah Linn Intertek Certificat de conformitate inverter GROWATT SPH 10000TL3 BH UP

62116 61727 Sisteme panouri solare și kit uri fotovoltaice cu montaje în toată țara Green by Allview

certificat growatt sph 10000tl3 bh up 6211661727 allview ro green cms atasamente 333 |||

Certificate of Conformity Certificate Number: CN-PV-210128 On the basis of the tests

undertaken, the samples of the below product have been found to comply with the

requirements of the referenced specifications /standards at the time the tests were

carried out. It does not imply that Intertek has p...

lang:en score:27 filesize: 246.08 K page_count: 4 document date: 2021-06-04

intertek

Test Quality Assurance

Certificate of Conformity

Certificate Number: CN-PV-210128

On the basis of the tests undertaken, the samples of the below product have been found to comply with the requirements of the referenced specifications /standards at the time the tests were carried out. It does not imply that Intertek has performed any surveillance or control of the manufacturer. The manufacturer shall ensure that the manufacturing process ensures compliance of the production units with the examined products mentioned in this certificate.

Applicant:

Shenzhen Growatt New Energy Co., Ltd.
28 and 30 Building, Kexue, Campus Huashan Park, Xixiang, Shanghai
Village, Shimen Street, Baotian District, Shanghai, China

Product:

Hybrid inverter / AC Coupled inverter

Rating & Principle

See Appendix to Certificate of Conformity

Characteristics

Models:

SPH 4000TL3 BH-UP, SPH 5000TL3 BH-UP, SPH 6000TL3 BH-UP,
SPH 7000TL3 BH-UP, SPH 8000TL3 BH-UP, SPH 10000TL3 BH-UP,
SPH 4000TL3 BH-UP, SPH 5000TL3 BH-UP, SPH 6000TL3 BH-UP,
SPH 7000TL3 BH-UP, SPH 8000TL3 BH-UP, SPH 10000TL3 BH-UP
GROWATT

Brand Name:

GROWATT

Tested according to:

IEC 61727-3004 Photovoltaic (PV) systems – Characteristics of the utility interface
IEC 62109-2018 Test procedure of standing prevention measures for utility-
interconnected photovoltaic inverters

Certificate Issuing

Intertek Testing Services Ltd, Shanghai
Village, Kexue, 2nd Floor, No. 702, Zhongxing Road Chong (Shanghai) Pilot Free Trade
Zone, Shanghai, P.R. China

Office Name & Address

210121014020-008
210121014020-008

Test Reports No:

210121014020-008

Additional information in Appendix:

Signature

Certification Manager: Grady Yu

Date: 03 June 2021

Intertek

Page 1 of 4

017 PV-01b-03a-03a-0002

[pdf] Specifications Declaration of Conformity

GFT OP 11a Sarah Linn Intertek Growatt SPH 4000 10000TL3 BH UP IEC62116 61727 b2b offgridtec

media product attachments |||

Certificate of Conformity Certificate Number: CN-PV-210128 On the basis of the tests

undertaken, the samples of the below product have been found to comply with the

requirements of the referenced specifications /standards at the time the tests were

carried out. It does not imply that Intertek has p...

lang:en score:27 filesize: 250.05 K page_count: 4 document date: 2021-06-04

[\[pdf\]](#) User Manual Instructions Declaration of Conformity Label

044 0088200 SPH4 10KTL3 BH UP 2022 01 05 Administrator Manuale dell utente Growatt SPH 4000

~ 10000TL3 UP Growatt Inverter ibrido 3PH SPH4000TL3 UP User manual 10000tl3 UP 3ph hybrid
inverter 2 mppt 2021 ENGcdn shopify s files 1 0839 6934 3828 User ENG Manuel d utilisation Sph bh
upManuale Hybride Solar onduleur Sph10000tl3 upGrowatt 2User 2cdn upManuel Sph6000tl3 6User
6cdn Sph7000tl3 5User 5cdn Sph5000tl3 3User 3cdn UPfv sph10000tl3 installation manualGrowatt
UPSolight cz documentsUser ENGfv manualcdn ENGsolight documents fv Sph8000tl3 4User 4cdn
manualHandbuchGrowatt documentsGrowatt Hybrid 3 Phasen Wechselrichter
manual36f532290fb338bf30058e77af4104e8cdn manualsundemand nl media c2 87 2c 1710500509
36f532290fb338bf30058e77af4104e8 SOLIGHT czManuel manualHandbuchThis will provide the users
who use TL3 Series of Shenzhen New Energy Technology Co LTD Short for as below Growatt
sph5000tl3 manualUser manualsolight srsltid AfmBOooOUeTNrBdrCZsSILu8I 3VmabBTICfrgvxlzL2G8v
L9X5yjO2cdn 100 4 52MBHandbuchThis SPH5000TL3 Υβριδικός Μεταρροπέας 5kWGrowatt
Manualsolight manualpanpower eu el index controller attachment id 11441sundemand 52MBUser Hibrid
InverterGrowatt ManualGrowatt 11441panpower hu ||| ||| Download Manual Growatt New Energy
Shenzhen Growatt New Energy Co., Ltd 4-13/F,Building A,Sino-German Europe Industrial Park,
Hangcheng Ave, Bao an District, Shenzhen, China T 86 0755 2747 1942 E service ginverter.com W
www.ginverter.com GR ||| Download Manual Growatt New Energy Shenzhen Growatt New Energy Co.,
Ltd 4-13/F,Building A,Sino-German Europe Industrial Park, Hangcheng Ave, Bao an District, Shenzhen,
China T 86 0755 2747 1942 E service ginverter.com W www.ginverter.com GR ||| Download Manual
Growatt New Energy Shenzhen Growatt New Energy Co., Ltd 4-13/F,Building A,Sino-German Europe
Industrial Park, Hangcheng Ave, Bao an District, Shenzhen, China T 86 0755 2747 1942 E service
ginverter.com W www.ginverter.com GR ||| Download Manual Growatt New Energy Shenzhen Growatt
New Energy Co., Ltd 4-13/F,Building A,Sino-German Europe Industrial Park, Hangcheng Ave, Bao an
District, Shenzhen, China T 86 0755 2747 1942 E service ginverter.com W www.ginverter.com GR |||
Download Manual Growatt New Energy Shenzhen Growatt New Energy Co., Ltd 4-13/F,Building A,Sino-
German Europe Industrial Park, Hangcheng Ave, Bao an District, Shenzhen, China T 86 0755 2747 1942
E service ginverter.com W www.ginverter.com GR ||| Download Manual Growatt New Energy Shenzhen
Growatt New Energy Co., Ltd 4-13/F,Building A,Sino-German Europe Industrial Park, Hangcheng Ave,
Bao an District, Shenzhen, China T 86 0755 2747 1942 E service ginverter.com W www.ginverter.com
GR ||| Download Manual Growatt New Energy Shenzhen Growatt New Energy Co., Ltd 4-13/F,Building
A,Sino-German Europe Industrial Park, Hangcheng Ave, Bao an District, Shenzhen, China T 86 0755
2747 1942 E service ginverter.com W www.ginverter.com GR ||| Download Manual Growatt New Energy
Shenzhen Growatt New Energy Co., Ltd 4-13/F,Building A,Sino-German Europe Industrial Park,
Hangcheng Ave, Bao an District, Shenzhen, China T 86 0755 2747 1942 E service ginverter.com W
www.ginverter.com GR ||| Download Manual Growatt New Energy Shenzhen Growatt New Energy Co.,
Ltd 4-13/F,Building A,Sino-German Europe Industrial Park, Hangcheng Ave, Bao an District, Shenzhen,
China T 86 0755 2747 1942 E service ginverter.com W www.ginverter.com GR ||| Download Manual
Growatt New Energy Shenzhen Growatt New Energy Co., Ltd 4-13/F,Building A,Sino-German Europe
Industrial Park, Hangcheng Ave, Bao an District, Shenzhen, China T 86 0755 2747 1942 E service
ginverter.com W www.ginverter.com GR
Download Manual Growatt New Energy Shenzhen Growatt New Energy Co., Ltd 4-
13/F,Building A,Sino-German Europe Industrial Park, Hangcheng Ave, Bao an
District, Shenzhen, China T 86 0755 2747 1942 E service ginverter.com W
www.ginverter.com GR-UM-226-A-01 Installation Operation Manual Content...
lang:en score:27 filesize: 4.52 M page_count: 34 document date: 2022-01-13



[\[pdf\]](#) Specifications

GFT OP 11a Sarah Linn Intertek Growatt SPH Zertifikat NA SchutzGrowatt PV Paket mit Wechselrichter
6kW und Speicher 7 68kWh inkl Smart Meter 68 kWh PVST5187 6 7Growatt Schutzcdn tepto de media
ec f5 79 1707296554 Schutz ts 1708339103 7SPA 4000 10000TL3 BH UP Onduleur à couplage AC
GrowattGrowatt Schutzc210a0183bb27fba0a9cfa517f4aca87cdn 1708339103fr growatt upload file
20220829 c210a0183bb27fba0a9cfa517f4aca87 GrowattDownload Baixar recursos úteis
c210a0183bb27fba0a9cfa517f4aca87br 3PH Hybrid SPH10000TL3 leo energyGrowatt SchutzSPH
N4105 2018 llcdn c210a0183bb27fba0a9cfa517f4aca87cdn shopify s files 1 0672 1267 3291 ll v
1675283673 SPA llGrowatt SchutzSPA Konut Tipi Depolama İnverter lltr energyDescargar Descargar
útiles 1675283673es Schutzhybridwechselrichter sph 10000tl bh up zertifikat vde na schutz 4105
2018SPH c210a0183bb27fba0a9cfa517f4aca87photovoltaik shop mw link id 1035br GrowattTélécharger
Télécharger des ressources utiles ll3e313d7ab0720a970af560691e50fa98tr
c210a0183bb27fba0a9cfa517f4aca87fr 3e313d7ab0720a970af560691e50fa98 llv1tr
3e313d7ab0720a970af560691e50fa98br GrowattDescargar 3e313d7ab0720a970af560691e50fa98latam
SchutzDIN VDE certificationSPA 7GROWATT Controller Module HVC 60050 A1 for ARK 2 5H suitable
batteries J Point sp z o phoSPA SchutzCERT DIN VDEhybridwechselrichter 1708339103files ecoenergy
product 6077 attachments CERT VDEfr ||| ||| Certificate of The Network and System Protection Zertifikat fr

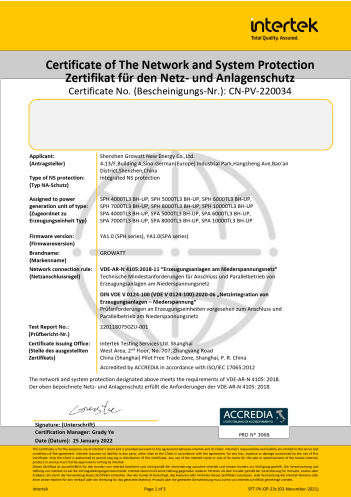

undertaken, the sample s of the below product have been found to comply w ||| Certificate of The Network
and System Protection Zertifikat fr den Netz- und Anlagenschutz Certificate No. Bescheinigungs-Nr. : CN-
PV-220034 On the basis of the tests undertaken, the sample s of the below product have been found to
comply w ||| Certificate of The Network and System Protection Zertifikat fr den Netz- und Anlagenschutz
Certificate No. Bescheinigungs-Nr. : CN-PV-220034 On the basis of the tests undertaken, the sample s of
the below product have been found to comply w ||| Certificate of The Network and System Protection
Zertifikat fr den Netz- und Anlagenschutz Certificate No. Bescheinigungs-Nr. : CN-PV-220034 On the
basis of the tests undertaken, the sample s of the below product have been found to comply w |||
Certificate of The Network and System Protection Zertifikat fr den Netz- und Anlagenschutz Certificate No.
Bescheinigungs-Nr. : CN-PV-220034 On the basis of the tests undertaken, the sample s of the below
product have been found to comply w ||| Certificate of The Network and System Protection Zertifikat fr den
Netz- und Anlagenschutz Certificate No. Bescheinigungs-Nr. : CN-PV-220034 On the basis of the tests
undertaken, the sample s of the below product have been found to comply w
Certificate of The Network and System Protection Zertifikat fr den Netz- und
Anlagenschutz Certificate No. Bescheinigungs-Nr. : CN-PV-220034 On the basis of
the tests undertaken, the sample s of the below product have been found to comply
with the requirements of the referenced specification s /s...

lang:de score:27 filesize: 322.52 K page count: 3 document date: 2022-01-25



[pdf] Specifications Decleration of Conformity

GFT OP 11a Sarah Linn Intertek Download Growatt SPH 6000TL3 BH UP 6kW Hybridwechselrichter 3 phasig 4000 10000TL3 VDE0126 offgridtec media product attachements |||

Certificate of Conformity Certificate Number: CN-PV-210124 On the basis of the tests undertaken, the samples of the below product have been found to comply with the requirements of the referenced specifications /standards at the time the tests were carried out. It does not imply that Intertek has p...

lang:en score:27 filesize: 232.57 K page_count: 4 document date: 2021-06-02

[pdf] Specifications

GFT OP 11a Sarah Linn Intertek N4105 2 EinheitenzertifikatGrowatt 7 kW Wechselrichter SPH 7000TL3 BH UP inkl Smart Meter — PVDeals24SPH 4000 10000TL3 VDE 4105 Certificate 02cdn shopify s files 1 0728 2265 3271 02 v 1680099434 PVDeals24SPA Onduleur à couplage AC GrowattSPH 02b62f07a977bb7b02f774a45ee698dd95cdn 1680099434fr growatt upload file 20220829

b62f07a977bb7b02f774a45ee698dd95 41051 EN 12 06 2023Intertek 6000TL3 6kW Hybrid 3 phasig inklusive AllSolarXGrowatt GrowattVDE 2023SPH 0682 5148 4439 2023 1738413232cdn

GrowattDownload Baixar recursos úteis b62f07a977bb7b02f774a45ee698dd95br GrowattDescargar Descargar útiles b62f07a977bb7b02f774a45ee698dd95latam EinheitenzertifikatSPA N4105Growatt Konut Tipi Depolama İverter GrowattSPA 1680099434tr b62f07a977bb7b02f774a45ee698dd95fr

N4105SPA b62f07a977bb7b02f774a45ee698dd95tr b62f07a977bb7b02f774a45ee698dd95es ||| |||

Certificate of The Network and System Protection Zertifikat fr den Netz- und Anlagenschutz Certificate No.

Bescheinigungs-Nr : CN-PV-210127 On the basis of the tests undertaken, the samples of the below

product have been found to comply wit ||| Certificate of The Network and System Protection Zertifikat fr

den Netz- und Anlagenschutz Certificate No. Bescheinigungs-Nr : CN-PV-210127 On the basis of the

tests undertaken, the samples of the below product have been found to comply wit ||| Certificate of The

Network and System Protection Zertifikat fr den Netz- und Anlagenschutz Certificate No. Bescheinigungs-

Nr : CN-PV-210127 On the basis of the tests undertaken, the samples of the below product have been

found to comply wit ||| Certificate of The Network and System Protection Zertifikat fr den Netz- und

Anlagenschutz Certificate No. Bescheinigungs-Nr : CN-PV-210127 On the basis of the tests undertaken,

the samples of the below product have been found to comply wit ||| Certificate of The Network and System

Protection Zertifikat fr den Netz- und Anlagenschutz Certificate No. Bescheinigungs-Nr : CN-PV-210127

On the basis of the tests undertaken, the samples of the below product have been found to comply wit |||

Certificate of The Network and System Protection Zertifikat fr den Netz- und Anlagenschutz Certificate No.

Bescheinigungs-Nr : CN-PV-210127 On the basis of the tests undertaken, the samples of the below

product have been found to comply wit

Certificate of The Network and System Protection Zertifikat fr den Netz- und

Anlagenschutz Certificate No. Bescheinigungs-Nr : CN-PV-210127 On the basis of

the tests undertaken, the samples of the below product have been found to comply

with the requirements of the referenced specification /standa...

lang:de score:27 filesize: 268.58 K page_count: 3 document date: 2021-06-02

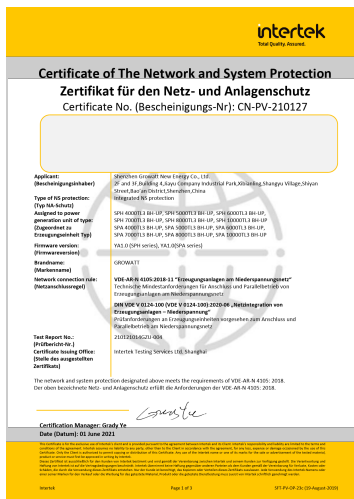



[pdf] Specifications Declaration of Conformity

GFT OP 11a Sarah Linn Intertek Download Growatt SPA 5000TL3 BH UP 5kW String Wechselrichter 3 phasig 4000 10000TL3 UTE C FR offgridtec media product attachements |||

Certificate of Conformity Certificate Number: CN-PV-210125 On the basis of the tests undertaken, the samples of the below product have been found to comply with the requirements of the referenced specifications /standards at the time the tests were carried out. It does not imply that Intertek has p...

lang:en score:27 filesize: 267.33 K page_count: 4 document date: 2021-06-02



[pdf] Specifications Declaration of Conformity Test Report

GFT OP 11a Sarah Linn Intertek Download Growatt SPH 6000TL3 BH UP 6kW Hybridwechselrichter 3 phasig 4000 10000TL3 TOR Erzeuger offgridtec media product attachements |||

Certificate of Conformity Certificate Number: CN-PV-210130 On the basis of the tests undertaken, the samples of the below product have been found to comply with the requirements of the referenced specifications /standards at the time the tests were carried out. It does not imply that Intertek has p...

lang:en score:27 filesize: 272.92 K page_count: 5 document date: 2021-06-04



[pdf] Specifications Declaration of Conformity

GFT OP 11a Sarah Linn Intertek Certificate of Conformity Zertifikate Oct 14 2022 — This is for the exclusive use s client and provided pursuant to agreement between its Client 57 pages Speichersystem 10KW Wechselrichter mit 7 5KW Batterie Hybrid Growatt Elektro Hausbedarf elektro hausbedarf de 10 ||| Certificate of Conformity Certificate Number: CN-PV-210125 On the basis of the tests undertaken, the samples of the below product have been found to comply with the requirements of the referenced specifications /standards at the time the tests were carried out. It does not imply that Intertek has p...

lang:en score:27 filesize: 5.18 M page_count: 57 document date: 2022-10-14



Growatt SPH TL3 BH-UP Series Installation and Operation Manual

This manual provides detailed product information and installation instructions for the Growatt SPH TL3 BH-UP Series hybrid inverters. It covers safety precautions, product descriptions, installation procedures, commissioning, operation modes, troubleshooting, and technical specifications.

lang:en score:26 filesize: 14.01 M page_count: 34 document date: 2022-01-05

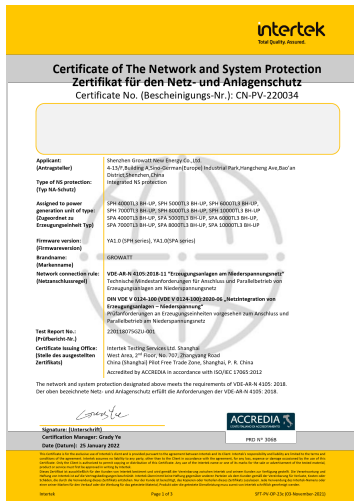

[pdf] Specifications

GFT OP 11a Sarah Linn Intertek Certificate of The Network and System Protection Zertifikat für den This is for the exclusive use 39 s client provided pursuant to agreement between its Client responsibility liability are limited terms 6243ccb0d6d84 ginverter upload file contents 2022 03 |||

Certificate of The Network and System Protection Zertifikat fr den Netz- und Anlagenschutz Certificate No. Bescheinigungs-Nr. : CN-PV-220034 On the basis of the tests undertaken, the sample s of the below product have been found to comply with the requirements of the referenced specification s /s...

lang:de score:26 filesize: 322.52 K page_count: 3 document date: 2022-01-25

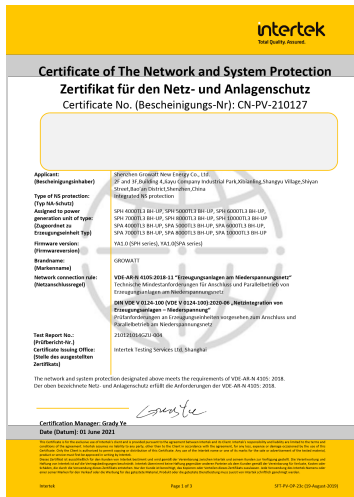

[pdf] Specifications

GFT OP 11a Sarah Linn Intertek Certificate of The Network and System Protection Zertifikat für den Netz und Anlagenschutz 611ca7c70c64a ginverter upload file contents 2021 08 |||

Certificate of The Network and System Protection Zertifikat fr den Netz- und Anlagenschutz Certificate No. Bescheinigungs-Nr : CN-PV-210127 On the basis of the tests undertaken, the samples of the below product have been found to comply with the requirements of the referenced specification /standa...

lang:de score:26 filesize: 268.58 K page_count: 3 document date: 2021-06-02



[pdf]

GFT OP 11a Sarah Linn Intertek SPH SPA 4000 10000TL3 BH UP VDE0126 VFR2019 French EN Three Phase Hybrid Growatt en growatt upload file ||| ||| Certificat de Conformit Numro de Certificat: CN-PV-210125 Sur la base des essais effectués, les chantillos du produit suivant se sont avrs conformes aux exigences des spcifications/des normes rfrences au moment o les essais ont t effectués. C Certificat de Conformit Numro de Certificat: CN-PV-210125 Sur la base des essais effectués, les chantillos du produit suivant se sont avrs conformes aux exigences des spcifications/des normes rfrences au moment o les essais ont t effectués. Cela n implique pas que Intertek a effectu toute surveillance...

lang:fr score:26 filesize: 261.29 K page_count: 4 document date: 2021-06-15



[\[pdf\]](#) User Manual Instructions Declaration of Conformity Label

044 0088200 Installation Manual of SPH4 10KTL3 BH UP series English 20210127 cdr Administrator
Operation Shenzhen Growatt New Energy CO LTD No 28 Guangming Road Shiyao Street Bao an District
P R China GR UM 226 A 01 Kaytoohje aurinkosahkotukku fi 2025 |||
Download Manual Growatt New Energy Shenzhen Growatt New Energy CO.,LTD
No.28 Guangming Road, Shiyao Street, Bao an District, Shenzhen, P.R.China T 86
0755 2747 1942 E service ginverter.com W www.ginverter.com GR-UM-226-A-01
Installation Operation Manual Contents 1 Brief Introduction 1.1 Pr...
lang:en score:26 filesize: 7.62 M page_count: 32 document date: 2021-07-01

[\[pdf\]](#) Specifications Declaration of Conformity

GFT OP 11a Sarah Linn Intertek CE EMC KonformitätsbescheinigungGrowatt 7 kW Wechselrichter SPH
7000TL3 BH UP inkl Smart Meter — PVDeals24SPH 4000 10000TL3 EMCcdn shopify s files 1 0728
2265 3271 v 1680099588 PVDeals24Download Baixar recursos úteis GrowattSPH
EMCca879e7d572f7289c4406f3d57730642cdn 1680099588br growatt upload file 20220829
ca879e7d572f7289c4406f3d57730642 KonformitätsbescheinigungEMC certificationGrowatt
PVDeals24GROWATT TL3 3 phase hybrid inverter J Point sp z o photovoltaicsDownload EMCsph4000
eeecd 1680099588sklep j point pl gk146 images sph4000 eeebr
KonformitätsbescheinigungKonformitätserklärung Growatt 1EMC PVDeals24Growatt PV Paket mit 6kW und
Speicher 68kWh 68 kWh PVST5187 6 7GROWATT EMCKonformitätserklärung 1sph4000 1680099588cdn
tepto de media 7d bf 1c 1707296554 Konformitätserklärung ts 1734452927sklep GrowattSPA Onduleur à
couplage AC eef028f26567f1157b3f48dc52ef62ef40cdn ca879e7d572f7289c4406f3d57730642fr
f028f26567f1157b3f48dc52ef62ef40 GrowattDownload f028f26567f1157b3f48dc52ef62ef40br
GrowattDescargar Descargar útiles f028f26567f1157b3f48dc52ef62ef40es
ca879e7d572f7289c4406f3d57730642es 1SPA EMCCEM 7SPA Konut Tipi Depolama İnverter
GrowattGROWATT 1734452927tr f028f26567f1157b3f48dc52ef62ef40sklep
f028f26567f1157b3f48dc52ef62ef40latam GrowattTélécharger Télécharger des ressources utiles
EMCCertifikat 310 08KBEMC GrowattGrowatt 4000TL3 Phasen Hybrid WechselrichterGROWATT 1SPH
f028f26567f1157b3f48dc52ef62ef40panpower eu index controller attachment id 10437sklep
08KBCertifikat WechselrichterGrowatt fázisú Hibrid InverterGROWATT EMCSPH 10437panpower hu
InverterGrowatt 8000 Inverter 8kWGROWATT ro 8kWGrowatt 10000 VäxelriktareGROWATT sv
EMCSPA f028f26567f1157b3f48dc52ef62ef40tr ca879e7d572f7289c4406f3d57730642latam
certificationEMC photovoltaicsGROWATT eeeSPH eeefiles ecoenergy product 6072 attachments EMCbr

||| ||| Certificate of Conformity Certificate Number: CN-PV-210211 On the basis of the tests undertaken,
the samples of the below product have been found to comply with the requirements of the referenced
specifications/standards at the time the tes ||| Certificate of Conformity Certificate Number: CN-PV-
210211 On the basis of the tests undertaken, the samples of the below product have been found to
comply with the requirements of the referenced specifications/standards at the time the tes ||| Certificate
of Conformity Certificate Number: CN-PV-210211 On the basis of the tests undertaken, the samples of
the below product have been found to comply with the requirements of the referenced
specifications/standards at the time the tes ||| Certificate of Conformity Certificate Number: CN-PV-
210211 On the basis of the tests undertaken, the samples of the below product have been found to
comply with the requirements of the referenced specifications/standards at the time the tes ||| Certificate
of Conformity Certificate Number: CN-PV-210211 On the basis of the tests undertaken, the samples of
the below product have been found to comply with the requirements of the referenced
specifications/standards at the time the tes ||| Certificate of Conformity Certificate Number: CN-PV-
210211 On the basis of the tests undertaken, the samples of the below product have been found to
comply with the requirements of the referenced specifications/standards at the time the tes ||| Certificate
of Conformity Certificate Number: CN-PV-210211 On the basis of the tests undertaken, the samples of
the below product have been found to comply with the requirements of the referenced
specifications/standards at the time the tes ||| Certificate of Conformity Certificate Number: CN-PV-
210211 On the basis of the tests undertaken, the samples of the below product have been found to
comply with the requirements of the referenced specifications/standards at the time the tes ||| Certificate
of Conformity Certificate Number: CN-PV-210211 On the basis of the tests undertaken, the samples of
the below product have been found to comply with the requirements of the referenced
specifications/standards at the time the tes ||| Certificate of Conformity Certificate Number: CN-PV-
210211 On the basis of the tests undertaken, the samples of the below product have been found to

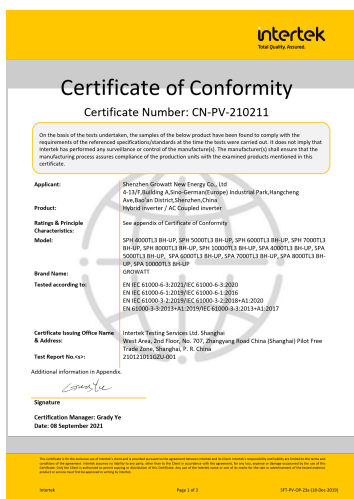

comply with the requirements of the referenced specifications/standards at the time the tes ||| Certificate of Conformity Certificate Number: CN-PV-210211 On the basis of the tests undertaken, the samples of the below product have been found to comply with the requirements of the referenced specifications/standards at the time the tes ||| Certificate of Conformity Certificate Number: CN-PV-210211 On the basis of the tests undertaken, the samples of the below product have been found to comply with the requirements of the referenced specifications/standards at the time the tes ||| Certificate of Conformity Certificate Number: CN-PV-210211 On the basis of the tests undertaken, the samples of the below product have been found to comply with the requirements of the referenced specifications/standards at the time the tes ||| Certificate of Conformity Certificate Number: CN-PV-210211 On the basis of the tests undertaken, the samples of the below product have been found to comply with the requirements of the referenced specifications/standards at the time the tes ||| Certificate of Conformity Certificate Number: CN-PV-210211 On the basis of the tests undertaken, the samples of the below product have been found to comply with the requirements of the referenced specifications/standards at the time the tes ||| Certificate of Conformity Certificate Number: CN-PV-210211 On the basis of the tests undertaken, the samples of the below product have been found to comply with the requirements of the referenced specifications/standards at the time the tes ||| Certificate of Conformity Certificate Number: CN-PV-210211 On the basis of the tests undertaken, the samples of the below product have been found to comply with the requirements of the referenced specifications/standards at the time the tes ||| Certificate of Conformity Certificate Number: CN-PV-210211 On the basis of the tests undertaken, the samples of the below product have been found to comply with the requirements of the referenced specifications/standards at the time the tests were carried out. It does not imply that Intertek has pe...

lang:en score:26 filesize: 310.08 K page_count: 3 document date: 2021-09-10



[pdf] User Manual Instructions

044 0088205 SPH4 10KTL3 BH UP 2024 4 26 cdr Administrator UP growatt sph 8000 manual solarone ro opencart UP |||

SPH 4-10KTL3 BH-UP User Manual Contents 1

Overview.....1 1.1

Information on this document 1

1.2 Target group

lang:en score:25 filesize: 6.38 M page_count: 88 document date: 2024-07-12

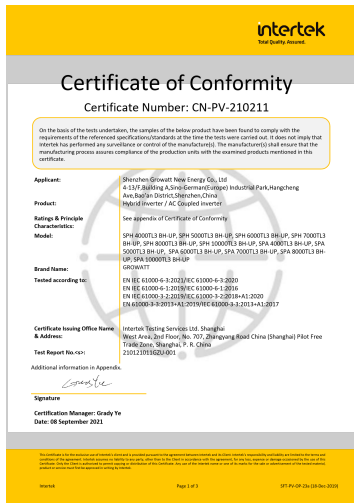

[pdf] Specifications Declaration of Conformity

GFT OP 11a Sarah Linn Intertek 616e789ec13f8 ginverter upload file contents 2021 10 |||

Certificate of Conformity Certificate Number: CN-PV-210211 On the basis of the tests undertaken, the samples of the below product have been found to comply with the requirements of the referenced specifications/standards at the time the tests were carried out. It does not imply that Intertek has pe...

lang:en score:25 filesize: 310.07 K page_count: 3 document date: 2021-09-10

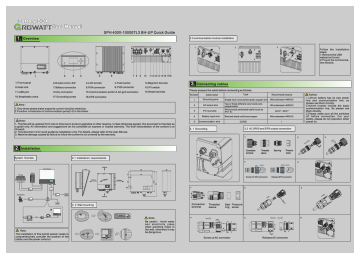

[pdf] User Manual Instructions Declaration of Conformity Label

044 0088200 Installation Manual of SPH4 10KTL3 BH UP series English 20210127 cdr Administrator Anleitung solarrio24 2022 10 |||

Download Manual Growatt New Energy Shenzhen Growatt New Energy CO.,LTD No.28 Guangming Road, Shiyan Street, Bao an District, Shenzhen, P.R.China T 86 0755 2747 1942 E service ginverter.com W www.ginverter.com GR-UM-226-A-01 Installation Operation Manual Contents 1 Brief Introduction 1.1 ...

lang:en score:25 filesize: 11.43 M page_count: 34 document date: 2022-10-14



[pdf] User Manual Instructions Declaration of Conformity Label

044 0088200 SPH4 10KTL3 BH UP 2022 01 05 Administrator Installation Operation Manual 5 6 3 Product Description 1 Growatt SPH series inverter Marks of Mark Explanation Push button Status symbol display screen and set system 61dff962e43e4 ginverter upload file contents |||

Download Manual Growatt New Energy Shenzhen Growatt New Energy Co., Ltd 4-13/F,Building A,Sino-German Europe Industrial Park, Hangcheng Ave, Bao an District, Shenzhen, China T 86 0755 2747 1942 E service ginverter.com W www.ginverter.com GR-UM-226-A-01 Installation Operation Manual Content...

lang:en score:25 filesize: 4.52 M page_count: 34 document date: 2022-01-13

Form C: Type Test Verification Report

Type Approval and **Manufacturer** declaration of compliance with the requirements of G98PL.

This form should be used when making a Type Test submission to the Energy Networks Association (ENA).

If the **Micro-generator** is **Fully Type Tested** and already registered with the **ENA Type Test Verification Report Register**, the **Installation Document** should include the **Manufacturer's Reference Number** (the Product ID), and this form does not need to be submitted.

Where the **Micro-generator** is **not registered** with the **ENA Type Test Verification Report Register**, this form needs to be completed and provided to the **ENO**, to confirm that the **Micro-generator** has been

Manufacturer's reference number	SPH 6000T3L3 BH-UP		
Micro-generator technology	SPH 6000T3L3 BH-UP, SPH 6000T3L3 BH-UP, SPH 6000T3L3 BH-UP, SPH 6000T3L3 BH-UP, SPH 6000T3L3 BH-UP, SPH 6000T3L3 BH-UP		
Manufacturer name	Shenzhen Growatt New Energy Co., Ltd.		
Address	A 13th Floor, Building A, Sino German Energy Industrial Development Park, No. 1, Haizhuang Avenue, Baotou District, Shenzhen, Guangdong, China.		
Tel	+86 755 2952 5888	Fax	+86 755 2427 2535
E-mail	req@growatt.com	Web site	www.growatt.com
Connection Option			
Registered Capacity, up to 100kW, or more than that one connection option	NA	NA/ single phase, single, split or three phase system	
	4-10	NA/ single phase	
	NA	NA/ two phases in the phase system	
	NA	NA/ two phases split phase system	

<p>Manufacturer Type Test declaration. - I certify that all products supplied by the company with the above Type Tested reference number will be manufactured and tested to ensure that they perform as stated in this document, prior shipment to site and that no site modifications are required to ensure that the product meets all the requirements of EREC GS/NL.</p>	<p>On-behalf of</p>	<p>Shenzhen Growatt New Energy Co., Ltd.</p>
--	---------------------	--

Note that testing can be done by the **Manufacturer** of an individual component or by an external test house.

Where parts of the testing are carried out by persons or organisations other than the **Manufacturer** then that person or organisation shall keep copies of all test reports and results submitted to them in order to verify the

V3 Jun 2022

SPH 4-10KTL3 BH-UP
&
User Manual

Report Type Approval and Manufacturer declaration of compliance with the requirements of G98/NI.. This form should be used when making a Type Test submission to the Energy Networks Association ENA . If the Micro-generator is Fully...

lang:en score:24 filesize: 10.74 M page count: 88 document date: 2024-03-12

Growatt inverters - ENA Fault Current Contribution

Issued: 30/07/2024

Inverter Model	Maximum Output Power (kW)	Maximum Output Current (Amps)	Rated Output Power (kW)	Rated Output Current (Amps)	Maximum DC Input Power (kW)	Maximum DC Input Current (Amps)	Maximum DC Input Voltage (V)	Maximum AC Output Power (kW)	Maximum AC Output Current (Amps)	Rated AC Output Power (kW)	Rated AC Output Current (Amps)	Short Circuit Current (kA)	Short Circuit Current (kA)
MG-100TL3	100.0	100.0	100.0	100.0	100.0	100.0	1000	100.0	100.0	100.0	100.0	100.0	100.0
MG-100TL3-1	100.0	100.0	100.0	100.0	100.0	100.0	1000	100.0	100.0	100.0	100.0	100.0	100.0
MG-100TL3-2	100.0	100.0	100.0	100.0	100.0	100.0	1000	100.0	100.0	100.0	100.0	100.0	100.0
MG-100TL3-3	100.0	100.0	100.0	100.0	100.0	100.0	1000	100.0	100.0	100.0	100.0	100.0	100.0
MG-100TL3-4	100.0	100.0	100.0	100.0	100.0	100.0	1000	100.0	100.0	100.0	100.0	100.0	100.0
MG-100TL3-5	100.0	100.0	100.0	100.0	100.0	100.0	1000	100.0	100.0	100.0	100.0	100.0	100.0
MG-100TL3-6	100.0	100.0	100.0	100.0	100.0	100.0	1000	100.0	100.0	100.0	100.0	100.0	100.0
MG-100TL3-7	100.0	100.0	100.0	100.0	100.0	100.0	1000	100.0	100.0	100.0	100.0	100.0	100.0
MG-100TL3-8	100.0	100.0	100.0	100.0	100.0	100.0	1000	100.0	100.0	100.0	100.0	100.0	100.0
MG-100TL3-9	100.0	100.0	100.0	100.0	100.0	100.0	1000	100.0	100.0	100.0	100.0	100.0	100.0
MG-100TL3-10	100.0	100.0	100.0	100.0	100.0	100.0	1000	100.0	100.0	100.0	100.0	100.0	100.0
MG-100TL3-11	100.0	100.0	100.0	100.0	100.0	100.0	1000	100.0	100.0	100.0	100.0	100.0	100.0
MG-100TL3-12	100.0	100.0	100.0	100.0	100.0	100.0	1000	100.0	100.0	100.0	100.0	100.0	100.0
MG-100TL3-13	100.0	100.0	100.0	100.0	100.0	100.0	1000	100.0	100.0	100.0	100.0	100.0	100.0
MG-100TL3-14	100.0	100.0	100.0	100.0	100.0	100.0	1000	100.0	100.0	100.0	100.0	100.0	100.0
MG-100TL3-15	100.0	100.0	100.0	100.0	100.0	100.0	1000	100.0	100.0	100.0	100.0	100.0	100.0
MG-100TL3-16	100.0	100.0	100.0	100.0	100.0	100.0	1000	100.0	100.0	100.0	100.0	100.0	100.0
MG-100TL3-17	100.0	100.0	100.0	100.0	100.0	100.0	1000	100.0	100.0	100.0	100.0	100.0	100.0
MG-100TL3-18	100.0	100.0	100.0	100.0	100.0	100.0	1000	100.0	100.0	100.0	100.0	100.0	100.0
MG-100TL3-19	100.0	100.0	100.0	100.0	100.0	100.0	1000	100.0	100.0	100.0	100.0	100.0	100.0
MG-100TL3-20	100.0	100.0	100.0	100.0	100.0	100.0	1000	100.0	100.0	100.0	100.0	100.0	100.0
MG-100TL3-21	100.0	100.0	100.0	100.0	100.0	100.0	1000	100.0	100.0	100.0	100.0	100.0	100.0
MG-100TL3-22	100.0	100.0	100.0	100.0	100.0	100.0	1000	100.0	100.0	100.0	100.0	100.0	100.0
MG-100TL3-23	100.0	100.0	100.0	100.0	100.0	100.0	1000	100.0	100.0	100.0	100.0	100.0	100.0
MG-100TL3-24	100.0	100.0	100.	100.0	100.0	100.0	1000	100.0	100.0	100.0	100.0	100.0	100.0

Administrator Growatt inverters ENA Fault Current Contribution Alternergy Jul 20 2024 · MAX 100KTL3 X
LV 0 1MW 60000Var 213 9A 163 3A 400V 144 5A 11MVA 110KTL3 11MW 66000Var alternergy co uk
mpattachments file viewonline id 4989 product 5058 |||

lang:en score:24 filesize: 100.85 K page count: 2 document date: 2024-07-24

Administrator Compatible Inverter list Infinity innovations UP 5000 HM8042 General Afore New Energy
Technology Shanghai Co Ltd AFX 5K SL aobo TBB Power CK II 2 0S 48V 2000W 25A SUPER L Must
Solar Uhome infinityinnovations co uk 2023 07 |||

lang:en score:24 filesize: 431.94 K page count: 4 document date: 2023-02-24

044 0088205 SPH4 10KTL3 BH UP 2024 4 26 cdr Administrator DownloadGrowatt inverter manual
Download 2025SPH 4000 10000TL3 UP User Manual EN 202404igrowattinverter 2025 02 SPH 202404
|||

Overview.....1 1.1

Information on this document 1

1.2 Target group

lang:en score:24 filesize: 10.11 M page count: 88 document date: 2024-04-26

044 0088200 SPH4 10KTL3 BH UP 2022 01 05 Administrator SPH 4000 10000TL3 User Manual EN
202201sadot energy co il 202201 |||

Download Manual Growatt New Energy Shenzhen Growatt New Energy Co., Ltd 4-
13/F,Building A,Sino-German Europe Industrial Park, Hangcheng Ave, Bao an
District, Shenzhen, China T 86 0755 2747 1942 E service ginverter.com W
www.qinverter.com GR-UM-226-A-01 Installation Operation Manual Content...

lang:en score:24 filesize: 5.11 M page count: 34 document date: 2023-12-28

[\[pdf\]](#) Specifications Decleration of Conformity Test Report

GFT OP 11a Sarah Linn Intertek CE LVD KonformitätsbescheinigungGrowatt 7 kW Wechselrichter SPH
7000TL3 BH UP inkl Smart Meter — PVDeals24SPH 4000 10000TL3 LVDcdn shopify s files 1 0728 2265
3271 v 1680099588 PVDeals24Download Baixar recursos úteis GrowattSPH
LVDfd1c1c937b3109a700b32333c67c6103cdn 1680099588br growatt upload file 20220829
fd1c1c937b3109a700b32333c67c6103 KonformitätsbescheinigungLVD certificationGrowatt

fd1c1c937b3109a700b3233c67cb103latam certificationLVD photovoltaicsGROWATT IvdSPH lvdfiles
ecoenergy product 6072 attachments LVDbr ||| ||| Certificate of Conformity Certificate Number: CN-PV-
210189 On the basis of the tests undertaken, the samples of the below product have been found to
comply with the requirements of the referenced specifications/standards at the time the tes ||| Certificate
of Conformity Certificate Number: CN-PV-210189 On the basis of the tests undertaken, the samples of
the below product have been found to comply with the requirements of the referenced
specifications/standards at the time the tes ||| Certificate of Conformity Certificate Number: CN-PV-
210189 On the basis of the tests undertaken, the samples of the below product have been found to
comply with the requirements of the referenced specifications/standards at the time the tes ||| Certificate
of Conformity Certificate Number: CN-PV-210189 On the basis of the tests undertaken, the samples of
the below product have been found to comply with the requirements of the referenced
specifications/standards at the time the tes ||| Certificate of Conformity Certificate Number: CN-PV-
210189 On the basis of the tests undertaken, the samples of the below product have been found to
comply with the requirements of the referenced specifications/standards at the time the tes ||| Certificate
of Conformity Certificate Number: CN-PV-210189 On the basis of the tests undertaken, the samples of
the below product have been found to comply with the requirements of the referenced
specifications/standards at the time the tes ||| Certificate of Conformity Certificate Number: CN-PV-
210189 On the basis of the tests undertaken, the samples of the below product have been found to
comply with the requirements of the referenced specifications/standards at the time the tes ||| Certificate
of Conformity Certificate Number: CN-PV-210189 On the basis of the tests undertaken, the samples of
the below product have been found to comply with the requirements of the referenced
specifications/standards at the time the tes ||| Certificate of Conformity Certificate Number: CN-PV-
210189 On the basis of the tests undertaken, the samples of the below product have been found to
comply with the requirements of the referenced specifications/standards at the time the tes ||| Certificate
of Conformity Certificate Number: CN-PV-210189 On the basis of the tests undertaken, the samples of
the below product have been found to comply with the requirements of the referenced
specifications/standards at the time the tes ||| Certificate of Conformity Certificate Number: CN-PV-
210189 On the basis of the tests undertaken, the samples of the below product have been found to
comply with the requirements of the referenced specifications/standards at the time the tes ||| Certificate
of Conformity Certificate Number: CN-PV-210189 On the basis of the tests undertaken, the samples of
the below product have been found to comply with the requirements of the referenced
specifications/standards at the time the tes ||| Certificate of Conformity Certificate Number: CN-PV-
210189 On the basis of the tests undertaken, the samples of the below product have been found to
comply with the requirements of the referenced specifications/standards at the time the tes

lang:en score:24 filesize: 222.46 K page_count: 3 document date: 2021-08-25

language: **en** file_size: 267.22 K page_count: 4 document_date: 2021-06-02

energySPH CertificateSPH VDE0126cdh 8334c2c118e3cb3524522a1564c901accdh 0672 1267 3291



VDE0126 1675283681 energyDescargar Descargar útiles 1675283681latam

KonformitätsbescheinigungSPA VDE0126DIN PVDeals24SPA Konut Tipi Depolama İnverter

GrowattGROWATT 1680099916tr 8334c2c1f8e3cb5524522af564c90facsklep

Certificatehybridwechselrichter sph 10000tl bh up konformit tserkl rungSPH

8334c2c1f8e3cb5524522af564c90facphotovoltaik shop mw link id 1034br

VDE0126cbaacf9b0d2d06a3996ff6f78d7fa379cdn cbaacf9b0d2d06a3996ff6f78d7fa379

GrowattTélécharger Télécharger des ressources utiles cbaacf9b0d2d06a3996ff6f78d7fa379fr

GrowattDescargar cbaacf9b0d2d06a3996ff6f78d7fa379latam VDE0126Certyfikat DIN 232 57KBDIN

10000 Hybrid WechselrichterGROWATT CertificateDIN V VDEhybridwechselrichter

8334c2c1f8e3cb5524522af564c90facpanpower eu de index controller attachment 10434sklep

57KBCertyfikat WechselrichterGrowatt 8000 Invertor Hibrid 8kWGROWATT VDEDIN 10434panpower ro

8kWGrowatt VäxelriktareGROWATT sv VDE0126SPA GrowattSPA

8334c2c1f8e3cb5524522af564c90factr cbaacf9b0d2d06a3996ff6f78d7fa379es certificationDIN

photovoltaicsGROWATT vdefiles ecoenergy product 6072 attachments VDEfr ||| ||| Certificate of

Conformity Certificate Number: CN-PV-210124 On the basis of the tests undertaken, the samples of the

below product have been found to comply with the requirements of the referenced specifications

/standards at the time the te ||| Certificate of Conformity Certificate Number: CN-PV-210124 On the basis

of the tests undertaken, the samples of the below product have been found to comply with the

requirements of the referenced specifications /standards at the time the te ||| Certificate of Conformity

Certificate Number: CN-PV-210124 On the basis of the tests undertaken, the samples of the below

product have been found to comply with the requirements of the referenced specifications /standards at

the time the te ||| Certificate of Conformity Certificate Number: CN-PV-210124 On the basis of the tests

undertaken, the samples of the below product have been found to comply with the requirements of the

referenced specifications /standards at the time the te ||| Certificate of Conformity Certificate Number: CN-

PV-210124 On the basis of the tests undertaken, the samples of the below product have been found to

comply with the requirements of the referenced specifications /standards at the time the te ||| Certificate of

Conformity Certificate Number: CN-PV-210124 On the basis of the tests undertaken, the samples of the

below product have been found to comply with the requirements of the referenced specifications

/standards at the time the te ||| Certificate of Conformity Certificate Number: CN-PV-210124 On the basis

of the tests undertaken, the samples of the below product have been found to comply with the

requirements of the referenced specifications /standards at the time the te ||| Certificate of Conformity

Certificate Number: CN-PV-210124 On the basis of the tests undertaken, the samples of the below

product have been found to comply with the requirements of the referenced specifications /standards at

the time the te ||| Certificate of Conformity Certificate Number: CN-PV-210124 On the basis of the tests

undertaken, the samples of the below product have been found to comply with the requirements of the

referenced specifications /standards at the time the te ||| Certificate of Conformity Certificate Number: CN-

PV-210124 On the basis of the tests undertaken, the samples of the below product have been found to

comply with the requirements of the referenced specifications /standards at the time the te ||| Certificate of

Conformity Certificate Number: CN-PV-210124 On the basis of the tests undertaken, the samples of the

below product have been found to comply with the requirements of the referenced specifications

/standards at the time the te ||| Certificate of Conformity Certificate Number: CN-PV-210124 On the basis

of the tests undertaken, the samples of the below product have been found to comply with the

requirements of the referenced specifications /standards at the time the te ||| Certificate of Conformity

Certificate Number: CN-PV-210124 On the basis of the tests undertaken, the samples of the below

product have been found to comply with the requirements of the referenced specifications /standards at

the time the te ||| Certificate of Conformity Certificate Number: CN-PV-210124 On the basis of the tests

undertaken, the samples of the below product have been found to comply with the requirements of the

referenced specifications /standards at the time the te ||| Certificate of Conformity Certificate Number: CN-

PV-210124 On the basis of the tests undertaken, the samples of the below product have been found to

comply with the requirements of the referenced specifications /standards at the time the te ||| Certificate of

Conformity Certificate Number: CN-PV-210124 On the basis of the tests undertaken, the samples of the

below product have been found to comply with the requirements of the referenced specifications

/standards at the time the te ||| Certificate of Conformity Certificate Number: CN-PV-210124 On the basis

of the tests undertaken, the samples of the below product have been found to comply with the

requirements of the referenced specifications /standards at the time the te ||| Certificate of Conformity

Certificate Number: CN-PV-210124 On the basis of the tests undertaken, the samples of the below

product have been found to comply with the requirements of the referenced specifications /standards at

the time the te ||| Certificate of Conformity Certificate Number: CN-PV-210124 On the basis of the tests

undertaken, the samples of the below product have been found to comply with the requirements of the

referenced specifications /standards at the time the te ||| Certificate of Conformity Certificate Number: CN-

PV-210124 On the basis of the tests undertaken, the samples of the below product have been found to

comply with the requirements of the referenced specifications /standards at the time the te

Certificate of Conformity Certificate Number: CN-PV-210124 On the basis of the tests

undertaken, the samples of the below product have been found to comply with the



lang:en score:24 filesize: 232.57 K page_count: 4 document date: 2021-06-02

GFT OP 11a Sarah Linn Intertek C10 11 KonformitätsbescheinigungGrowatt 7 kW Wechselrichter SPH
7000TL3 BH UP inkl Smart Meter — PVDDeals24SPH 4000 10000TL3 Certificatecdn shopify s files 1 0728
2265 3271 Certificate v 1680099997 PVDDeals24SPA Onduleur à couplage AC GrowattSPH
Certificate8996f024548c6424d3eb2a24f11b8812cdn 1680099997fr growatt upload file 20220829
8996f024548c6424d3eb2a24f11b8812 GrowattDownload Baixar recursos úteis
8996f024548c6424d3eb2a24f11b8812br GrowattDescargar Descargar útiles
Certificate66d2c5d4ce92a750638cde741590c871cdn 8996f024548c6424d3eb2a24f11b8812es
20220926 66d2c5d4ce92a750638cde741590c871 66d2c5d4ce92a750638cde741590c871es
KonformitätsbescheinigungSPA C11Growatt Konut Tipi Depolama İnverter GrowattSPA 1680099997tr
8996f024548c6424d3eb2a24f11b8812fr GrowattTélécharger Télécharger des ressources utiles
66d2c5d4ce92a750638cde741590c871br C11SPA 8996f024548c6424d3eb2a24f11b8812tr
66d2c5d4ce92a750638cde741590c871latam ||| ||| Certificate of Conformity Certificate Number: CN-PV-

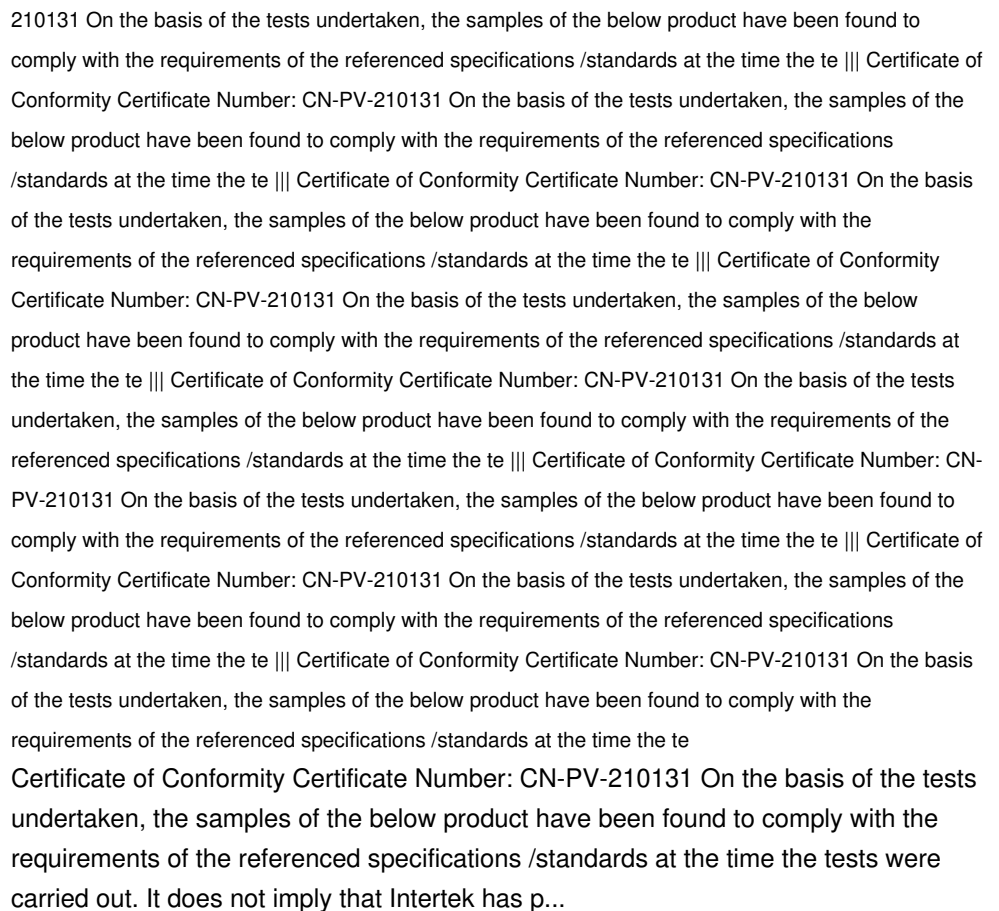

lang:en score:24 filesize: 268.79 K page_count: 4 document date: 2021-06-04

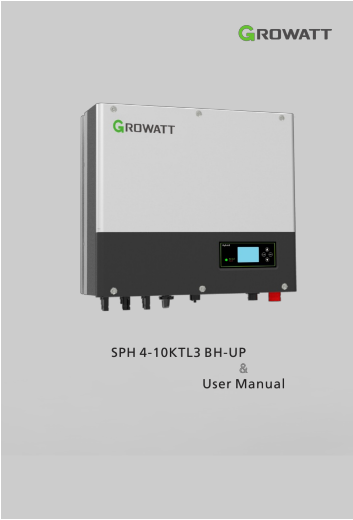

[\[pdf\]](#) User Manual Instructions

044 0088205 SPH4 10KTL3 BH UP 2024 4 26 cdr Administrator Manual SPH 10000TL3 BL UP
Invertor hibrid trifazat Growatt 5000TL3 Performanță eficientă și flexibilitate pentru aplicații rezidențiale in
index controller attachment id 431 e solare |||
SPH 4-10KTL3 BH-UP User Manual Contents 1
Overview.....1 1.1
Information on this document 1
1.2 Target group
lang:en score:24 filesize: 10.11 M page_count: 88 document date: 2024-04-26

[\[pdf\]](#) Specifications Declaration of Conformity Test Report

GFT OP 11a Sarah Linn Intertek SPA 4000 10000TL3 BH UP Onduleur à couplage AC
Growatt2621cbee6acf500800de278e3c48d55efr growatt upload file 20220829
2621cbee6acf500800de278e3c48d55e Growattfr GrowattDownload Baixar recursos úteis
2621cbee6acf500800de278e3c48d55ebr GrowattDescargar Descargar útiles
2621cbee6acf500800de278e3c48d55elatam TOR ErzeugerSPA Konut Tipi Depolama İnverter
GrowattSPA Growatttr 2621cbee6acf500800de278e3c48d55efr
Growatt0cf3fb282c03236bbdff0eccba2efc55tr 0cf3fb282c03236bbdff0eccba2efc55 GrowattTélécharger
Télécharger des ressources utiles 0cf3fb282c03236bbdff0eccba2efc55fr
0cf3fb282c03236bbdff0eccba2efc55latam 2621cbee6acf500800de278e3c48d55etr
0cf3fb282c03236bbdff0eccba2efc55es ||| ||| Certificate of Conformity Certificate Number: CN-PV-210130
On the basis of the tests undertaken, the samples of the below product have been found to comply with
the requirements of the referenced specifications /standards at the time the te ||| Certificate of Conformity
Certificate Number: CN-PV-210130 On the basis of the tests undertaken, the samples of the below
product have been found to comply with the requirements of the referenced specifications /standards at
the time the te ||| Certificate of Conformity Certificate Number: CN-PV-210130 On the basis of the tests
undertaken, the samples of the below product have been found to comply with the requirements of the
referenced specifications /standards at the time the te ||| Certificate of Conformity Certificate Number: CN-
PV-210130 On the basis of the tests undertaken, the samples of the below product have been found to
comply with the requirements of the referenced specifications /standards at the time the te ||| Certificate of
Conformity Certificate Number: CN-PV-210130 On the basis of the tests undertaken, the samples of the
below product have been found to comply with the requirements of the referenced specifications
/standards at the time the te ||| Certificate of Conformity Certificate Number: CN-PV-210130 On the basis
of the tests undertaken, the samples of the below product have been found to comply with the
requirements of the referenced specifications /standards at the time the te ||| Certificate of Conformity
Certificate Number: CN-PV-210130 On the basis of the tests undertaken, the samples of the below
product have been found to comply with the requirements of the referenced specifications /standards at
the time the te
Certificate of Conformity Certificate Number: CN-PV-210130 On the basis of the tests
undertaken, the samples of the below product have been found to comply with the
requirements of the referenced specifications /standards at the time the tests were
carried out. It does not imply that Intertek has p...
lang:en score:24 filesize: 272.93 K page_count: 5 document date: 2021-06-04

