

EPEVER MT52

EPEVER MT52 Remote Control Unit Instruction Manual

Model: MT52

1. PRODUCT OVERVIEW

The EPEVER MT52 is a remote control unit designed for monitoring and setting parameters of EPEVER MPPT solar charge controllers. It provides real-time system data, error alarms, and status information through a clear LCD display, enhancing user control and system management.

1.1 Key Features

- **Compatibility:** Compatible with EPEVER controllers featuring an RS485 interface.
- **Battery Support:** Suitable for Gel, AGM, lead-acid, and lithium batteries.
- **Display:** Large multi-function LCD for real-time data, error alarms, and status.
- **User Interface:** Simple navigation via 6 function keys.
- **Power Supply:** Directly powered via RJ45 communication cable from the controller; no external power required.
- **Remote Control:** Enables remote load switching and parameter adjustment.

2. SAFETY INSTRUCTIONS

Please read all instructions carefully before installation and operation. Failure to follow these instructions may result in damage to the unit, the controller, or other components, and may void the warranty.

- Ensure the MT52 is connected only to compatible EPEVER solar charge controllers.
- Avoid exposing the unit to direct sunlight, high temperatures, or high humidity.
- Do not disassemble or attempt to repair the MT52 unit. Contact qualified personnel for service.
- Keep the unit away from water and other liquids.
- Ensure proper ventilation around the unit.

3. PACKAGE CONTENTS

Verify that all items listed below are included in your package:

- EPEVER MT52 Remote Control Unit
- Communication Cable (RJ45, approximately 2 meters)

- Mounting Screws (4 pieces)
- Rubber Feet (4 pieces)



Image 3.1: EPEVER MT52 Remote Control Unit with included communication cable, mounting screws, and rubber feet.

4. SETUP AND INSTALLATION

4.1 Mounting the MT52

The MT52 unit can be surface-mounted using the provided screws. Choose a location that is easily accessible for viewing and operation, and away from direct sunlight or heat sources.

4.2 Wiring Connection

The MT52 connects to your EPEVER solar charge controller via the supplied RJ45 communication cable. Locate the RS485 communication port on your charge controller and the corresponding port on the back of the MT52 unit. Insert the RJ45 connectors firmly into both ports.

The MT52 draws its power directly from the charge controller through this communication cable, eliminating the need for an external power supply.



Image 4.1: Rear view of the MT52 unit, highlighting the RJ45 communication port for connection to the solar charge controller.

ZUBEHÖRANSCHLUSS

* Zubehör **NICHT** im Lieferumfang enthalten

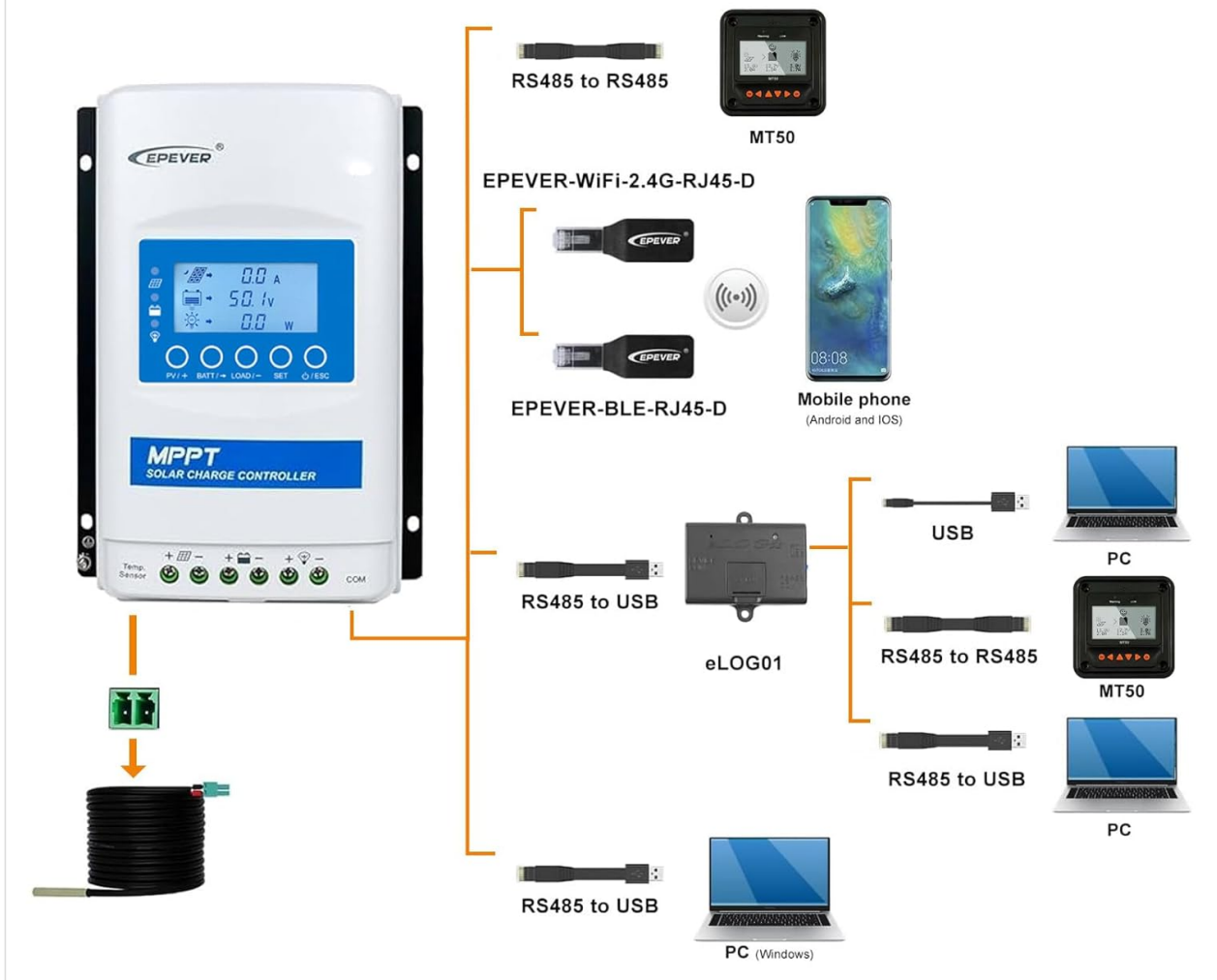

Image 4.2: Illustrative diagram demonstrating the connection of the MT52 remote control unit to an EPEVER solar charge controller within a typical solar power system setup, including solar panel, battery, and load.

5. OPERATING INSTRUCTIONS

Once connected, the MT52 will power on automatically and display the current system status. The unit features an LCD screen and six function buttons for navigation and parameter adjustment.

5.1 Display Interface

The LCD displays various parameters such as battery voltage, charging current, load current, and system status icons (e.g., solar charging, battery status, load status). Error alarms will also be indicated on the display.



Image 5.1: Front view of the MT52 display, showing real-time system parameters such as solar input, battery voltage, and load status.

5.2 Button Functions

- **ESC:** Exits the current menu or returns to the previous screen.
- **Up/Down Arrows:** Navigates through menu options or adjusts parameter values.
- **Left/Right Arrows:** Moves between different display screens or menu items.
- **OK:** Confirms a selection or enters a menu.

5.3 Navigation and Parameter Setting

Use the arrow keys to navigate through the various display screens to view different system parameters. To enter the settings menu, typically press and hold the 'OK' button or navigate to a specific settings icon and press 'OK'. Within the settings menu, use the arrow keys to select parameters and adjust their values. Confirm changes with the 'OK' button and exit with 'ESC'.



Image 5.2: Close-up of the MT52 display and its six function buttons, used for navigating menus and adjusting settings.

6. TECHNICAL SPECIFICATIONS

- **Self-consumption:**
 - Backlight active: < 23mA
 - Backlight inactive: < 15mA
- **Communication Port:** RJ45
- **Communication Cable Length:** 2 meters
- **Ambient Temperature:** -20°C to +70°C
- **Dimensions (L x W x H):** 11.4 cm x 11.4 cm x 3.3 cm
- **Weight:** 0.23 kg
- **Material:** Plastic
- **Display Type:** LCD

Tipp zum Einbau

BATTERIEMODUS

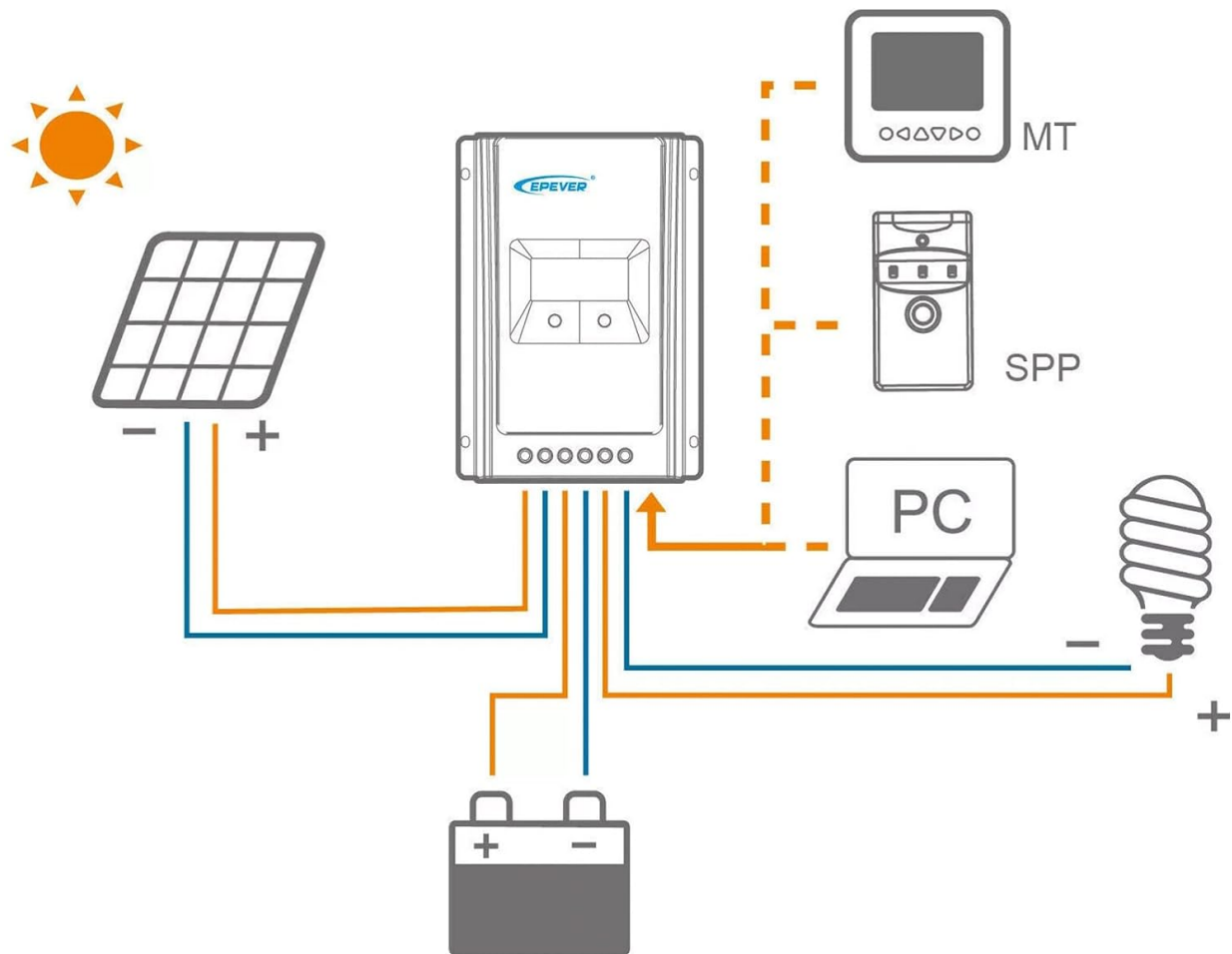

Image 6.1: Illustration of the physical dimensions and weight of the EPEVER MT52 unit, indicating its compact form factor.

7. TROUBLESHOOTING

If you encounter issues with your MT52 unit, consider the following:

- **No Display/Power:** Ensure the RJ45 communication cable is securely connected to both the MT52 and the solar charge controller. Verify that the solar charge controller is powered on and functioning correctly.
- **Incorrect Readings:** Confirm that the MT52 is connected to a compatible EPEVER controller. Check the controller's own display for comparison.
- **Buttons Unresponsive:** Try disconnecting and reconnecting the MT52. If the issue persists, contact support.
- **Communication Error:** Check the RJ45 cable for damage. Ensure the controller's firmware is up to date if applicable.

For more detailed troubleshooting, refer to the instruction manual of your specific EPEVER solar charge controller.

8. MAINTENANCE

The EPEVER MT52 remote control unit requires minimal maintenance:

- Keep the unit clean and free from dust using a soft, dry cloth.
- Avoid using abrasive cleaners or solvents.
- Ensure the communication cable connections remain secure.
- Periodically check for any physical damage to the unit or cable.





9. WARRANTY AND SUPPORT

The EPEVER MT52 Remote Control Unit comes with a **2-year manufacturer's warranty** from the date of purchase. This warranty covers defects in materials and workmanship under normal use.

For warranty claims, technical support, or any questions regarding the operation of your MT52 unit, please contact your retailer or EPEVER customer service directly. Please have your purchase receipt and product model number available when contacting support.

Certifications: CE certified.

Related Documents - MT52

 <p>Advanced MPPT Charge Controller: XTRA-N G3</p> <p>What is XTRA-N G3 charge controller?</p> <p>The XTRA-N G3 series solar charge controller is designed to provide the maximum power transfer from your solar panels to your battery bank. It features a high-efficiency MPPT algorithm, a built-in LCD display, and a variety of protection features to ensure the safety and longevity of your solar system. The XTRA-N G3 is available in 12V and 24V versions, with power ratings up to 150A.</p>	<p>EPEVER XTRA-N G3 Advanced MPPT Charge Controller</p> <p>Detailed information on the EPEVER XTRA-N G3 Advanced MPPT Charge Controller, including features, naming conventions, setup guide, and accessories for solar off-grid systems.</p>
 <p>Advanced MPPT Charge Controller: XTRA-N G3</p> <p>What is XTRA-N G3 charge controller?</p> <p>The XTRA-N G3 series solar charge controller is designed to provide the maximum power transfer from your solar panels to your battery bank. It features a high-efficiency MPPT algorithm, a built-in LCD display, and a variety of protection features to ensure the safety and longevity of your solar system. The XTRA-N G3 is available in 12V and 24V versions, with power ratings up to 150A.</p>	<p>EPEVER XTRA-N G3 Advanced MPPT Charge Controller: Features, Setup, and Specifications</p> <p>Comprehensive guide to the EPEVER XTRA-N G3 series Advanced MPPT Charge Controller. Covers product features, naming conventions, unique functionalities like constant voltage output and over-current protection, installation steps, wiring diagrams, load working modes, and available accessories for solar off-grid systems.</p>
 <p>Remote Meter User Manual</p> <p>MT52</p>	<p>EPEVER MT52 Remote Meter User Manual</p> <p>User manual for the EPEVER MT52 remote meter, covering installation, operation, features, and technical specifications for solar charge controllers. Learn how to monitor and manage your solar system.</p>
 <p>Remote Meter User Manual</p> <p>MT52</p>	<p>EPEVER MT52 Remote Meter User Manual: Installation, Operation, and Specifications</p> <p>Comprehensive user manual for the EPEVER MT52 Remote Meter. Covers installation, product features, operation, technical specifications, and troubleshooting for compatible solar charge controllers.</p>

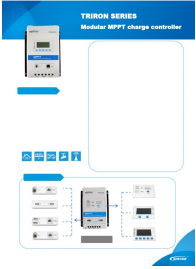

[EPEVER TRIRON Series Modular MPPT Charge Controller](#)

Detailed information on the EPEVER TRIRON Series of modular MPPT solar charge controllers, including product models, features, protection functions, naming rules, interface modules, accessories, and electrical parameters.

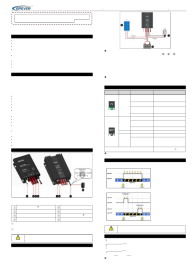

[EPEVER Tracer BP MPPT Solar Charge Controller User Manual & Technical Specifications](#)

Explore the EPEVER Tracer BP MPPT Solar Charge Controller user manual, featuring advanced Maximum Power Point Tracking technology for efficient solar charging. Learn about its features, wiring, LED indicators, load working modes, comprehensive protection mechanisms, troubleshooting, and detailed technical specifications for various battery types including sealed, gel, flooded, and lithium batteries. Ideal for solar home systems, traffic signals, solar street lights, and garden lamps.