

HOTUT HOTUS-MTD-2PCS-FBA

HOTUT Toilet Night Light with Motion Sensor and Star Projector - Instruction Manual

Model: HOTUS-MTD-2PCS-FBA

INTRODUCTION

This manual provides detailed instructions for the setup, operation, and maintenance of your HOTUT Toilet Night Light. This device features motion activation, light sensing, 16 color options, and an integrated star projector, designed to enhance visibility and ambiance in your bathroom during nighttime hours.

WHAT'S IN THE BOX

- HOTUT Toilet Night Light Unit (2 pieces)
- USB Charging Cable
- Instruction Manual (this document)

PRODUCT FEATURES

- **Motion Sensor Activation:** Automatically turns on when motion is detected in the dark.
- **Light Sensing:** Operates only in low-light conditions to conserve battery.
- **16 LED Colors:** Offers a selection of 16 distinct colors or a color rotation mode.
- **Star Projector:** Projects a starry pattern onto the floor or ceiling.
- **USB Rechargeable:** Built-in rechargeable battery eliminates the need for frequent battery replacement.
- **Flexible Arm:** Allows for secure attachment to various toilet bowl sizes.

Motion-activated LED Night Light

Colorful Fun Toilet
with 16 Colours



Hassle Free
Installation



Fits Any Toilet



Makes Potty
Training Fun



Image: The HOTUT Toilet Night Light illuminating a toilet bowl with a yellow light and projecting a star pattern onto the floor.

SETUP INSTRUCTIONS

1. **Charge the Device:** Before first use, fully charge the toilet night light using the provided USB cable. Connect the cable to the charging port on the device and a standard USB power adapter (not included). The charging indicator light will be red during charging and turn green when fully charged.

Motion-activated LED Night Light

Red light on when charging, green light on when fully charged

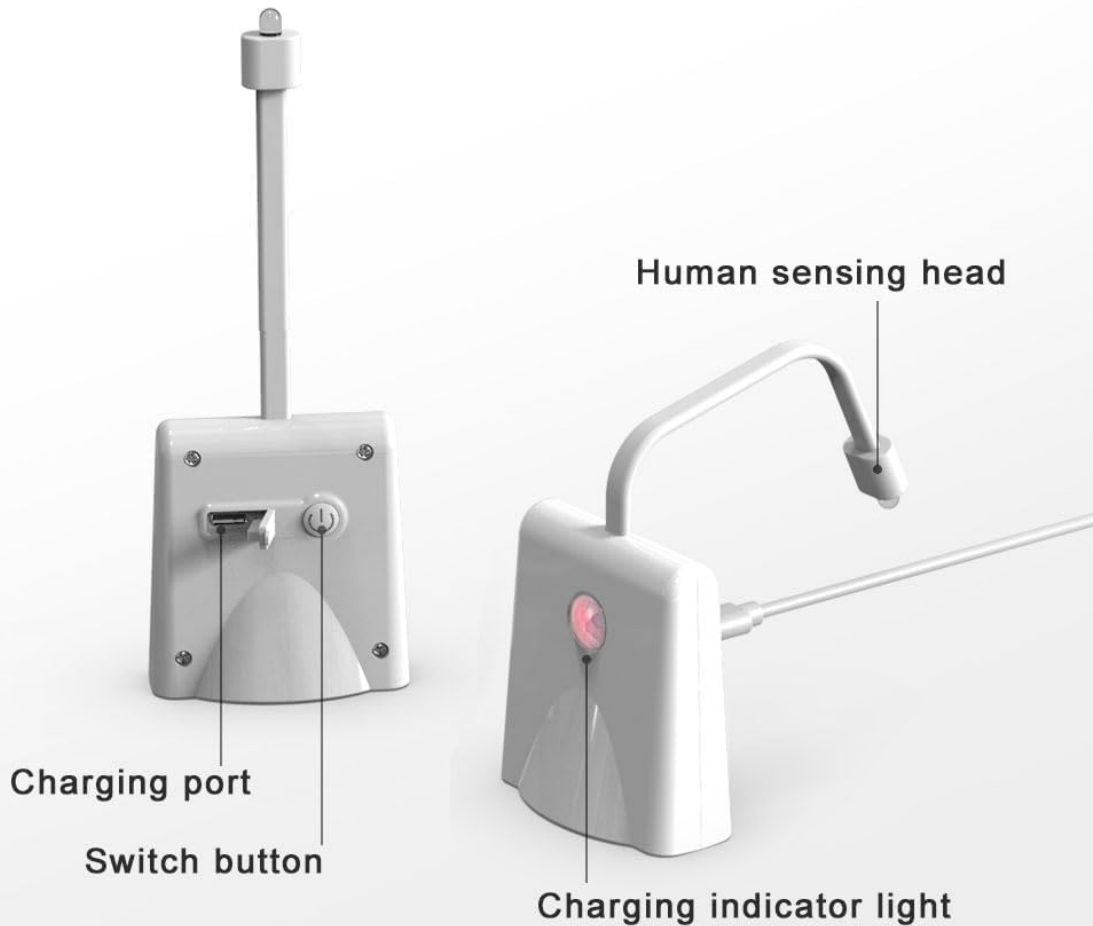

Image: Detailed view of the device's back, highlighting the charging port, switch button, and motion sensor.

2. **Positioning:** Bend the flexible arm to fit over the rim of your toilet bowl. Ensure the motion sensor (human sensing head) faces outwards towards the area where movement will occur, and the LED light is positioned inside the bowl. The projector lamp is located at the bottom of the main unit.

Product Specific Information



Image: Diagram illustrating the various parts of the toilet night light and its dimensions.

3. **Secure Attachment:** Adjust the flexible arm to ensure the device is securely attached and stable on the toilet rim.

OPERATING INSTRUCTIONS

1. **Power On/Off:** Press the switch button once to turn on the device. Press it again to cycle through modes or turn off.
2. **Motion and Light Sensing:** The device is designed to activate automatically in dark environments when motion is detected within a range of 0-4 meters and a 120-degree angle. It will remain illuminated for approximately 90 seconds after motion ceases. It will not activate in bright conditions.



Image: Illustration of the night light's motion and light sensing, showing it off during the day and active at night.

3. Changing Colors:

- When the device is on, click the switch button to cycle through the 16 available colors.
- To activate the color rotation (Rainbow Mode), continue clicking until the light begins to automatically cycle through all colors.
- To select a fixed color during color rotation, press the switch button once when your desired color is displayed. The light will then remain on that color.



Image: The toilet night light displaying a purple hue, with a visual guide to the 16 available LED colors.

4. Star Projector Function:

- The star projector is located at the bottom of the main unit.
- To turn the projector light on or off, **long press** the switch button. This function operates independently of the toilet bowl light.

Projection lights can be individually switched on and off

Long press button: turn on/off the projector light



Image: Comparison showing the toilet night light with the projector off and with the star projector activated.

MAINTENANCE

- **Cleaning:** Wipe the device with a damp cloth. Do not submerge the unit in water. Avoid using harsh chemicals or abrasive cleaners.
- **Charging:** Recharge the device when the light dims or stops functioning. Battery life varies depending on usage frequency.
- **Storage:** If storing for an extended period, ensure the device is fully charged and stored in a cool, dry place.

TROUBLESHOOTING

Problem	Possible Cause	Solution
Light does not turn on.	Insufficient battery charge. Environment is too bright. No motion detected.	Recharge the device. Ensure the room is dark enough for activation. Verify motion sensor is unobstructed and facing the detection area.
Light turns on but colors do not change.	Stuck in fixed color mode.	Press the switch button repeatedly to cycle through colors or enter rainbow mode.

Problem	Possible Cause	Solution
Star projector does not work.	Projector is turned off.	Long press the switch button to activate the projector.
Battery life is shorter than expected.	High frequency of activation. Aging battery.	Reduce traffic in the detection area if possible. Ensure full charge cycles.

SPECIFICATIONS

Brand	HOTUT
Model Number	HOTUS-MTD-2PCS-FBA
Power Source	Battery Powered (USB Rechargeable)
Light Source Type	LED
Number of Light Colors	16
Motion Sensor Range	0-4 meters, 120 degrees
Material	Plastic (Acrylonitrile Butadiene Styrene, Polyvinyl Chloride)
Product Dimensions	3.93"D x 2.95"W x 2.3"H (Main Unit)
Item Weight	5.3 ounces
Water Resistance Level	Not Water Resistant (Wipe clean only)

WARRANTY INFORMATION

HOTUT products are manufactured to high-quality standards. For specific warranty details, please refer to the product packaging or contact customer support. Keep your purchase receipt as proof of purchase.

CUSTOMER SUPPORT

If you have any questions, concerns, or require assistance with your HOTUT Toilet Night Light, please contact our customer support team through the retailer's platform or visit the official HOTUT website for contact information.