

## SAHAUHY WTE80A-025T

# SAHAUHY 80 Pints ENERGY STAR Dehumidifier

MODEL: WTE80A-025T

### User Manual

#### Introduction

The SAHAUHY 80 Pints ENERGY STAR Dehumidifier is designed to efficiently remove excess moisture from large indoor spaces, improving air quality and comfort. This unit is ideal for areas up to 5,200 square feet, including basements, garages, bedrooms, and living rooms. It features multiple operating modes, adjustable fan speeds, and convenient drainage options.

#### Key Features:

- Removes up to 80 pints of moisture per day.
- ENERGY STAR Certified for energy efficiency.
- Easy-to-use controls with automatic humidity settings.
- Multiple drainage options: manual, continuous drain hose, or compatible with garden hose.
- Humanized features: 4 modes (Sleep, Living, Basement, Continuous), adjustable fan speeds, 24-hour timer, built-in 360° wheels and handle, auto restart, auto defrost, low-noise operation, power outage restart, child lock, and removable washable filter.

#### Safety Information

Please read all safety instructions carefully before operating the dehumidifier to prevent injury or damage. Keep this manual for future reference.

- **USE ON SINGLE OUTLET CIRCUIT ONLY:** A damaged power supply cord must be replaced with a new power supply cord obtained from the product manufacturer and not repaired.
- **DANGER - Risk of Fire Or Explosion:** Flammable Refrigerant Used. To Be Repaired Only By Trained Service Personnel. Do Not Puncture Refrigerant Tubing.
- **CAUTION - Risk Of Fire Or Explosion:** Dispose Of Property In Accordance With Federal Or Local Regulations. Flammable Refrigerant Used.
- Always disconnect power before servicing the unit.

- Ensure the unit is placed on a stable, level surface.
- Do not block air inlets or outlets.

## Setup

Follow these steps to set up your SAHAUHY Dehumidifier:

1. **Unpacking:** Carefully remove the dehumidifier and all accessories from the packaging. Inspect the unit for any shipping damage.
2. **Placement:** Place the dehumidifier in an area where humidity control is desired. Ensure there is at least 8 inches of space around the unit for proper airflow. The unit is equipped with 360° rotatable wheels for easy movement.
3. **Power Connection:** Plug the 64-inch power cord into a single, grounded electrical outlet.
4. **Drainage Options:** Your dehumidifier offers three drainage methods:



Front view of the SAHAUHY 80 Pints Dehumidifier, showing the water tank level indicator.

# 4 Modes to Suit Your Needs

## Living Area Mode



## Sleeping Area Mode



## Basement Mode



## Continuous Mode



This image illustrates the three available drainage methods: Manual Draining using the 1.14-gallon water tank, Automatic Drainage with the included 3.3 ft drain hose, and Portable Drainage compatible with a garden hose (not included).

- **Manual Draining:** The dehumidifier collects water in the 1.14-gallon water tank. When the tank is full, the unit will automatically stop and an indicator will light up. Carefully remove and empty the tank, then reinsert it.
- **Automatic Drainage:** For continuous operation without emptying the tank, connect the included 3.3 ft drain hose to the drainage port at the back of the unit. Ensure the hose is positioned below the drain outlet to allow gravity drainage into a suitable receptacle or floor drain.
- **Portable Drainage (Garden Hose Compatible):** If the included hose is not long enough, you can connect a standard garden hose (purchased separately) to the drainage port for continuous draining.

## Operating Instructions

Your SAHAUHY Dehumidifier features a smart control panel for easy operation.

## Perfect for Various Indoor Places



Detailed view of the dehumidifier's smart control panel, highlighting Power, Mirage, Filter, Fan Speed, Humidity adjustment, Mode, and Timer buttons, along with indicators for various settings and bucket full status.

1. **Power On/Off:** Press the **POWER** button to turn the unit on or off.
2. **Setting Humidity:** Use the **HUMIDITY %** up/down arrows to set your desired humidity level. The unit will automatically operate to maintain this level, stopping when reached and restarting if humidity rises. The adjustable range is typically between 30% and 80%.
3. **Operating Modes:** Press the **MODE** button to cycle through the four available modes:
  - **Sleep Mode:** Operates quietly for undisturbed rest.
  - **Living Mode:** Standard operation for general living areas.
  - **Basement Mode:** Optimized for higher humidity environments like basements.
  - **Continuous Mode:** Runs continuously regardless of humidity level, ideal for very damp conditions or when using continuous drainage.

# Optional Draining Methods

Three drainage methods can be chosen according to the effect you want, how convenient!



**Manual Draining**  
1.14 gallon water tank



**Automatic Drainage**  
3.28 ft drain hose (Include)



**Portable Drainage**  
Compatible with garden hose (Not Include)

## Automatic drainage hose connection precautions

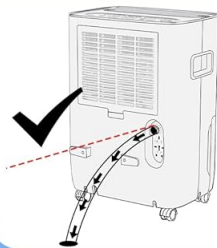

Ensure the drain hose is always positioned below the horizontal line.

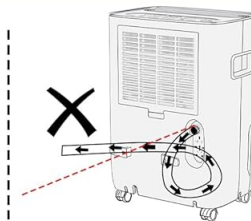

The drain hose cannot be above the drain outlet as this will cause water to back up into the bucket.

This image displays the four distinct operating modes: Living Area Mode, Sleeping Area Mode, Basement Mode, and Continuous Mode, each designed for specific environmental needs.

4. **Fan Speed:** Press the **FAN SPEED** button to select between Low, Medium, and High fan speeds.
5. **24-Hour Timer:** Use the **TIMER** button to set a delayed start or stop time for the unit, up to 24 hours.
6. **Child Lock:** Activate the child lock feature to prevent accidental changes to settings.
7. **Auto Restart:** In case of a power outage, the unit will automatically restart with the previous settings once power is restored.
8. **Auto Defrost:** The dehumidifier is equipped with an auto defrost function to ensure efficient operation even in colder conditions, preventing ice buildup on coils.

## Official Product Video: Operation Overview

Your browser does not support the video tag.

This video provides a comprehensive overview of the SAHAUHY 80 Pints Dehumidifier, demonstrating its key features, ease of movement with 360° wheels, fast dehumidification capabilities, water tank capacity, overflow protection, manual and automatic drainage options, reusable filter, and smart control panel functions including humidity setting, fan speed, modes, timer, and child lock. It also shows the unit in various settings like office, basement, bedroom, and living room.

## Maintenance

Regular maintenance ensures optimal performance and longevity of your dehumidifier.

1. **Emptying the Water Tank:** If using manual drainage, empty the 1.14-gallon water tank when the 'Bucket Full' indicator lights up. Pull the tank out, discard the collected water, and slide it back into place until it clicks securely.
2. **Cleaning the Air Filter:** The dehumidifier features a detachable and washable air filter. It is recommended to clean the filter every 30 days or more frequently depending on usage and air quality.

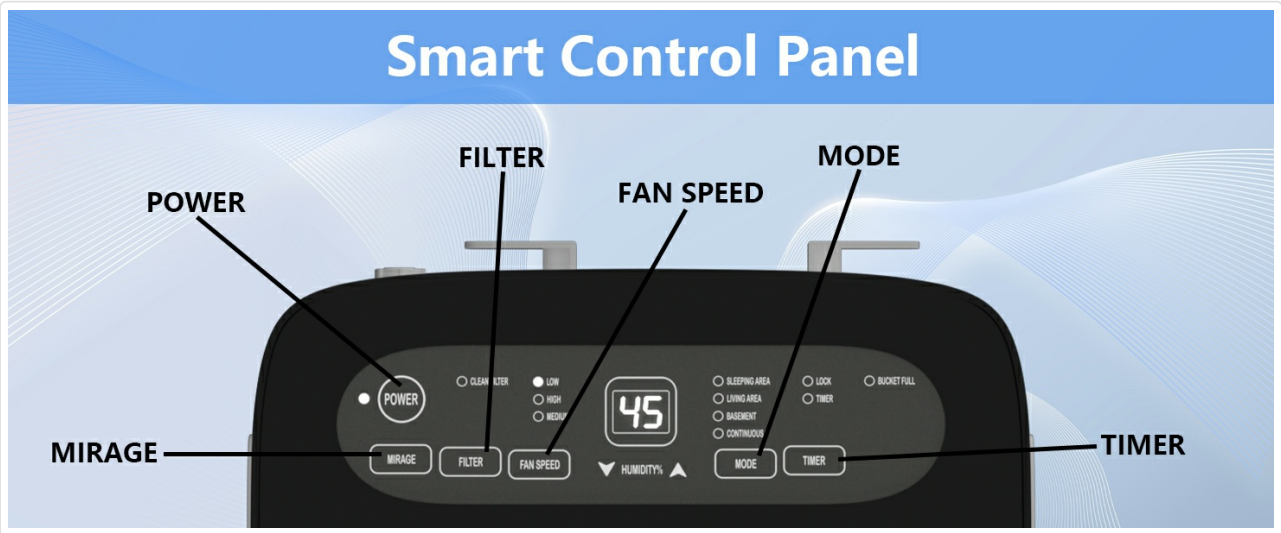

This image demonstrates the process of removing and washing the dehumidifier's air filter, which should be done regularly to maintain efficiency.

To clean the filter:

- Turn off and unplug the unit.
  - Remove the filter from the back of the unit.
  - Wash the filter with warm, soapy water. Rinse thoroughly.
  - Allow the filter to air dry completely before reinserting it into the unit.
- **General Cleaning:** Wipe the exterior of the unit with a soft, damp cloth. Do not use harsh chemicals or abrasive cleaners.

## Troubleshooting

If you encounter issues with your dehumidifier, refer to the following common problems and solutions:

Problem	Possible Cause	Solution
Dehumidifier does not turn on.	No power, power cord unplugged, circuit breaker tripped.	Check power connection, ensure outlet is functional, reset circuit breaker.
Unit runs but does not dehumidify.	Air filter clogged, room temperature too low, humidity setting too high, unit size too small for space.	Clean air filter, ensure room temperature is above 41°F (5°C), lower humidity setting, consider unit capacity for room size.

Problem	Possible Cause	Solution
Water tank is full, but unit is not stopping.	Water tank not properly seated, float switch malfunction.	Ensure water tank is fully inserted and correctly aligned. Contact customer support if issue persists.
Unit is noisy.	Unit not on a level surface, fan obstruction.	Place unit on a firm, level surface. Check for any obstructions in the fan area.

For further assistance, please contact SAHAUHY Customer Support.

## Specifications

Attribute	Value
Brand	SAHAUHY
Model Name	WTE80A-025T
Floor Area Coverage	5200 Square Feet
Dehumidification Capacity	80 Pints per Day
Tank Volume	1.14 Gallons
Product Dimensions	9.8"D x 13.4"W x 19.5"H
Item Weight	34.4 pounds
Color	White
Material	Plastic, Metal
Number of Speeds	3
Wattage	275 watts
Operation Modes	Sleep Mode, Living Mode, Basement Mode, Continuous Mode
Air Flow Capacity	9500 CFPH
Upper Temperature Rating	90 Degrees Fahrenheit
Included Components	1 x 64 in Power Cord, 1 x 3.3 Ft Drain Hose, 1 x 1.14 Gallons Water Tank, 1 x Detachable & Washable Filter, 1 x SAHAUHY 80 Pints Dehumidifier

Attribute	Value
UPC	742970910049

### Warranty and Support

SAHAUHY stands behind the quality of its products.

- **30-Day Money Back Guarantee:** If you are not satisfied with the product.
- **1-Year Warranty:** Standard warranty coverage.
- **2nd Year Warranty Extension:** Refer to the user manual for details on how to extend your warranty.
- **Lifetime Expert Tech Support:** For any questions or issues, please feel free to contact SAHAUHY customer support. They aim to reply within 24 hours and assist with problem resolution.

For support, please refer to the contact information provided in your product packaging or visit the official SAHAUHY website.