

EMKE UOLM03DTXXX1

EMKE Bathroom LED Mirror User Manual

Model: UOLM03DTXXX1

1. PRODUCT OVERVIEW

The EMKE Bathroom LED Mirror is a modern, frameless round mirror designed to enhance your bathroom, corridor, bedroom, or dressing area. It features integrated LED lighting, touch control, adjustable brightness, and a memory function to recall your last brightness setting. Its bright mirror surface provides a clearer image compared to ordinary mirrors, making it ideal for daily use.



Image: The EMKE Bathroom LED Mirror with its integrated LED lighting, installed above a modern sink in a bathroom setting.

2. IMPORTANT SAFETY INFORMATION

Please read all instructions carefully before installation and use. Keep this manual for future reference.

- Ensure the power supply is disconnected before installation or maintenance.
- Installation should be performed by a qualified electrician if you are unsure.
- Do not expose the mirror to excessive moisture or direct water spray.
- Handle the mirror with care to prevent damage to the glass or internal components.
- Keep out of reach of children.

3. PACKAGE CONTENTS

Verify that all components are present and undamaged before proceeding with installation.

- 1 x EMKE Bathroom LED Mirror

- Installation Instructions
- Mounting Accessories

4. INSTALLATION GUIDE

The EMKE LED Mirror is designed for wall mounting. Follow these general steps for installation. Refer to the detailed installation instructions included in your package for specific diagrams and hardware usage.

1. **Prepare the Wall:** Choose a suitable location on a solid wall, ensuring there are no hidden electrical wires or pipes. Mark the desired height and center point for the mirror.
2. **Mounting Bracket Installation:** Secure the mounting bracket to the wall using the provided screws and anchors. Ensure the bracket is level and firmly attached.
3. **Electrical Connection:** Connect the mirror's electrical wiring to your home's electrical system. This step should be performed by a qualified professional if you are not experienced with electrical work. Ensure power is off at the circuit breaker before connecting.
4. **Hang the Mirror:** Carefully lift the mirror and align it with the wall bracket. Gently lower the mirror onto the bracket until it is securely seated.
5. **Test Functionality:** Restore power and test the mirror's LED light and touch controls.

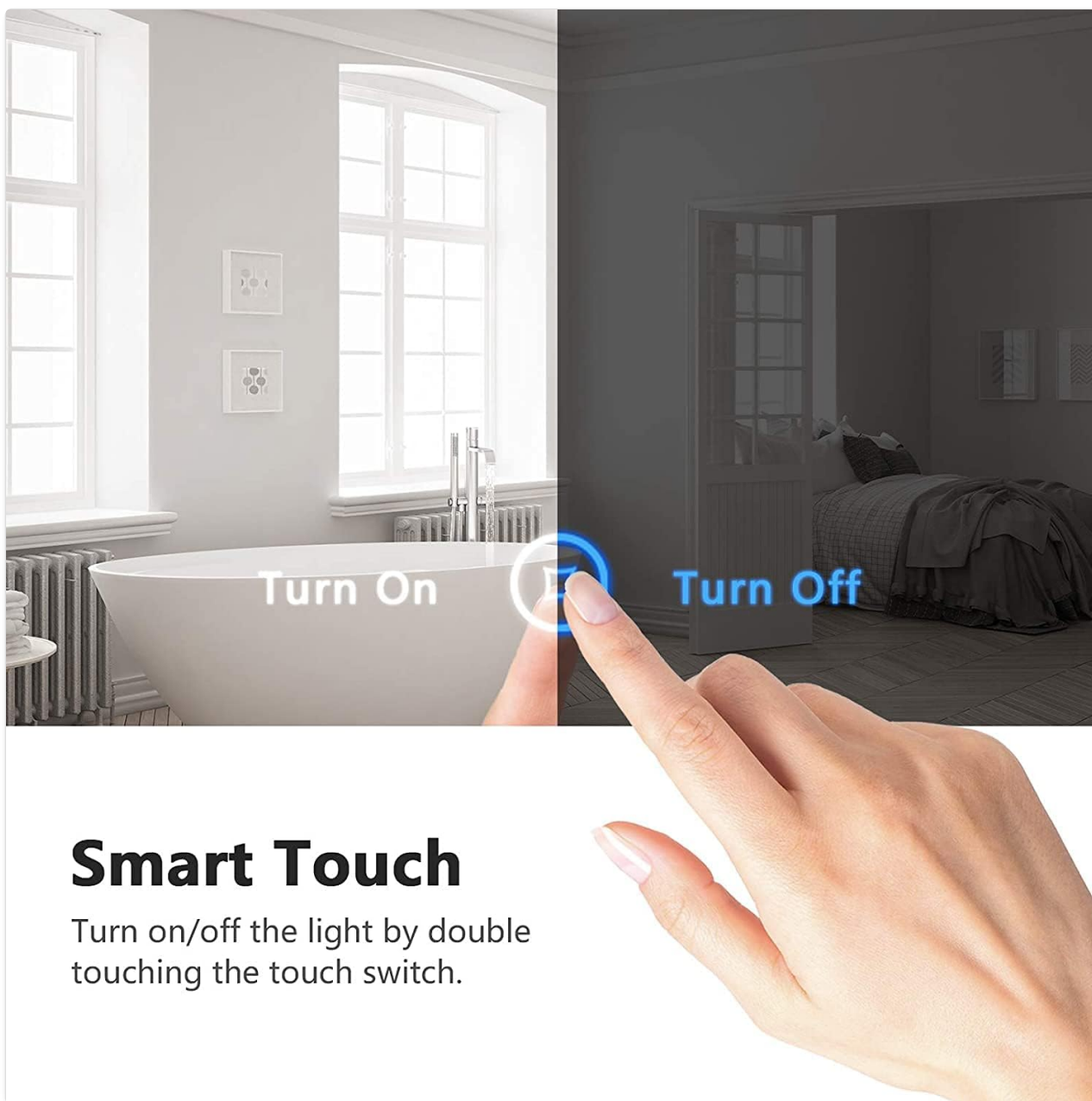

Image: The EMKE Bathroom LED Mirror seamlessly integrated into a modern bathroom design, illustrating a typical installation environment.

5. OPERATING INSTRUCTIONS

The EMKE LED Mirror features intuitive touch controls for easy operation of its lighting functions.

5.1. Smart Touch Control (On/Off)

To turn the LED light on or off, gently touch the designated touch switch on the mirror surface. The switch illuminates white when the light is on and blue when it is off, making it easy to locate in the dark.

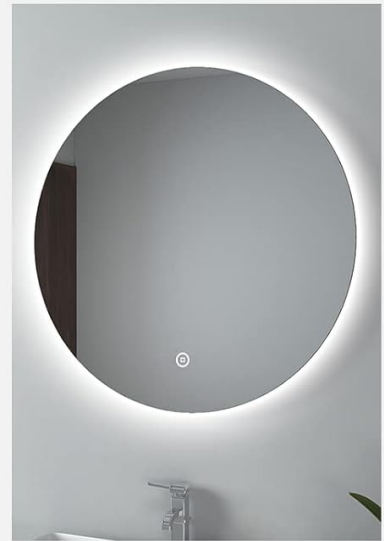

10%

50%

100%

Adjusting Brightness

Long press the light button to adjust the brightness of the mirror from 10% to 100%



Image: Visual representation of the smart touch control, demonstrating how to turn the mirror light on and off by touching the switch.

5.2. Brightness Adjustment

To adjust the brightness of the LED light, press and hold the touch switch. The brightness will cycle between 10% and 100%. Release your finger when the desired brightness level is reached.

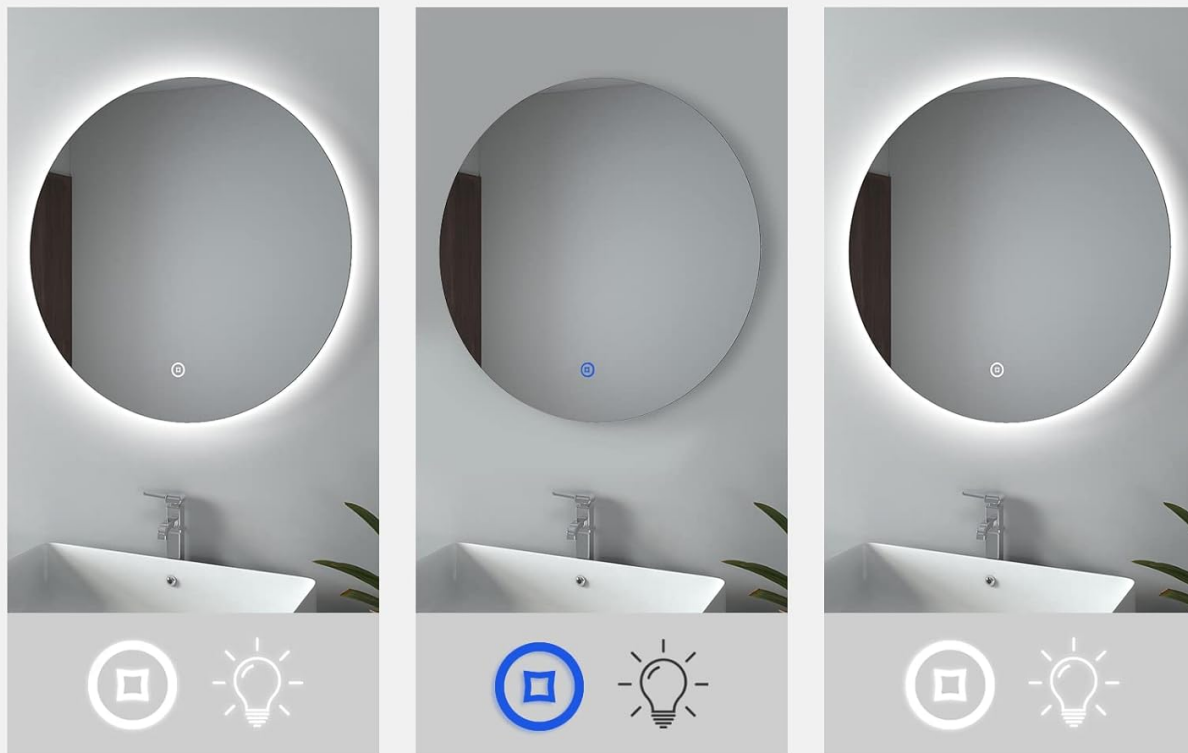

Brightness Memory

Turn on the light, turn off and turn on the light again, the mirror can remember last color.



Image: A visual guide showing the range of brightness adjustment from 10% to 100% by pressing and holding the light button.

5.3. Memory Function

The mirror is equipped with a memory function. It will remember the last brightness setting you used. When you turn the mirror light off and then on again, it will automatically return to the previously set brightness level, saving you the need to readjust it each time.



High Color Rendering Index

The higher the CRI is, the clearer the reflection displays.
Our HD mirror offers a crystal clear image (CRI > 90).

Image: Illustration of the brightness memory feature, showing how the mirror recalls the last used light setting upon reactivation.

6. CARE AND MAINTENANCE

To ensure the longevity and optimal performance of your EMKE LED Mirror, follow these maintenance guidelines:

- **Cleaning:** Use a soft, damp cloth with a mild glass cleaner to wipe the mirror surface. Avoid abrasive cleaners or materials that could scratch the glass or frame.
- **Do Not Submerge:** Never submerge the mirror in water or spray water directly onto electrical components.
- **Regular Inspection:** Periodically check the electrical connections and mounting hardware to ensure they remain secure.
- **Dusting:** Dust the mirror and frame regularly with a dry, soft cloth to prevent buildup.

7. TROUBLESHOOTING

If you encounter any issues with your EMKE LED Mirror, refer to the table below for common problems and their solutions.

Problem	Possible Cause	Solution
Light does not turn on	No power supply; Loose connection; Faulty switch	Check circuit breaker; Ensure all wires are securely connected; Contact customer support if switch is unresponsive.
Light flickers or dims unexpectedly	Unstable power supply; Loose wiring; LED driver issue	Ensure stable power; Check wiring connections; Contact customer support.
Touch control unresponsive	Dirty sensor; Electrical interference; Internal fault	Clean the touch area with a soft, dry cloth; Ensure no strong electrical devices are nearby; Contact customer support.

8. PRODUCT SPECIFICATIONS

Feature	Detail
Brand	EMKE
Model Number	UOLM03DTXXX1
Product Dimensions	19.69"L x 19.69"W (500mm x 500mm)
Shape	Round
Frame Material	Glass
Mounting Type	Wall Mount
Special Features	Adjust Brightness, Memory Function, Touch Switch
Color	Touch
Material	Aluminum
Item Weight	7.04 pounds (3.2 Kilograms)
Included Components	1 x Mirror

9. WARRANTY AND SUPPORT

EMKE is committed to providing high-quality products and professional local after-sales service. We hope our well-tested and packed bathroom mirror meets your expectations.

For any inquiries, technical support, or warranty claims, please refer to the contact information provided with your purchase or visit the official EMKE store:

[Visit the EMKE Store on Amazon](#)

