



[Manuals.plus](#) /

> [Model Expo](#) /

> Midwest 981 Indian Girl Canoe 1:12 Model Kit Instruction Manual

Model Expo MID981

Midwest 981 Indian Girl Canoe 1:12 Model Kit Instruction Manual

Brand: Model Expo | Model: MID981

INTRODUCTION

This manual provides detailed instructions for the assembly, maintenance, and care of your Midwest 981 Indian Girl Canoe 1:12 scale wooden model kit. Please read all instructions carefully before beginning assembly to ensure a smooth and successful building experience. This kit is designed for hobbyists with some prior experience in wood model building.

KIT CONTENTS AND IDENTIFICATION

Before starting, verify all components are present and familiarize yourself with the parts. Refer to the included plans and the following descriptions for identification.

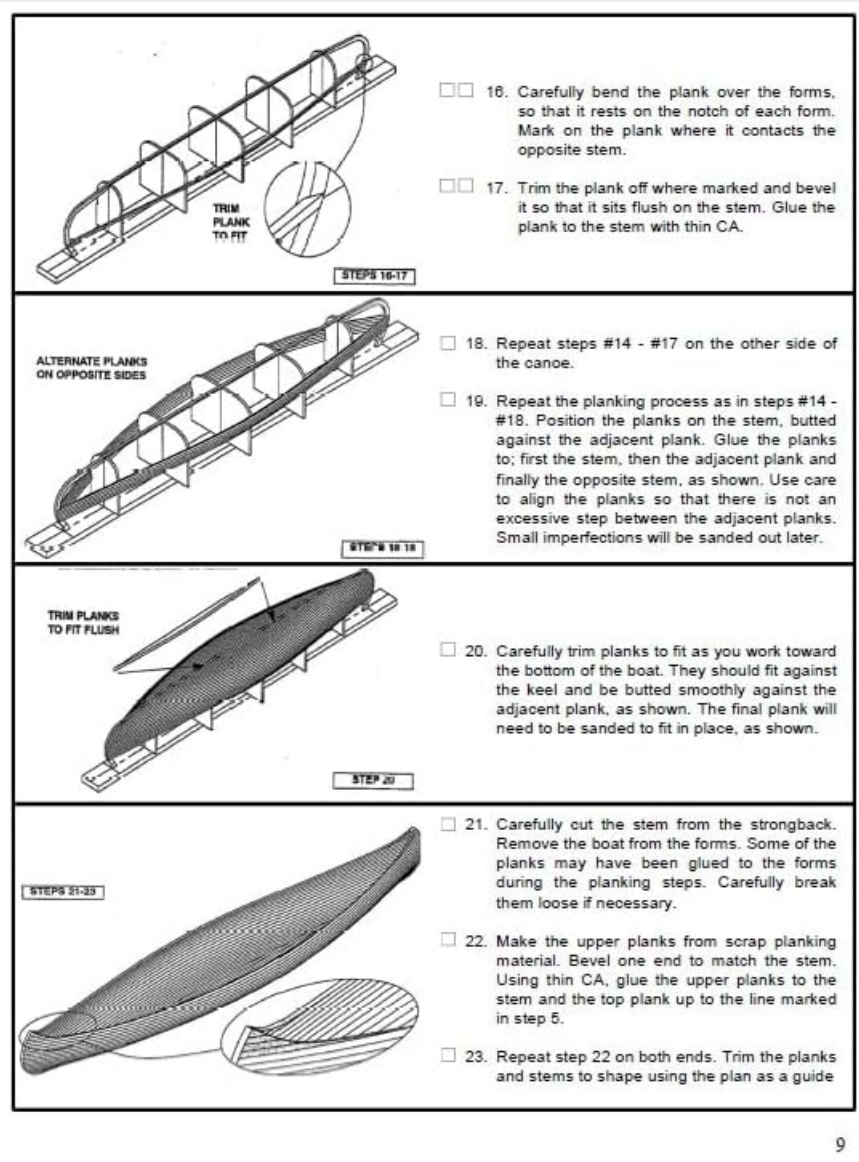

Image: The kit box opened, showing the instruction manual, rolled plans, various wood strips, and laser-cut wood sheets for parts.

Included Components:

- Laser-cut Basswood parts for easy construction.
- Strip planking materials for the hull.
- Detailed instruction manual with illustrations.
- Full-size rolled plans for reference.
- Canvas material for seats.
- Metal fittings (e.g., wire for seats).

Identifying Parts:

The laser-cut wood sheets are labeled with part numbers (e.g., MID981 #33725, MID981 #33726, MID981 #33727). Match these numbers to the corresponding parts shown in the instruction manual and on the rolled plans.



Image: Close-up view of laser-cut wood sheets, showing part numbers and outlines for various canoe components like seats and ribs.

The wood strips are provided in various sizes and types (basswood, cherry). Refer to the stripwood identification guide in your manual to correctly identify each piece.

ASSEMBLY INSTRUCTIONS

Follow the steps outlined in the instruction manual and refer to the full-size plans for accurate assembly. This section provides a general overview of the construction process.

Tools and Materials You Will Need (Not Included):

- Instant Setting (thin CA) Cyanoacrylate adhesive
- Slow Setting (thick CA) Cyanoacrylate adhesive
- Hobby knife and extra blades
- Small square
- Tack rag
- Wax paper
- Pencil
- 12" Steel Straight Edge
- Razor Saw
- Ammonia (for bending wood)
- Sandpaper (various grits: #120, #220, #400)
- Masking tape
- Midwest Apprentice Bass Paint Kit (optional, for finishing)

Construction Steps Overview:

1. **Building Jig:** Assemble the building jig using the laser-cut forms and the strongback. Ensure proper alignment as this forms the foundation of your canoe.
2. **Planking:** Begin applying the strip planks to the forms, starting from the bottom plank and working upwards. Use thin CA adhesive for initial tack and ensure planks are butted smoothly. Alternate planking on opposite sides to maintain hull symmetry.
3. **Trimming Planks:** Carefully trim planks to fit as you work towards the bottom of the boat. Sand the hull smooth

once all planks are in place.

4. **Ribs:** Install the internal ribs to provide structural integrity and shape.
5. **Decks:** Attach the deck pieces to the bow and stern.
6. **Seats:** Assemble and install the woven canvas seats.
7. **Paddles:** Construct the miniature paddles.
8. **Finishing:** Apply desired finishes such as paint or varnish (optional).

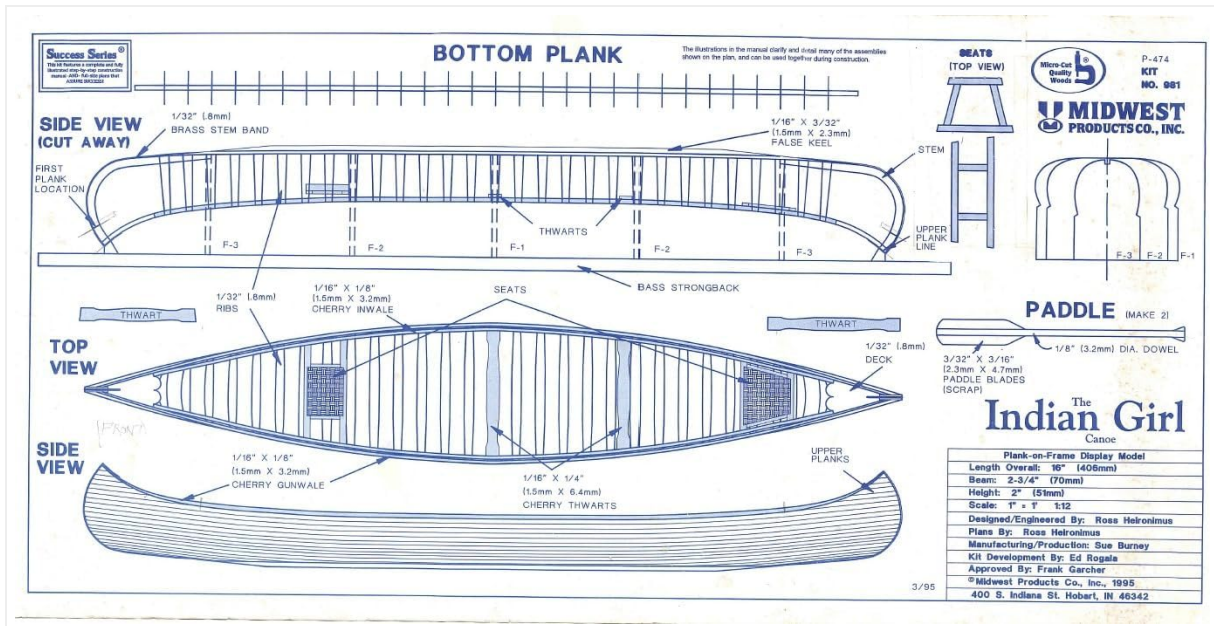

Image: Detailed blueprint for the Indian Girl Canoe model, illustrating various views, dimensions, and component placements for accurate assembly.



Image: A fully assembled Indian Girl Canoe model, showcasing its intricate details, placed on a map alongside miniature camping gear, suggesting its display purpose.

Visual Guide: Unboxing and Parts Identification



Video: This video demonstrates the unboxing of the Indian Girl Canoe model kit, showcasing the various components including the instruction manual, rolled plans, laser-cut wood sheets, and stripwood. It also highlights how to identify different parts by their labels.

MAINTENANCE AND CARE

To preserve the quality and appearance of your finished model, follow these maintenance guidelines:

- **Dusting:** Regularly dust the model with a soft, dry brush or cloth to prevent accumulation.
- **Display Environment:** Display the model in a stable environment, away from direct sunlight, extreme temperatures, and high humidity, which can cause wood to warp or finishes to fade.

- **Handling:** Handle the model carefully, avoiding excessive pressure on delicate parts.
- **Cleaning:** If necessary, gently wipe surfaces with a slightly damp cloth, then immediately dry. Avoid harsh chemicals or abrasive cleaners.

TROUBLESHOOTING

Here are solutions to common issues encountered during model assembly:

- **Warped Wood:** If wood strips appear warped, gently bend them against the grain or use a damp cloth and gentle heat (e.g., from a hairdryer on low setting) to reshape them. Ammonia can also be used for bending.
- **Parts Not Fitting:** Ensure you are using the correct parts as indicated by the part numbers and plans. Minor sanding or trimming may be required for a precise fit.
- **Adhesive Issues:** Ensure surfaces are clean and dry before applying adhesive. Allow sufficient curing time for glues. If parts do not bond, re-clean and reapply adhesive.
- **Missing or Damaged Parts:** In the event of missing or damaged parts, please refer to the Warranty and Support section for replacement information.

SPECIFICATIONS

Feature	Detail
Brand	Model Expo
Model Name	Midwest Indian Girl Canoe 1:12
Item Model Number	MID981
Scale	1:12
Dimensions (L x W x H)	15-7/8" x 2-5/8" x 1-1/2" (406mm x 70mm x 38mm)
Material	Basswood, Canvas
Construction Type	Strip plank construction
Skill Level	2 (Apprentice Series)
Manufactured In	USA

WARRANTY AND SUPPORT

Model Expo provides comprehensive support for your model kit:

- **Lifetime Guarantee:** In case any piece gets lost or damaged during construction, Model Expo will replace it for free.
- **Customer Service:** Should you experience a problem with this kit or require assistance, please contact Model Expo directly.
- **Contact Information:**
 - Model Expo
 - 1185 NW 159th Dr
 - Miami Gardens, FL 33169 USA
 - Email: info@modelexpo-online.com

