

## UNITOPSCI L2

# UNITOPSCI Double Din Car Stereo User Manual

Model: L2 | Brand: UNITOPSCI

### 1. INTRODUCTION

---

This manual provides detailed instructions for the installation, operation, and maintenance of your UNITOPSCI Double Din Apple CarPlay & Android Auto Car Stereo. Please read this manual thoroughly before using the product to ensure proper functionality and safety.

### 2. WHAT'S IN THE BOX

---

- 1 x Car Stereo
- 1 x Backup Camera
- 1 x Remote Control (Battery Not included)
- 1 x Steering Wheel Control (Battery Not included)
- 1 x Power Cable
- 1 x Speaker Cable
- 1 x User Manual
- 1 x Microphone

### 3. KEY FEATURES

---

- Compatible with Apple CarPlay & Android Auto via USB cable connection.
- 7-inch HD Capacitive Touch Screen for clear visuals and smooth operation.
- Built-in Bluetooth 5.1 for hands-free calling and music streaming.
- FM Radio with 18 preset stations.
- Mirror Link function for screen mirroring from smartphones (Android/iOS).
- Includes Backup Camera for safer parking.
- Supports Steering Wheel Control for convenient operation.
- EQ Sound settings (Classic, Pop, Rock, Flat, DSP).
- Multiple playback options: USB, AUX, TF Card input.
- 7 colorful backlight display options.

## 4. SETUP AND INSTALLATION

Proper installation is crucial for optimal performance. It is recommended to have this unit installed by a professional if you are unfamiliar with car audio wiring.

### 4.1 General Wiring Diagram

Refer to the following diagram for the general wiring connections of the car stereo. Ensure all connections are secure and correctly matched to your vehicle's wiring harness.

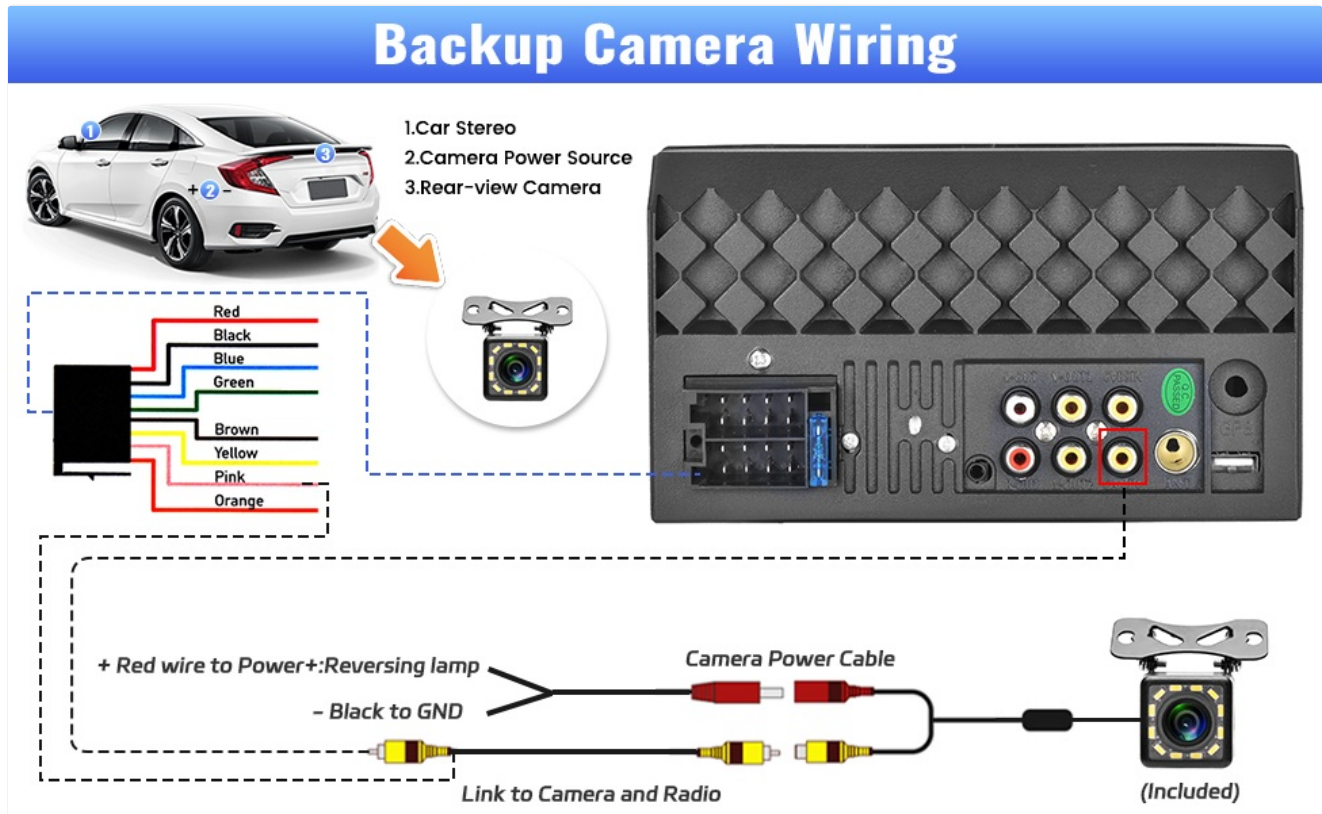

Figure 1: General Wiring Diagram

### 4.2 Backup Camera Wiring

The included backup camera requires specific wiring for proper functionality. Connect the red power cable of the camera to the positive back battery supply and the black cable to the negative battery supply. The yellow video input port of the camera connects to the CAM IN port on the rear of the car radio. Locate the wire labeled "BACK" on the car radio's harness and connect it to the positive power supply (typically the reverse light trigger wire). This ensures the display automatically switches to the reversing image when the car is in reverse gear.

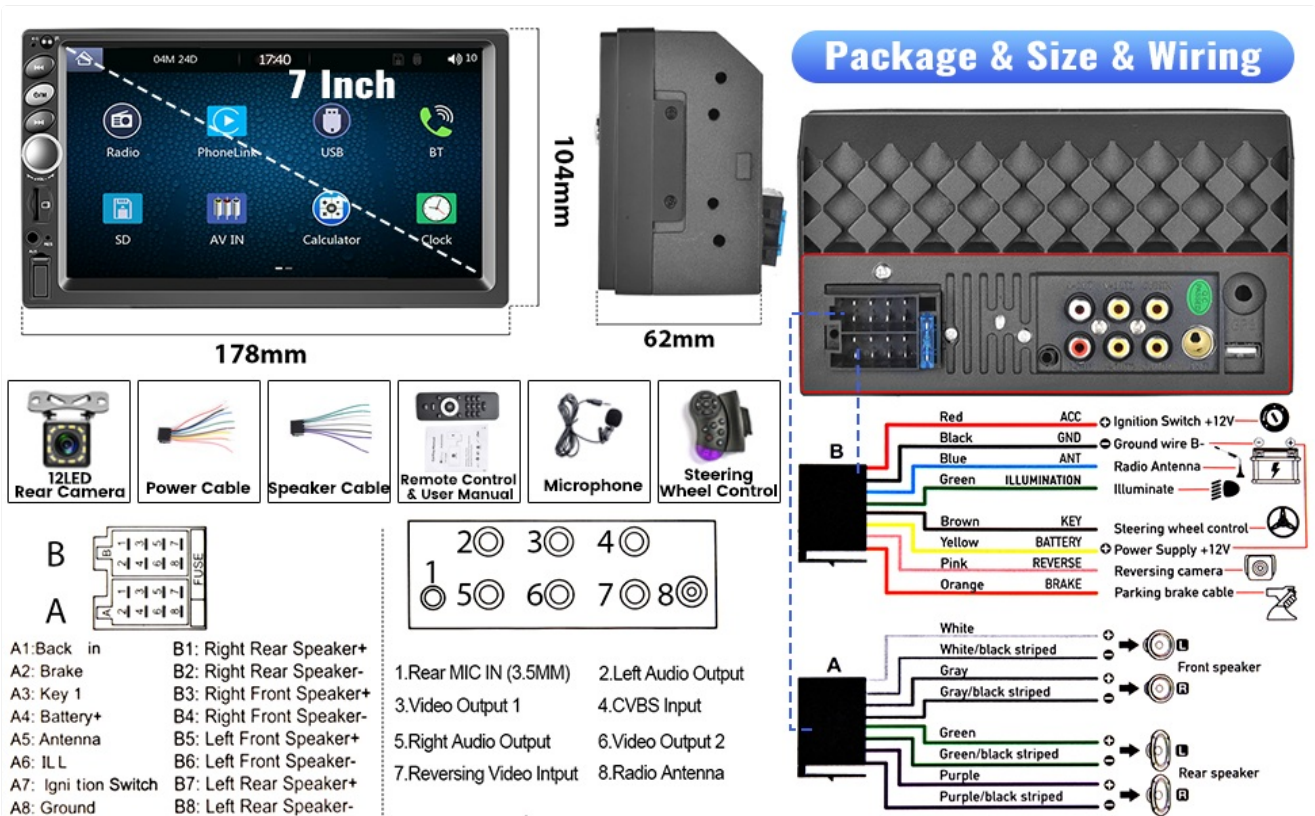

Figure 2: Backup Camera Wiring Diagram

## 5. OPERATING INSTRUCTIONS

### 5.1 Apple CarPlay & Android Auto

Connect your smartphone to the car stereo via a USB cable. The unit will automatically detect and launch Apple CarPlay or Android Auto, allowing you to access navigation, music, calls, and messages directly from the stereo's screen. Voice control functions are supported for hands-free operation.

# CarPlay & Android Auto Voice Control

Support USB cable connection to your mobile phone.

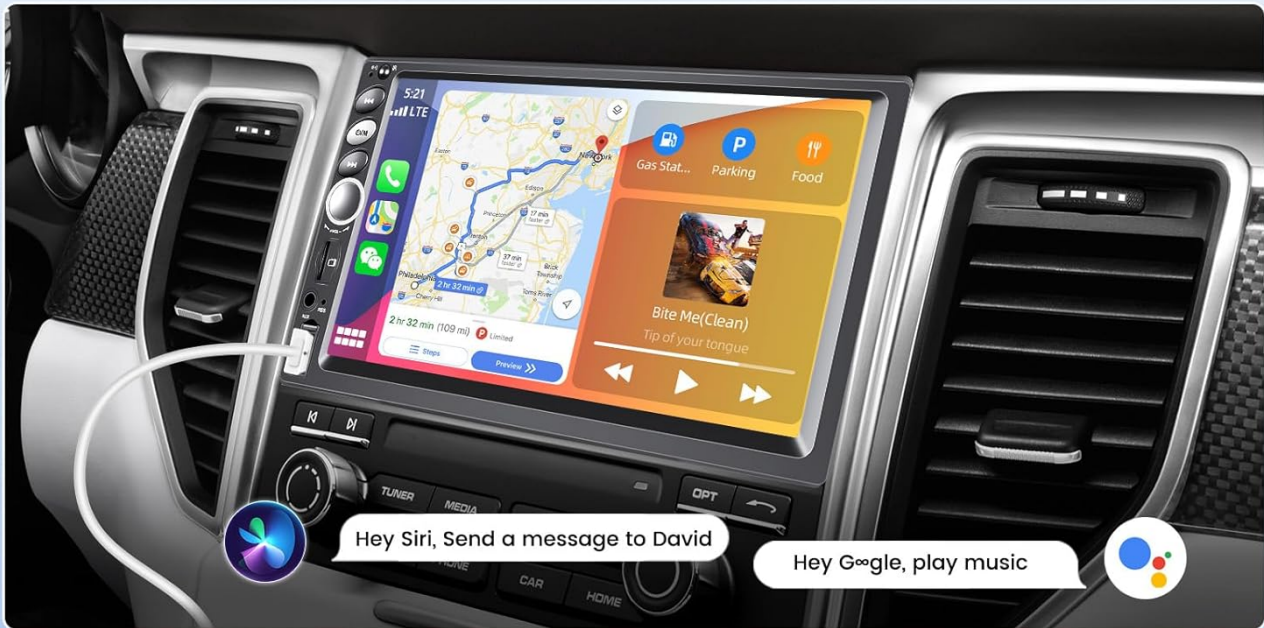

**Apple Carplay**

Wired Connection



**Android Auto**

Wired Connection



Figure 3: CarPlay & Android Auto Interface

## 5.2 Bluetooth 5.1

Enable Bluetooth on your smartphone and search for available devices. Select the car stereo from the list to pair. Once connected, you can make and receive hands-free calls and stream audio directly to the stereo. The built-in microphone ensures clear call quality.

# Mirror Link For Android/iOS

Use original USB cable to realize on-board full screen from your smartphones.



For **IOS:USB**



For **Android:USB**



Figure 4: Bluetooth Hands-free Calls

## 5.3 FM Radio

Access the FM radio function to listen to your favorite stations. The unit supports a radio range of FM 87.5-108.0MHZ and allows you to save up to 18 preset stations for quick access to news, sports, and music.



Answer / Hang up a call



## BT 5.1 Hands-free Calls

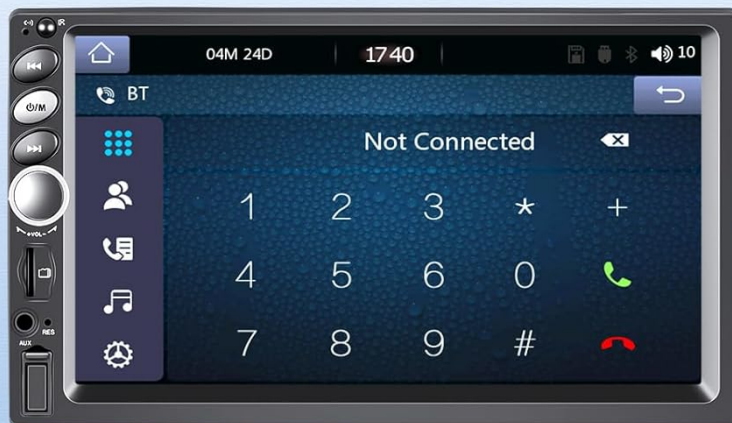

## Stable FM Radio



87.50MHz

108.00MHz



Figure 5: Stable FM Radio Operation

### 5.4 Mirror Link

Utilize the Mirror Link function by connecting your smartphone via USB. This feature allows you to mirror your phone's screen content, including videos and navigation maps, directly onto the car stereo's display.



## Steering Wheel Control



Figure 6: Mirror Link Functionality

### 5.5 EQ Sound Settings

Adjust the audio output to your preference using the built-in EQ sound settings. Choose from predefined modes like Classic, Pop, Rock, Flat, or customize your sound with DSP settings.

## Rear External Mic External mic included, get better sound quality



## Digital Sound Effect Adjust sound effect of Jazz, Pop, Rock and Classic etc.

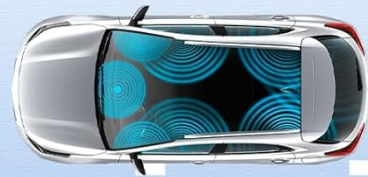

## Support USB/AUX/TF Card Input

Multiple audio/video playback supported, enjoyable.



Figure 7: Digital Sound Effect Adjustment

### 5.6 Steering Wheel Control

Connect the steering wheel control wires to enable convenient control of the stereo directly from your steering wheel. This allows you to easily switch songs, adjust volume, and manage phone calls without taking your hands off the wheel.

# Packing List & Size



12LED Rear Camera



Power Cable

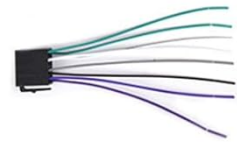

Speaker Cable



Remote Control



User Manual



Microphone



Steering Wheel Control

Figure 8: Steering Wheel Control Setup

## 5.7 USB/AUX/TF Card Playback

The unit supports multiple input sources for audio and video playback. Insert a USB drive, TF card, or connect an external device via the AUX input to enjoy your media files.

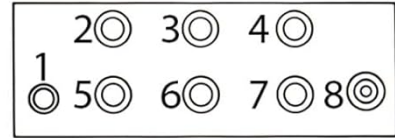

- 1. Rear MIC IN (3.5MM)
- 2. Left Audio Output
- 3. Video Output 1
- 4. CVBS Input
- 5. Right Audio Output
- 6. Video Output 2
- 7. Reversing Video Input
- 8. Radio Antenna

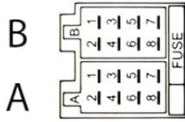

- A1: Back in
- A2: Brake
- A3: Key 1
- A4: Battery+
- A5: Antenna
- A6: ILL
- A7: Ignition Switch
- A8: Ground
- B1: Right Rear Speaker+
- B2: Right Rear Speaker-
- B3: Right Front Speaker+
- B4: Right Front Speaker-
- B5: Left Front Speaker+
- B6: Left Front Speaker-
- B7: Left Rear Speaker+
- B8: Left Rear Speaker-

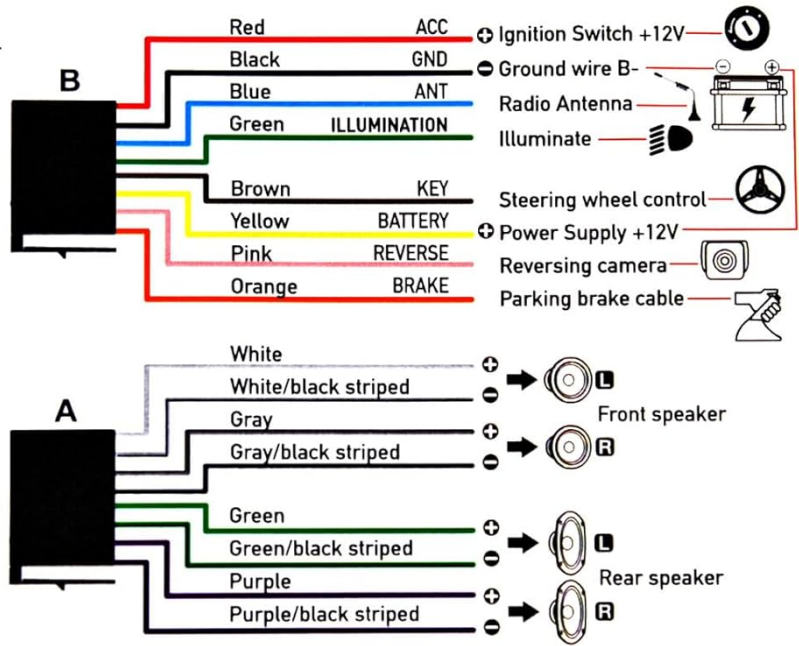

Figure 9: USB/AUX/TF Card Input

## 6. MAINTENANCE

To ensure the longevity and optimal performance of your car stereo, follow these maintenance guidelines:

- Keep the screen clean using a soft, lint-free cloth. Avoid abrasive cleaners.
- Ensure proper ventilation around the unit to prevent overheating.
- Avoid exposing the unit to extreme temperatures or direct sunlight for prolonged periods.
- Regularly check wiring connections for looseness or corrosion.

## 7. TROUBLESHOOTING

If you encounter issues with your car stereo, refer to the following common problems and solutions:

- **No Power:** Check all power connections, including the ACC (ignition switch) and B+ (battery) wires. Ensure the fuse is not blown.
- **No Sound:** Verify speaker connections are secure and correctly polarized. Check the volume level and EQ settings.
- **Bluetooth Connectivity Issues:** Ensure Bluetooth is enabled on both the stereo and your phone. Try unpairing and re-pairing the devices.

- **Backup Camera Not Displaying:** If the camera is powered on but the head unit does not switch to the reversing image, check the trigger wire for the backup camera connection. Ensure it is correctly connected to a positive power supply that activates when reverse gear is engaged.
- **Touch Screen Unresponsive:** Try resetting the unit (refer to the main unit for a small reset button, if available, or disconnect power briefly).

## 8. SPECIFICATIONS

Feature	Specification
Product Dimensions	2.48 x 7 x 4 inches
Item Weight	1.1 pounds
Item Model Number	L2
Connectivity Technology	Bluetooth, Auxiliary, USB
Controller Type	Android
Special Features	Touchscreen, Backup Camera Input, Android Auto, Built-In Bluetooth, Apple CarPlay
Compatible Devices	Smartphone
Connector Type	USB 2.0
Audio Output Mode	Mono
Surround Sound Channel Configuration	4.0
Video Encoding	H.264, H.265
Manufacturer	UNITOPSCI
Country of Origin	China

## 9. WARRANTY AND SUPPORT

UNITOPSCI is committed to providing high-quality products and satisfactory services. Your product comes with the following support:

- Replacement Available within 24 Months
- 60-days No Worry to Return
- Lifetime After-Sales Consult and Technical Support
- Quick Response within 16 Hours

For any inquiries or technical assistance, please contact us at: [UNITOPSCI@126.com](mailto:UNITOPSCI@126.com)