



[Manuals.plus](#) /

> [JUBEST](#) /

> JUBEST 36"x80" 5-Panel Frosted Glass Pocket Door Instruction Manual

## JUBEST JUBEST Pocket Door-5PD-W36P

# JUBEST 36"x80" 5-Panel Frosted Glass Pocket Door Instruction Manual

Model: JUBEST Pocket Door-5PD-W36P

## 1. INTRODUCTION

Thank you for choosing the JUBEST 36"x80" 5-Panel Tempered Frosted Glass Sliding Pocket Door. This product is designed to provide a space-saving and aesthetically pleasing solution for your interior spaces. The frosted glass panels offer privacy while allowing light to filter through, creating a modern and open feel. This manual provides detailed instructions for assembly, operation, and maintenance to ensure proper installation and long-term satisfaction with your new pocket door system.

## 2. SAFETY INFORMATION

- Always wear appropriate personal protective equipment (PPE) such as safety glasses and gloves during installation.
- The door panel weighs approximately 70-94 pounds. It is recommended to have at least two people for lifting and positioning the door to prevent injury.
- Ensure the wall structure is capable of supporting the weight of the door and the pocket door frame kit. Consult a professional if unsure.
- Keep children and pets away from the work area during installation.
- Follow all local building codes and regulations for door installation.
- Do not modify the product components, as this may compromise safety and performance.

## 3. PACKAGE CONTENTS

Verify that all components listed below are present and undamaged before beginning assembly. If any parts are missing or damaged, please contact JUBEST customer support.

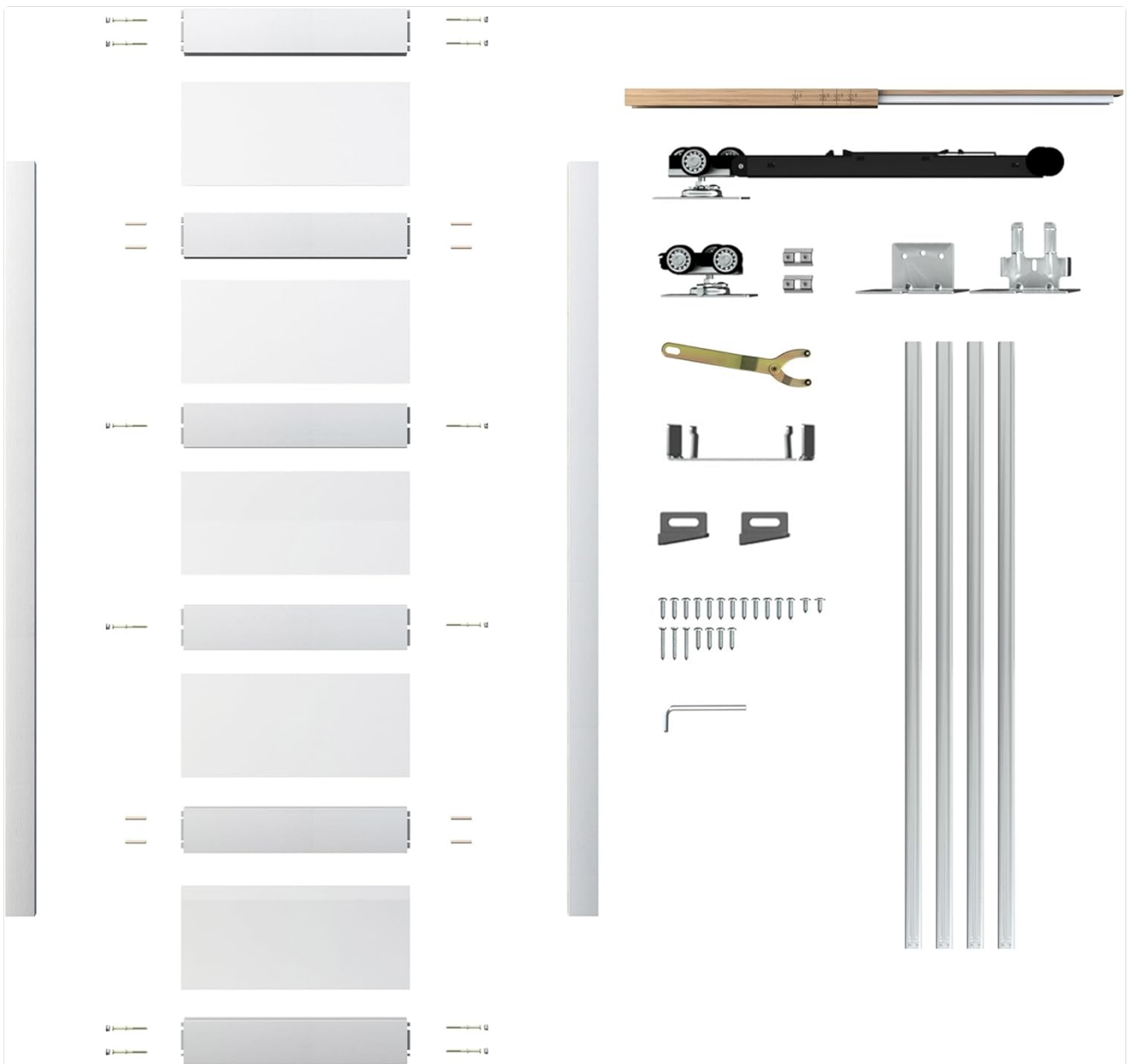

*Image: Detailed view of all components included in the JUBEST Pocket Door package.*

- 8x White Door Slabs
- 5x Tempered Frosted Glass Panels
- 4x Square Uprights
- 1x Aluminum Track with Wood Slot
- 1x Double-Sided Soft Close Mechanism
- 2x Hangers with Mounting Plates
- 2x Column Bases
- 2x Door Guides
- 2x Floor Adjustable Anchors
- Necessary Screws and Fasteners

## 4. SPECIFICATIONS

<b>Feature</b>	<b>Specification</b>
Brand	JUBEST
Model Number	JUBEST Pocket Door-5PD-W36P
Color	White
Material	Solid Wood, MDF, Tempered Frosted Glass, PVC Surface
Style	Modern
Door Width	36 inches
Door Height	80 inches
Door Thickness	1-3/8 inches
Recommended Rough Opening Width	73 inches
Recommended Rough Opening Height	84.5 inches
Item Weight	94 Pounds
Soft Close Mechanism	Two-way
Hanger Type	Three-wheel, heavy-duty ball-bearing
Track Material	Galvanized Steel



Image: Door and rough opening dimensions.



*Image: Construction details showing solid wood, waterproof PVC, and scratch resistance.*

## 5. SETUP AND ASSEMBLY

Assembly of the JUBEST Pocket Door requires careful attention to detail. The estimated assembly time is approximately 2 hours. It is highly recommended to have a helper, especially when handling the door panel due to its weight.

### Assembly Steps:

1. **Construct Rough Opening:** Prepare the wall opening according to the recommended dimensions (73" wide x 84.5" high). Ensure the opening is plumb and square.
2. **Install Pocket Door Frame Kit:** Assemble and install the galvanized steel pocket door frame kit within the rough opening. Secure it firmly to the wall studs.
3. **Apply Desired Wall Material:** Once the frame is installed, apply your chosen wall material (e.g., drywall) over the frame, ensuring it is flush with the door opening.

4. **Assemble the Door:** Assemble the 8 white door slabs and 5 tempered frosted glass panels to form the complete door.
5. **Attach Assembled Door:** Mount the hangers to the top of the assembled door and attach the door to the aluminum track within the pocket door frame.
6. **Install Trim and Floor Guide:** Install the necessary trim around the door opening and secure the floor adjustable anchor and door guides to ensure smooth and stable operation.

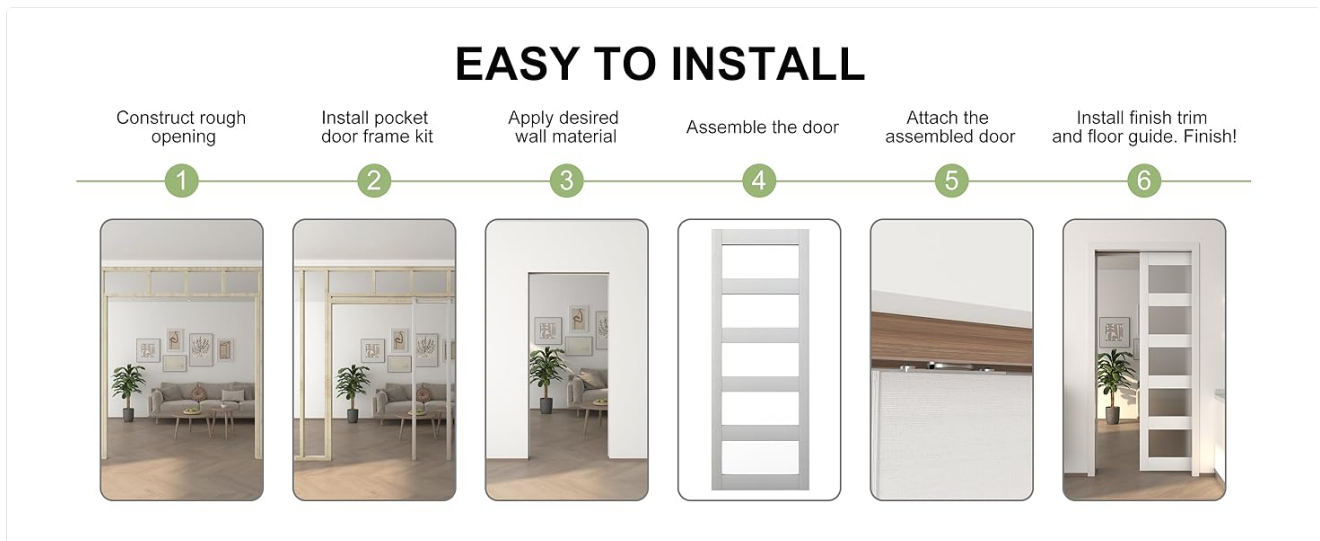

*Image: Visual guide for the pocket door installation process.*

### **Optional: Double Pocket Door Configuration**

If you wish to create a double pocket door system, you will need two JUBEST Pocket Door sets and an adapter (sold separately). This configuration allows two doors to slide into the wall from opposite sides, creating a wider opening.



*Image: Recommendation for creating a double pocket door setup.*

## 6. OPERATING INSTRUCTIONS

The JUBEST Pocket Door is designed for smooth and quiet operation. To open or close the door, gently push or pull the door handle. The integrated two-way soft close mechanism will engage to dampen the door's movement, preventing slamming and ensuring a quiet experience.

## **Two-way Soft-close Mechanism**

Prevent door from hitting the door jamb

## **Three Wheel Ball Bearing Hanger**

Ensure quiet and smooth sliding door



*Image: Soft-close mechanism and three-wheel ball-bearing hangers for smooth sliding.*

The frosted glass panels provide privacy while allowing natural light to pass through, making it suitable for various rooms such as living rooms, bathrooms, cloakrooms, and bedrooms.



*Image: Examples of the pocket door in various room applications.*

Your browser does not support the video tag.

*Video: Demonstration of the JUBEST Pocket Door in use, highlighting its smooth sliding and space-saving benefits for closets, bathrooms, and tight spaces.*

## 7. MAINTENANCE

The JUBEST Pocket Door is designed for durability and ease of maintenance. The PVC-coated surface is waterproof and easy to clean.

- **Cleaning:** Wipe the door panels and glass surfaces with a soft, damp cloth and a mild, non-abrasive cleaner. Avoid harsh chemicals or abrasive materials that could damage the finish or glass.
- **Track Maintenance:** Periodically inspect the track for any debris or obstructions. Clean the track as needed to ensure smooth sliding.
- **Hardware Check:** Occasionally check all screws and fasteners to ensure they are tight. Tighten any loose

hardware as necessary.

## 8. TROUBLESHOOTING

If you encounter any issues with your JUBEST Pocket Door, please refer to the following common troubleshooting tips:

- **Door not sliding smoothly:** Check the track for any obstructions or debris. Ensure the hangers are properly seated and the wheels are clean. Verify that the floor guide is correctly aligned.
- **Door not closing completely:** Inspect the soft close mechanism for proper function. Ensure there are no obstructions preventing the door from fully engaging the mechanism.
- **Excessive noise during operation:** Lubricate the track and hanger wheels with a silicone-based lubricant. Check for any loose components that might be causing rattling.

For issues not resolved by these tips, please contact customer support.

## 9. WARRANTY INFORMATION

JUBEST products are manufactured to high-quality standards. For specific warranty details regarding your pocket door, please refer to the warranty card included with your purchase or visit the official JUBEST website. Keep your proof of purchase for any warranty claims.

## 10. CUSTOMER SUPPORT

If you have any questions, require assistance with installation, or need to report a missing/damaged part, please contact JUBEST customer support through the retailer where you purchased the product or visit the official JUBEST website for contact information.

**JUBEST Official Store:** [Visit JUBEST Store on Amazon](#)