

Manuals+

[Q & A](#) | [Deep Search](#) | [Upload](#)

manuals.plus /

> [VLOXO](#) /

> [VLOXO Cordless Electric Scissors \(Model Y4100\) User Manual](#)

VLOXO Y4100

VLOXO Cordless Electric Scissors (Model Y4100) User Manual

Model: Y4100

INTRODUCTION

Thank you for choosing the VLOXO Cordless Electric Scissors. This versatile tool is designed to simplify cutting various materials with ease and efficiency. Featuring a 4V motor, a 240RPM cutting speed, and a 1/4-inch cutting capacity, it is ideal for tasks involving cardboard, leather, fabric, plastic mats, carpets, and felt. This manual provides essential information for safe and effective operation, maintenance, and troubleshooting.

PRODUCT OVERVIEW

Familiarize yourself with the components of your VLOXO Cordless Electric Scissors:

- **Electric Scissor Unit:** The main body of the tool.
- **Rotary Blade:** The cutting component, featuring an automatic sharpening system.
- **Blade Protection Cover:** A safety guard over the blade.
- **Safety Lock Button:** Prevents accidental activation.
- **Power Switch:** Activates the blade when the safety lock is disengaged.
- **LED Light:** Illuminates the cutting area.
- **TYPE-C Charging Port:** For recharging the internal battery.
- **Charging Indicator Light:** Displays charging status.
- **Ergonomic Handle:** Designed for comfortable grip.



Figure 1: VLOXO Cordless Electric Scissors and included accessories.



Figure 2: Detail of the safety lock button and indicator light.



Figure 3: The self-sharpening rotary blade with 1/4-inch cutting capacity.

SETUP

Initial Charging

Before first use, fully charge the electric scissors. Connect the provided TYPE-C charging cable to the charging port located at the rear of the tool and plug the other end into a suitable USB power adapter (not included). The charging indicator light will illuminate red during charging and turn green when fully charged. A full charge is recommended for optimal performance.

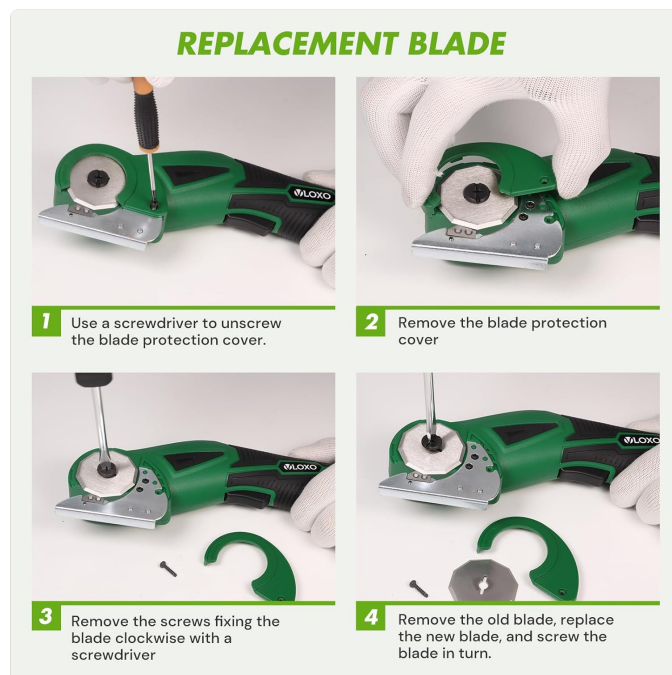

Figure 4: Charging the VLOXO electric scissors via TYPE-C port.

OPERATING INSTRUCTIONS

Turning On/Off

1. To activate the tool, press and hold the **Safety Lock Button** (located on top of the unit). The indicator light will turn on.
2. While holding the safety lock, press the **Power Switch Button** (located on the underside of the handle) to start the blade rotation.
3. Release the Power Switch Button to stop the blade. The indicator light will turn off automatically after approximately 30 seconds of inactivity.
4. To resume operation after inactivity, repeat steps 1 and 2.

Cutting Materials

The VLOXO Cordless Electric Scissors are designed for cutting a variety of materials up to 1/4 inch (6.35 mm) thick. These include:

- Cardboard
- Leather
- Plastic Mats
- Carpets
- Felt
- Fabric (e.g., denim, canvas)
- Rope

Ensure the material is positioned flat and stable before cutting. Guide the tool steadily along the desired cutting line. For optimal results, avoid forcing the tool through excessively thick or hard materials beyond its specified capacity.



Figure 5: Basic steps for operating the electric scissors.



Figure 6: Examples of materials that can be cut with the tool.

Your browser does not support the video tag.

Video 1: Demonstration of the VLOXO Electric Rotary Cutter in action, cutting various materials.

BLADE REPLACEMENT

To maintain optimal cutting performance, replace the blade when it becomes dull or damaged. Always ensure the tool is turned off and disconnected from any power source before attempting blade replacement.

Procedure:

1. Using a screwdriver, unscrew the blade protection cover.
2. Carefully remove the blade protection cover.
3. Remove the screws fixing the old blade by turning them clockwise with a screwdriver.
4. Remove the old blade, replace it with a new blade, and screw the components back in place.
5. Reattach the blade protection cover and secure it with the screw.

Safety Tip: When replacing the blade, always wear cut-proof gloves to prevent injury. After replacement, ensure the safety lock is closed before operating the tool.



Figure 7: Step-by-step guide for blade replacement.

MAINTENANCE

Blade Care

The rotary blade is equipped with an automatic sharpening system to maintain its edge. To ensure continuous precise and smooth cuts, regularly clean the area around the blade guard. Remove any dust, debris, or material chips using compressed air or a soft brush. Avoid using water or liquid cleaners directly on the blade or motor components.

Storage

After each use, wipe the blade surface with a dry cloth and store the electric scissors in the provided storage case. Store the tool in a dry, cool place, away from direct sunlight and out of reach of children.

TROUBLESHOOTING

Problem	Possible Cause	Solution
Tool does not turn on.	Battery is low or depleted. Safety lock not engaged correctly.	Charge the tool fully. Ensure the safety lock button is pressed before activating the power switch.
Poor cutting performance or blade jams.	Blade is dull. Debris around the blade. Material is too thick.	Replace the blade (refer to Blade Replacement section). Clean the blade area. Ensure material thickness is within 1/4 inch capacity.

Problem	Possible Cause	Solution
Charging indicator light does not turn green.	Charging cable or adapter issue.	Check the charging cable and adapter for damage. Try a different compatible TYPE-C cable and USB adapter.

SPECIFICATIONS

Feature	Detail
Brand	VLOXO
Model Number	Y4100
Power	4V
Cutting Speed	240 RPM
Cutting Capacity	Up to 1/4 inch (6.35 mm)
Blade Material	Stainless Steel
Blade Type	Rotary, Octagonal, Self-Sharpening
Battery Type	1 Lithium Metal (included)
Charging Port	TYPE-C
Item Weight	1.34 pounds (0.61 kg)
Package Dimensions	10 x 4.53 x 2.36 inches (25.4 x 11.5 x 6 cm)
Color	Green

WARRANTY AND SUPPORT

For warranty information, technical support, or any inquiries regarding your VLOXO Cordless Electric Scissors, please contact VLOXO customer service through the retailer's platform or visit the official VLOXO website. Please retain your proof of purchase for warranty claims.

IMPORTANT SAFETY INFORMATION

- Always keep hands and fingers away from the rotating blade during operation.
- Use the safety lock feature to prevent accidental startup, especially when not in use or during maintenance.
- Wear appropriate personal protective equipment, such as cut-resistant gloves and eye protection,

when operating or performing maintenance on the tool.

- Do not attempt to cut materials exceeding the specified 1/4-inch capacity.
- Keep the tool dry and away from moisture. Do not operate in wet conditions.
- Store the tool out of reach of children.
- Use only the provided charging cable or a compatible TYPE-C cable for charging.
- Do not disassemble the tool beyond blade replacement as described in this manual.