

PHILIPS AWP2980WH

PHILIPS GoZero Next-Gen Instant Water Filter Pitcher

Model: AWP2980WH

INTRODUCTION

Thank you for choosing the PHILIPS GoZero Next-Gen Instant Water Filter Pitcher. This innovative water station is designed to provide instant, pure, and great-tasting water with advanced filtration technology. This manual provides essential information for the safe and efficient use of your new water filter pitcher. The Philips Instant Water Station AWP2980 features cutting-edge instant filtration technology, delivering water significantly faster than traditional water filter pitchers. Its compact design allows for versatile placement, including inside your fridge door. The built-in rechargeable battery offers convenience and portability, lasting up to 30 days on a single charge.

PRODUCT COMPONENTS

The PHILIPS GoZero Next-Gen Instant Water Filter Pitcher kit includes:

- 1 x Water Filter Pitcher (AWP2980WH)
- 3 x Micro X-Clean Instant Filters
- 1 x Type-C USB Charging Cable



DESIGN
AWARD
2021



3-MODES

- Fresh water flow out
- Filter replacement
- Battery Recharge



Image: Contents of the package, including the pitcher and filters. Ensure all components are present upon unboxing.

SETUP

- Initial Charge:** Before first use, fully charge the pitcher's built-in rechargeable battery using the provided Type-C USB cable. The charging port is typically located on the back or side of the unit. A full charge can last up to 30 days.
- Filter Preparation:** Remove a new Micro X-Clean Instant Filter from its packaging. It is recommended to rinse the filter under cold tap water for a few seconds to remove any loose carbon dust.
- Install Filter:** Locate the filter housing within the pitcher. Insert the prepared filter firmly into the designated slot until it clicks into place. Ensure a secure fit to prevent unfiltered water bypass.
- First Fill:** Fill the pitcher with tap water. For the first use, dispense and discard the first full pitcher of filtered water to prime the filter and flush out any remaining carbon dust.
- Placement:** The compact design allows for placement on countertops or inside most refrigerator doors.



Set it up anywhere, with built-in battery

On the desk, or in the fridge door rack

Image: The pitcher's compact design allows it to fit conveniently in a refrigerator door.



Image: Key features of the pitcher, including double-click dispensing and battery operation.

OPERATING INSTRUCTIONS

1. **Filling the Pitcher:** Open the flip-top lid and fill the pitcher with tap water. The pitcher has a capacity of up to 12 cups (approximately 2.8 liters).
2. **Dispensing Water:** To dispense filtered water, double-click the button on the top of the dispenser. This thoughtful design prevents accidental spills. The instant filtration technology processes water as it is dispensed, providing fresh, pure water without waiting.
3. **Stopping Dispense:** Double-click the button again to stop the water flow.
4. **Filter Lifetime Indicator:** The pitcher features a usage-based filter lifetime indicator. This indicator tracks the actual filtration volume and usage period, notifying you precisely when it's time to replace the filter for optimal performance.



Image: Dispensing water from the pitcher into a glass.

Next-Gen Micro X-Clean Instant Filter

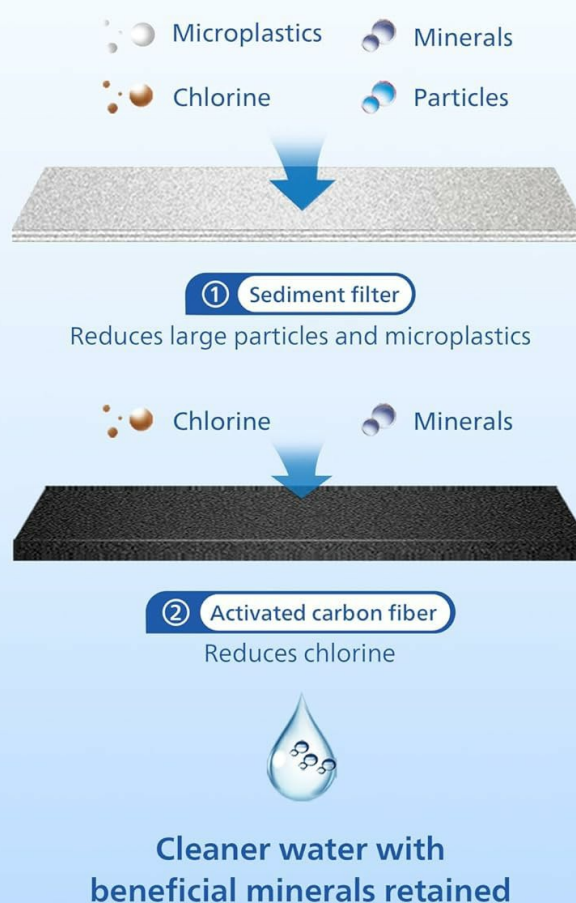

*Activated carbon water filters generally DO NOT reduce TDS

Image: Explanation of the Micro X-Clean Instant Filter technology, detailing how it reduces microplastics, chlorine, and other impurities.

MAINTENANCE

- **Filter Replacement:** Replace the filter when indicated by the filter lifetime monitor. Typically, one filter lasts for approximately 60 gallons or up to 3 months, depending on usage and water quality. To replace, remove the old filter and insert a new one as described in the Setup section.
- **Cleaning the Pitcher:** The pitcher is BPA-free and features an IPX4 splash-proof design. To clean, disassemble the pitcher components (reservoir, lid, dispenser unit). Wash all parts, except the electronic dispenser unit, with mild soap and warm water. Rinse thoroughly. The electronic dispenser unit should be wiped clean with a damp cloth; do not submerge it in water.
- **Charging:** Recharge the battery when the indicator light signals low battery. Connect the Type-C USB cable to the charging port and a suitable power source.

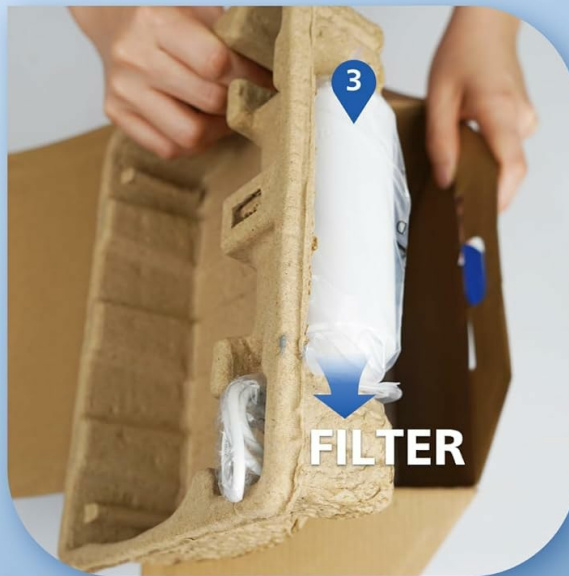

**FIND YOUR FILTER
IN THE PACKAGE**

Image: Overview of pitcher dimensions and key features for ease of use and maintenance.

TROUBLESHOOTING

Problem	Possible Cause	Solution
Slow water dispensing	Filter is clogged or nearing end of life.	Check the filter lifetime indicator. Replace the filter if necessary. Ensure the filter is properly seated.
No water dispensed	Battery is depleted; dispenser unit not properly connected; filter not installed correctly.	Charge the battery. Ensure the dispenser unit is securely attached. Re-install the filter.
Water tastes unusual	New filter not primed; filter needs replacement.	Discard the first pitcher of water after new filter installation. Replace the filter if it's old.

Problem	Possible Cause	Solution
Battery not charging	Charging cable or adapter issue; charging port obstruction.	Ensure the Type-C USB cable is securely connected to both the pitcher and a working power source. Try a different cable or adapter. Check the charging port for debris.

SPECIFICATIONS

Feature	Detail
Model Number	AWP2980WH/37
Product Dimensions	9.17"L x 5.98"W x 10.35"H
Item Weight	2 Pounds
Power Source	Battery Powered (1 Lithium Ion battery included)
Battery Life	Up to 30 days per charge
Filter Technology	Micro X-Clean Instant (Activated Carbon Fiber, Sediment Filter)
Filter Lifespan	Up to 60 gallons
Water Capacity	12 Cups (approx. 2.8 Liters)
Safety Features	BPA-free, IPX4 splash waterproof
Installation Type	Countertop
Maximum Flow Rate	1 Liters Per Minute

WARRANTY AND SUPPORT

This product is manufactured by Philips. For specific warranty details and to register your product, please refer to the warranty card included in your product packaging or visit the official Philips Water website.

Keep your proof of purchase for warranty claims.

For technical support, troubleshooting assistance beyond this manual, or to inquire about replacement parts, please contact Philips customer service. Contact information can typically be found on the Philips Water website or on your product packaging.

Optional protection plans may be available for extended coverage. Please check with your retailer for details on available plans.