

## TecTake 404961

# TecTake Garden Patio Retractable Awning

## USER MANUAL

### 1. Product Overview

The TecTake Retractable Awning provides effective protection from sun and rain, enhancing the usability of your patio, garden, or outdoor space. Designed for ease of use and durability, this awning features a smooth-running hand crank and is constructed from robust materials to withstand various weather conditions.

Key features include:

- **Easy Setup:** Hassle-free installation using a clamp system, requiring no drilling into exterior walls.
- **Customizable Design:** Height-adjustable arms allow for ideal tilt angle adjustment, providing flexible shade or breeze.
- **All-Weather Protection:** UV and water-resistant coated fabric shields against sun and rain.
- **Effortless Operation:** Lightweight aluminium shaft and smooth-running crank for easy opening and closing.
- **Versatile Use:** Can be fitted diagonally or vertically, also serving as a privacy screen.

### 2. Safety Instructions

**It is crucial to adhere to all safety guidelines to ensure safe operation and prevent damage or injury.**

- Ensure the awning is correctly anchored to prevent shifting, especially in windy conditions.
- Do not exceed the maximum load capacity of the awning to avoid structural damage.
- Always retract the awning during strong winds, heavy rain, or snowfall to prevent damage.
- Keep children and pets away from the awning during operation.
- Regularly inspect all components for wear, damage, or loose connections.

### 3. Assembly and Installation

This awning features a practical clamp system for quick and effortless installation, eliminating the need for drilling or doweling. It can be installed in various locations, such as patios or balconies.

#### 3.1. Scope of Delivery

- 1x Retractable Awning
- 1x Assembly Materials (fasteners, crank handle)
- 1x Assembly Instructions (refer to this manual)

### 3.2. Installation Steps

Follow the detailed instructions provided in the included assembly guide. Ensure all components are present before beginning assembly. It is recommended to have two people for installation.



Figure 3.1: Overview of key features and installation benefits.

## EASY TO Install.

The practical clamping system ensures quick and effortless installation - without any drilling or doweling. Install anywhere!



Figure 3.2: Visual guide to the clamp system and vertical privacy screen option.

The practical clamping mechanism allows for secure attachment without permanent fixtures. The multi-step telescopic rods enable height adjustment between 211 cm and 304 cm, ensuring adaptability to your specific space.

## 4. Operation

Operating your TecTake Retractable Awning is straightforward, designed for convenience and ease.

### 4.1. Extending and Retracting the Awning

Use the provided hand crank to extend or retract the awning. The crank handle can be mounted on either side for convenience. Turn the crank clockwise to extend the awning and counter-clockwise to retract it.

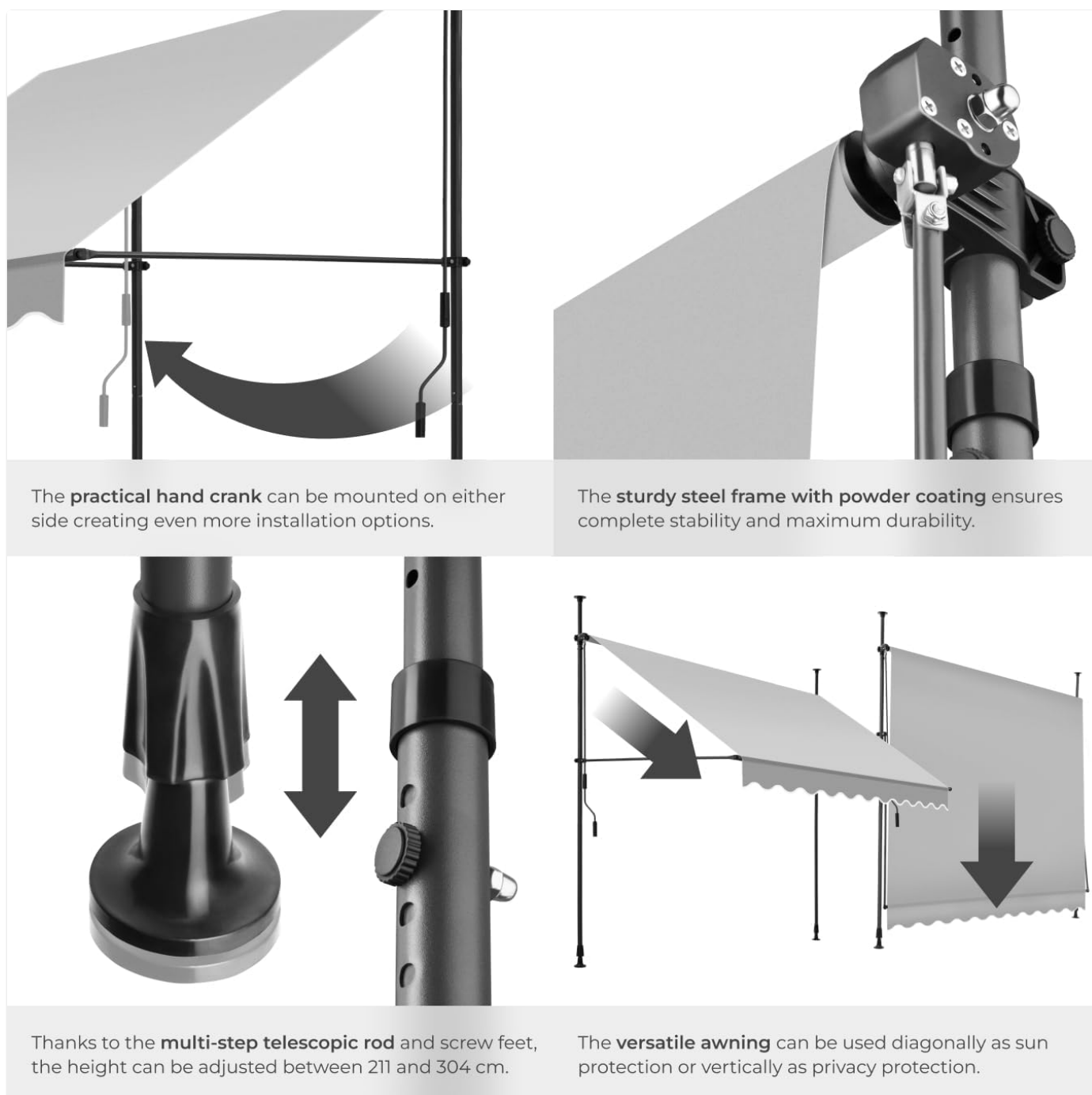

Figure 4.1: Details of the hand crank and height adjustment mechanism.

## 4.2. Adjusting Tilt Angle and Height

The awning features height-adjustable arms, allowing you to set the ideal tilt angle for optimal shade or to allow for a gentle breeze. Adjust the telescopic rods on the uprights to modify the overall height and tension of the awning fabric.

The versatile design allows the awning to be used diagonally for sun protection or vertically as a privacy screen, adapting to your needs.

## 5. Care and Maintenance

Proper care and maintenance will extend the lifespan of your TecTake Retractable Awning.

- **Cleaning the Fabric:** Clean the polyester fabric with mild soap and water. Use a soft brush or cloth to gently remove dirt. Rinse thoroughly with clean water and allow to air dry completely before retracting. Do not use harsh chemicals or abrasive cleaners.
- **Frame Maintenance:** Periodically wipe down the powder-coated steel and aluminium frame with a damp cloth to remove dust and grime. Check for any signs of rust or corrosion, especially on steel components, and address them

promptly.

- **Inspecting Moving Parts:** Regularly inspect the hand crank mechanism and telescopic rods for smooth operation. Lubricate moving parts if necessary with a silicone-based spray to prevent sticking or squeaking.
- **Seasonal Storage:** If storing the awning for an extended period, especially during winter months, ensure it is clean and dry. Store in a protected area to prevent damage from extreme weather.

## 6. Troubleshooting

---

This section addresses common issues you might encounter with your awning.

- **Awning not extending/retracting smoothly:** Check for any obstructions in the mechanism or along the fabric path. Ensure the hand crank is properly engaged. Lubricate moving parts if they feel stiff.
- **Awning fabric sagging:** Verify that the telescopic rods are extended to the correct height and are securely locked in place, providing adequate tension to the fabric.
- **Awning unstable:** Re-check all clamping points and ensure they are tightly secured. Confirm that the non-slip plastic feet are firmly positioned on a stable surface. Ensure the awning is anchored correctly as per safety instructions.
- **Water pooling on fabric:** Adjust the tilt angle to ensure proper water runoff. The fabric is water-resistant, but prolonged pooling can cause stress.

If you experience issues not covered here, please refer to the contact information for support.

## 7. Technical Specifications

---

Detailed specifications for the TecTake Retractable Awning (Model 404961).

MEASUREMENTS

**Dimensions open**  
250 x 120 x 211 - 304 cm

**Dimensions folded**  
250 x 12 x 211 - 304 cm

**Awning**  
237 x 180 cm

**Extension arms**  
120 cm

**Plastic feet**  
7 cm diameter

TECHNICAL DATA

**UV-protection** 50+  
**Fabric weight** 180 g/m<sup>2</sup>  
**Weight** 8.5 kg  
**Material** powder-coated steel,  
aluminium, polyester,  
polyethylene, polyurethane

CONTENTS

1 Clamp awning  
Assembly materials  
Installation instructions

Measurements may vary

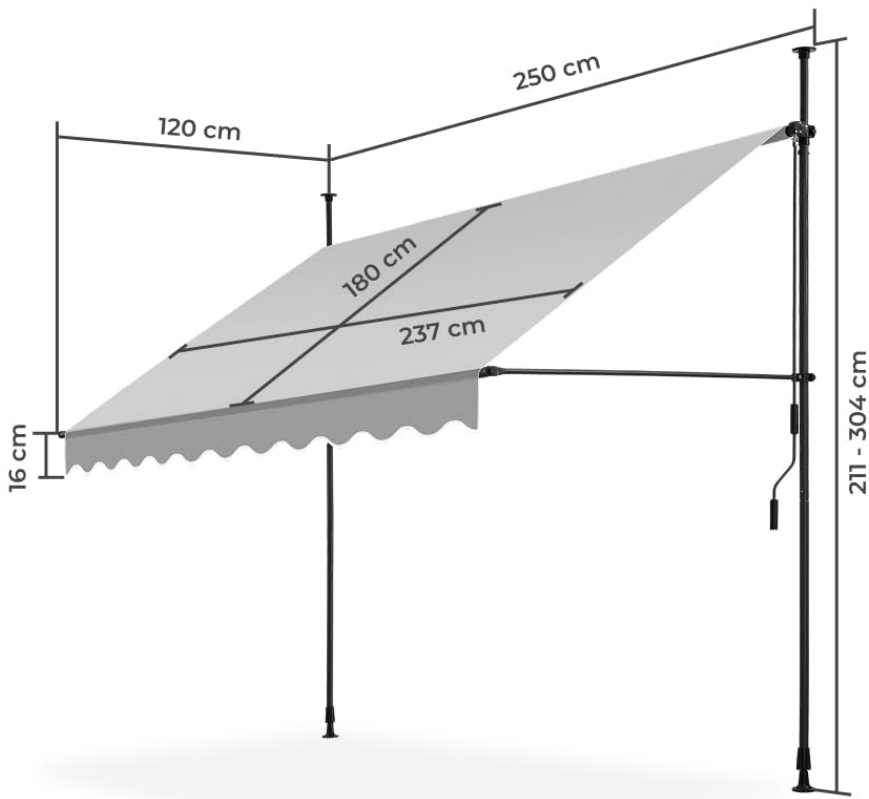

Figure 7.1: Product information, measurements, and technical data.

Attribute	Value
Model Number	404961
Total Dimensions (WxDxH)	approx. 250 x 120 x 211 - 304 cm
Folded Dimensions (WxDxH)	approx. 250 x 12 x 211 - 304 cm
Covering (WxD)	approx. 237 x 180 cm
Drop Arm Length	approx. 120 cm
Fabric Thickness	180 g/m <sup>2</sup>
UV Protection	50+

Attribute	Value
Diameter of Plastic Caps	approx. 7 cm
Crank Handle (WxØ)	approx. 9 x 2.2 cm
Weight	8.7 kg (Product) / 9.5 kg (Shipping)
Material	Powder-coated steel, aluminium, 100% polyester, polyethylene, polyurethane
Power Source Type	Hand Powered

8. Warranty and Support



For warranty information, product support, or to inquire about replacement parts, please contact TecTake customer service. Keep your purchase receipt as proof of purchase.

You can find contact details on the official TecTake website or through your point of purchase.

© 2025 TecTake. All rights reserved.

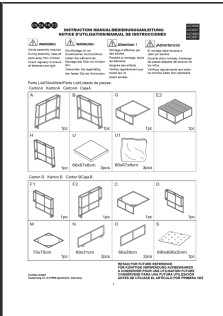
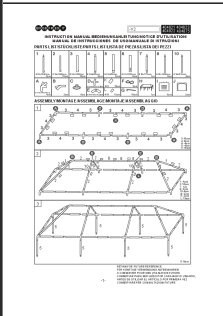
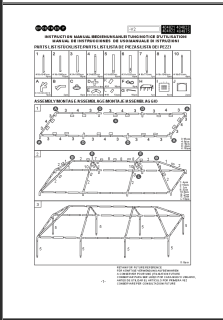
Related Documents - 404961

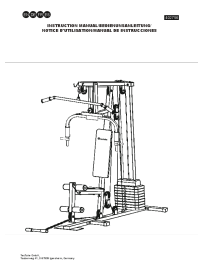
	<p><a href="#">TecTake Rattan Garden Furniture Assembly Instructions</a></p> <p>Comprehensive assembly instructions for TecTake rattan garden furniture sets, including a detailed parts list and step-by-step visual guidance. Model numbers: 403696, 403697, 403880, 403881.</p>
	<p><a href="#">tectake Gazebo Instruction Manual - Assembly Guide</a></p> <p>Comprehensive instruction manual for assembling and maintaining your tectake gazebo. Includes parts list, step-by-step assembly, location advice, care instructions, and contact information.</p>
	<p><a href="#">tectake Gazebo Instruction Manual - Assembly and Care Guide</a></p> <p>Comprehensive instruction manual for the tectake gazebo (models 404821, 404823, 404822, 404875), covering parts list, assembly steps, location selection, cleaning, maintenance, and storage. Includes safety warnings for outdoor use.</p>

 <p>Diagram showing the assembly of the TecTake 402756 home gym, including the main frame and exercise components.</p>	<p><a href="#">TecTake 402756 Home Gym Assembly and Exercise Guide</a></p> <p>Instruction manual for the TecTake 402756 home gym, covering assembly, safety precautions, and exercise guidance. Includes preparation tips and warm-up/cool-down routines.</p>
 <p>Diagram showing the TecTake 400777 semi-automatic washing machine, including the main unit and control panel.</p>	<p><a href="#">TecTake 400777 Semi-Automatic Washing Machine User Manual and Instructions</a></p> <p>This user manual provides comprehensive instructions for the TecTake 400777 semi-automatic washing machine, covering installation, operation, safety guidelines, and maintenance. Learn how to effectively wash and spin your clothes with this efficient appliance.</p>
 <p>Diagram showing the 2-in-1 Grass Shear / Hedge Trimmers WIRELESS BATTERY LI-ION 7.2V (Model 401542), including the main unit and accessories.</p>	<p><a href="#">2-in-1 Grass Shear / Hedge Trimmers WIRELESS BATTERY LI-ION 7.2V - User Manual</a></p> <p>Comprehensive user manual for the 2-in-1 Grass Shear / Hedge Trimmers WIRELESS BATTERY LI-ION 7.2V (Model 401542). Includes technical specifications, intended use, safety warnings, operating instructions, maintenance, and troubleshooting.</p>