

Itari M832

Itari M832 Portable Thermal Printer User Manual

Model: M832

INTRODUCTION

This manual provides detailed instructions for the safe and efficient use of your Itari M832 Portable Thermal Printer. Please read this manual thoroughly before operating the device and retain it for future reference.

PRODUCT OVERVIEW

The Itari M832 is a compact, inkless thermal printer designed for portability and convenience. It supports various paper sizes, including 8.5" x 11" Letter and A4, and offers wireless connectivity via Bluetooth, as well as USB connection for computers.



Image: The Itari M832 Portable Thermal Printer, demonstrating its compact size and versatility with different printouts like contracts, photos, and educational materials, alongside a smartphone connected via Bluetooth.

Package Contents

Upon unpacking, please verify that all items are present:

- 1 x Itari M832 Portable Printer
- 1 x 7M Thermal Paper Roll
- 1 x USB-C Cable
- 1 x M832 Portable Printer User Manual (this document)
- 1 x Storage Bag for M832 Thermal Printer (if included in your specific package)

DEVICE COMPONENTS

Familiarize yourself with the key components of your Itari M832 printer:



Image: A detailed view of the Itari M832 printer, highlighting its power button, power indicator, paper exit slot, push button, charging port, and reset button.

- **Power Button:** Used to turn the printer on/off.
- **Power Indicator:** Displays the printer's power status.
- **Push Button:** Releases the top cover for paper loading.
- **Exit Slot:** Where printed documents emerge.
- **USB-C Charging Port:** For charging the device and connecting to computers.
- **Reset Button:** For factory reset or troubleshooting (use a pin to press).

SETUP

1. Charging the Printer

Before first use, fully charge the printer using the provided USB-C cable and a compatible power adapter (not included). The power indicator will show charging status.

2. Loading Thermal Paper

1. Press the push button to open the top cover.
2. Insert the thermal paper roll or flat thermal paper into the paper compartment. Ensure the printing side faces upwards.
3. Adjust the paper roll stopper (if using roll paper) to secure the paper in place according to its width. The printer supports widths of 2.08" (53mm), 3.14" (80mm), 4.33" (110mm), A4, and 8.5" x 11" US Letter.
4. Close the top cover firmly until it clicks into place.

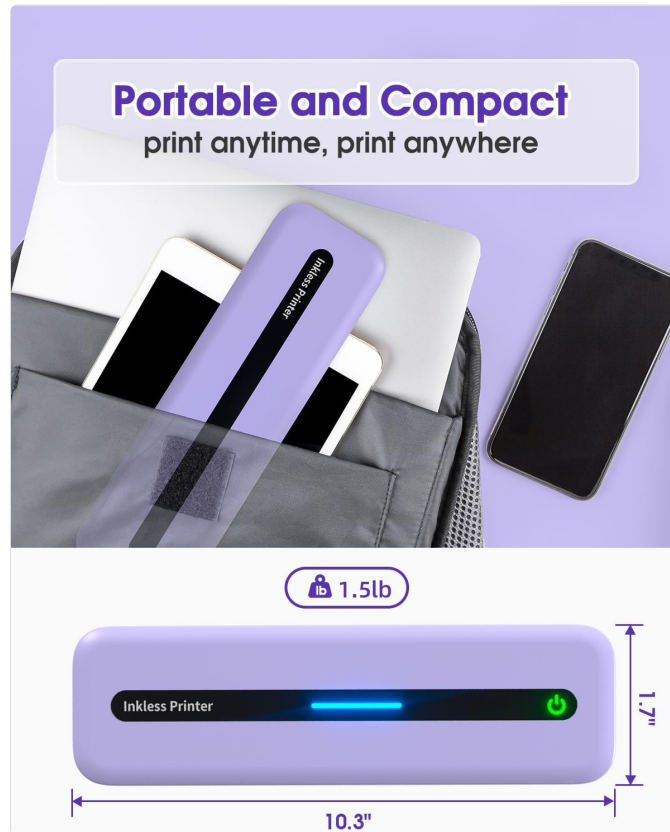

Image: The Itari M832 printer with its top cover open, illustrating how to load thermal paper and adjust the internal baffle for different paper sizes.

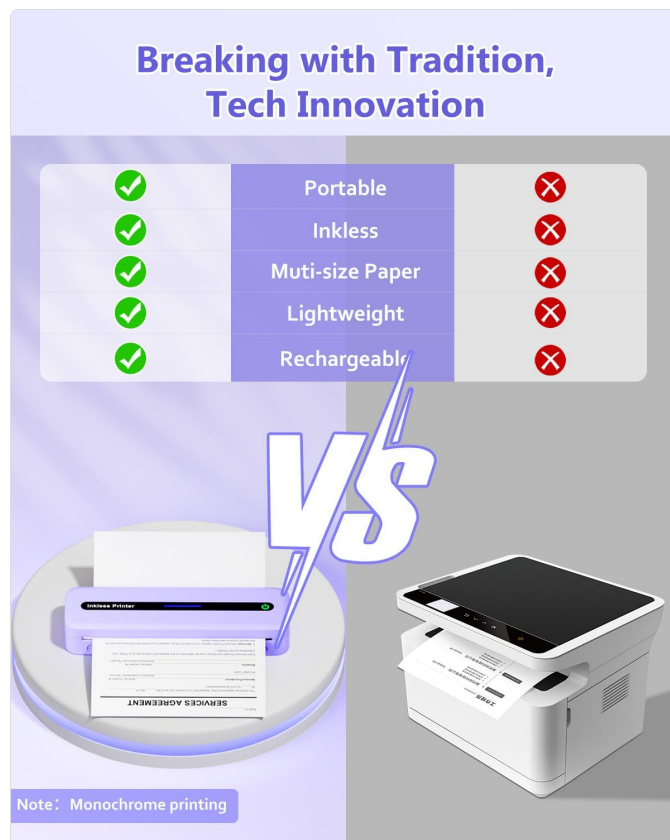

Image: The Itari M832 printer showcasing its compatibility with flat paper, continuous paper, and roll paper, highlighting its flexible paper handling capabilities.

OPERATING INSTRUCTIONS

1. Powering On/Off

Press and hold the Power Button for approximately 3 seconds to turn the printer on or off. The power indicator will illuminate when the printer is on.

2. Connecting to a Mobile Device (Bluetooth)

1. Ensure the printer is powered on.
2. Download the "Phomemo" app from your device's app store (available for iOS and Android).
3. Enable Bluetooth on your mobile device.
4. Open the "Phomemo" app, search for the M832 printer, and connect.
5. Within the app, select the desired document or image to print and choose the correct paper type/size.
6. Initiate printing from the app.

Your browser does not support the video tag.

Video: This video demonstrates the general setup and operation of the Itari M832 printer, including identifying components, loading paper, turning on, connecting to the mobile app, and printing a sample document.

3. Connecting to a Computer (USB)

1. Ensure the printer is powered on.
2. Connect the printer to your computer using the provided USB-C cable.
3. Visit the Itari website (itaricartridge.com/pages/download-center) to download and install the appropriate printer driver for your operating system (Windows 10/11, macOS, Linux).
4. Once the driver is installed, select the M832 printer from your computer's print dialogue.

5. Initiate printing from your computer.

Your browser does not support the video tag.

Video: This video demonstrates the process of printing from a Windows computer using the Itari M832 Portable Printer, including driver installation and document printing.

4. Printing Quality

The Itari M832 printer offers a 300dpi resolution for clear and sharp monochrome prints. Adjust print settings within the app or driver for optimal results.



Image: A magnified comparison demonstrating the superior clarity and sharpness of 300dpi prints from the Itari M832 printer compared to lower resolution alternatives.

MAINTENANCE

1. Cleaning the Print Head

To maintain print quality, regularly clean the print head. Use a soft, lint-free cloth lightly dampened with isopropyl alcohol. Gently wipe the print head surface. Ensure the printer is off and completely dry before use.

2. Battery Care

The printer is equipped with a 2600mAh Lithium Polymer battery. For optimal battery life, avoid fully discharging the battery frequently and store the printer in a cool, dry place when not in use for extended periods.

3. Paper Storage

Store thermal paper in a cool, dry place away from direct sunlight and heat to prevent discoloration and degradation of print quality.

TROUBLESHOOTING

Problem	Possible Cause	Solution
Printer does not turn on.	Low battery or power issue.	Charge the printer using the USB-C cable. Ensure the power button is held for 3 seconds.
Cannot connect via Bluetooth.	Bluetooth is off, incorrect printer selected, or app issue.	Ensure Bluetooth is enabled on your device. Select the correct M832 printer in the Phomemo app. Restart the app or printer.
Poor print quality (faint/blurry).	Print head dirty, incorrect paper type, or low print density setting.	Clean the print head. Ensure you are using thermal paper. Adjust print density settings in the app/driver to "Heavy" or "Medium".
Paper jam.	Improper paper loading or foreign object.	Turn off the printer, open the cover, and carefully remove any jammed paper. Reload paper correctly.
Printer not recognized by computer.	Missing or incorrect driver installation.	Verify driver installation from itaricartridge.com . Reinstall if necessary. Ensure USB cable is securely connected.

If problems persist after attempting these solutions, please contact Itari customer support for assistance.

SPECIFICATIONS

- **Model:** M832
- **Printing Technology:** Thermal
- **Connectivity:** Bluetooth, USB-C
- **Print Resolution:** 300 dpi (Monochrome)
- **Supported Paper Sizes:** 2.08" (53mm), 3.14" (80mm), 4.33" (110mm), A4, 8.5" x 11" US Letter
- **Battery:** 2600mAh Lithium Polymer (included)
- **Product Dimensions:** 12.2 x 4.49 x 3.62 inches
- **Item Weight:** 2.18 pounds (0.99 Kilograms)
- **Compatible Devices:** Android, iOS, iPad, Windows 10/11, macOS, Linux
- **Printer Ink Type:** Inkless

WARRANTY AND SUPPORT





Itari provides free, lifetime technical support for the M832 Portable Thermal Printer. If you encounter any issues or require assistance, please contact our customer service team via:

- Remote assistance
- Email
- WhatsApp
- Phone

Our 7*24H professional after-sales service team is dedicated to providing satisfactory solutions.

For more information or to download drivers, visit: itaricartridge.com/pages/download-center

Related Documents - M832

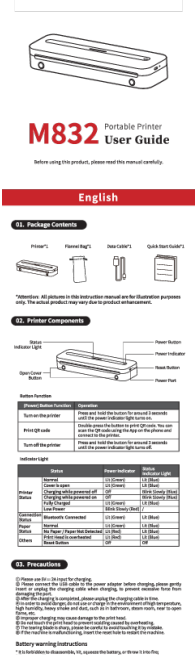
	<p>Itari PM-241-BT Quick Start Guide: Wireless Label Printing</p> <p>A comprehensive quick start guide for the Itari PM-241-BT Bluetooth label printer, covering app download, printer connection, PDF import, printing, and PC connectivity for small businesses.</p>
	<p>Itari PM-241 Logistics Label Printer User Guide: Setup, Installation, and Operation</p> <p>Comprehensive user guide for the Itari PM-241 Logistics Label Printer, covering quick start, product overview, setup for Windows and macOS, label loading, maintenance, troubleshooting, and driver installation.</p>
	<p>A886 Tattoo Printer Quick Start Guide</p> <p>A comprehensive quick start guide for the Itari A886 Tattoo Printer, detailing setup, app connection via Bluetooth, printing from mobile and computer, maintenance, and troubleshooting.</p>
	<p>Phomemo M832 A4 Portable Thermal Printer User Guide and Tips</p> <p>Information and usage tips for the Phomemo M832 A4 Portable Thermal Printer by Zoolion, including setup instructions and troubleshooting advice.</p>
	

There is a warning on the back of the printer. Please read it carefully. If you do not read it, you may not be able to use the printer properly. If you do not read it, you may not be able to use the printer properly. If you do not read it, you may not be able to use the printer properly.

06. Install App

1. Download the App
Please search for "Phomemo" on your phone's App installed and download the App.
Search for "Phomemo" in the Apple App Store, click to download and install.
Search for "Phomemo" in the Google App Store, click to download and install.

2. How to download and install driver
Download the latest driver from the official website. Download the relevant driver according to the operating system version and follow the instructions to install the driver.

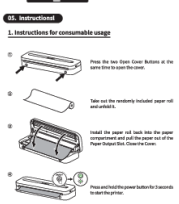

→ Note: When to differentiate the front and back of the printing paper.
1. When a piece of printing paper is printed, the color of the paper will not change. The front side of the paper will be white. The back side of the paper will be black. The front side of the paper will be white. The back side of the paper will be black. The front side of the paper will be white. The back side of the paper will be black.

3. Instructions for single sheet paper and folded paper usage
1. When using single sheet paper or folded paper, please use the paper with the same size as the paper in the printer. The paper will be white. The back side of the paper will be black. The front side of the paper will be white. The back side of the paper will be black. The front side of the paper will be white. The back side of the paper will be black.

3-1. Connect the printer to the App
1. Turn on the printer and power on the App. 2. Turn on the printer and power on the App. 3. Turn on the printer and power on the App. 4. Turn on the printer and power on the App. 5. Turn on the printer and power on the App.

3-2. Connect the printer to the computer
1. Turn on the printer and power on the computer. 2. Turn on the printer and power on the computer. 3. Turn on the printer and power on the computer. 4. Turn on the printer and power on the computer. 5. Turn on the printer and power on the computer.

07. Official Printing Paper Type
1. Thermal Paper: This paper is used for thermal printing. 2. Thermal Paper: This paper is used for thermal printing. 3. Thermal Paper: This paper is used for thermal printing. 4. Thermal Paper: This paper is used for thermal printing. 5. Thermal Paper: This paper is used for thermal printing.

Model	Color	Size	Material
Model	Color	Size	Material
Model	Color	Size	Material
Model	Color	Size	Material
Model	Color	Size	Material
Model	Color	Size	Material
Model	Color	Size	Material
Model	Color	Size	Material
Model	Color	Size	Material
Model	Color	Size	Material

08. FCC Warning
This device complies with part 15 of the FCC Rules. Operation is subject to the following two conditions: (1) This device may not cause harmful interference, and (2) this device must accept any interference received, including interference that may cause undesired operation.

09. E-Warning
The printer complies with the CE mark. The printer complies with the CE mark. The printer complies with the CE mark. The printer complies with the CE mark. The printer complies with the CE mark. The printer complies with the CE mark. The printer complies with the CE mark. The printer complies with the CE mark. The printer complies with the CE mark. The printer complies with the CE mark.



Phomemo M832 Portable Thermal Printer User Guide

User guide for the Phomemo M832 portable thermal printer, covering package contents, printer components, precautions, app installation, printing instructions, paper types, warranty, and FCC/IC compliance.

Phomemo M832 Printer Quick Start Guide

A concise guide to setting up and using the Phomemo M832 printer with both computer and smartphone connections, including driver installation, paper loading, and Bluetooth pairing.