

Manuals.plus /

- › AULA /
- › AULA F98 Pro Wireless Mechanical Keyboard User Manual

AULA F98 Pro

AULA F98 Pro Wireless Mechanical Keyboard User Manual

Model: F98 Pro | Brand: AULA

INTRODUCTION

This manual provides comprehensive instructions for the AULA F98 Pro Wireless Mechanical Keyboard. It covers setup, operation, maintenance, and troubleshooting to ensure optimal performance and longevity of your device. The AULA F98 Pro is a versatile mechanical keyboard featuring transparent keycaps, hot-swappable switches, a gasket structure, RGB backlighting, and an OLED screen, offering triple-mode connectivity (Bluetooth 5.0, 2.4GHz wireless, and USB-C wired).



Image: The AULA F98 Pro keyboard showcasing its transparent keycaps and vibrant RGB backlighting.

WHAT'S IN THE BOX

- AULA F98 Pro Wireless Mechanical Keyboard
- Keycap Puller
- USB Cable (Type-C)
- User Manual (this document)

SETUP AND CONNECTION

The AULA F98 Pro keyboard supports three connection modes: Bluetooth 5.0, 2.4GHz wireless, and USB-C wired. Choose the mode that best suits your needs.

1. Charging the Keyboard

Before first use, ensure the keyboard is fully charged. Connect the provided USB-C cable to the keyboard's Type-C port and the other end to a USB power source (e.g., computer USB port, wall adapter). The OLED screen will indicate charging status.

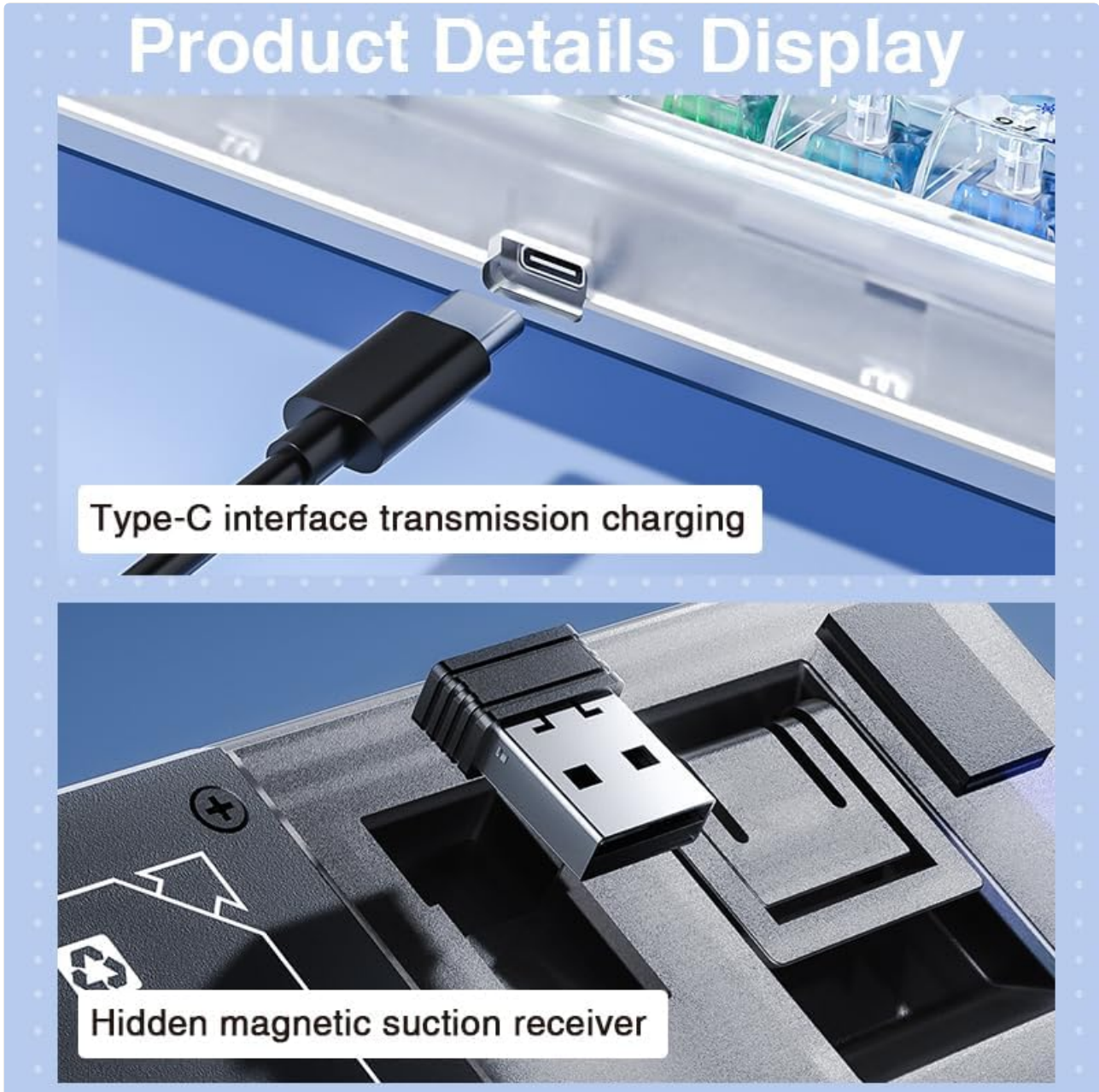

Image: Detail showing the Type-C interface for charging and data transmission, and the hidden magnetic compartment for the 2.4G wireless receiver.

2. Connection Modes

The keyboard can connect to various devices and operating systems including Windows, Mac, iOS, and Android.

Three-mode Connect

Supports three connection modes and multiple platform operations such as WIN/Mac/iOS/Android



Image: Visual representation of the keyboard's triple-mode connectivity, illustrating connections to a tablet, smartphone, and laptop.

USB-C Wired Connection

Connect the USB-C cable directly from the keyboard to your computer's USB port. The keyboard will be recognized automatically and is ready for use.

2.4GHz Wireless Connection

1. Locate the 2.4GHz USB receiver, usually stored in a magnetic compartment on the underside of the keyboard.
2. Plug the USB receiver into an available USB port on your computer.
3. Switch the keyboard to 2.4GHz mode using the mode switch (refer to the keyboard layout for exact location). The OLED screen will confirm the connection mode.

Bluetooth 5.0 Connection

1. Switch the keyboard to Bluetooth mode using the mode switch.
2. On your device (computer, tablet, smartphone), enable Bluetooth and search for new devices.
3. Select "AULA F98 Pro" from the list of available devices to pair. The OLED screen will indicate successful pairing.

OPERATING INSTRUCTIONS

OLED Screen and Multifunctional Knob

The integrated OLED screen displays various information such as time, connection mode, battery percentage, lighting effects, and system switching. The multifunctional knob allows for convenient control of settings.



Image: The OLED screen displaying time and connection status, with the multifunctional knob for adjustments.

- **Knob Rotation:** Adjusts volume by default. Can be customized for other functions via software.
- **Knob Press:** Mutes/unmutes audio by default. Can be customized.
- **OLED Display:** Shows current time, connection status (BT, 2.4G, Wired), battery level, and active lighting mode.

RGB Backlighting Control

The keyboard features 16.8 million RGB cool backlight options. Brightness and lighting speed are adjustable. Users can customize the backlight via the dedicated driver software.

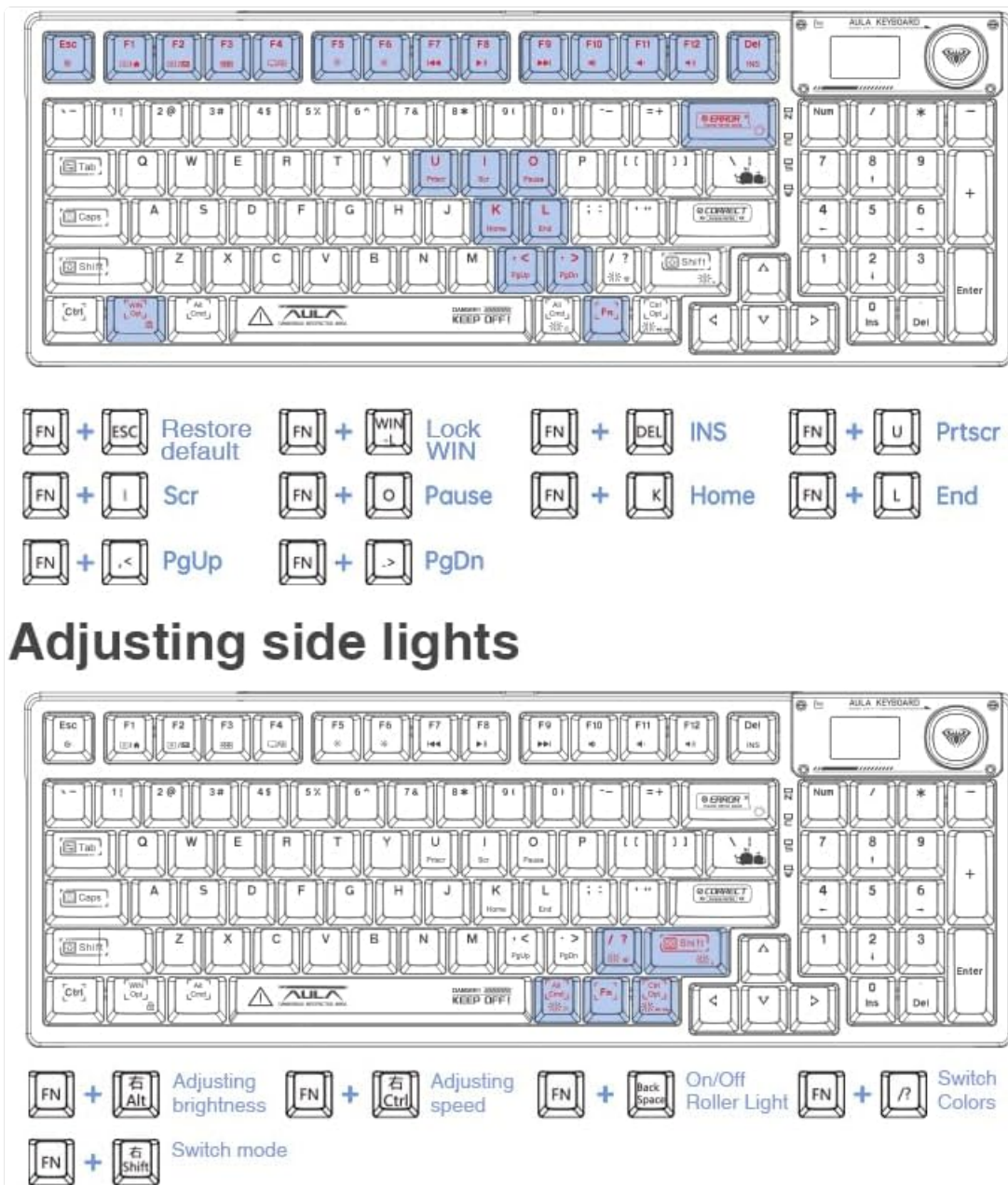

Image: A diagram illustrating various FN key combinations for controlling RGB lighting effects, brightness, speed, and other keyboard functions.

FN Key Combinations for Lighting Control

Combination	Function
FN + <	Adjust brightness down
FN + >	Adjust brightness up
FN + [Adjust lighting speed down
FN +]	Adjust lighting speed up
FN + \	Switch lighting mode
FN + ?	Switch lighting color
FN + Backspace	Toggle side lights On/Off

Hot-swappable Switches

The AULA F98 Pro features hot-swappable sockets, allowing users to easily replace 3-pin or 5-pin mechanical switches without soldering. This enables customization of typing feel and sound.

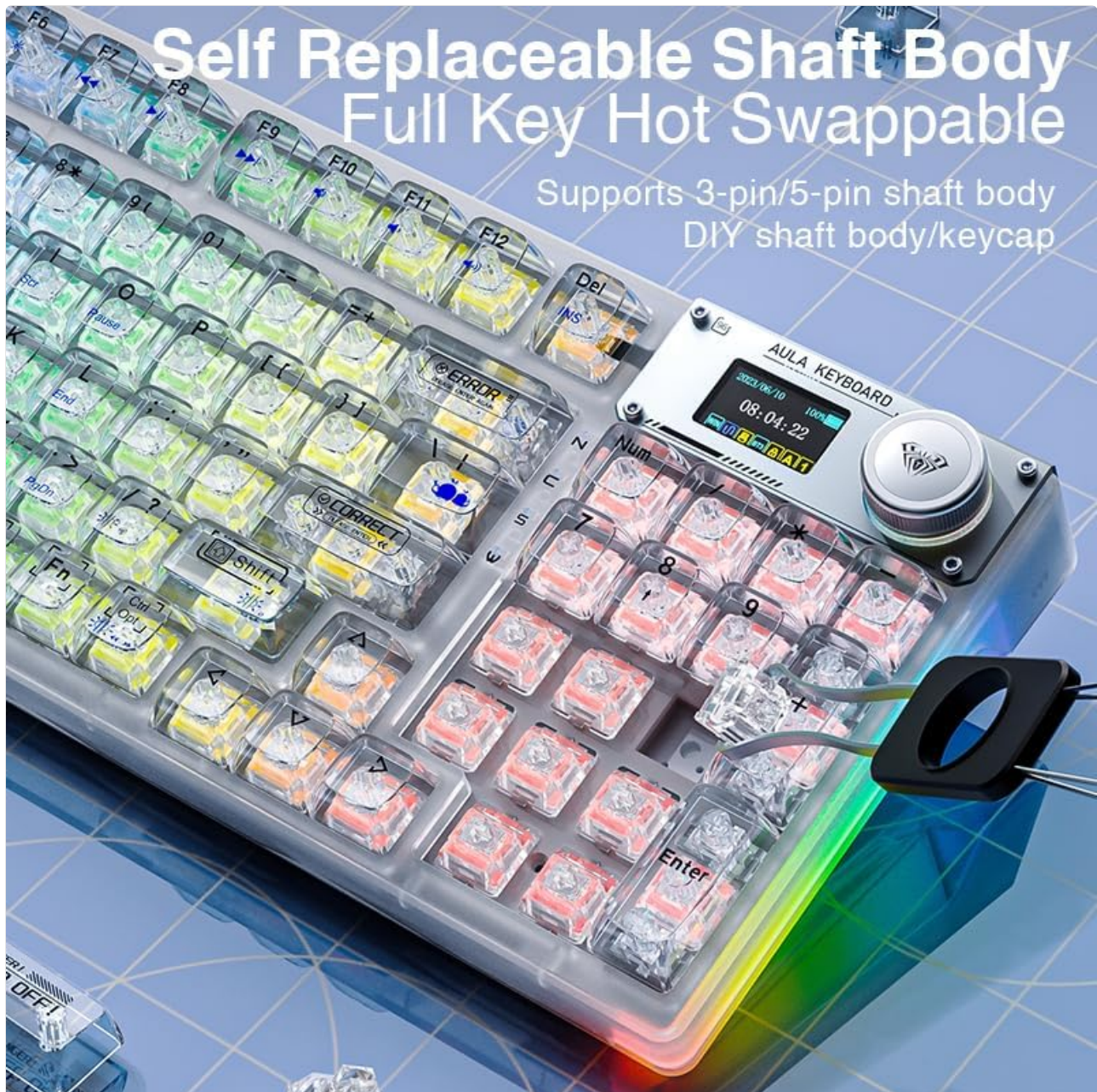

Image: Illustration of the hot-swappable feature, showing a keycap and switch being removed from the keyboard.

To replace switches:

1. Use the provided keycap puller to gently remove the desired keycap.
2. Use the switch puller (often integrated with the keycap puller) to carefully grip and pull out the switch.
3. Align the pins of the new switch with the holes on the PCB and gently press it into place until it clicks. Ensure pins are not bent.
4. Re-attach the keycap.

Macro Programming

The keyboard supports macro programming via dedicated driver software. This allows users to assign complex sequences of commands or keystrokes to a single key.

Refer to the official AULA software documentation for detailed instructions on macro creation and assignment.

MAINTENANCE

Regular maintenance helps preserve the keyboard's performance and appearance.

- **Cleaning Keycaps:** Use the provided brush to remove dust and debris between keycaps. For deeper cleaning, remove keycaps using the keycap puller and wipe them with a damp cloth and mild soap solution. Ensure keycaps are completely dry before reattaching.
- **Cleaning the Case:** Wipe the keyboard case with a soft, dry, lint-free cloth. Avoid abrasive cleaners or solvents.
- **Storage:** Store the keyboard in a dry, cool place away from direct sunlight and extreme temperatures.
- **Liquid Spills:** In case of liquid spills, immediately disconnect the keyboard from power. Invert the keyboard to drain liquid and allow it to air dry completely for at least 24-48 hours before reconnecting.

TROUBLESHOOTING

Common Issues and Solutions

Issue	Possible Solution
Keyboard not responding (wired)	<ul style="list-style-type: none">◦ Ensure the USB-C cable is securely connected to both the keyboard and the computer.◦ Try a different USB port on your computer.◦ Test with a different USB-C cable.◦ Restart your computer.
Keyboard not responding (wireless 2.4GHz)	<ul style="list-style-type: none">◦ Ensure the 2.4GHz USB receiver is properly plugged into a USB port.◦ Verify the keyboard is switched to 2.4GHz mode.◦ Check battery level; charge if low.◦ Try a different USB port for the receiver.
Keyboard not responding (Bluetooth)	<ul style="list-style-type: none">◦ Ensure the keyboard is in Bluetooth pairing mode.◦ On your device, unpair and re-pair the keyboard.◦ Check battery level; charge if low.◦ Ensure your device's Bluetooth is enabled and functioning.
RGB lighting not working or inconsistent	<ul style="list-style-type: none">◦ Adjust brightness using FN key combinations.◦ Try switching lighting modes.◦ Ensure the keyboard software/driver is installed and up to date for full customization.◦ Perform a factory reset (refer to keyboard layout for FN+ESC combination).
OLED screen not displaying correctly	<ul style="list-style-type: none">◦ Check battery level.◦ Restart the keyboard by turning it off and on.◦ If issues persist, contact customer support.

SPECIFICATIONS

Feature	Detail
Model	F98 Pro
Connectivity	BT5.0 / 2.4GHz Wireless / USB-C Wired
Keyboard Type	Mechanical
Switches	Pre-lubed Linear Switches, Hot-swappable (3-pin / 5-pin support)
Structure	Gasket Structure
Keycaps	Transparent
Backlighting	RGB (16.8 million colors)
Special Features	OLED Screen, Multifunctional Knob, Macro Programmable
Number of Keys	99
Product Dimensions	5.79 x 1.69 x 15.35 inches
Item Weight	3.05 pounds
Batteries	1 Lithium Ion battery (included)
Compatible Devices	Laptop, Gaming Console, PC, Tablet, Smartphone

WARRANTY AND SUPPORT

For warranty information and technical support, please refer to the official AULA website or contact AULA customer service directly. Keep your purchase receipt for warranty claims.

Official AULA Website: www.aulacm.com