

FX Luminaire LUX300SS

FX Luminaire LUX-300-SS Luxor Series ZDC Transformer Controller User Manual

Model: LUX300SS | Brand: FX Luminaire

1. INTRODUCTION

This manual provides detailed instructions for the installation, setup, operation, and maintenance of the FX Luminaire LUX-300-SS Luxor Series ZDC Transformer Controller. This device is designed to manage low-voltage landscape lighting systems, offering advanced control features including zone management, color adjustment, and astronomical timing.

2. SAFETY INFORMATION

Please read all safety instructions carefully before installing or operating the transformer. Failure to follow these instructions may result in electric shock, fire, or other hazards.

- Always disconnect power at the circuit breaker before installing or servicing the transformer.
- Installation must be performed by a qualified electrician in accordance with all local and national electrical codes.
- Do not operate the transformer with damaged wiring or if the casing is compromised.
- Ensure the transformer is mounted securely to a stable surface.
- This unit is designed for outdoor use and is rated for its intended environment.

3. PACKAGE CONTENTS

Verify that all components are present in the package:

- FX Luminaire LUX-300-SS Luxor Series ZDC Transformer Controller

4. PRODUCT OVERVIEW

The LUX-300-SS is a 300-watt ZDC transformer controller housed in a durable stainless steel metal case. It

provides comprehensive control over landscape lighting, integrating smart features for enhanced functionality.



Image 1: Front view of the FX Luminaire LUX-300-SS Transformer Controller, showing the control panel and display.

Key Features:

- 300 Watt power rating with 120V primary voltage and 60Hz frequency.
- Internet connectivity via LAN port or optional Wi-Fi Module (P/N - WIFIMOD2).
- Wireless control via optional iOS and Android app.
- Dimming control from 0-100%.
- Astronomical timing for automatic dusk and dawn adjustments based on location.
- Event-based scheduling and calendar-based programming.
- Up to 250 individual lighting zones.
- Color control with up to 30,000 colors per zone.
- Scene/Theme creation with up to 40 custom lighting themes.
- UL-1838, UL-379 compliant.

5. INSTALLATION

5.1 Mounting

The LUX-300-SS is designed for wall mounting. Select a suitable location that is easily accessible, protected from direct impact, and allows for proper ventilation. Ensure the mounting surface is capable of supporting the unit's weight (approximately 23 pounds).

1. Mark the desired mounting points on the wall using the transformer's mounting holes as a template.
2. Drill pilot holes appropriate for your mounting hardware (not included).
3. Securely fasten the transformer to the wall.



Image 2: The FX Luminaire LUX-300-SS Transformer Controller, illustrating its compact design suitable for wall mounting.

5.2 Electrical Connections

All electrical wiring must comply with local and national electrical codes. Ensure power is disconnected before

making any connections.

1. Connect the 120V AC input power to the designated terminals inside the transformer.
2. Connect the low-voltage output wires from your landscape lighting fixtures to the appropriate output terminals on the transformer. Refer to the wiring diagram inside the unit for specific terminal assignments.
3. Ensure all connections are tight and secure.
4. Close and secure the transformer casing.

6. SETUP AND CONFIGURATION

6.1 Initial Power-Up

Once installation is complete, restore power to the transformer at the circuit breaker. The unit's display will illuminate, guiding you through the initial setup process, which typically includes setting the date, time, and location.

6.2 Network Connection

The transformer can be connected to the internet for remote control and updates:

- **LAN Port:** Connect an Ethernet cable from your network router to the LAN port on the transformer.
- **Optional Wi-Fi Module:** If using the optional Wi-Fi Module (P/N - WIFIMOD2), install it according to its instructions. For areas with limited Wi-Fi strength, consider the Luxor Wi-Fi Module Remote Mount (P/N - WIFIMOD2RMT). Follow the on-screen prompts to connect to your Wi-Fi network.

6.3 App Control (iOS/Android)

Download the official FX Luminaire control app from the Apple App Store or Google Play Store. Follow the in-app instructions to pair your smart device with the transformer, enabling wireless control.

6.4 Zone and Color Control

The Luxor system allows for the creation of up to 250 independent lighting zones. Within each zone, you can adjust colors (up to 30,000 options) and dimming levels (0-100%). Use the transformer's interface or the mobile app to assign fixtures to zones and customize their settings.

6.5 Scheduling

The transformer offers flexible scheduling options:

- **Astronomical Timing:** Automatically adjusts dusk and dawn times based on your geographical location and seasonal changes.
- **Event-Based Scheduling:** Program specific lighting events to occur at certain times or in response to triggers.
- **Calendar-Based Programming:** Create schedules for specific dates or recurring patterns throughout the year.

7. OPERATION

7.1 Basic Operation

Navigate the transformer's menu using the control buttons on the front panel or through the mobile application.

The main display provides current status, time, and sunrise/sunset information.

7.2 Dimming Control

Adjust the intensity of your lighting fixtures from 0% to 100% using the dimming controls available on the unit or via the app. This allows for customized ambiance and energy saving.

7.3 Scene/Theme Creation

Create and save up to 40 custom lighting themes or scenes. A scene can combine specific zone settings, colors, and dimming levels to be activated with a single command, suitable for different occasions or moods.

8. MAINTENANCE

Regular maintenance ensures optimal performance and longevity of your transformer.

- Keep the transformer casing clean and free from debris. Use a soft, dry cloth for cleaning.
- Periodically inspect all wiring connections for tightness and signs of wear or corrosion.
- Ensure proper ventilation around the unit to prevent overheating.
- Check for any firmware updates through the mobile app or the transformer's network connection to ensure you have the latest features and bug fixes.

9. TROUBLESHOOTING

Refer to the table below for common issues and their solutions.

Problem	Possible Cause	Solution
Transformer not powering on	No power supply; tripped circuit breaker; faulty wiring	Check circuit breaker; verify power connections; consult an electrician.
Lights not turning on	Incorrect schedule; faulty fixture; loose wiring; dimming set to 0%	Check schedule settings; inspect fixture and wiring; adjust dimming level.
Cannot connect to Wi-Fi	Incorrect Wi-Fi password; out of range; Wi-Fi module not installed	Verify password; move closer to router or install remote module; ensure module is correctly installed.
App not controlling lights	App not paired; network issue; outdated app version	Re-pair app; check network connection; update app to latest version.

10. SPECIFICATIONS

Detailed technical specifications for the LUX-300-SS Transformer Controller:

Feature	Specification
Model Number	LUX300SS

Feature	Specification
Power Rating	300 Watts
Primary Voltage	120V
Frequency	60Hz
Material	Stainless Steel
Dimensions (D x W x H)	5 x 8 x 13 inches (12.7 x 20.3 x 33 cm)
Item Weight	23 Pounds
Mounting Type	Wall Mount
Compliance	UL-1838, UL-379
Connectivity	LAN, Optional Wi-Fi (P/N - WIFIMOD2)
Control	On-unit display, iOS/Android App
Lighting Zones	Up to 250 independent zones
Color Control	30,000 colors per zone
Scene/Theme Creation	Up to 40 custom themes

11. WARRANTY AND SUPPORT

For warranty information and technical support, please refer to the official FX Luminaire website or contact their customer service. Keep your purchase receipt for warranty claims. Support resources may include online FAQs, troubleshooting guides, and direct contact options.

Related Documents - LUX300SS

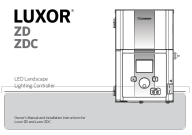
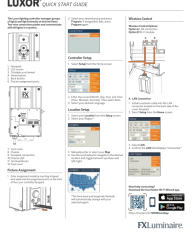
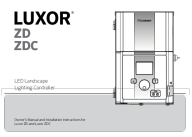
 <p>LUXOR[®] ZD ZDC</p> <p>LED Landscape Lighting Controller</p> <p>Model ZD and ZDC are available in 300W and 600W versions.</p>	<p>FX Luminaire Luxor ZD/ZDC LED Landscape Lighting Controller Manual</p> <p>Comprehensive owner's manual and installation guide for the FX Luminaire Luxor ZD and ZDC LED Landscape Lighting Controllers, covering installation, operation, programming, color features, troubleshooting, and warranty information.</p>
 <p>LUXOR[®] QUICK START GUIDE</p> <p>LED Landscape Lighting Controller</p> <p>Model ZD and ZDC are available in 300W and 600W versions.</p> <p>FX Luminaire</p>	<p>Luxor Lighting Controller Quick Start Guide</p> <p>A quick start guide for the Luxor lighting controller, detailing setup, fixture assignment, wireless control, color management, themes, and programs.</p>
 <p>LUXOR[®] ZD ZDC</p> <p>LED Landscape Lighting Controller</p> <p>Model ZD and ZDC are available in 300W and 600W versions.</p>	<p>Luxor ZD/ZDC LED Landscape Lighting Controller Owner's Manual</p> <p>Comprehensive owner's manual and installation instructions for the Luxor ZD and Luxor ZDC LED Landscape Lighting Controllers by FX Luminaire. Learn about setup, operation, programming, color control, and maintenance.</p>

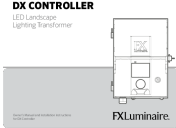
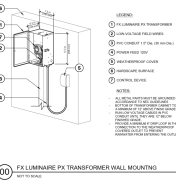
	<p>Luxor LED Landscape Lighting Controller Owner's Manual</p> <p>Comprehensive owner's manual and installation instructions for the FX Luminaire Luxor LED Landscape Lighting Controller, covering setup, operation, maintenance, and troubleshooting.</p>
	<p>FX Luminaire DX Controller: LED Landscape Lighting Transformer Owner's Manual and Installation Guide</p> <p>Comprehensive owner's manual and installation guide for the FX Luminaire DX Controller, an LED Landscape Lighting Transformer. Covers setup, operation, maintenance, and warranty information for outdoor lighting systems.</p>
	<p>FX Luminaire PX Transformer Wall Mounting Guide</p> <p>Detailed guide for installing the FX Luminaire PX Transformer on a wall, including component identification, dimensions, and essential installation notes for safe and effective operation.</p>

Documents - FX Luminaire – LUX300SS



[pdf] Specifications Catalog

FX Luminaire LX 300 Watt Digital Lighting Control Transformer Stainless Steel LUX300SS 143775
2022614163134 poolsupplyunlimited Products Manuals |||
LED Lighting Controller PROJECT CATALOG # TYPE NOTES
CC11FFOORRMMAATTRREEVVIISIIIOONN1111//2200//22 ... North America n e
230 V, International n eu 230 V, CE Certified EXAMPLE CONTROLLER
CONFIGURATION: **LUX300SS** 300 Finish n SS Stainless Steel n M Matte Gray
WIRELESS CONTROLLER ACCESSORIES: Spec...
lang:en score:44 filesize: 1.13 M page_count: 4 document date: 2022-06-14

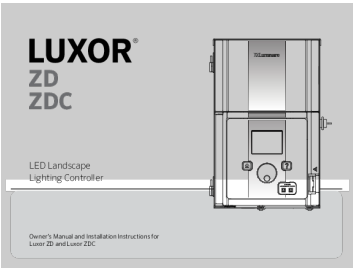

[FX Luminaire Luxor ZD/ZDC LED Landscape Lighting Controller Manual](#)

Comprehensive owner's manual and installation guide for the FX Luminaire Luxor ZD and ZDC LED Landscape Lighting Controllers, covering installation, operation, programming, color features, troubleshooting, and warranty information.
lang:en score:32 filesize: 2.47 M page_count: 38 document date: 2022-06-14

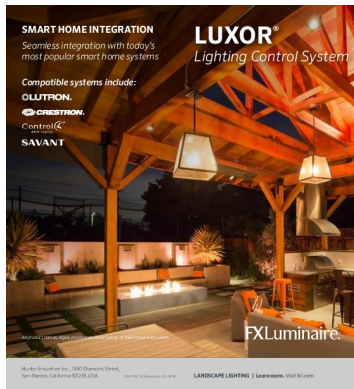

[pdf]

FX Luminaire LX 300 Watt Digital Lighting Control Transformer Stainless Steel LUX300SS 143775

202261416319 poolsupplyunlimited Products Manuals |||

SMART HOME INTEGRATION Seamless integration with today s most popular smart home systems Compatible systems include: LUXOR Lighting Control System All product names, logos, and brands are property of their respective owners. Hunter Industries Inc., 1940 Diamond Street, San Marcos, California 920...

lang:en score:26 filesize: 667.72 K page_count: 2 document date: 2022-06-14

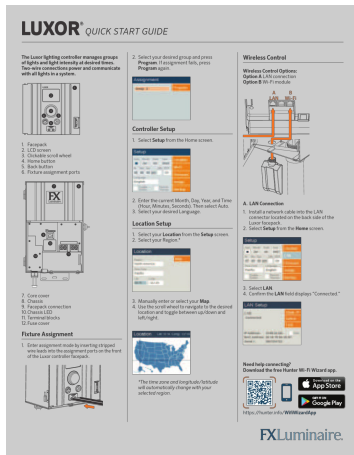

Luxor Lighting Controller Quick Start Guide

A quick start guide for the Luxor lighting controller, detailing setup, fixture assignment, wireless control, color management, themes, and programs.

lang:en score:26 filesize: 790.06 K page_count: 2 document date: 2022-06-14



[pdf] Specifications Catalog

LUXOR® Controller FX Luminaire Power 150 W 250 260 CE version 300 Input Primary 120 V 60 Hz 220 240 50 Amperage The Luxor lighting controller offers zoning dimming LUX n Watts default North America fxlit 187 ss luxor en web fxl sites files

LED Lighting Controller PROJECT CATALOG # TYPE NOTES C1 FORMAT REVISION 11/20/2017 C1 FORMAT REVIS ... Only n SS Stainless Steel n eu 230 V, CE Certified, 300 W Only EXAMPLE CONTROLLER CONFIGURATION: **LUX300SS** LUX WIRELESS CONTROLLER ACCESSORIES: Specify Separately Item n WI-FI MODULE n WI-FI...

lang:en score:23 filesize: 552.39 K page_count: 3 document date: 2020-04-22



[pdf] Specifications Catalog

fxlit 187 ss luxor en web stage fxl sites files |||

LED Lighting Controller PROJECT CATALOG # TYPE NOTES CC11FFOORRMMAATTRREEVVIISIIIOONN1111//2200//22 ... North America n e 230 V, International n eu 230 V, CE Certified EXAMPLE CONTROLLER CONFIGURATION: **LUX300SS** 300 Finish n SS Stainless Steel n M Matte Gray WIRELESS CONTROLLER ACCESSORIES: Spec...

lang:en score:18 filesize: 1.16 M page_count: 4 document date: 2022-05-26

FXLuminaire

Pinnacle™ PA-36 Accent Light



MODEL	
ARTICLE #	
TYPE	
WATT	

The PA-36 is engineered for adjustability and performance for complete, customized lighting control.

Quick Facts

- Fully adjustable
The PA-36 is designed to be adjusted to suit light levels and to provide the best lighting for the location, increasing safety and visibility.
- 300° rotation
The PA-36 is designed to rotate 300° to provide a wide range of lighting options, increasing safety and visibility.
- Built-in Light
The PA-36 is designed with a built-in light source, providing a wide range of lighting options, increasing safety and visibility.
- 300° rotation
The PA-36 is designed to rotate 300° to provide a wide range of lighting options, increasing safety and visibility.
- 300° rotation
The PA-36 is designed to rotate 300° to provide a wide range of lighting options, increasing safety and visibility.

Engineered to meet the needs of the construction industry, the PA-36 is designed to provide a wide range of lighting options, increasing safety and visibility.

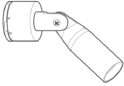

UNIVERSITY OF CALIFORNIA, BERKELEY

UNIVERSITY OF CALIFORNIA, BERKELEY

1 of 1

Download 20 May 2025 10:07:18

[pdf] Specifications Catalog

Pinnacle™ PA 36 Spec Sheet FX PAR36 Series 35W LED Flood Lamp pa36 specsheet reinders media ProductAttachment p a |||

Pinnacle™ PA-36 Accent Light PROJECT CATALOG # TYPE NOTES The PA-36 is engineered for adjustability ... Stainless Steel finish, 300 W PX Transformer, 300 W DX150SS DX300SS EX-150-SS LUX300ESS LUX300EUSS **LUX300SS** PX-300-SS PX Transformer, 900 W PX-900-SS PX Transformer with Timer and Photocell, 300 W...

lang:en score:16 filesize: 3.53 M page_count: 8 document date: 2025-05-20