

Manuals+

[Q & A](#) | [Deep Search](#) | [Upload](#)

manuals.plus /

- › [Seesii](#) /
- › [Seesii SE203 Dual Farad Spot Welder User Manual](#)

Seesii SE203

Seesii SE203 Dual Farad Spot Welder User Manual

Model: SE203

1. INTRODUCTION

Thank you for choosing the Seesii SE203 Dual Farad Spot Welder. This device is designed for precise spot welding of batteries, hardware, and electronic components, particularly suitable for nickel strips ranging from 0.1mm to 0.3mm thickness. It features a 3000F supercapacitor, 250 adjustable gears, and a 1.8-inch LCD for clear operation. Please read this manual thoroughly before use to ensure safe and efficient operation.



Image 1.1: The Seesii SE203 Dual Farad Spot Welder with its main components, including the welding unit, power adapter, welding pens, foot switch, nickel strip, and welding needles.

2. SAFETY INFORMATION

WARNING: Improper use of this spot welder can result in serious injury or damage to the equipment. Always follow these safety guidelines:

- Always wear appropriate personal protective equipment (PPE), including safety glasses and gloves, when operating the spot welder.
- Ensure the work area is well-ventilated and free from flammable materials.
- Do not touch the welding pens or electrodes during operation, as they can become extremely hot and carry electrical current.
- Never attempt to weld materials other than those specified (e.g., nickel strips) or exceed the recommended thickness.
- Keep the device away from water or damp environments to prevent electrical shock.

- Disconnect the power adapter before performing any maintenance, cleaning, or changing welding needles.
- Do not modify the device or use non-original parts, as this may void the warranty and pose safety risks.
- Ensure proper electrical grounding if required by local regulations.
- Keep out of reach of children.

Important Note: A user review mentioned a potential safety hazard regarding internal wiring and the handle screws. While the manufacturer aims for safe design, always inspect your unit for any loose components or exposed wiring before use. If you suspect any electrical issue, discontinue use immediately and contact customer support.

3. PACKAGE CONTENTS

Verify that all items are present in your package:

- 1 x Seesii SE203 Spot Welder Unit
- 1 x Power Adapter
- 2 x Spot Welding Pens (with gold-plated terminals)
- 4 x Welding Needles (replaceable)
- 1 x Nickel Strip
- 1 x Foot Pedal Switch
- 4 x Non-slip Pads
- 1 x User Manual

All-in-One Packet

spot welder *1



Nickle Sheet*1



welding needles *4



Non-slip pad*4



foot pedal switch *1



manual *1



power adapter *1



spot welding pens *2

Image 3.1: An overview of all items typically included in the Seesii SE203 Spot Welder package.

4. SETUP

1. **Placement:** Place the spot welder unit on a stable, flat, and non-flammable surface.
2. **Attach Non-slip Pads:** Apply the four non-slip pads to the bottom of the unit for stability.
3. **Connect Welding Pens:** Insert the two spot welding pens into the designated "Spot welding pen interface" ports on the front of the unit. Ensure they are securely connected.
4. **Connect Foot Pedal (Optional):** If using the foot pedal for manual welding control, plug the foot pedal switch into the "Foot joint" port.
5. **Connect Power Adapter:** Plug the power adapter into the "Charging interface" on the back of the unit, then connect the adapter to a suitable power outlet.
6. **Power On:** Flip the "Switch" on the back of the unit to the ON position. The 1.8-inch LCD screen will illuminate.

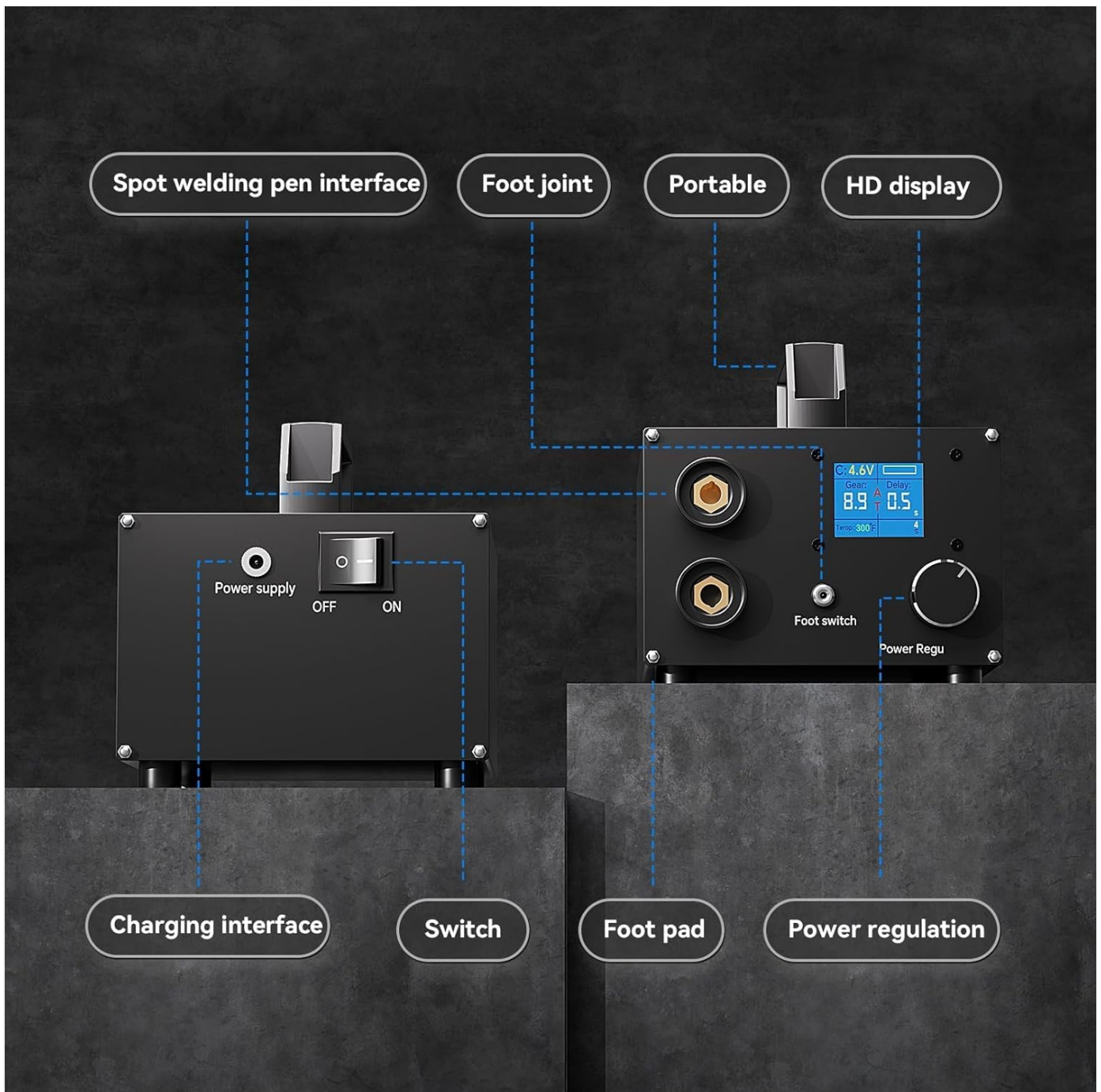

Image 4.1: Connection diagram illustrating the spot welding pen interface, foot joint, charging interface, and power switch locations.

5. OPERATING INSTRUCTIONS

5.1 Understanding the LCD Display

The 1.8-inch TFT-LCD screen provides real-time information about the welding process:

- **C: [Voltage]V:** Displays the current capacitor voltage.
- **Gear:** Shows the selected welding gear level (1-250).
- **Delay:** Indicates the welding delay time (0.5-2.5s).
- **Temp:** Displays the internal temperature of the unit.
- **Battery Icon:** Shows the charge status of the supercapacitor.

1.8-inch TFT-LCD screen.

Clear parameters, welding status at a glance.



Image 5.1: The LCD screen displaying welding parameters such as capacitor voltage, gear setting, delay, and temperature.

5.2 Adjusting Welding Parameters

Use the "Power Regu" knob on the front panel to adjust the welding gear (power level) from 1 to 250. Higher numbers indicate more power. The unit also allows for 0.1 gear precision adjustment and a welding delay from 0.5 to 2.5 seconds.

250 Gears Adjustable

Precision welding at your fingertips



Image 5.2: The rotary knob for adjusting the welding gear, offering 250 levels of precision.

5.3 Welding Modes: Auto & Foot Pedal Switching

The SE203 supports both automatic and foot pedal-controlled welding modes. The selection is typically made via a switch or automatically detected when the foot pedal is connected.

- **Automatic Mode:** The welder will automatically detect contact with the nickel strip and initiate the weld after a set delay.
- **Foot Pedal Mode:** Press the foot pedal to initiate the weld after placing the welding pens on the nickel strip. This provides more precise control over the welding timing.

Auto & Pedal Free Switching

Satisfying diverse needs with both automatic and foot pedal switch options

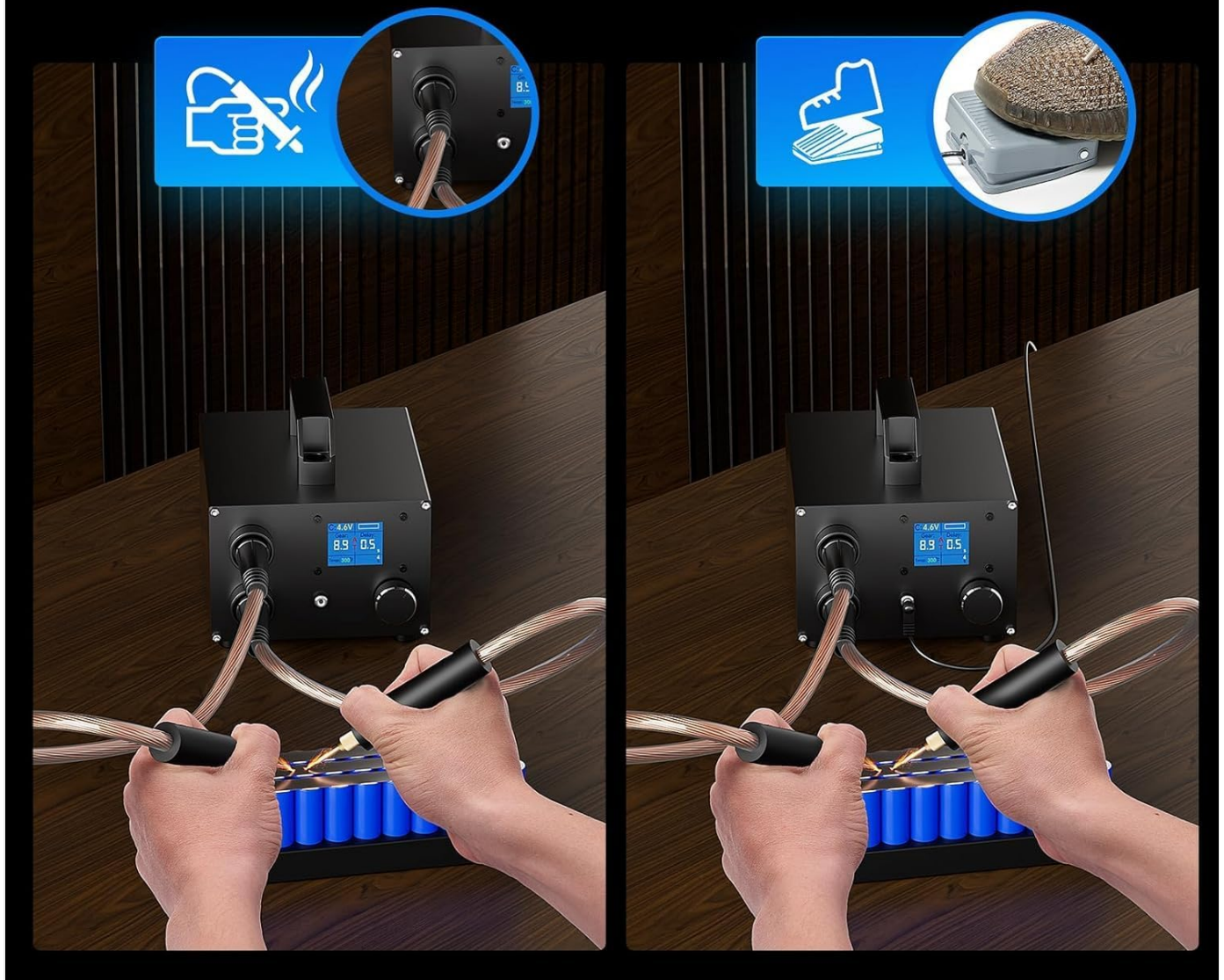

Image 5.3: Illustrates the two operational modes: automatic welding (left) and foot pedal-controlled welding (right).

5.4 Welding Process for Nickel Strips (0.1-0.3mm)

This spot welder is optimized for nickel strips between 0.1 mm and 0.3 mm thickness. Adjust the gear setting according to the thickness of the material you are welding. Thicker materials generally require higher gear settings.

1. Ensure the battery terminals and nickel strip are clean and free of oxidation.
2. Place the nickel strip firmly against the battery terminal.
3. Position the two welding pens on the nickel strip, ensuring good contact and even pressure. The tips should be slightly apart, not touching each other.
4. Initiate the weld:
 - In **Automatic Mode**, the weld will trigger automatically after the set delay once good contact is detected.
 - In **Foot Pedal Mode**, press the foot pedal to trigger the weld.
5. After the weld, lift the pens carefully. Inspect the weld joint for strength and appearance. Adjust gear settings as

needed for optimal results.

0.1-0.3mm Micro Welding

Detailed Coloring, Perfect Welding Results

- 18650 BAT ✓
- 26650 BAT ✓
- 32650 BAT ✓
- NIMH ✓
- Ni/Cd ✓

0.1mm

0.2mm

0.3mm

Image 5.4: Visual guide demonstrating the application of welding pens for different nickel strip thicknesses (0.1mm, 0.2mm, 0.3mm).

SeeSii

Dual Farad Spot Welder

Stronger and Safer Welding



Image 5.5: An individual demonstrating the use of the spot welder for assembling battery packs.

6. MAINTENANCE

- **Cleaning:** Regularly clean the welding pens and electrodes to remove any residue or oxidation. Use a fine-grit sandpaper or file if necessary to maintain sharp, clean tips.
- **Needle Replacement:** The welding needles are consumable and will wear down over time. Replace them when they become too short or blunt to ensure consistent weld quality.

20-INCH Gold-Plate Terminal Welding Pen

Equipped with 4pcs welding needles



The welding needles are replaceable



Image 6.1: Exploded view of the welding pen, highlighting the replaceable welding needles.

- **Storage:** Store the spot welder in a dry, cool place, away from direct sunlight and moisture.
- **Supercapacitor Care:** The integrated balancing circuit helps maintain the supercapacitor's health. Avoid completely discharging the unit for extended periods.
- **Fan Control:** The intelligent fan control strategy ensures the fan operates only when needed, extending its lifespan. Keep the fan vents clear of obstructions.

7. TROUBLESHOOTING

Problem	Possible Cause	Solution
No power/LCD not lighting up	Power adapter not connected; Power switch off; Faulty power outlet.	Check power adapter connection; Ensure power switch is ON; Test outlet with another device.

Problem	Possible Cause	Solution
Weak or inconsistent welds	Low gear setting; Dirty/worn welding needles; Poor contact with nickel strip/battery; Nickel strip too thick.	Increase gear setting; Clean or replace welding needles; Ensure firm, even pressure; Use appropriate nickel strip thickness (0.1-0.3mm).
Overheating	Continuous heavy use; Blocked ventilation.	Allow the unit to cool down; Ensure fan vents are clear. The intelligent fan control should manage this automatically.
Welder not triggering in Auto mode	Poor contact; Foot pedal connected (overrides auto mode).	Ensure good contact with both pens; Disconnect foot pedal if you intend to use auto mode.

8. SPECIFICATIONS

Brand	Seesii
Model Number	SE203
Capacitor Type	Dual Farad Supercapacitor
Capacitor Capacity	3000F
Adjustable Gears	250 levels
LCD Screen Size	1.8 inches
Nickel Strip Thickness	0.1mm - 0.3mm
Power Source	AC (via included power adapter)
Package Dimensions	25 x 21.5 x 20 cm
Item Weight	3.3 kilograms

9. WARRANTY AND SUPPORT

For warranty information, technical support, or service inquiries, please refer to the contact details provided with your purchase documentation or visit the official Seesii website. Please have your model number (SE203) and purchase date ready when contacting support.

