

Manuals+

[Q & A](#) | [Deep Search](#) | [Upload](#)

manuals.plus /

- > [ApoloSign](#) /
- > [ApoloSign 32" Portable Smart TV User Manual](#)

ApoloSign SW3295T Pro

ApoloSign 32" Portable Smart TV User Manual

Model: SW3295T Pro

INTRODUCTION

The ApoloSign 32" Portable Smart TV is a versatile, high-definition display designed for flexible use across various environments. Featuring a 1080p Incell Touch Screen, 8GB RAM, 128GB storage, and an Android operating system with Google Play Store support, this device offers a comprehensive entertainment and productivity solution. Its built-in battery and full swivel rotation enhance portability and viewing comfort.

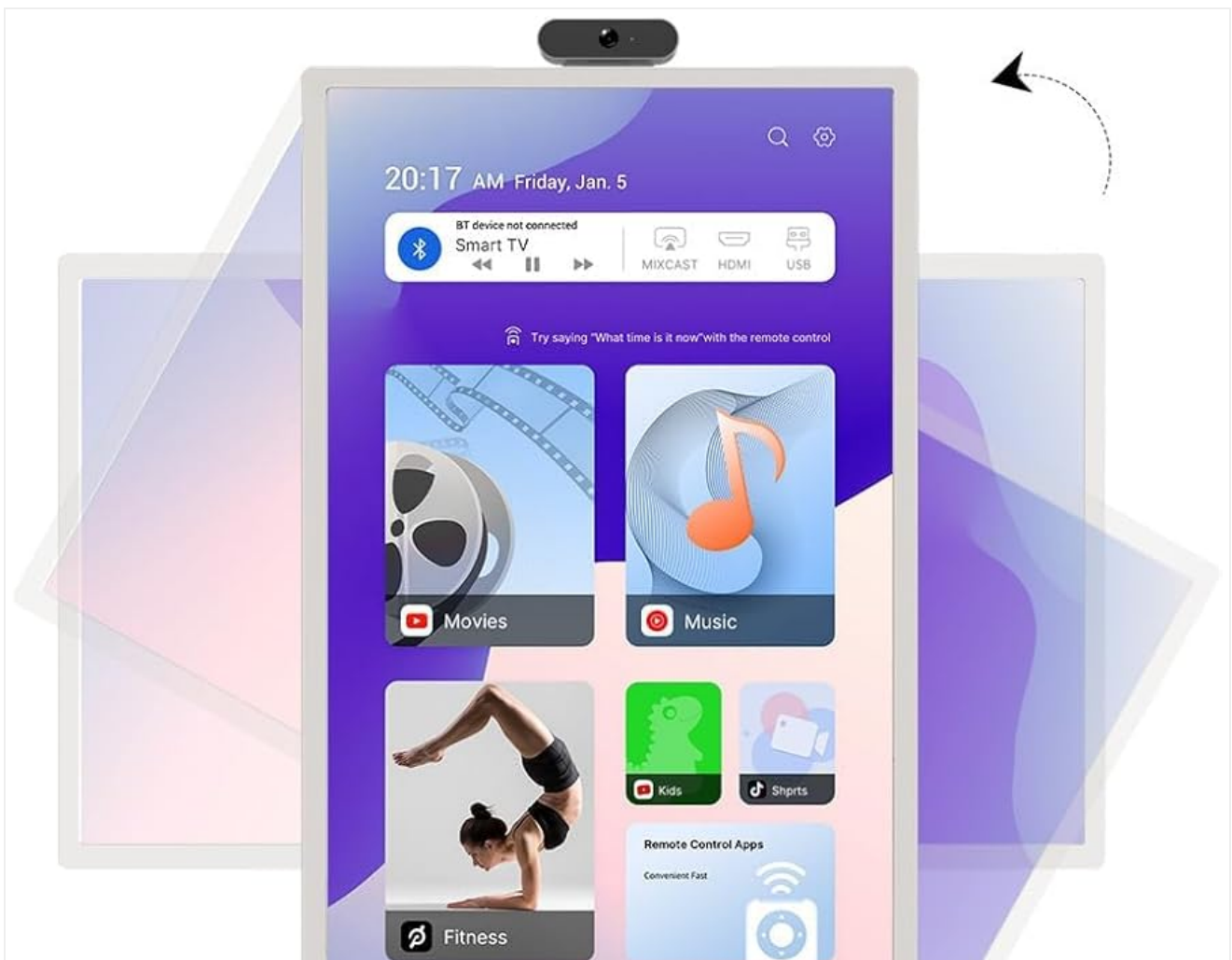



Figure 1: ApoloSign 32-inch Portable Smart TV in vertical orientation.

SETUP GUIDE

This section provides step-by-step instructions for assembling your ApoloSign Portable Smart TV. Please follow these steps carefully to ensure proper setup.

Your browser does not support the video tag.

Video 1: How to install ApoloSign Mobile Smart Screen. This video demonstrates the complete assembly process.

1. Unpacking

1. Carefully open the packaging box.
2. Lift the first layer of foam cushioning.
3. Remove the stand and the circular base from the packaging.
4. Remove the display screen, remote control, power cord, foot pads, screwdriver, and user manual from the box.

2. Attaching the Stand

1. Place the circular base on the foam cushion groove to prevent it from rotating during assembly. Ensure the

front of the base (with the large hole) is facing the correct direction.

2. Remove the cover plate from the base to access the internal components.
3. Thread the power cord of the stand through the base.
4. Align the slot position and insert the stand into the base. Rotate and insert slowly, ensuring the stand is fully inserted without any exposed silver edges.
5. Check if the positioning column is correctly inserted.
6. Tighten the four (PM3*16) screws on the base using the provided screwdriver.
7. After tightening the screws, insert the power cord of the base into the charging board socket.
8. Arrange the power cord neatly inside the base, then cover it with the cover plate.
9. Once the stand is installed, carefully take it out of the foam and stand it upright on the ground.

3. Installing the Monitor

1. Hold the screen and open the interface dust cover on the back of the monitor.
2. Separate the magnetic cover plate from the VESA mount on the stand.
3. Align the two pre-installed screws on the VESA of the screen with the U-shaped holes on the stand and slide the monitor onto the stand.
4. Lock the remaining two (PWM4*6) screws into the VESA mount.
5. Then tighten the two pre-installed screws on the VESA mount.
6. Plug the power cord from the right side of the stand around to the left into the monitor socket.
7. Align the VESA cover plate with the dot and push it forward to make it fit tightly with the VESA.
8. Rotate the monitor counter-clockwise to a vertical screen orientation.
9. Remove the dust cover from the side of the monitor to access the ports.
10. Then remove the camera's cable and plug it into the blue USB3.0 port on the monitor.
11. Installation is now complete.

OPERATING INSTRUCTIONS

Your ApoloSign Portable Smart TV offers a range of features and functionalities for an enhanced user experience.

Screen Adjustments

The smart screen provides flexible angle adjustments for comfortable viewing in any position.

- **Rotation:** The screen can be rotated ± 90 degrees to switch between landscape and portrait modes.
- **Tilting:** Adjust the screen by tilting it ± 25 degrees for optimal viewing angles.
- **Height Adjustment:** With its built-in stand, the screen supports an 18cm height adjustment.

Multi-angle Rotatable Screen

Flexible angle adjustment allows you to view in comfort from anywhere.

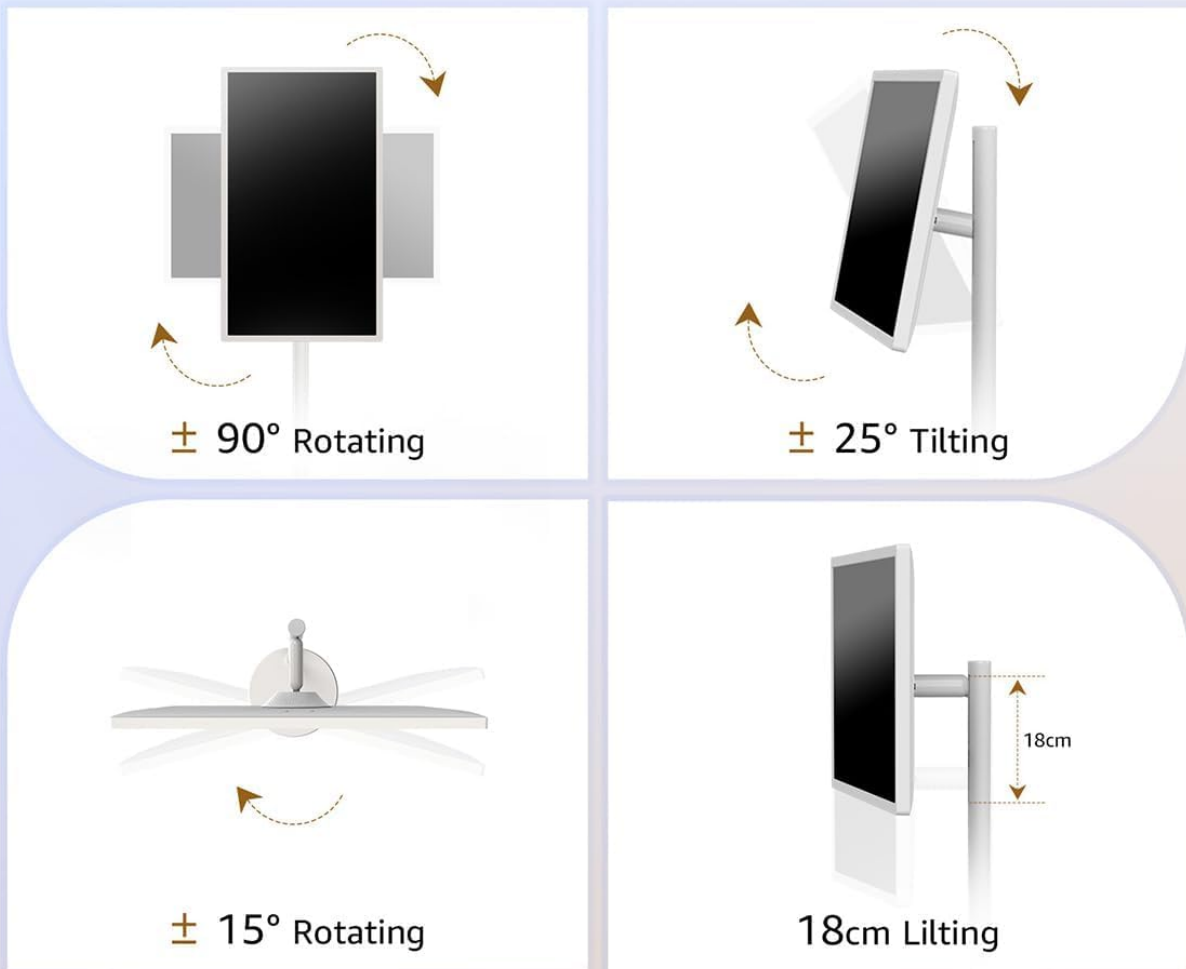

Figure 2: Demonstrates the multi-angle rotation and tilting capabilities of the screen.

Software and Apps

The ApoloSign system runs on a custom Android-based operating system with full Google certification, allowing access to a vast array of applications.

- **Google Play Store:** Effortlessly download and install any application available on the Google Play Store.
- **Customization:** Supports software downloads to customize your device for various needs.

Sophisticated and Tailored Android OS

Equipped with a highly customized Android OS, supporting app downloads and voice control.



Figure 3: The Android OS interface showing various applications and Google Play Store access.

Connectivity

The device offers flexible connectivity options for seamless content sharing.

- **Wireless & Wired Projection:** Easily share content from your phone, tablet, or computer.
- **USB Ports:** Equipped with 3 USB ports for connecting peripherals.
- **HDMI & Type-C:** Supports HDMI and Type-C inputs for external devices.
- **LAN & Earphone:** Includes LAN port for wired internet and an earphone jack for private listening.



Figure 4: Demonstrates screen casting from various devices to the ApoloSign Smart TV.

Usage Scenarios

The ApoloSign Portable Smart TV is designed for diverse applications:

- **Entertainment:** Stream movies, music, and shows from your favorite apps.
- **Productivity:** Use for work presentations, document editing, or as an extended display.
- **Fitness:** Follow along with home workout videos.
- **Video Calls:** Utilize the external 4K HD camera for clear video communication.
- **Gaming:** Connect gaming consoles for a seamless gaming experience with octa-core performance.
- **Learning:** Access educational apps and content.



Figure 5: The device supports connecting gaming consoles for an immersive gaming experience.



Figure 6: The external camera enables video calls and live streaming capabilities.

MAINTENANCE

Proper maintenance ensures the longevity and optimal performance of your ApoloSign Portable Smart TV.

- **Cleaning the Screen:** Use a soft, lint-free cloth specifically designed for electronic screens. Avoid abrasive cloths, paper towels, or harsh chemicals. Lightly dampen the cloth with water or a screen cleaner if necessary, and gently wipe the screen.
- **Cleaning the Body:** Wipe the exterior surfaces with a soft, dry cloth. Do not use liquid cleaners directly on the device.
- **Battery Care:** To prolong battery life, avoid fully discharging the battery frequently. Charge the device regularly, even if not in active use, to maintain battery health. Store in a cool, dry place if not used for extended periods.
- **Software Updates:** Regularly check for and install software updates to ensure your device has the latest features, security patches, and performance improvements.
- **Storage:** When storing the device, ensure it is in a stable position to prevent tipping. Keep it away from extreme temperatures and direct sunlight.

TROUBLESHOOTING

If you encounter issues with your ApoloSign Portable Smart TV, refer to the following common troubleshooting steps:

- **Device Not Powering On:** Ensure the power cord is securely connected to both the device and a working power outlet. Check if the power button is pressed correctly. If using battery power, ensure the battery is charged.
- **Screen Not Responding to Touch:** Restart the device. Ensure the screen is clean and free from debris.
- **Wi-Fi Connectivity Issues:** Check your Wi-Fi router and internet connection. Restart the device and the router. Re-enter the Wi-Fi password to ensure it is correct.
- **Bluetooth Pairing Problems:** Ensure Bluetooth is enabled on both the Smart TV and the device you are trying to pair. Move the devices closer to each other. If issues persist, try restarting both devices.
- **App Performance Issues:** Close and reopen the application. Clear the app's cache and data through the device settings. Ensure you have sufficient storage space.

- **No Sound:** Check the volume level on the device and any connected external audio devices. Ensure the correct audio output is selected in the settings.

If these steps do not resolve the issue, please contact ApoloSign Customer Support for further assistance.

SPECIFICATIONS

Feature	Detail
Product Dimensions	16.14 x 28.87 x 59.05 inches
Item Weight	56.9 pounds
Manufacturer	ApoloSign
Item model number	SW3295T Pro
Batteries	1 Lithium Ion batteries required. (included)
Screen Size	32 Inches
Resolution	FHD 1080p (1920 x 1080)
Screen Surface Description	Matte
Aspect Ratio	16:9
Total USB Ports	3
Operating System	Android OS (Google Certified)
RAM	8GB
Internal Storage	128GB

WARRANTY AND SUPPORT

ApoloSign is committed to providing high-quality products and excellent customer service.

- **Lifetime Technical Support:** ApoloSign offers lifetime technical support for your device.
- **24-Hour Quick Replay:** Expect prompt responses to your inquiries.
- **30 Days Replacement & Return:** Refer to your purchase agreement for details on replacement and return policies.

For any questions, technical assistance, or warranty claims, please visit the ApoloSign Store or contact their customer support directly. Contact information can typically be found in the original product packaging or on the official ApoloSign website.



Figure 7: Customer Support details.