

## OnLyee CR1024

# OnLyee Projection Alarm Clock User Manual

Model: CR1024

## INTRODUCTION

---

Thank you for choosing the OnLyee Projection Alarm Clock. This digital clock is designed to provide convenience and functionality with its advanced features, including a rotatable projector, dual alarm settings, adjustable display brightness, temperature and humidity monitoring, and multiple charging ports. This manual provides detailed instructions to help you set up and operate your new alarm clock effectively.



Image: The OnLye Projection Alarm Clock displaying time, date, temperature, and humidity, with a phone connected for charging.

## PRODUCT OVERVIEW

### Key Features:

- **Large LED Display:** A 5.9-inch ultra-clear LED screen for easy readability.
- **Ultra-Clear Projection:** 350° rotatable projector with 360° focus adjustment for time projection on ceilings or walls.
- **Adjustable Brightness:** 5-level adjustable display brightness and 5-level projection brightness.
- **Adjustable Volume:** 7-level adjustable alarm volume (45-116dB) with progressive buzzer.
- **Dual Alarms & 4 Wake-up Modes:** Set two independent alarms with options for weekend, weekdays, all seven days, or one-time settings.
- **Indoor Temperature & Humidity Monitor:** Displays real-time indoor temperature and humidity.
- **Snooze Function:** 9-minute snooze for additional sleep.
- **12/24 Hour & DST:** Supports 12-hour or 24-hour time format and Daylight Saving Time adjustment.

- **Dual Charging Ports:** Includes 1 USB and 1 Type-C charging port for external devices.
- **Battery Backup:** Requires 2 AAA batteries (not included) for memory backup during power outages.
- **Anti-Slip Design:** Ensures stability on surfaces.

## What's in the Box:

- OnLyee Projection Alarm Clock x 1
- Power Adapter x 1
- USB Power Cord x 1
- User Manual x 1

### Calendar Function

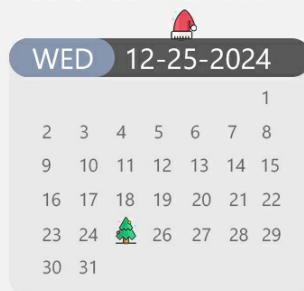

Image: Illustration showing the alarm clock, power adapter, USB power cord, and user manual as included items.

## SETUP

1. **Power Connection:** Connect the provided USB power cord to the clock's DC input port and plug the power adapter into a standard AC outlet (100-240V). The clock display will light up.
2. **Battery Backup Installation:** For memory backup during power outages, open the battery compartment on the bottom of the clock and insert 2 AAA batteries (not included), ensuring correct polarity. Note: The display will not show time and the alarm will not sound during a power outage when running on battery backup alone.
3. **Placement:** Place the alarm clock on a stable, flat surface. The anti-slip design on the bottom helps prevent movement.

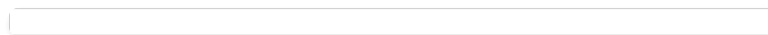

Image: A view of the bottom of the alarm clock showing the battery compartment for AAA batteries.

## OPERATING INSTRUCTIONS

### 1. Time and Date Setting

1. Press and hold the **"SET"** button to enter time setting mode.
2. Use the **"+"** or **"-"** buttons to adjust the value.
3. Press **"SET"** again to confirm and move to the next setting (Year → Month → Day → 12/24H Format → Hour → Minute).
4. Press **"SET"** one more time or wait 15 seconds for the settings to be saved automatically.



Image: Visual representation of 12-hour and 24-hour time formats, including DST.

## 2. Alarm Setting (Dual Alarms)

The clock supports two independent alarms (Alarm 1 and Alarm 2).

1. Press and hold the **"AL1"** or **"AL2"** button to enter the respective alarm setting mode.
2. Use the **"+"** or **"-"** buttons to adjust the Hour, then press the alarm button again to set the Minute.
3. After setting the time, press the alarm button again to select the alarm mode:
  - **Mon-Sun:** Alarm sounds every day.
  - **Mon-Fri:** Alarm sounds on weekdays only.
  - **Sat-Sun:** Alarm sounds on weekends only.
  - **One-Time:** Alarm sounds once and then deactivates.
4. Press the alarm button one more time or wait 15 seconds to save settings.
5. To activate/deactivate an alarm, short press the **"AL1"** or **"AL2"** button. An alarm icon will appear/disappear on the display.

### Night light with adjustable brightness

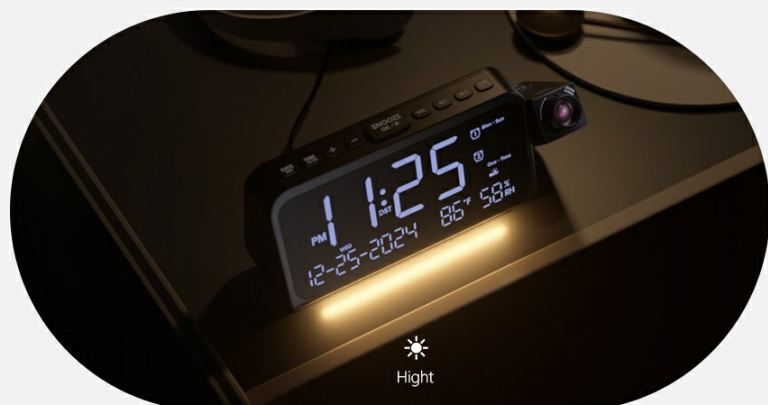
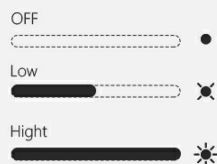

Image: Illustration of setting two separate alarms with options for daily, weekday, weekend, or one-time activation.

## 3. Projection Function

The clock features a 350° rotatable projector to display the time on your ceiling or wall.

1. **Adjusting Projection Angle:** Manually rotate the projector arm up to 350° to direct the time display to your desired surface.
2. **Focus Adjustment:** Rotate the focus ring on the projector lens to achieve a clear and sharp image. The optimal projection distance is 1.64-11.4 feet (0.5-3 meters).
3. **Image Flip:** If the projected image is upside down, short press the **"Power"** button on the side of the projector to flip it 180°.
4. **Projection Brightness:** Press the **"DIM"** button on the projector to cycle through 5 levels of projection brightness.

#### 12/24H format & DST



Image: Step-by-step guide on how to adjust the projection angle, focus, flip the image, and change projection brightness.

#### Dual Alarm Clock

Set your personal alarm to your habits



Image: A close-up view of the projector, highlighting its 350° rotation capability.

## 4. Display Brightness and Volume Adjustment

1. **Display Brightness:** Short press the **"DIM"** button on the top of the clock to cycle through 5 levels of LED display brightness.
2. **Alarm Volume:** When an alarm is sounding, press the **"VOL"** button to adjust the alarm volume through 7 levels (45-116dB). The alarm volume increases progressively.





## OnLye Projection Alarm Clock for Bedroom

No need to turn to head check the time

350°

180°

360°

11.4

Image: Visual representation of the five different brightness levels for the main LED display.



Turn on the projection and adjust the firmware to set it at a suitable angle.



1



If the image is blurry, turn the "focus knob" to adjust the clarity.

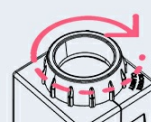

3



If the projected image needs to be flipped, short press the "Power" button to flip it.



2



Press the "DIM" button to adjust the brightness to the desired level (1-5 levels).



4

Image: Diagram showing the 7 levels of adjustable volume for the alarm, ranging from 45dB to 116dB.

### 5. Snooze Function

When the alarm sounds, press the large **"SNOOZE/OK"** button on the top of the clock to activate the 9-minute snooze function. The alarm will sound again after 9 minutes. To turn off the alarm completely, press any other button.

### 5-Level Adjustable Dimmer Brightness



Image: A hand pressing the large "SNOOZE/OK" button on the top of the alarm clock.

## 6. Temperature and Humidity Display

The clock continuously monitors and displays the indoor temperature and humidity. The temperature can be displayed in Celsius (°C) or Fahrenheit (°F). To switch between units, short press the **"TEMP"** button.



Image: The alarm clock displaying indoor temperature and humidity, with a family in the background, emphasizing a comfortable home environment.

## 7. Charging Ports

The clock is equipped with a USB-A and a Type-C charging port on the side, allowing you to charge your mobile devices such as smartphones and tablets.



Image: A close-up view of the alarm clock's side, showing the USB-A and Type-C charging ports in use, charging a phone and earbuds.

## 8. Daylight Saving Time (DST)

To activate or deactivate Daylight Saving Time, short press the **"DST"** button. The time will adjust by one hour forward or backward accordingly.

## MAINTENANCE

- Clean the clock with a soft, dry cloth. Do not use abrasive cleaners or solvents.

- Avoid exposing the clock to extreme temperatures, direct sunlight, or high humidity.
- Do not disassemble the clock. This will void the warranty.
- If the clock will not be used for an extended period, remove the AAA backup batteries to prevent leakage.

## TROUBLESHOOTING

Problem	Possible Cause	Solution
Clock display is off.	No power connection or power outage.	Ensure the power adapter is securely plugged into the clock and a working outlet. Check if there's a power outage.
Projection is blurry.	Projector focus not adjusted.	Rotate the focus ring on the projector lens until the image is clear.
Projected image is upside down.	Projection orientation needs adjustment.	Short press the "Power" button on the side of the projector to flip the image 180°.
Alarm does not sound.	Alarm not activated or volume too low.	Ensure the alarm icon is displayed on the screen. Adjust the alarm volume using the "VOL" button.
Time/settings reset after power loss.	No backup batteries or batteries are dead.	Install 2 new AAA batteries for memory backup. Note that the display will not show time during power outage, only settings are saved.

## SPECIFICATIONS

Brand	OnLyee
Model Number	CR1024
Color	White
Display Type	Digital LED
Product Dimensions	7.87"L x 2.36"W x 3.43"H (20 x 6 x 8.7 cm)
Item Weight	11.7 ounces (240 grams)
Power Source	Corded Electric (AC 100-240V), Battery Powered (2x AAA for backup)
Material	Acrylonitrile Butadiene Styrene (ABS)
Projection Distance	1.64-11.4 ft (0.5-3 meters)
Temperature Range	-50°C to 70°C (-58°F to 158°F)
Humidity Range	1% to 99% RH

## WARRANTY AND SUPPORT

OnLyee is committed to providing high-quality products and excellent customer service.

- **Warranty:** This product comes with an 18-month warranty from the date of purchase.
- **Email Support:** We aim to respond to all email inquiries within 8 hours.



- **Lifetime Support:** OnLyee provides lifetime technical support for this product.

For any questions, concerns, or support needs, please contact OnLyee customer service through the platform where you purchased the product or visit the official OnLyee brand store.



Image: OnLyee logo with text indicating 18 Months Warranty, 8H Email Reply, and Lifetime Support.

Related Documents - CR1024

	<p><a href="#">Mesqool CR1024 Projection Alarm Clock User Manual</a></p> <p>User guide for the Mesqool CR1024 Projection Alarm Clock, detailing time setting, date setting, DST function, alarm settings, brightness control, temperature/humidity display, night light, projection mode, and device charging.</p>
	<p><a href="#">CR1024 Projection Alarm Clock User Manual</a></p> <p>User manual for the CR1024 Projection Alarm Clock, detailing setup, time and date settings, alarm functions, projection features, brightness control, temperature/humidity display, and device charging capabilities.</p>
	<p><a href="#">Roxicosly CR1024 Projection Alarm Clock User Manual</a></p> <p>User manual for the Roxicosly CR1024 projection alarm clock. Features include a large display, date, day, temperature, humidity, dual alarms, USB charging, snooze, and backlight. Projects time onto walls and ceilings.</p>

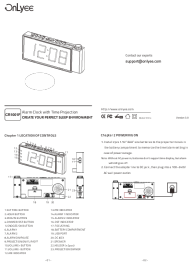
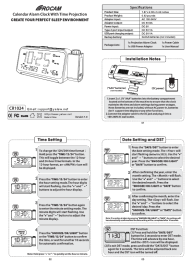
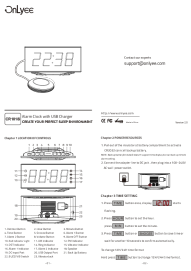
	<p><a href="#">OnLyee CR1001F Alarm Clock with Time Projection User Manual</a></p> <p>User manual for the OnLyee CR1001F Alarm Clock with Time Projection, detailing its features, controls, setup, and operation.</p>
	<p><a href="#">ROCAM CR1024 Calendar Alarm Clock with Time Projection User Manual</a></p> <p>Comprehensive user manual for the ROCAM CR1024 Calendar Alarm Clock, detailing its features including time projection, alarm settings, date configuration, DST function, brightness control, temperature/humidity monitoring, night light, and device charging capabilities.</p>
	<p><a href="#">OnLyee CR1018i Alarm Clock with USB Charger User Manual</a></p> <p>User manual for the OnLyee CR1018i Alarm Clock with USB Charger. Learn about its features, controls, power resources, time setting, alarm setting, DST, USB charging, dimmer, and vibrator functions.</p>

Documents - OnLyee – CR1024

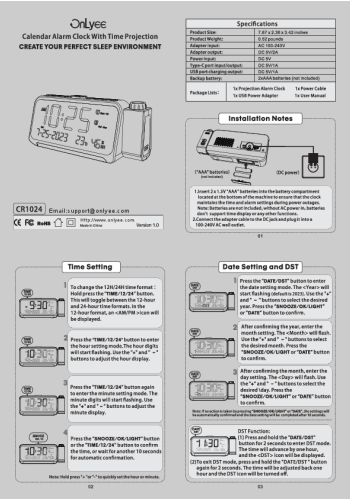

[pdf] User Manual

OnLyee CR1024 UserManual      2023 7 31 V1      cdr KUN Projection Alarm Clock for Bedroom with 350° Rotatable Projector 5 Brightness Dual Weekday Weekend Mode Temp Humidity Snooze Bedside Heavy Sleepers BlueUser ManualCR1024 User Manual Blue B0CKYQJWJG B0CJRNFDMG B0CLD4D8GG B0CJRJFFS4Projection Digital Level Dimmer Adjustable Volume Temperature Monitor Calendar 12 24H DST Battery Backup Home KitchenB1226U5DOGLB1226U5DOGLm media amazon images I B1226U5DOGLm B1226U5DOGL |||

Email:support onlyee.com Http://www.onlyee.com Pressthe AL1 or SNOOZE/OK/LIGHT buttontosavethealarmsettingsand exitthealarmsettingmode.

Note: ...

lang: score:13 filesize: 2.31 M page\_count: 2 document date: 2023-07-31