

Philips Hue 581553

Philips Hue Secure Battery Camera (Model 581553) Instruction Manual

Your guide to setting up, operating, and maintaining your Philips Hue Secure Battery Camera.

1. INTRODUCTION

The Philips Hue Secure Battery Camera is designed to provide enhanced security for your home, both indoors and outdoors. It integrates seamlessly with your existing Philips Hue lighting system, allowing for synchronized security responses. This manual provides essential information for the proper installation, operation, and maintenance of your camera.



Image: Philips Hue Secure Battery Camera and its retail packaging.

Product Overview Video

Video: An overview of the Philips Hue Secure system, highlighting its features and integration with lighting.

2. WHAT'S IN THE BOX

Ensure all components are present before proceeding with installation:

- Battery camera (white) x1
- 1M USB A Cable (white) x1
- Camera Mount (white) x1
- PSU (white) x1
- Screws and Anchors x1 set



Image: Visual representation of the camera's dimensions and core functionalities.

3. SETUP AND INSTALLATION

To fully utilize the Philips Hue Secure Battery Camera, a Philips Hue Bridge is required for seamless integration with your smart lighting system and advanced features.

3.1 Preparing for Installation

- Download the latest Philips Hue app on your smartphone or tablet.
- Ensure your Philips Hue Bridge is set up and connected to your network.
- Choose a suitable indoor or outdoor location for your camera. The camera has an IP65 rating, making it resistant to dust and water jets.

3.2 Mounting the Camera

The camera comes with a magnetic mount for flexible placement. Follow these steps for secure installation:

1. Twist to remove the mounting bracket from the magnetic mount.

2. Using a pencil, mark the placement of the bracket on the wall.
3. Drill a hole into the mounting surface at the marked spot.
4. Insert the wall plug and then insert the screw, leaving it slightly unscrewed for the power cable.
5. Route the power cable through the mounting bracket.
6. Place the magnetic mount back onto the mounting bracket and twist to secure.
7. Place the camera onto the magnetic mount and adjust its angle as desired.
8. Connect the power cable to the camera.

Installation Video Guide

Video: Step-by-step guide on how to install your Philips Hue Secure Battery Camera.

3.3 Connecting to the Philips Hue App

1. Open the Philips Hue app.
2. Navigate to the 'Settings' tab and select 'Security'.
3. Tap 'Add new device' and follow the on-screen instructions to scan the QR code on your camera or its ownership card.
4. The app will guide you through connecting the camera to your Hue Bridge and Wi-Fi network.

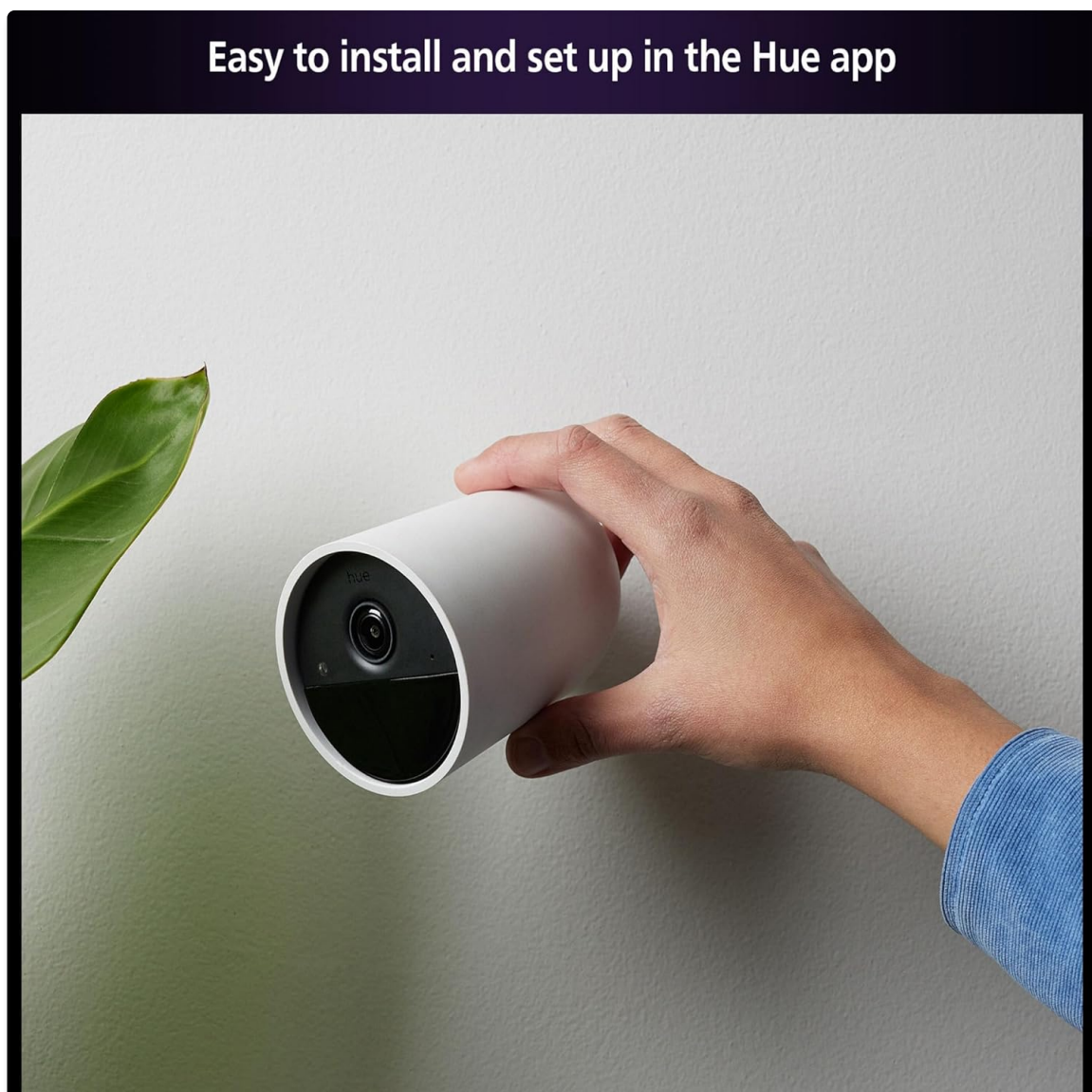

Image: The camera is designed for easy installation and setup via the Hue app.

4. OPERATING INSTRUCTIONS

The Philips Hue Secure Battery Camera offers a range of features for comprehensive home security, all controlled through the Philips Hue app.

4.1 Live View and Recording

- Access a crisp 1080p HD live stream of your camera's view at any time through the Hue app.
- The camera captures and records footage when motion is detected.
- Benefit from a free 24-hour video history, allowing you to review recorded events without a subscription.

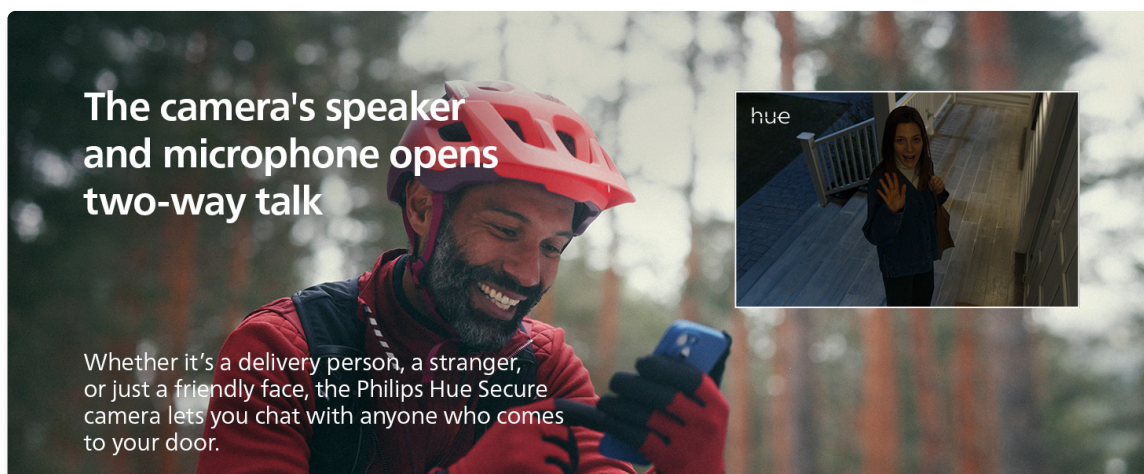

Image: Monitor your home in real-time with the Hue app's live view feature.

4.2 Motion Detection and Notifications

- Receive instant, motion-activated alerts directly on your mobile device whenever the camera detects activity.
- Configure activity zones within the app to focus on specific areas and reduce unwanted alerts.
- With a Secure plan, alerts can specify if motion was from a person, animal, vehicle, or package.

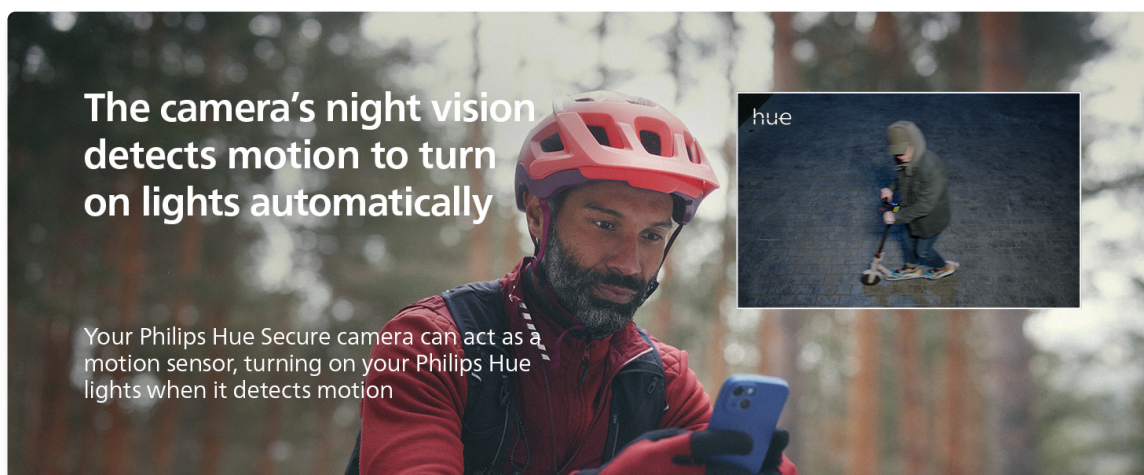

Image: Instant, motion-activated alerts keep you informed of activity detected by your camera.

4.3 Two-Way Audio and Alarms

- Utilize the camera's built-in speaker and microphone for two-way talk, allowing you to

communicate with visitors or deter intruders.

- Trigger light and sound alarms directly from the Hue app to warn off potential intruders when suspicious activity is observed.



Image: The camera's two-way audio feature allows for communication with individuals at your door.

5. KEY FEATURES

- **1080p HD Resolution:** Capture clear and sharp video footage day and night.
- **Infrared Night Vision:** See every detail even in low-light conditions.
- **Indoor and Outdoor Use:** Designed for versatile placement with an IP65 weather-resistant rating.
- **Rechargeable Battery:** Offers flexible placement without the need for constant power outlets.
- **Seamless Hue Integration:** Lights can automatically turn on when motion is detected, enhancing security.
- **End-to-End Encryption:** Your video data is protected with high privacy standards and two-factor authentication.

Made for indoor and outdoor use



Image: The camera is suitable for both indoor and outdoor environments.



Image: Enhanced night vision and HD live stream provide clear visuals in all lighting conditions.

6. MAINTENANCE

6.1 Cleaning

To maintain optimal performance, regularly clean the camera lens and body with a soft, damp cloth. Avoid using harsh chemicals or abrasive materials that could damage the camera's finish or lens.

6.2 Battery Charging

The Philips Hue Secure Battery Camera is rechargeable. When the battery level is low, you will receive a notification in the Hue app. Use the provided USB A cable and PSU to charge the camera. Ensure the charging port is dry before connecting the cable.

7. TROUBLESHOOTING

7.1 Connectivity Issues

- **Camera Offline:** Ensure your Wi-Fi network is active and the camera is within range of your router or Hue Bridge. Restarting your router, Hue Bridge, and camera may resolve the issue.
- **App Not Detecting Camera:** Verify the camera is powered on and in pairing mode (if applicable). Try rescanning the QR code in the Hue app.

7.2 Video Quality Problems

- **Blurry or Unclear Footage:** Clean the camera lens. Ensure there are no obstructions in the camera's field of view. Check your internet connection speed.
- **Poor Night Vision:** Ensure the infrared lights are not obstructed. Adjust the camera's position to minimize glare from nearby light sources.

7.3 Battery Life Concerns

- **Short Battery Life:** Frequent live view access, high motion activity, and extreme temperatures can affect battery life. Adjust motion sensitivity settings in the app.
- **Not Charging:** Ensure the charging cable and PSU are properly connected and functioning. Try a different power outlet.

8. SPECIFICATIONS

Feature	Detail
Model Number	581553
Indoor/Outdoor Usage	Indoor, Outdoor
Compatible Devices	Hue Bridge
Power Source	Battery Powered (1 Lithium Polymer battery included)
Connectivity Protocol	Wi-Fi





Video Capture Resolution	1080p
Frame Rate	30 frames per second
International Protection Rating	IP65
Special Features	Motion Sensor, 2-Way Audio, Night Vision, HD Resolution
Item Dimensions (L x W x H)	5.75 x 6.93 x 5.51 inches
Item Weight	2.11 pounds
Material	Plastic

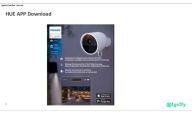

9. WARRANTY AND SUPPORT

For warranty information and technical support, please refer to the official Philips Hue website or contact their customer service. Keep your proof of purchase for warranty claims.

You can visit the official Philips Hue Store for more information and products: [Philips Hue Store](#)

Related Documents - 581553

	Philips Hue Secure Camera Onboarding Guide Step-by-step guide for installing the Philips Hue App and creating a Hue account for the Philips Hue Secure camera, covering setup, Wi-Fi connection, privacy settings, and security configuration.
	Philips Hue Secure Floodlight Camera User Manual and Installation Guide Detailed user manual and installation guide for the Philips Hue Secure Floodlight camera, covering setup, mounting, and connectivity.
	Philips Hue Secure Floodlight Camera User Manual and Installation Guide Comprehensive user manual and installation guide for the Philips Hue Secure Floodlight camera (model 442296204331). Learn how to install, wire, and configure this smart outdoor security lighting solution with integrated camera features using the Philips Hue app. Includes setup instructions, safety information, and support contacts.
	Philips Hue Legal Manual and Quick Start Guide: Compliance, Warranty, and Specifications Official legal manual and quick start guide for Philips Hue personal wireless lighting products, covering FCC compliance, limited warranty, safety warnings, technical specifications, and setup instructions.

	<p>Philips Hue Product Information, Warranty, and Safety Guidelines</p> <p>Comprehensive guide to Philips Hue products, covering regulatory compliance, limited warranty details, safety warnings, environmental specifications, and customer support. Includes information for various Hue accessories like Hue Bridge, Smart Button, Smart Plug, Dimmer Switch, and Motion Sensors.</p>
	<p>Philips Hue Iris Smart Lamp User Manual & Setup Guide</p> <p>Comprehensive guide for setting up and using the Philips Hue Iris personal wireless lighting. Includes installation steps, safety information, and product details.</p>