



[Manuals.plus](#) /

› [cudinham](#) /

› [cudinham Print Pods Mini Printer \(Model X6/MP-01\) Instruction Manual](#)

cudinham X6/MP-01

cudinham Print Pods Mini Printer (Model X6/MP-01) Instruction Manual

Your guide to setting up and using your cudinham mini printer.

1. PRODUCT OVERVIEW

The cudinham Print Pods Mini Printer is a portable, inkless thermal printer designed for printing black and white photos, stickers, notes, and labels directly from your smartphone. It utilizes thermal printing technology, eliminating the need for ink cartridges. The printer is compatible with both iOS and Android devices via the "Tiny Print" application.



Image: The cudinhham Print Pods Mini Printer, a compact white device.

2. WHAT'S IN THE BOX

Upon unboxing, please ensure all the following items are present:

- Mini Printer (1 unit)
- Thermal Printing Paper (5 rolls)
- Adhesive Printing Paper (5 rolls)
- User Manual (1 unit)
- Power Cable (1 unit, Type-C)

PORTABLE MINI PRINTER



Thermal Paper Roll * 5
Sticker Paper Roll * 5



User Manual * 1



Type-C Power Cord * 1



Packing Box

Image: Diagram showing the mini printer, thermal paper rolls, sticker paper rolls, user manual, and Type-C power cable included in the package.

3. SETUP GUIDE

3.1 Charging the Printer

Connect the provided Type-C USB cable to the printer and a low-power USB charging port. Avoid using fast charging adapters to prevent potential damage to the device.

BLUETOOTH & APP CONNECTED



Tips: Please connect Bluetooth within the "Tiny Print" APP



Tips: Please use a low-power USB charging port to charge; do not use a fast charging adapter.



Image: Illustration showing the printer being charged via a standard USB port, with a warning against using fast charging adapters.

3.2 Installing the Printing Paper

1. **Open the Paper Loading Compartment:** Gently open the printer's top cover to access the paper compartment.



Image: Step 1 - Opening the printer's paper loading compartment.

2. **Insert the Paper Roll:** Place the thermal paper roll into the compartment with the arc part facing downwards. Ensure the print side of the paper is correctly oriented.



Image: Step 2 - Correctly inserting the thermal paper roll with the arc facing down.

3. **Close the Lid:** Pull out a small portion (approximately 1 cm) of the paper from the printer's slot and then close the lid securely.

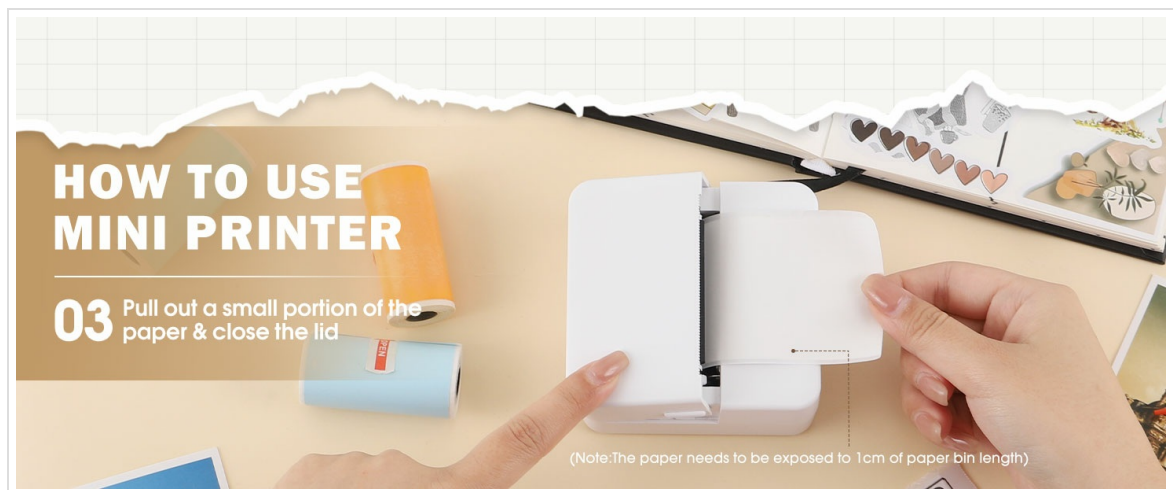

Image: Step 3 - Pulling out a small portion of paper and closing the printer lid.

Video: How to correctly replace the thermal paper of mini printer?

Your browser does not support the video tag.

This video demonstrates the proper procedure for loading thermal paper into the cudinhm mini printer, ensuring correct orientation for printing.

3.3 App Download and Bluetooth Connection

1. **Download the App:** Search for and download the "Tiny Print" app from your device's app store (compatible with Android 4.0 and iOS 9.0 or higher).
2. **Enable Bluetooth:** Turn on Bluetooth on your smartphone.
3. **Connect via App:** Open the "Tiny Print" app. Connect to the printer directly within the app. **Do not connect through your phone's system Bluetooth settings.**



Image: Visual guide for downloading the "Tiny Print" app, enabling Bluetooth, and connecting the printer within the app.

4. OPERATING INSTRUCTIONS

4.1 Printing from the App

The "Tiny Print" app offers various features for printing, including:

- Multiple free templates
- Free editing content
- Image/Text printing
- DIY options
- OCR functions

MULTI-FUNCTIONALITY APPS TO MEET YOUR NEEDS



Multiple Free Templates



Free Edit Content



Image / Text Printing



Free DIY



AI & More

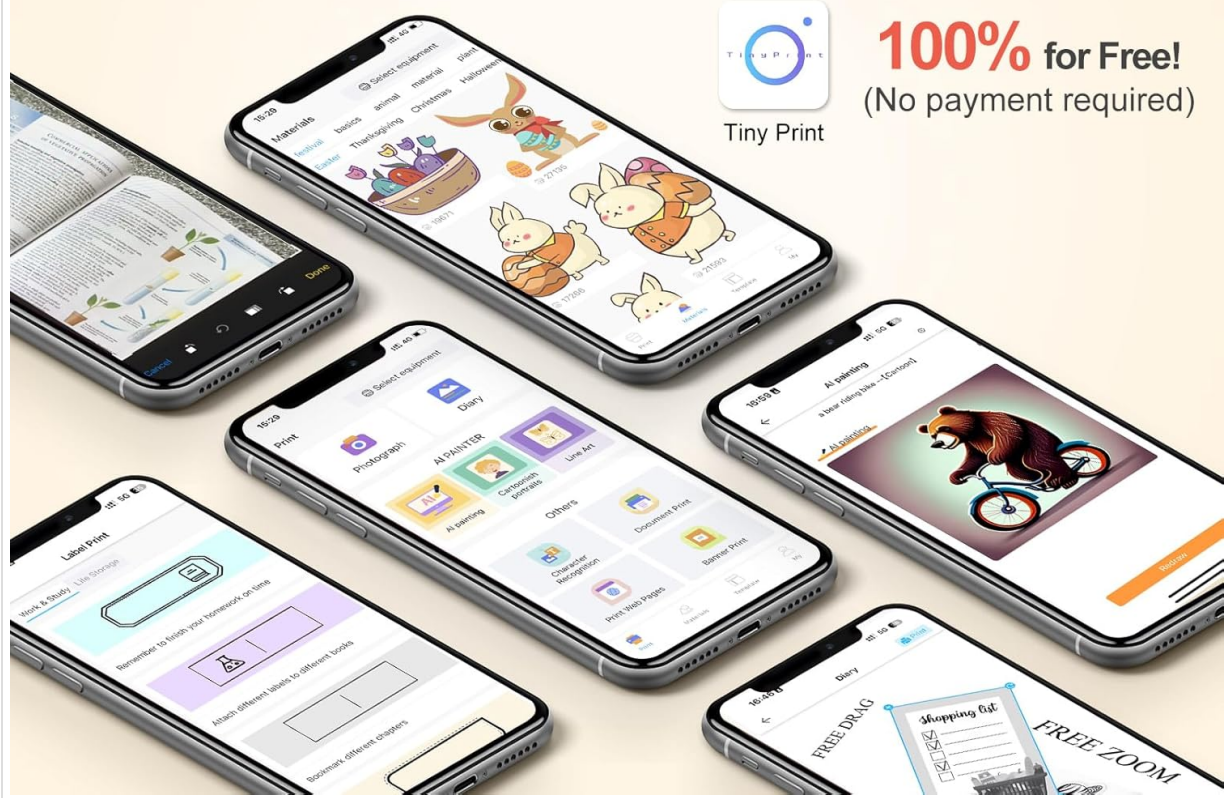

Tiny Print

100% for Free!
(No payment required)

Image: Screenshots of the "Tiny Print" app interface showcasing various functionalities like templates, editing, and AI features.

4.2 Adjusting Print Settings

For optimal print quality, especially for images, adjust the print depth within the app. It is recommended to use the "high definition" printing mode and set the print depth between 4 and 7.

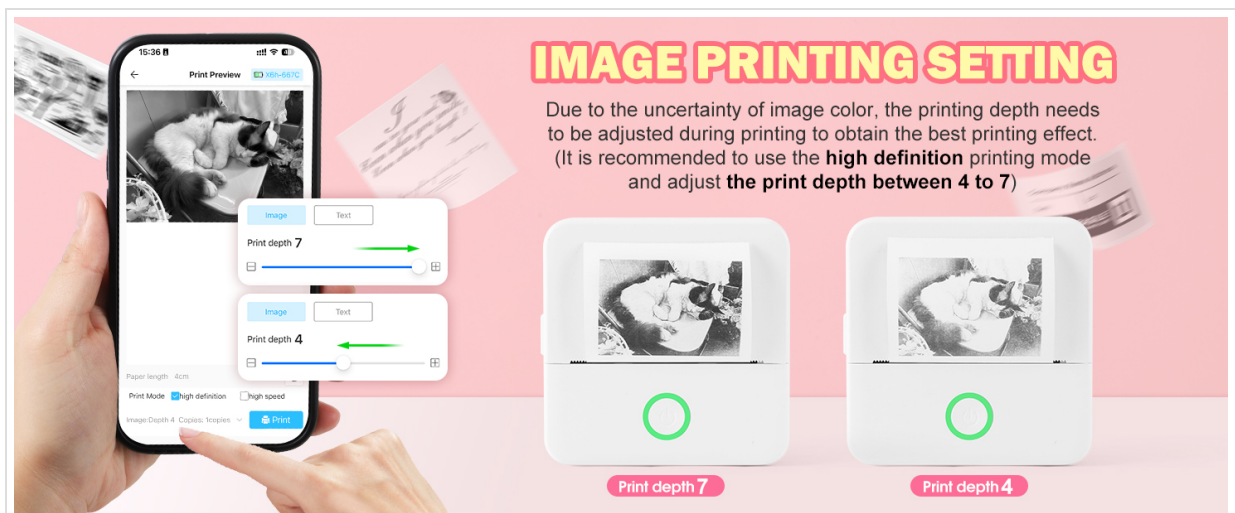

Image: App interface showing image printing settings with adjustable print depth (7 for darker, 4 for lighter).

When printing text, you can choose between image printing mode (emphasizes overall effect) or text printing mode (emphasizes text clarity). Adjust print depth as needed.

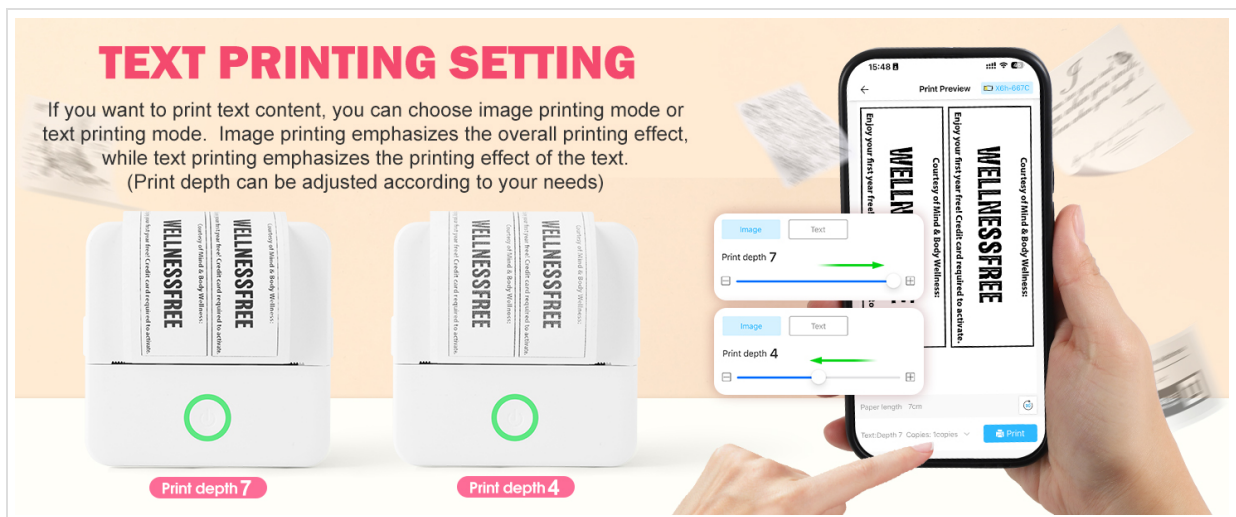

Image: App interface showing text printing settings with adjustable print depth.

4.3 Printing Applications

The cudinham mini printer can be used for various purposes:

- Printing black and white photos and pictures
- Creating study notes and to-do lists
- Making shopping lists
- Customizing bookmarks, labels, and greeting cards
- Scrapbooking and DIY crafts



Image: Collage showing various applications of the mini printer, including scrapbooking, labeling, note-taking, photo printing, gift cards, and shopping lists.

5. MAINTENANCE

5.1 Cleaning the Print Head

If print quality degrades or becomes unclear after repeated use, the laser bar (print head) may need cleaning. Open the paper loading compartment and carefully wipe the laser bar with a cotton swab lightly dampened with alcohol. Ensure the printer is turned off before cleaning.

6. TROUBLESHOOTING

6.1 Common Issues and Solutions

Issue	Possible Cause / Solution
Printer not connecting via Bluetooth	Ensure Bluetooth is enabled on your phone. Connect directly through the "Tiny Print" app, not your phone's system settings. Restart both the printer and the app.

Issue	Possible Cause / Solution
Poor print quality / Unclear prints	Adjust the "Print Depth" setting in the "Tiny Print" app (recommended 4-7 for high definition). Clean the printer's laser bar with alcohol if needed (refer to Maintenance section). Ensure paper is loaded correctly.
Red light indicator / Paper not feeding	The paper may not be placed properly. Re-open the compartment and ensure the paper roll is inserted correctly with the arc facing down and a small portion extended.
App freezing or crashing	Ensure your app is updated to the latest version. Close and restart the app. If the issue persists, try reinstalling the app.

7. SPECIFICATIONS

Feature	Detail
Brand	cudinham
Model Name	X6
Model Number	MP-01
Connectivity Technology	Bluetooth 5.0
Printing Technology	Thermal
Printer Output	Monochrome (Black Ink)
Max Print Speed Monochrome	20 ppm
Resolution	200 x 200 DPI
Product Dimensions	1.77"D x 3.35"W x 3.35"H
Battery	1200mAh Lithium-ion
Compatible Devices	Smartphones, Tablets (iOS 9.0+, Android 4.0+)
Print Media	Thermal Paper, Adhesive Thermal Paper (2.25 inches wide)

8. WARRANTY AND SUPPORT

8.1 Product Warranty

This cudinhams Print Pods Mini Printer comes with a **1-year limited warranty** from the date of purchase. Please retain your proof of purchase for warranty claims.

8.2 Customer Support

For technical assistance, troubleshooting not covered in this manual, or warranty inquiries, please contact cudinhams customer support through the retailer where the product was purchased or visit the official cudinhams website for contact information.