

Manuals+

[Q & A](#) | [Deep Search](#) | [Upload](#)

manuals.plus /

- › [BUVAYE](#) /
- › [BUVAYE BN03 Car Jump Starter with Air Compressor User Manual](#)

BUVAYE BN03

BUVAYE BN03 Car Jump Starter with Air Compressor

User Manual

INTRODUCTION

The BUVAYE BN03 Car Jump Starter with Air Compressor is a versatile and essential tool for vehicle owners. Designed for 12-volt vehicles, it features a powerful 4000A peak current capable of jump-starting gasoline engines up to 10 liters and all diesel engines. Beyond jump-starting, it integrates a 150 PSI air compressor for tire inflation, an emergency power bank for charging mobile devices, and multiple LED light modes for various situations. This device is built with 10 safety protections to ensure secure operation in diverse conditions, from extreme cold to high temperatures.



The BUVA YE BN03 Car Jump Starter with Air Compressor, showcasing its compact design and included accessories like jumper cables and inflation nozzles.

WHAT'S IN THE BOX

Upon unboxing your BUVA YE BN03, you will find the following components:

- 1 × Jump Starter with Air Compressor
- 1 × Heavy-Duty Battery Jumper Cables
- 1 × Detachable Air Hose
- 4 × Gas Nozzles (Presta to Schrader adapter, needle adapter, short tapered nozzle, long tapered nozzle)
- 1 × USB-C charging cable
- 1 × Instruction Manual
- 1 × EVA Carrying Case



SETUP

Initial Charging

Before first use, or if the device has been stored for an extended period, ensure the jump starter is fully charged. Connect the included USB-C charging cable to the USB-C input port on the device and plug the other end into a suitable USB power adapter (not included). The LCD display will indicate the charging status. It is recommended to keep the battery starting power above 50% for optimal performance.

Component Identification

Familiarize yourself with the main components and controls of the device:



Detailed diagram showing the various components and features of the BUVAYE BN03, including ports, buttons, and display.

- **Power Switch:** Turns the device on/off.

- **Air Pressure + / -:** Adjusts target air pressure for inflation.
- **Pressure Unit Adjustment:** Cycles through PSI, BAR, KPA, Kg/cm².
- **LED Flashlight Switch:** Activates and cycles through flashlight, SOS, and strobe modes.
- **USB-A Output:** For charging external devices.
- **USB-C Input Port:** For charging the jump starter.
- **Smart Clip Socket:** Connects the smart jumper cables.
- **Inflator Hose Socket:** Connects the detachable air hose.
- **Positive Clamp (Red):** Connects to the positive (+) terminal of the battery.
- **Negative Clamp (Black):** Connects to the negative (-) terminal of the battery.
- **Jump Start Port:** Connects to the smart jumper cables.

OPERATING INSTRUCTIONS

Jump Starting a Vehicle

Follow these steps to safely jump start your vehicle:

1. **Step 1:** Insert the Smart Clip into the Jump Starter's jump start port. Ensure a secure connection.
2. **Step 2:** Connect the red positive (+) clamp to the positive (+) terminal of the vehicle's dead battery. Connect the black negative (-) clamp to the negative (-) terminal of the vehicle's dead battery. The smart cables will auto-detect the connection.
3. **Step 3:** Once the indicator light on the smart clip turns green, start your car engine.
4. **Step 4:** After the engine starts, immediately remove the clamps from the car battery, then disconnect the smart clip from the jump starter.



Visual guide demonstrating the four-step process of using the BUVAYE BN03 to jump start a vehicle, from connecting the smart clip to starting the engine.

Your browser does not support the video tag.

Official product video demonstrating the jump-starting and inflation capabilities of the BUVAYE BN03. This video shows the device in action, highlighting its ease of use for starting vehicles and inflating tires.

Inflating Tires and Other Devices

The integrated air compressor can inflate car tires, bicycle tires, motorcycle tires, sports balls, and more.

1. **Step 1:** Connect the air hose to the valve of the tire or device you wish to inflate. Ensure it is securely screwed on.
2. **Step 2:** Press and hold the power button (often indicated by a "M" or similar icon) for 2 seconds to turn on the device. The

LCD display will show the current pressure.

3. **Step 3:** Long press the "O" button to switch between inflation modes (car, motorcycle, bicycle, ball). Short press the "O" button to select the desired pressure unit (PSI, BAR, KPA, Kg/cm²).
4. **Step 4:** Press the "+" and "-" buttons to preset the desired pressure value.
5. **Step 5:** Press the power button (often indicated by a "M" or similar icon) again to start the inflation pump. The pump will automatically stop once the preset pressure is reached.



Illustrates the process of connecting the air hose and operating the air compressor function of the BUVAYE BN03 to inflate a tire.

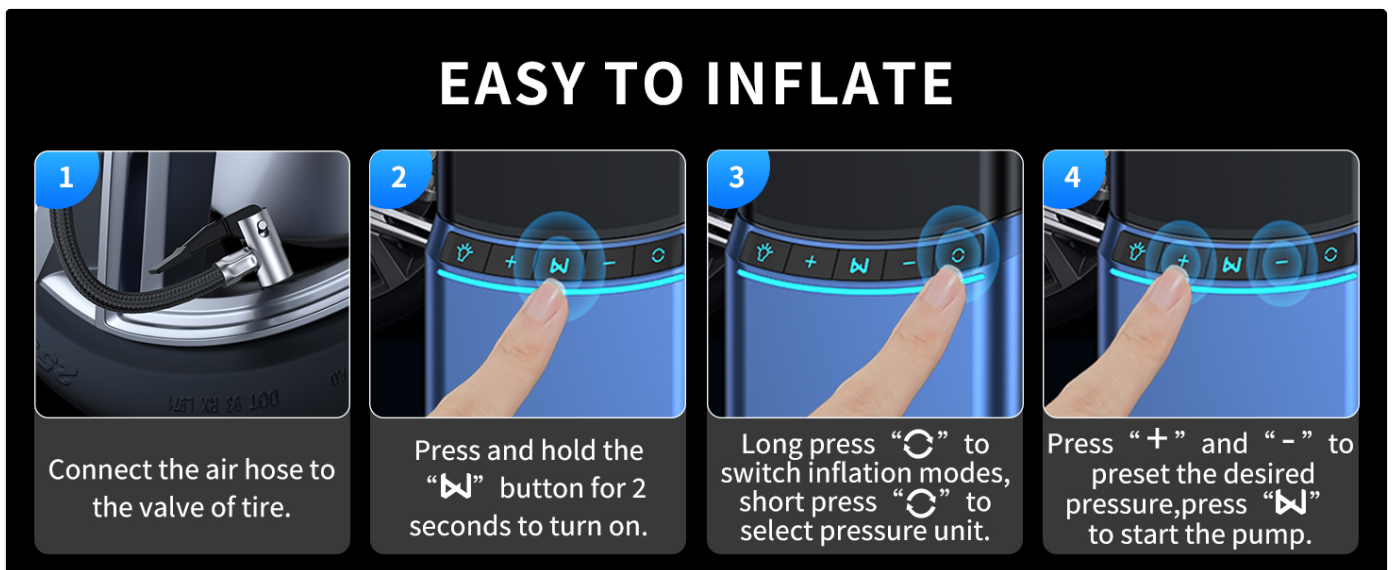

Shows the four different inflation modes (car, motorcycle, bicycle, ball) supported by the BUVAYE BN03, along with the corresponding nozzle adapters.

Using as a Power Bank

The BUVAYE BN03 can serve as a portable power bank to charge your electronic devices.

- Connect your device's charging cable to the USB-A output port on the jump starter.
- The jump starter will automatically begin charging your device.

WORK IN EXTREME WEATHER



The BUVAYE BN03 connected via USB-C to charge a smartphone, demonstrating its power bank functionality.

Using the LED Light

The built-in LED light offers three modes for various emergency or outdoor situations.

- Press the LED flashlight switch button once for constant illumination (Flashlight mode).
- Press it again to activate the SOS signal mode.
- Press it a third time for Strobe mode.
- Press it a fourth time to turn off the light.



The BUVAYE BN03's LED light illuminating a car tire at night, demonstrating its utility for nighttime emergencies and its various light modes.

MAINTENANCE

- **Regular Charging:** To maintain battery health and ensure readiness, charge the jump starter every two months, especially if not used for a long time.
- **Temperature Management:** If the product becomes very hot during use (e.g., during prolonged tire inflation), allow it to cool down for at least 10 minutes before continuing operation.
- **Storage:** Store the device in a cool, dry place. Avoid leaving it in extreme temperatures (very hot or very cold environments) for extended periods, as this can negatively impact the lithium battery's lifespan and performance.

- **Cleaning:** Use a soft, dry cloth to clean the device. Do not use harsh chemicals or abrasive cleaners.

TROUBLESHOOTING

Problem	Possible Cause	Solution
Device does not turn on.	Battery is completely discharged.	Charge the jump starter fully using the USB-C cable.
Vehicle does not jump start.	Incorrect clamp connection; Jump starter battery too low; Vehicle battery severely damaged.	Ensure clamps are connected correctly (red to +, black to -). Check jump starter battery level (should be >50%). Consult a mechanic if vehicle battery is faulty.
Air compressor does not inflate or stops prematurely.	Hose not securely connected; Preset pressure reached; Device overheating.	Ensure air hose is tightly screwed on to the valve. Check preset pressure. Allow device to cool down if hot.
LCD display is not working or flickering.	Low battery; Internal malfunction.	Charge the device. If problem persists, contact customer support.
Device gets hot during inflation.	Normal operation during prolonged use.	This is normal. Allow the device to cool for 10 minutes if it becomes very hot before continuing.

SPECIFICATIONS

Feature	Detail
Brand	BUVAYE
Model	BN03
Peak Output Current	4000 Amps
Applicable Engine Type	All Gas (up to 10L), All Diesel (up to 5L)
Air Compressor Pressure	Up to 150 PSI (35L/Min)
Battery Type	Lithium Ion (4 batteries included)
Operating Temperature	-4°F to 140°F (-20°C to 60°C)
Dimensions (L x W x H)	6.9 x 1.9 x 3.7 inches (17.5 x 4.8 x 9.4 cm)
Item Weight	2.75 pounds
Safety Protections	Over-charge, Over-current, Short-circuit, Reverse-polarity, Low-temp, High-temp, Over-voltage, Over-load, Spark-proof, Reverse-charge







Detailed dimensions of the BUVAE BN03 Car Jump Starter, showing its length, width, and height in both inches and centimeters.

WARRANTY AND SUPPORT

BUVAE offers a **1-year product quality maintenance** period and **lifetime technical support** for the BN03 Car Jump Starter. For any questions, concerns, or technical assistance, please feel free to contact BUVAE customer support. Refer to the contact information provided in the product packaging or on the official BUVAE website.

Related Documents - BN03

	<p>BN03 Jump Starter with Air Compressor User Manual</p> <p>User manual for the BN03 Jump Starter with Air Compressor, providing detailed instructions on product overview, package contents, technical specifications, operation for jump starting and tire inflation, lighting, charging, troubleshooting, safety precautions, and FAQs.</p>
	<p>Yuyao Yuanxin Vehicle Equipment Co., LTD. - Product Manual and Specifications</p> <p>Comprehensive product manual detailing various vehicle equipment from Yuyao Yuanxin Vehicle Equipment Co., LTD., including air pumps, emergency power supplies, and car chargers. Features product specifications, model details, and company information.</p>
	<p>AZDOME BN03 Owner's Manual - Installation, Features, and Settings</p> <p>Comprehensive owner's manual for the AZDOME BN03 dashcam. Learn about installation, product features, app connectivity, dashcam settings, firmware updates, GPS player, and warranty information.</p>
	<p>AZDOME Dashcam Product Catalog: Barrel, Budget, High-End, Mirror, and 4G Series</p> <p>Explore the comprehensive range of AZDOME dashcams, including 4K, 2K, and 1080P models across Barrel, Budget, High-End, Mirror, and 4G series, featuring GPS, Wi-Fi, advanced sensors, and various recording capabilities for enhanced vehicle security.</p>

