

## Manuals+

[Q & A](#) | [Deep Search](#) | [Upload](#)

manuals.plus /

› [BOMGIE](#) /

› [BOMGIE 1.6HP Shallow Well Garden Pump Instruction Manual](#)

**BOMGIE B0CL5SN83K**

# BOMGIE 1.6HP Shallow Well Garden Pump Instruction Manual

Model: B0CL5SN83K

## INTRODUCTION

---

This manual provides essential information for the safe and efficient operation, installation, and maintenance of your BOMGIE 1.6HP Shallow Well Garden Pump. Please read these instructions carefully before use and retain them for future reference. The BOMGIE 1.6HP Shallow Well Garden Pump is designed for various water transfer applications, including garden irrigation, lawn watering, and boosting water pressure for domestic use. It features a high-performance motor capable of delivering up to 1600 gallons of water per hour with a maximum discharge head height of 164 feet.



Image: The BOMGIE 1.6HP Shallow Well Garden Pump, a robust cast iron unit with a blue motor housing and black pump head.

## SAFETY INFORMATION

Always observe basic safety precautions to reduce the risk of fire, electric shock, and personal injury. This pump is designed for pumping clean water only. Do not use it for flammable liquids, corrosive chemicals, or saltwater.

- **Electrical Safety:** Ensure the power supply matches the pump's voltage (115V AC). Always connect to a grounded outlet. Do not operate the pump with a damaged power cord or plug. Avoid operating the pump in standing water.
- **Personal Safety:** Wear appropriate personal protective equipment. Keep children and unauthorized persons away from the pump during operation.
- **Installation:** Securely install the pump on a stable, level surface. Ensure all connections are tight to prevent leaks.
- **Overheating Protection:** The pump is equipped with overheating protection. If the pump stops unexpectedly, allow it to cool down before attempting to restart.
- **Maintenance:** Disconnect power before performing any maintenance or cleaning.

## PACKAGE CONTENTS

---

Verify that all items are present and undamaged upon unpacking:

- BOMGIE 1.6HP Shallow Well Garden Pump (Cast Iron Pump)
- Two 3/4" Adapters
- Two O-ring Rubber Seals
- One Roll of 10 meters (32.8ft) Teflon Tape

## SPECIFICATIONS

---

Feature	Specification
Brand	BOMGIE
Model	B0CL5SN83K (1.6HP)
Material	Cast Iron
Power Source	AC
Voltage	115 Volts (AC)
Wattage	1200 watts
Current	10.5A
Maximum Flow Rate	26.67 Gallons Per Minute (1600 GPH)
Maximum Lifting Height (Head Lift)	164 Feet
Maximum Suction Lift	26.2 Feet
Inlet/Outlet Diameter	NPT 1"
Product Dimensions (L x W x H)	15" x 8.93" x 8.58"
Item Weight	12.95 Kilograms (28.5 pounds)
Cable Length	6.6 Feet

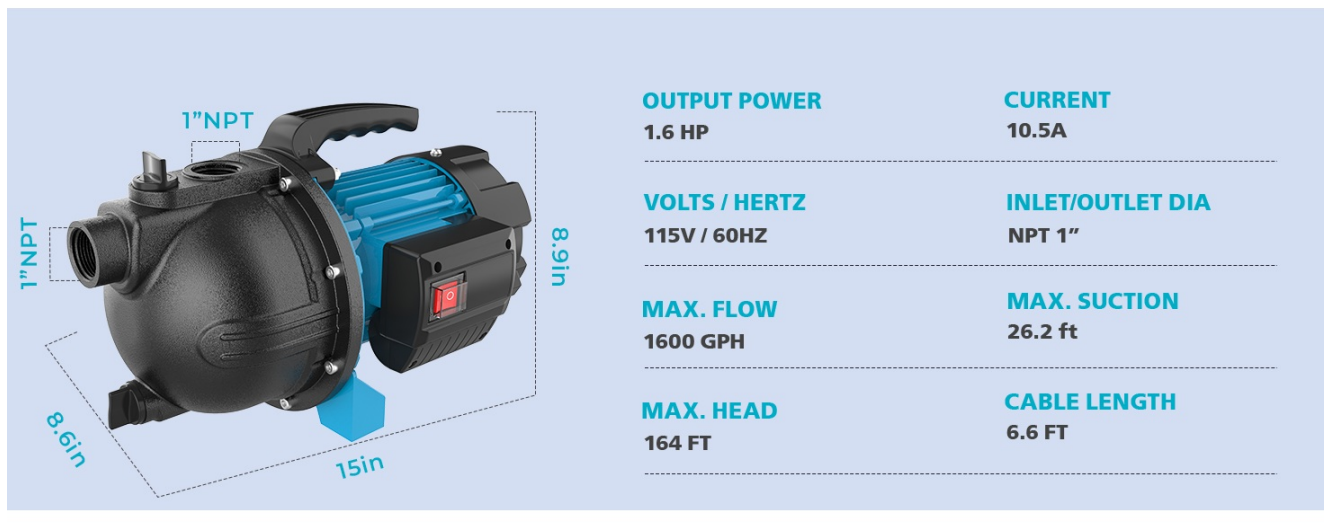

Image: Diagram illustrating the dimensions of the BOMGIE 1.6HP Shallow Well Garden Pump and key specifications.



Image: Performance chart showing the pump's flow rate (GPH/GPM) at various head lifts, with a maximum head lift of 164 ft and max suction of 26.2 ft.

## SETUP

The BOMGIE 1.6HP Shallow Well Garden Pump is designed for easy installation. Follow these steps for proper setup:

- Placement:** Position the pump on a stable, level surface near your water source and desired discharge point. The pump is portable and equipped with a handle for easy carrying.
- Inlet Connection:** Connect the inlet hose to the pump's inlet port (1" NPT). Ensure a foot valve is installed at the end of the suction hose if drawing water from a well or tank to prevent backflow and maintain prime. Use the provided Teflon tape on threaded connections to ensure a watertight seal.
- Outlet Connection:** Connect the discharge hose to the pump's outlet port (1" NPT). Use the provided 3/4" adapters and O-ring rubber seals if needed for your hose size, along with Teflon tape for secure connections.
- Priming the Pump:** Before the first use, or if the pump has run dry, it must be primed. Remove the prime plug (usually located on top of the pump head) and fill the pump head with clean water until it is full. Replace the prime plug securely.

**TIPS :** To prime shallow well pumps, remove the prime plug and fill with water until it's full.

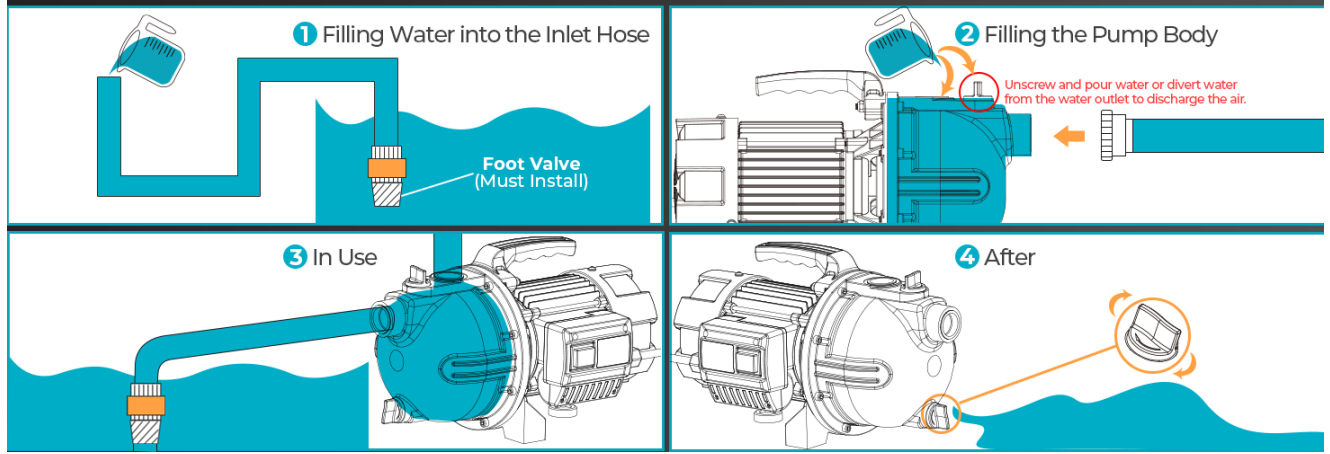

Image: Illustration of two inlet connection methods: direct connection to a water tap and self-priming from a water source using a foot valve.



Image: Step-by-step guide on how to prime the shallow well pump, including filling the inlet hose and the pump body.

## OPERATING INSTRUCTIONS

Once the pump is properly set up and primed, you can begin operation:

1. **Power Connection:** Plug the pump into a standard 115V AC grounded electrical outlet.
2. **Start the Pump:** Flip the power switch to the 'ON' position. The pump should start immediately.
3. **Monitor Operation:** Observe the pump for any unusual noises or leaks. Ensure water is flowing as expected.
4. **Stop the Pump:** To turn off the pump, flip the power switch to the 'OFF' position.
5. **Applications:** This pump is suitable for various applications including lawn sprinkling, garden watering, farm irrigation, and boosting domestic water pressure.

## BOMGIE Pump



## Other Brand



**With Handle**



**High Water Pressure**



**Cast Iron Head**



**2-Year Guarantee**



**Without Handle**



**Low Water Pressure**



**Fragile Materials**



**No Guarantee**



*Image: Collage showing various applications of the BOMGIE pump, including lawn sprinkling, garden watering, farm irrigation, and domestic water supply.*

## MAINTENANCE

Regular maintenance ensures the longevity and optimal performance of your BOMGIE pump. Always disconnect the power supply before performing any maintenance.

- **Cleaning:** Periodically clean the exterior of the pump to prevent dirt and debris buildup.
- **Check Connections:** Regularly inspect all hose connections for tightness and signs of wear or leaks. Replace O-rings and Teflon tape as needed.
- **Anti-Rust Treatment:** The cast iron construction includes anti-rust treatment for durability. However, avoid prolonged exposure to harsh weather conditions to maximize lifespan.
- **Winterization:** In freezing temperatures, drain all water from the pump and hoses to prevent damage from ice expansion. Store the pump in a dry, frost-free location.



## CAST IRON MATERIAL

Constructed with cast iron materials, our garden well pump offers unmatched durability and longevity.

It is resistant to wear-and-tear, corrosion, and other environmental factors ensuring a long-lasting investment in your home.



*Image: Exploded view of the pump components, highlighting features like cast iron pump head, impeller, power box, anti-rust treatment, overheating protection, and portable design.*

## TROUBLESHOOTING

If you encounter issues with your pump, refer to the following common problems and solutions:

Problem	Possible Cause	Solution
Pump does not start	No power, tripped circuit breaker, motor overheated	Check power connection and circuit breaker. Allow motor to cool if overheated.
Pump runs but no water flows	Pump not primed, air leak in suction line, clogged inlet/outlet	Re-prime the pump. Check all suction line connections for leaks. Clear any blockages.
Low water pressure/flow	Partial clog, air in system, worn impeller, insufficient power	Check for partial clogs. Ensure pump is fully primed. Inspect impeller for damage. Verify power supply.
Pump leaks water	Loose connections, damaged seals/O-rings	Tighten all connections. Replace damaged seals or O-rings.

If the problem persists after attempting these solutions, please contact BOMGIE customer service for assistance.

## WARRANTY AND SUPPORT

BOMGIE provides a **2-Year Guarantee** for this product, ensuring quality and performance. We are committed to providing professional after-sales maintenance service.

If you have any questions, concerns, or require technical assistance, please do not hesitate to contact BOMGIE customer service. Our team is ready to provide a satisfactory resolution.

For support, please visit the BOMGIE store on Amazon or refer to the contact information provided with your purchase documentation.