

## Tilta TA-T59-FCC-B

# Tilta Full Camera Cage for Canon R7 User Manual

Model: TA-T59-FCC-B

## 1. PRODUCT OVERVIEW

The Tilta Full Camera Cage is custom-designed for the Canon R7 camera body, providing enhanced protection and versatile mounting options for various accessories. Constructed from durable aluminum, this cage integrates seamlessly with the camera's form factor while maintaining access to all essential controls and ports.

Key features include multiple 1/4"-20 threads with locating points, cold shoe mounts, and a NATO rail for attaching accessories such as monitors, microphones, and LED lights. The integrated Arca-Swiss compatible bottom plate allows for quick transitions between tripods and gimbals, including compatibility with DJI RS3 Pro. A dedicated cable clamp secures HDMI and USB-C cables, ensuring stable data transmission. For convenience, a multi-tool with an M3 Allen key and flat head screwdriver is magnetically integrated into the bottom plate.



Figure 1.1: Tilta Full Camera Cage installed on a Canon R7 camera, viewed from the side, highlighting the robust construction and accessory attachment points.



Figure 1.2: Rear view of the cage on the Canon R7, demonstrating clear access to the camera's rear screen and operational buttons.



Figure 1.3: Front view of the cage on the Canon R7, illustrating how the cage frames the camera body without obstructing the lens.

## 2. WHAT'S IN THE BOX

Verify that all components are present in your package:

- 1 x Full Camera Cage for Canon R7 – Black
- 1 x EF-R Mount Adapter Support for Canon R8 – Black (Note: This component is included but primarily for R8 compatibility; it may not be directly used with the R7 cage.)
- 1 x Micro HDMI and USB-C Cable Clamp for Canon R7 – Black
- 1 x Slotted and Allen Key (Multi-tool)

## 3. SETUP GUIDE

### 3.1 Attaching the Camera Cage

1. Ensure your Canon R7 camera is powered off and any lens or accessories are removed.
2. Align the camera with the cage, ensuring the 1/4"-20 mounting screw on the bottom of the cage aligns with the camera's tripod socket.
3. Secure the camera to the cage using the integrated 1/4"-20 screw. Use the magnetically attached

multi-tool (slotted screwdriver end) located on the bottom of the cage to tighten the screw firmly.

4. For additional security, align the two side strap anchor points on the camera with the corresponding pins on the cage. This provides a three-point attachment for maximum stability.



Figure 3.1: Detailed view of the cage's mounting points and camera attachment mechanism.

## 3.2 Attaching the Cable Clamp

1. Locate the Micro HDMI and USB-C Cable Clamp.
2. Attach the clamp to the side of the cage near the camera's HDMI and USB-C ports using the provided thumb screws.
3. Route your HDMI and USB-C cables through the clamp and tighten the thumb screws to secure them. This prevents accidental disconnections and protects the camera's ports.



Figure 3.2: The cable clamp in use, securing connected cables to the cage.

# 4. OPERATING THE CAGE

## 4.1 Accessory Mounting

The cage offers multiple attachment points for various camera accessories:

- **1/4"-20 Threads with Locating Points:** Use these threads to attach articulating arms, external monitors, LED lights, and other accessories that require anti-twist security.
- **Cold Shoe Receivers:** Located on the top of the cage, these are ideal for mounting microphones, small LED lights, or wireless receivers.
- **NATO Rail:** The integrated NATO rail on the side allows for quick attachment and detachment of NATO-compatible handles or other accessories.



Figure 4.1: The cage with an optional top handle attached, showcasing its modularity.

## 4.2 Arca-Swiss Compatibility

The bottom plate of the cage is Arca-Swiss compatible, allowing for direct mounting onto Arca-Swiss tripod heads and gimbals, including the DJI RS3 Pro. This feature enables rapid transitions between handheld, tripod, and gimbal setups without needing to remove the cage or attach additional quick release plates.



Figure 4.2: Close-up of the Arca-Swiss compatible base plate for quick mounting.

## 4.3 Integrated Multi-Tool

A multi-tool, comprising an M3 Allen key and a flat head screwdriver, is magnetically stored in the bottom of the cage. This tool is essential for tightening the camera mounting screw and other cage components, ensuring it is always accessible when needed.



Figure 4.3: The multi-tool conveniently stored within the cage's design.

## 5. MAINTENANCE

To ensure the longevity and optimal performance of your Tilta Full Camera Cage, follow these maintenance guidelines:

- **Cleaning:** Wipe the cage regularly with a soft, dry cloth to remove dust and fingerprints. For stubborn dirt, a slightly damp cloth can be used, followed by immediate drying. Avoid abrasive cleaners or solvents.
- **Inspection:** Periodically check all screws and mounting points for tightness. Re-tighten any loose connections using the integrated multi-tool.
- **Storage:** Store the cage in a dry, clean environment when not in use. If storing with the camera, ensure the camera is powered off and protected.

## 6. TROUBLESHOOTING

### 6.1 Difficulty Accessing Record Button

Some users may find the camera's record button slightly less accessible due to the cage's design. This is a minor ergonomic consideration due to the protective nature of the cage.

- **Solution:** Adapt your grip slightly to reach the button. Alternatively, consider remapping a more easily accessible button on your Canon R7 to function as the record button if your camera firmware allows.

### 6.2 Loose Accessories

If accessories mounted to the cage feel loose or wobbly:

- **Solution:** Ensure all screws and clamps securing the accessories are fully tightened. Utilize the locating pins on 1/4"-20 threads where available to prevent rotation.

## 7. SPECIFICATIONS

Attribute	Value
Product Dimensions	9 x 6 x 3.5 inches
Item Weight	9.6 ounces
ASIN	B0CL5LR3W7
Item Model Number	TA-T59-FCC-B
Manufacturer	Tilta
Country of Origin	China
Brand	Tilta
Mounting Type	Cold Shoe Mount
Color	Black
Material	Aluminum
UPC	810076278681

## 8. WARRANTY AND SUPPORT

Tilta products are manufactured to high-quality standards. For information regarding warranty coverage and terms, please refer to the official Tilta website or contact their customer support directly.

For technical assistance, product inquiries, or support, please visit the [Tilta Store on Amazon](#) or their official website.

### Related Documents - TA-T59-FCC-B



#### [Tilta Camera Cage System for Sony a7 IV: Installation and Features](#)

Comprehensive guide to the Tilta camera cage system for the Sony a7 IV, detailing installation, features, and accessory compatibility. Includes all components and assembly steps.





[Tilta Camera Cage for Sony A7C: Assembly and Installation Guide](#)

Comprehensive guide to assembling and installing the Tilta camera cage and accessories for the Sony A7C camera. Includes detailed instructions for attaching top handles, side handles, wooden handles, and baseplates.

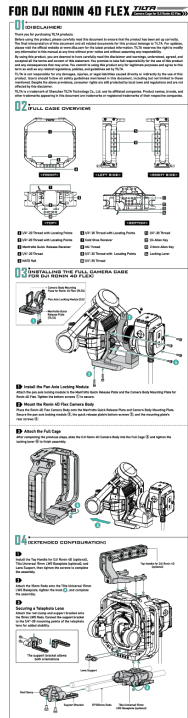

[DJI Ronin 4D Flex Camera Cage Installation and Configuration Guide](#)

A comprehensive guide to installing and configuring the Tilta Camera Cage for the DJI Ronin 4D Flex, including component overviews and extended setup options.

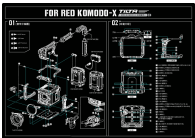

[Tilta Camera Cage for RED KOMODO-X: Overview and Functions](#)

Comprehensive guide detailing the Tilta camera cage system for the RED KOMODO-X, including an overview of its components and a detailed breakdown of its functional features and mounting points.



[GOLREX T59 True Wireless Earbuds User Manual](#)

Comprehensive user manual for the GOLREX T59 True Wireless Earbuds, covering package contents, product overview, pairing, wearing instructions, charging, button operations, maintenance, and troubleshooting.





### [Tilta Rig Side Handle and Follow Focus Side Handle: User Guide and Specifications](#)

Comprehensive guide to the Tilta Rig Side Handle and Follow Focus Side Handle, detailing features, instructions, calibration, power outputs, and available adaptors for professional camera setups.

Documents - Tilta – TA-T59-FCC-B



### [Tilta MILC Tactical Kit Series Camera Cages](#)

Explore the Tilta MILC Tactical Kit Series, featuring a comprehensive range of camera cages and accessories for Canon, Sony, Lumix, Red, Fujifilm, Nikon, and DJI cameras. Discover high-quality, precision-engineered gear designed to enhance your filmmaking experience.

lang:i-klngon **score:25** filesize: 51.54 M page\_count: 69 document date: 2024-04-02