

ARCCAPTAIN MIG200 & Spool Gun

ARCCAPTAIN MIG Welder 200Amp User Manual

MODEL: MIG200 & SPOOL GUN

1. SAFETY INFORMATION

Always prioritize safety when operating welding equipment. Failure to follow safety guidelines can result in serious injury or death.

General Safety Precautions:

- **Personal Protective Equipment (PPE):** Always wear appropriate welding helmet, gloves, protective clothing, and safety shoes.
- **Ventilation:** Ensure adequate ventilation to remove welding fumes and gases. Work in a well-ventilated area or use local exhaust ventilation.
- **Fire Hazards:** Keep flammable materials away from the welding area. Have a fire extinguisher readily available.
- **Electrical Safety:** Ensure proper grounding and inspect cables for damage before each use. Do not operate in wet conditions.
- **Arc Rays:** Protect eyes and skin from arc rays, which can cause burns and eye damage.

Integrated Safety Features:

The ARCCAPTAIN MIG200 is equipped with multiple safety features to enhance user protection:

- **VRD (Voltage Reduction Device):** Reduces open-circuit voltage for increased safety.
- **Over Voltage Protection:** Automatically shuts down the machine if input voltage exceeds safe limits.
- **Over Current Protection:** Prevents damage from excessive current draw.
- **Over Load Protection:** Protects the machine from overheating due to prolonged heavy use.
- **Overheating Protection:** Activates the cooling fan only when needed, and shuts down if internal temperature becomes too high.

SAFETY & RELIABLE



VRD



Over
Voltage



Over Current
Protection



Over Load
Protection



Overheating
Protection



LED in Wire Feed Bin



Fan On Demand

Figure 1: Internal components and safety features of the ARCCAPTAIN MIG200 welder.

2. PRODUCT OVERVIEW

The ARCCAPTAIN MIG200 is a versatile 6-in-1 multi-process welding machine designed for various welding requirements, from hobbyist to professional use. It supports multiple welding modes and comes with a dedicated spool gun for aluminum welding.

Key Features:

- **Multi-Process Capabilities:** Gas/Solid Wire MIG (GMAW), Gasless Flux Core MIG (FCAW), Stick/MMA, Spot welding, Lift TIG (TIG gun not included), and Spool Gun connector (spool gun included, TIG gun not included).
- **Wire Compatibility:** Supports .023"/.030"/.035" solid wire, .023"/.030"/.035" flux core wire, and .035"/.045" aluminum wire.
- **Synergic MIG:** Digital control automatically matches recommended current and wire feeding speed based on selected wire diameter and gas material. Manual adjustment is also possible.
- **Advanced Functions:** Includes adaptive crater, burn-back adjustment, and pre-flow/post-flow for improved welding efficiency.
- **2T/4T Welding Modes:** Offers two welding trigger modes for different application needs.
- **Preset Settings:** Ability to store up to 10 groups of parameter data for each welding mode for convenient recall.
- **Cooling System:** Features a 'Fan on Demand' system, where the cooling fan operates only when necessary, reducing noise.

6 IN 1 MULTI-FUNCTION WELDING MACHINE



Figure 2: Visual representation of the 6-in-1 multi-function welding machine.

Spool Gun Features:

- **Smooth Wire Feeding:** Designed for consistent and uninterrupted aluminum welding.
- **Cable Length:** Equipped with a 10-foot (3m) cable for extended reach.
- **Visible Cover:** Transparent cover allows for easy visibility of the welding wire, ensuring cleanliness and preventing contamination.

- **Ergonomic Design:** Features a positive trigger and ergonomic design for comfortable handling.



Figure 3: The ARCCAPTAIN 150A Spool Gun.

VISIBLE & STAY CLEAN



Figure 4: Transparent cover and ergonomic design of the spool gun.

3. SETUP

Before operating the ARCCAPTAIN MIG200, ensure all connections are secure and correct.

3.1 Power Connection:

The MIG200 welder is compatible with both 220V and 110V power sources. Use the appropriate adapter cable provided for your power outlet.

3.2 Gas Line Connection:

For Gas MIG (GMAW) or Lift TIG welding, connect your shielding gas cylinder to the machine using the provided gas line cable. Ensure all connections are tight to prevent leaks.

3.3 Welding Cable Connections:

Connect the appropriate welding cables (MIG torch, Stick electrode holder, Ground clamp) to their respective ports on the front panel of the welder. Ensure a secure connection for optimal performance and safety.



Figure 5: ARCCAPTAIN MIG200 welder and its accessories, including various cables.

3.4 Spool Gun Installation:

Follow these steps to install the welding wire in the spool gun:

1. **Open the Lid:** Carefully open the transparent cover lid of the spool gun.
2. **Install the Welding Wire:** Place the welding wire spool into the designated compartment, ensuring it is seated correctly.
3. **Install Wire Feed Drive Roller:** Position the wire feed drive roller and tighten the nut to secure it. Ensure the wire feeds smoothly through the guide.

SOLID CONSTRUCTION EASY TO INSTALL

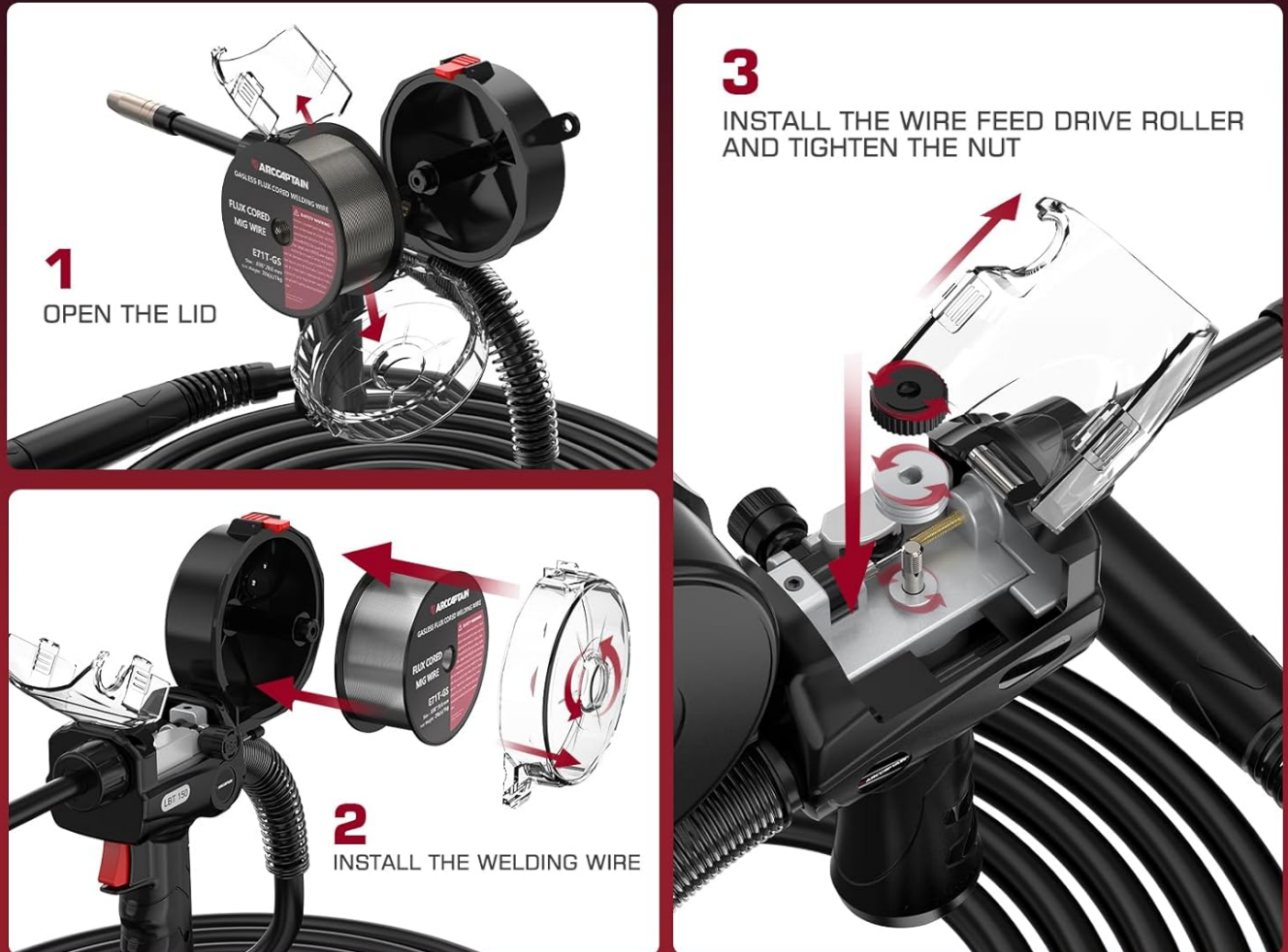

Figure 6: Detailed steps for installing welding wire in the spool gun.

4. OPERATING INSTRUCTIONS

The ARCCAPTAIN MIG200 is designed for ease of use, even for beginners, thanks to its intelligent control system.

4.1 Synergic Control:

Select the diameter of your welding wire and the type of gas material on the machine's digital interface. The synergic control will automatically recommend the optimal current and wire feeding speed. You can fine-tune these settings manually to suit your specific welding habits or project requirements.

4.2 Multi-functional Operation:

Utilize the various welding modes (MIG, Flux Core MIG, Stick/MMA, Spot, Lift TIG) by selecting them on the control panel. The machine's internal electronics are designed to recognize the connected accessories and adjust settings accordingly, providing a broad operational range.

4.3 2T/4T Modes:

Switch between 2T (two-touch) and 4T (four-touch) trigger modes based on your welding preference. 2T is suitable for short welds, while 4T allows for continuous welding without holding the trigger, ideal for longer passes.

4.4 Saving and Recalling Presets:

The machine allows you to save up to 10 sets of customized parameter data for each welding mode. This feature is convenient for quickly switching between frequently used settings for different materials or joint types.

5. MAINTENANCE

Regular maintenance ensures the longevity and optimal performance of your ARCCAPTAIN MIG200 welder and spool gun.

- **Keep Wire Clean:** Utilize the transparent cover on the spool gun to keep the welding wire free from contaminants, which can affect weld quality.
- **Cooling Fan:** The 'Fan on Demand' system helps maintain optimal operating temperature. Ensure the air vents are clear of obstructions to allow proper airflow.
- **Cable Inspection:** Regularly inspect all cables (power, welding, gas) for any signs of wear, cuts, or damage. Replace damaged cables immediately. The spool gun cable is designed to be sturdy and durable to prevent breaking during movement.
- **General Cleaning:** Keep the machine and accessories clean and free of dust, debris, and spatter.

STURDY & DURABLE

keep the cable from breaking when moving back and forth



Figure 7: Sturdy and durable design of the spool gun cable.

6. TROUBLESHOOTING

While the ARCCAPTAIN MIG200 is designed for intuitive operation, here are some common issues and their potential solutions:

Problem	Possible Cause	Solution
No Power	Power cable disconnected, circuit breaker tripped, machine fault.	Check power connections, reset breaker, contact support if fault persists.
Wire Sticking (Stick Welding)	Insufficient current, improper electrode angle.	Increase current setting, adjust electrode angle. The machine's intelligence should minimize this.
Poor Weld Quality	Incorrect settings, contaminated material, improper technique.	Verify synergic settings or adjust manually, clean workpiece, review welding technique.

Problem	Possible Cause	Solution
Wire Feed Issues (MIG/Spool Gun)	Tangled wire, clogged liner, incorrect drive roller tension.	Check wire spool, clean liner, adjust drive roller tension.
Overheat Indicator On	Prolonged use, blocked vents.	Allow machine to cool down, ensure vents are clear.

7. SPECIFICATIONS

Key technical specifications for the ARCCAPTAIN MIG200 & Spool Gun:

Feature	Detail
Model	MIG200 & Spool Gun
Input Voltage Compatibility	110V / 220V (Dual Voltage)
Max Output Current (Welder)	200 Amp
Spool Gun Current Rating	150 Amp
Spool Gun Cable Length	10 feet (3m)
Wire Feed Type	Smooth Wire Feeding (Spool Gun)
Connection Type	Euro Connection
ASIN	B0CL4TDB5T
First Available Date	October 16, 2023

SIZE OF ACCESSORIES



Figure 8: Dimensions of various accessories included with the welder.

8. WARRANTY & SUPPORT

For warranty information, technical support, or service inquiries regarding your ARCCAPTAIN MIG200 welder and spool gun, please contact ARCCAPTAIN customer service directly. Refer to the product packaging or the official ARCCAPTAIN website for the most up-to-date contact details and warranty terms.

ARCCAPTAIN Official Store: [Visit the ARCCAPTAIN Store on Amazon](#)