

Manuals+

[Q & A](#) | [Deep Search](#) | [Upload](#)

manuals.plus /

- › [Koiiko](#) /
- › [Koiiko Q11A Phone Game Controller User Manual](#)

Koiiko Q11A

Koiiko Q11A Phone Game Controller User Manual

Model: Q11A

INTRODUCTION

This manual provides detailed instructions for the setup, operation, maintenance, and troubleshooting of your Koiiko Q11A Phone Game Controller. This versatile controller is designed for use across multiple platforms, including iOS, Android, PC, and Nintendo Switch, offering an enhanced gaming experience with features like dual motor vibration, 6-axis gyro, and turbo functionality.



Image: The Koiiko Q11A controller holding a smartphone, showcasing its design and compatibility with mobile gaming.

SETUP AND CONNECTION

Charging the Controller

Before initial use, fully charge the controller. The Koiiko Q11A features a 600 mAh rechargeable battery, providing over 18 hours of playtime on a full charge. Charging typically takes 2-3 hours.

- Connect the included USB Type-C cable to the controller's charging port and a compatible USB power source.
- The indicator light will show charging status and turn off when fully charged.



Image: Detailed view of the controller's charging port and battery specifications.

Connecting to Devices

Ensure the controller is switched off before initiating any connection process.



Image: A table illustrating various connection methods for different platforms.

1. iOS / Android / PC (Bluetooth Mode - X-input Key)

1. Press and hold the **Bluetooth Key** to boot the controller.
2. On your iOS/Android/PC device, turn on Bluetooth and select 'Xbox Wireless Controller' to pair.
3. The indicator light will remain on once connected.

2. Android (Pro Controller Mode)

1. For different games, press the '**N**' + '**S**' key to boot the controller.
2. On your Android device, turn on Bluetooth and select 'Pro Controller' to pair.

3. Nintendo Switch

1. Press the '**N**' + '**S**' key to boot the controller.
2. On your Switch console, navigate to 'Controllers' > 'Change Grip/Order'.
3. The controller will automatically connect, and the indicator light will remain on. (The 'N+S' key also functions as the HOME key).

4. PlayStation 3/4 (Wired Connection)

1. On your PS4 console, go to 'Settings' > 'Devices' > 'Controllers' > 'Communication Method' > 'Use USB Cable'. Turn off your original controller.
2. Connect the Type-C cable to the D6 controller and the USB interface of the PS4/PS5 console.
3. Press the **Bluetooth Key**, and the controller will automatically connect. The indicator light will remain on.

OPERATING INSTRUCTIONS

Button Layout and Description

KOIIKO D6 KEYS DESCRIPTION

PS Remote Play, Xbox Remote Play, Steam Link
work on Bluetooth mode (X-input Key)



Image: A detailed diagram labeling all buttons and their functions on the Koiiko D6 controller.

- **L3/R3:** Left/Right Joystick press.
- **Direction Keys:** D-pad for directional input.
- **Switch Mode:** Button to change connection modes.
- **V3 Mode:** Specific mode for certain functions or upgrades.
- **A/B/X/Y Keys:** Standard action buttons.
- **SELECT/START:** Menu and pause buttons.
- **TURBO:** Activates turbo function.
- **RB/LB:** Right/Left Bumper buttons.
- **RT/LT:** Right/Left Trigger buttons.

Turbo Combo Function

The controller features a Turbo function with manual and auto modes, and three adjustable speed levels. This allows for rapid, repeated button presses, providing a competitive advantage in games.

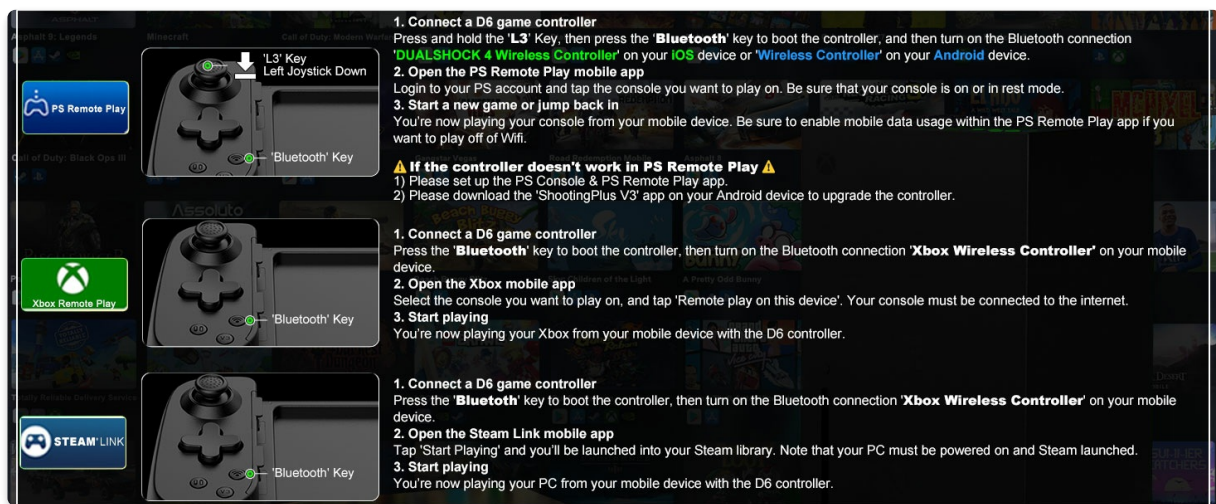

Image: Visual guide on how to set and release the Turbo function for specific buttons.

1. Press the **"T" button** + a function button (e.g., A button) to set the Turbo function.
2. Press and hold the function button (e.g., "A" button) to activate its automatic release function.
3. Pressing the **"A+T" button** again will cancel the automatic release function.

Dual Vibration & 6-Axis Gyro

Experience immersive gameplay with dual haptic feedback motors and sensitive six-axis gyroscopic sensors.

- **Dual Vibration:** Provides precise haptic feedback for a more realistic gaming experience. (Supported on PC, PS3, PS4, NS-Switch only).
- **6-Axis Gyro:** Offers high-precision body feel fine-tuning, assisting in FPS games for accurate aiming and in racing games for built-in steering control. (Supported on PC, PS3, PS4, NS-Switch only).

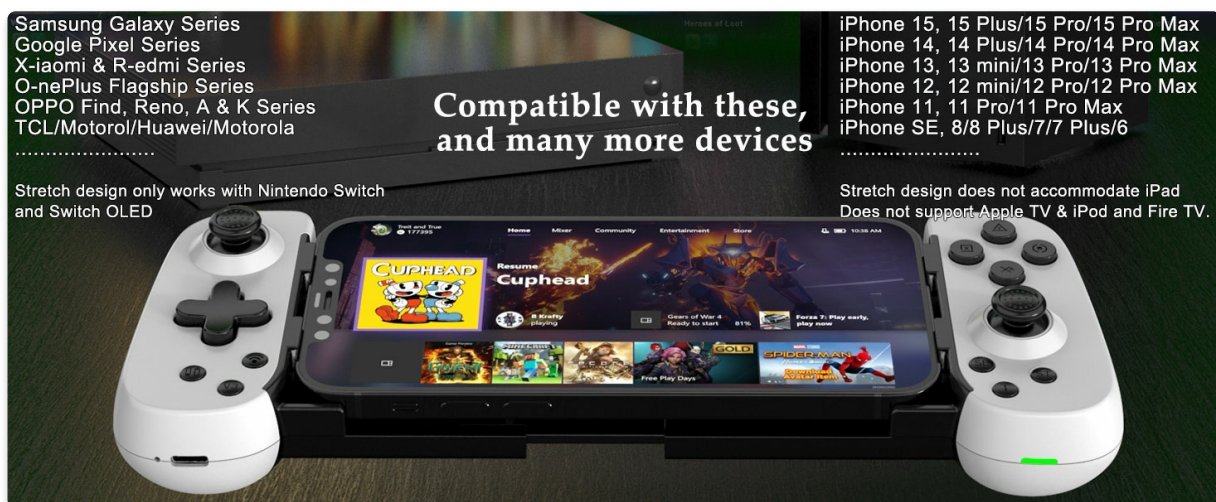

Image: Visual representation of the dual vibration functionality.

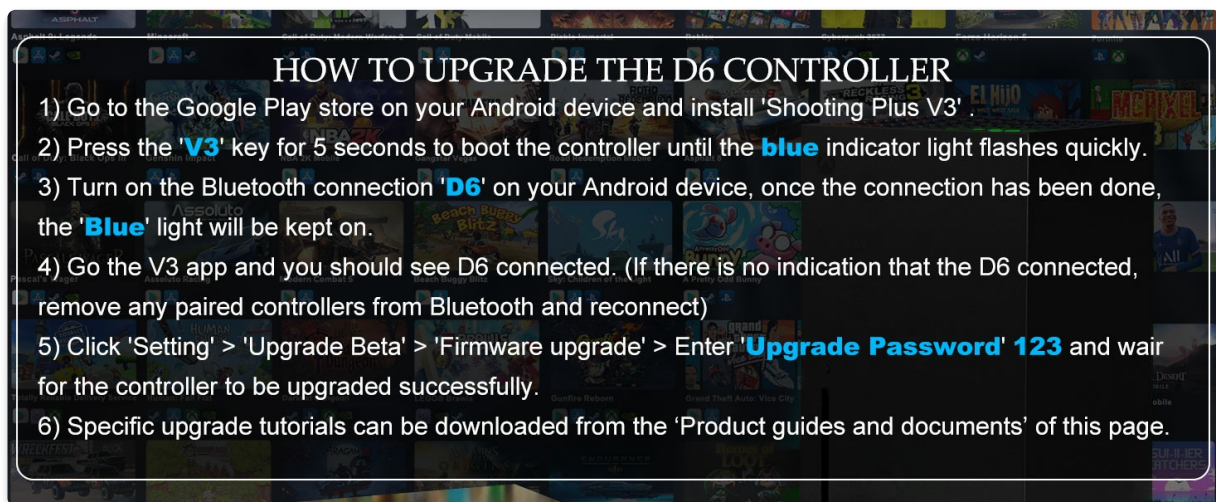

Image: Visual representation of the 6-axis gyro feature in action.

Cloud Gaming and Streaming

The Koiiko Q11A controller supports a wide range of cloud gaming services and console streaming options.

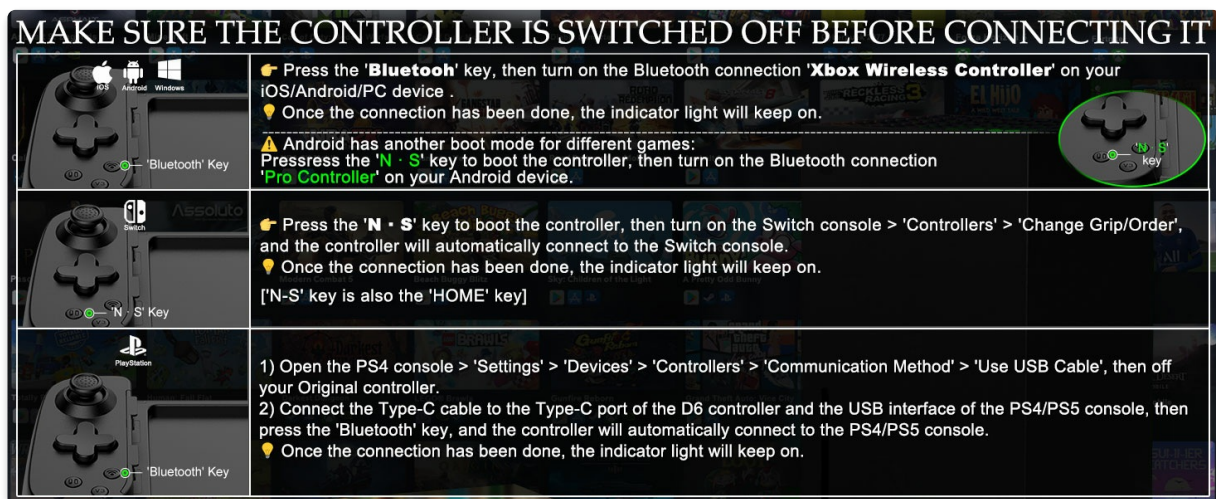

Image: An overview of the gaming platforms and services compatible with the controller.

- **Cloud Gaming:** Supports services like Nvidia GeForce Now, Xbox Cloud Gaming, Amazon Luna, Google Stadia, Rainway, and Moonlight on iOS/Android mobile or tablet devices.
- **Console Streaming:** Supports streaming from PS5/PS4, Xbox Series/Xbox One, and PC consoles. Download the respective remote play apps (PS Remote Play, Xbox Remote Play, Steam Link) on your phone/tablet to stream games.

Connecting for Remote Play / Steam Link



Image: Step-by-step instructions for connecting the controller to various remote play services.

- **PS Remote Play:** Connect the D6 controller by pressing and holding the '**L3**' Key, then the **Bluetooth Key**. Pair with 'DUALSHOCK 4 Wireless Controller' on iOS or 'Wireless Controller' on Android. Open the PS Remote Play app, log in, and start playing.
- **Xbox Remote Play:** Connect the D6 controller by pressing the **Bluetooth Key**. Pair with 'Xbox Wireless Controller'. Open the Xbox mobile app, select your console, and tap 'Remote play on this device'.
- **Steam Link:** Connect the D6 controller by pressing the **Bluetooth Key**. Pair with 'Xbox Wireless Controller'. Open the Steam Link mobile app, tap 'Start Playing'. Your PC must be powered on and Steam launched.

MAINTENANCE

Care and Storage

- Keep the controller clean by wiping it with a soft, dry cloth. Avoid using harsh chemicals or abrasive materials.
- Store the controller in a cool, dry place away from direct sunlight and extreme temperatures.
- Avoid dropping the controller or subjecting it to strong impacts.
- To preserve battery life, fully charge the controller before long periods of inactivity and recharge it periodically.

TROUBLESHOOTING

Connection Problems

- **Controller not pairing:** Ensure the controller is fully charged. Turn off and restart both the controller and your device's Bluetooth. Remove any previously paired controllers from your device's Bluetooth settings and try pairing again.
- **Buttons not responding:** Check if the controller is correctly paired and in the appropriate mode for your device/game. If issues persist, try resetting the controller using the reset button (often a small pinhole, refer to the 'Long Battery Life' image for location).
- **PS Remote Play issues:** If the controller does not work correctly with PS Remote Play, a firmware upgrade may be required.

Firmware Upgrade

To ensure optimal performance and compatibility, especially for PS Remote Play, you may need to upgrade the controller's firmware.



Image: Instructions for performing a firmware upgrade on the controller.

1. Go to the Google Play Store on your Android device and install the 'Shooting Plus V3' app.
2. Press the '**V3' key** for 5 seconds to boot the controller until the blue indicator light flashes quickly.
3. Turn on Bluetooth on your Android device and connect to 'D6'. Once connected, the blue light will remain on. (If no indication of connection, remove any paired controllers from Bluetooth and reconnect).
4. Open the V3 app; it should show D6 connected.
5. Click 'Setting' > 'Upgrade Beta' > 'Firmware upgrade' > Enter 'Upgrade Password'**123** and wait for the controller to be upgraded successfully.
6. Specific upgrade tutorials can also be downloaded from the 'Product guides and documents' section on the product page.

SPECIFICATIONS

Feature	Detail
Model Number	Q11A
ASIN	B0CKVRZYM6
Item Weight	8.1 ounces
Package Dimensions	8.58 x 3.94 x 1.93 inches
Battery	600 mAh (1 AAA battery included for initial use, rechargeable)
Manufacturer	ShenZhen ShanWan Technology Co., Ltd.
Date First Available	September 19, 2023



Image: A visual list of compatible smartphone and tablet models.

WARRANTY AND SUPPORT

Specific warranty information for the Koiiiko Q11A Phone Game Controller is not provided in the available product details. For warranty claims, technical support, or any product-related inquiries, please contact Koiiiko customer service directly through their official website or the retailer where the product was purchased.

Always refer to the latest information provided by the manufacturer for the most accurate and up-to-date support details.