

[Manuals.plus](#) /

› [REAKOSOUND](#) /

› REAKOSOUND Portable Car Stereo User Manual

REAKOSOUND PND009-FBA

REAKOSOUND Portable Car Stereo User Manual

Model: PND009-FBA

PRODUCT OVERVIEW

The REAKOSOUND Portable Car Stereo is a versatile in-car entertainment and navigation system designed to enhance your driving experience. Featuring a 7-inch HD touchscreen, it supports Apple CarPlay and Android Auto for seamless smartphone integration, mirror link functionality, and multiple audio output options. It also includes a backup camera for improved safety.



Image: The REAKOSOUND Portable Car Stereo unit with its 7-inch screen, sun visor, and various accessories including a suction cup mount, a dashboard mount, a backup camera, an external microphone, and connection cables.

PACKAGE CONTENTS

Please verify that all items listed below are included in your package:

- Portable Car Stereo Unit (7-inch screen)
- Suction Cup Bracket
- Dashboard Bracket
- Rear View Camera Cable
- Power Cable (Car Charger)
- AUX Cable
- User Manual

Package List Information



Image: A visual representation of the package contents, including the main unit with labeled ports (AUX hole, TF Card, Video input, Power), two types of brackets, rear view camera cable, power cable, AUX cable, and the user manual.

SETUP AND INSTALLATION

Follow these steps to properly set up and install your portable car stereo:

- 1. Prepare the Surface:** Wipe the car center console or dashboard area where you intend to mount the device with a clean rag to ensure it is free of dust and debris.
- 2. Install Supporting Accessories:** Attach the chosen mounting bracket (suction cup or dashboard) to the back of the stereo unit. Ensure it clicks securely into place.
- 3. Mounting:** Position the stereo unit with the attached bracket on your desired location on the dashboard or windshield.
- 4. Secure the Mount:** For dashboard mounting, apply the powerful adhesive patch to the bracket's base and firmly press it onto the dashboard. For suction cup mounting, press the suction cup firmly against the windshield or dashboard and engage the lever to create a vacuum seal.
- 5. Connect Power:** Plug the power cable into the stereo unit and then into your car's 12V power outlet (cigarette lighter socket).
- 6. Connect Rear View Camera (Optional):** If using the backup camera, connect its cable to the designated video input port on the stereo unit and install the camera at the rear of your vehicle according to its separate instructions.
- 7. Connect AUX Cable (Optional):** If you wish to output audio through your car's existing stereo system, connect the AUX cable from the portable stereo's AUX output to your car's AUX input.

7-32V Support Most Cars



Image: A five-step visual guide demonstrating the installation process: wiping the console, installing supporting accessories, attaching mounting brackets, pasting the patch to the bracket, and the successfully installed unit.

OPERATING INSTRUCTIONS

Apple CarPlay & Android Auto

Connect your smartphone wirelessly via Bluetooth to access Apple CarPlay or Android Auto. This allows for hands-free calls, navigation, music playback, messaging, and voice control (Siri/Google Assistant) directly from the stereo's 7-inch display, promoting a safer driving experience.

1. **Enable Bluetooth:** On your phone, go to Settings > Bluetooth and turn Bluetooth on.
2. **Pair with Machine:** On the car stereo, navigate to the Bluetooth settings and search for available devices. Select the stereo's Bluetooth name (e.g., "CAR BT-XXXX") on your phone.
3. **Confirm Pairing:** Confirm the pairing code displayed on both devices.
4. **Initiate CarPlay/Android Auto:** Once paired, the stereo will prompt you to use CarPlay or Android Auto. Select the appropriate option.
5. **Successful Connection:** The CarPlay or Android Auto interface will appear on the stereo screen, ready for use.

Wireless Carplay

1

Settings > Bluetooth > on



2

Please connect Bluetooth with the machine



3

Click the "pair" connection machine



4

Click "Use CarPlay" to connect to the machine



5

Successful connection and start using



Android Auto

1

Download and install "Android Auto" app from 'Google Play



2

Settings > Bluetooth > on

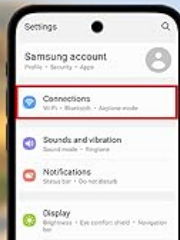

3

Please connect Bluetooth with the machine

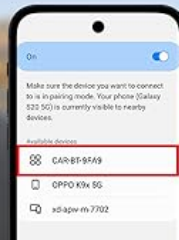

4

Click the "pair" connection machine

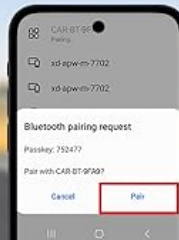

5

Successful connection and start using



Image: A detailed five-step visual guide showing the process of connecting a smartphone to the portable car stereo for both Wireless CarPlay and Android Auto via Bluetooth pairing.

Portable Carplay/Android Auto

Wireless Connection between phone and screen



Image: The portable car stereo displaying the Apple CarPlay interface, with a phone showing the CarPlay icon and another phone showing the Android Auto icon, illustrating wireless connectivity.

Mirror Link Function

The mirror link function allows you to project your smartphone's display onto the 7-inch screen of the car stereo wirelessly via Bluetooth. This is particularly useful for viewing videos or other content from your phone on a larger display. This feature is primarily designed for Apple Airplay.

IOS/Andorid Mirror Link



GPS Navigation



Image: The car stereo screen displaying a mirrored image from a smartphone, with smaller inset images showing separate iOS and Android phone screens, demonstrating the mirror link capability.

Voice Control & Bluetooth Music

Utilize voice commands through Siri or Google Assistant for hands-free operation, including making calls, playing music, and getting directions. The integrated Bluetooth function also allows for wireless music streaming from your phone.

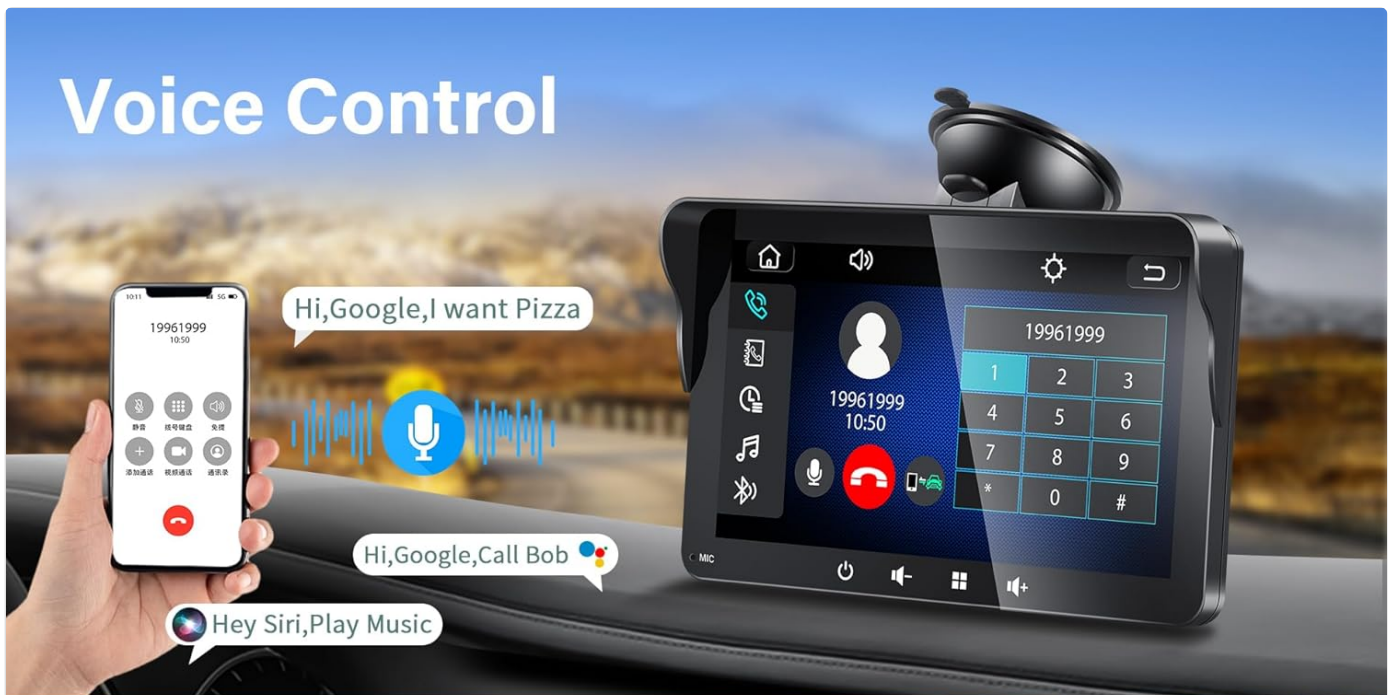

Image: The top panel shows a smartphone with a voice assistant interface and the car stereo displaying a call screen, indicating voice control functionality. The bottom panel shows the car stereo playing music via Bluetooth, with sound waves emanating from the device.

Audio Output Modes

The stereo offers three primary audio output modes:

- **FM Transmission:** Tune the portable stereo to an unused FM frequency, then set your car's radio to the same frequency to transmit audio wirelessly.
- **Built-in Speaker:** The unit has an integrated speaker for direct audio output.
- **AUX Connection:** Connect the provided AUX cable from the stereo to your car's AUX input jack for a wired audio connection to your car's sound system.

Three Audio Output Modes

FM Transmission



Built-in Speaker



AUX Connect to Car



Image: A four-panel image showing the three audio output modes: FM Transmission with frequency display, a diagram of the built-in speaker, a car dashboard showing FM radio, and the stereo connected via AUX cable to a car's audio system.

Reverse Camera Function

When connected, the included backup camera provides a clear, high-definition view of the area behind your vehicle on the 7-inch screen. It features a 170° viewing angle, is waterproof, and includes night vision capabilities for enhanced safety during parking and reversing maneuvers.

Reverse Camera

- HD**
High Definition
- 170°**
Viewing Angle
- Water Proof**
- Night Vision**



High Definition Touch Screen

- Touch Screen**
- HD**
HD screen
- Sensitive touch**



Image: The top panel shows the car stereo displaying the rear view from the backup camera, highlighting HD, 170° viewing angle, waterproof, and night vision features. The bottom panel shows a hand interacting with the touch screen displaying a navigation map, emphasizing the HD and sensitive touch capabilities.

Navigation

While the stereo does not have a built-in GPS, it provides navigation instructions through Apple CarPlay and Android Auto. Maps, directions, and real-time traffic information are displayed on the large 7-inch screen, utilizing your smartphone's GPS capabilities.

MAINTENANCE

To ensure the longevity and optimal performance of your REAKOSOUND Portable Car Stereo, follow these simple maintenance guidelines:

- **Cleaning the Screen:** Use a soft, lint-free cloth to gently wipe the touchscreen. For stubborn smudges, slightly dampen the cloth with water or a screen-cleaning solution. Avoid harsh chemicals or abrasive materials.
- **Cleaning the Unit:** Periodically wipe the body of the stereo and its mounts with a dry or slightly damp cloth to remove dust and dirt.

- **Cable Care:** Ensure all cables are not kinked or pinched. Store them neatly when not in use to prevent damage.
- **Temperature Exposure:** Avoid exposing the unit to extreme temperatures (very hot or very cold) for extended periods, as this can affect its electronic components.

TROUBLESHOOTING

If you encounter issues with your portable car stereo, refer to the following common problems and solutions:

Problem	Possible Cause	Solution
No Power	Power cable not properly connected; car's 12V outlet is faulty; car fuse blown.	Ensure power cable is securely plugged into both the stereo and the car's 12V outlet. Test the 12V outlet with another device. Check your car's fuse box for a blown fuse related to the 12V outlet.
Bluetooth Connection Issues	Bluetooth not enabled on phone/stereo; incorrect pairing process; interference.	Ensure Bluetooth is enabled on both devices. Delete previous pairings and try pairing again. Move closer to the stereo. Restart both the phone and the stereo.
No Audio Output / Poor Audio Quality	Incorrect audio output mode selected; volume too low; AUX cable faulty; FM interference.	Check if the correct audio output mode (FM, AUX, Built-in Speaker) is selected. Increase volume on both the stereo and your car's audio system. If using AUX, ensure the cable is fully inserted and not damaged. If using FM, try a different, clear FM frequency.
Touchscreen Unresponsive	Temporary software glitch; screen dirty.	Restart the stereo unit. Clean the screen with a soft, lint-free cloth.
Backup Camera Not Displaying	Camera cable loose or disconnected; camera faulty.	Check the connection of the backup camera cable to the stereo unit. Ensure the camera is properly installed and powered.

SPECIFICATIONS

Feature	Detail
Brand	REAKOSOUND
Model	PND009-FBA
Operating System	iOS, Android (via CarPlay/Android Auto)
Screen Size	7 Inches (18 cm visible diagonal)
Display Type	Touchscreen
Special Features	Touchscreen, Apple CarPlay, Android Auto, Mirror Link, Bluetooth, FM Transmitter, Built-in Speaker, Rear View Camera Support
Audio Output Mode	Stereo
Audio Output Type	Speakers (Built-in), AUX
Connectivity Technology	Auxiliary, Bluetooth
Human Interface Input	Touchscreen

Feature	Detail
---------	--------

Power Input	7-32V (Supports most cars)
Dimensions (Package)	23.1 x 14.2 x 10.5 cm
Weight (Package)	710 g

WARRANTY AND SUPPORT

REAKOSOUND is committed to providing quality products and customer satisfaction. While specific warranty details are not provided in this manual, please ensure all accessories are complete upon receiving your package. For any product inquiries, technical support, or warranty claims, please contact REAKOSOUND customer service through the retailer where you purchased the product.

For the most up-to-date support information, please refer to the official REAKOSOUND website or contact their customer support channels directly.