

SecuFirst B0CKLCMRKB

SecuFirst 2K Wireless Surveillance System User Manual

Model: B0CKLCMRKB

Brand: SecuFirst

1. INTRODUCTION

Welcome to the SecuFirst 2K Wireless Surveillance System user manual. This comprehensive guide provides detailed instructions for setting up, operating, and maintaining your new security system. The system includes a 7-inch touch screen monitor and four 2K (3MP) wireless outdoor cameras, designed for reliable surveillance without requiring an internet connection for basic operation.

This system is versatile and can be used as a baby video monitor, pet camera, entrance door surveillance, or for elderly care monitoring. It supports up to four cameras with multi-view display on the monitor.



Image: The SecuFirst 2K Wireless Surveillance System, showing the 7-inch monitor displaying a four-camera split view, and four white outdoor cameras.

2. PACKAGE CONTENTS

Please verify that all items listed below are included in your package.

- 1x 7-inch Touch Screen Monitor
- 4x Outdoor Cameras with Multi-position Brackets
- 5x 1.8M AC Power Adapters (1 for monitor, 4 for cameras)
- 4x 1.8M Power Extension Cables
- 1x Ethernet Cable
- 1x 64GB MicroSD Card (pre-installed in monitor)
- 1x Screws and Anchors Kit
- 1x Camera Mounting Hole Template
- 1x Quick Start Guide



Image: A 64GB MicroSD card, indicating included storage.

3. PRODUCT OVERVIEW

3.1. 7-inch Touch Screen Monitor



Image: Detailed diagram of the 7-inch touch screen monitor, highlighting its components such as the recording indicator, power indicator, monitor microphone, power button, antenna port, USB port, speaker, monitor stand, Ethernet port, SD card slot, power port, and reset button.

The monitor features a responsive touch screen interface, allowing for easy navigation and control. It includes a built-in microphone and speaker for two-way audio communication.

3.2. Wireless Outdoor Camera

7 pouces Moniteur à écran tactile

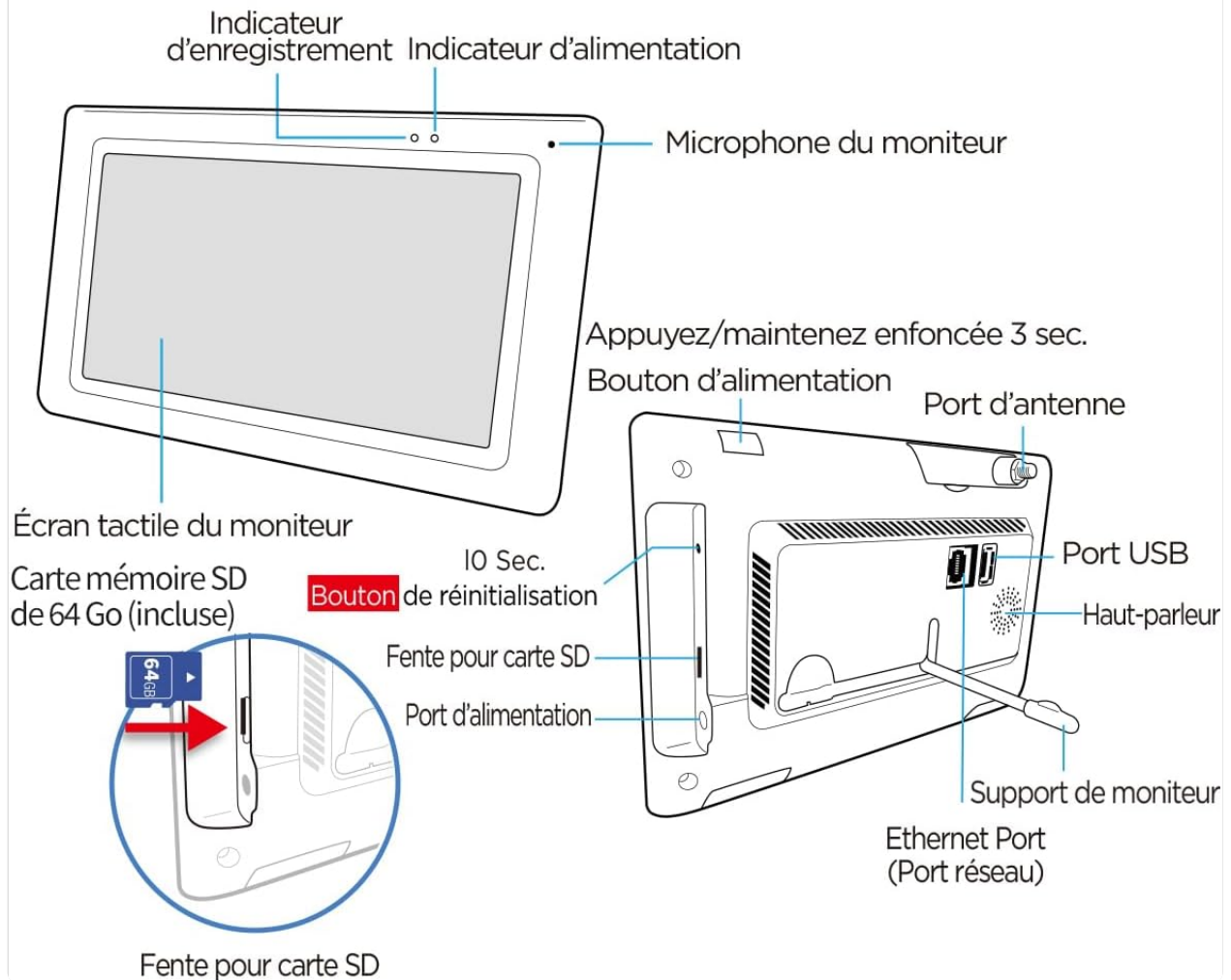

Image: Detailed diagram of the wireless outdoor camera, showing its antenna, adjustable bracket, power cable, power status indicator, light sensor, IR LEDs, passive infrared motion sensor, audio speaker, microphone, and antenna connector.

The cameras are IP66 rated for outdoor use, featuring 2K (3MP) resolution for clear video, night vision, and AI + PIR thermal motion detection for accurate recording.

4. SETUP

4.1. Initial Power-On

1. Connect the power adapter to the 7-inch monitor and plug it into a power outlet.
2. Connect the power adapters to each of the four cameras and plug them into power outlets.
3. The cameras are pre-paired with the monitor. Live video feeds should appear on the monitor within seconds.



Image: An icon depicting a camera with Wi-Fi signals, indicating the auto-pairing feature.

4.2. Camera Placement

Position the cameras in desired surveillance areas. Ensure they are within the 300-meter open-area range from the monitor for optimal signal. The cameras are designed for both indoor and outdoor use.

Regardez les enregistrements par caméra via le moniteur.

Inclus dans l' emballage



Image: A SecuFirst camera mounted outdoors, demonstrating its IP66 waterproof rating.

4.3. Optional Internet Connection (for Remote Access)

While the system functions without internet, you can enable remote access via the "Observer HD+" application by connecting the monitor to the internet.

1. Connect the monitor to your router via an Ethernet cable or Wi-Fi.
2. Download the "Observer HD+" application on your smartphone or tablet.
3. Follow the in-app instructions to add your device for remote viewing, two-way audio, and playback of recordings.

Application pour smartphone (en option)

Connectez le moniteur au WiFi ou à Internet filaire.
Vous pouvez également visionner la vidéo via notre application gratuite, partout dans le monde.



Image: A smartphone showing the "Observer HD+" app interface, demonstrating remote access capabilities alongside the physical monitor.

5. OPERATING THE SYSTEM

5.1. Live View and Multi-View

The 7-inch monitor displays live feeds from all connected cameras. You can switch between single-camera view and multi-camera split view directly on the touch screen.



Image: An icon showing a monitor with a four-way split screen, symbolizing the multi-view capability.

5.2. Two-Way Audio

Use the microphone icon on the monitor's touch screen or within the mobile application to activate two-way audio. This allows you to speak through the camera's speaker and hear audio from the camera's microphone.

5.3. Recording and Playback

The system automatically records events triggered by motion detection to the included 64GB MicroSD card. You can also initiate manual recordings.

To view recordings:

1. On the monitor, navigate to the playback interface.
2. Select the desired camera and date to review recorded footage.
3. Recordings can also be accessed and played back via the "Observer HD+" mobile application.

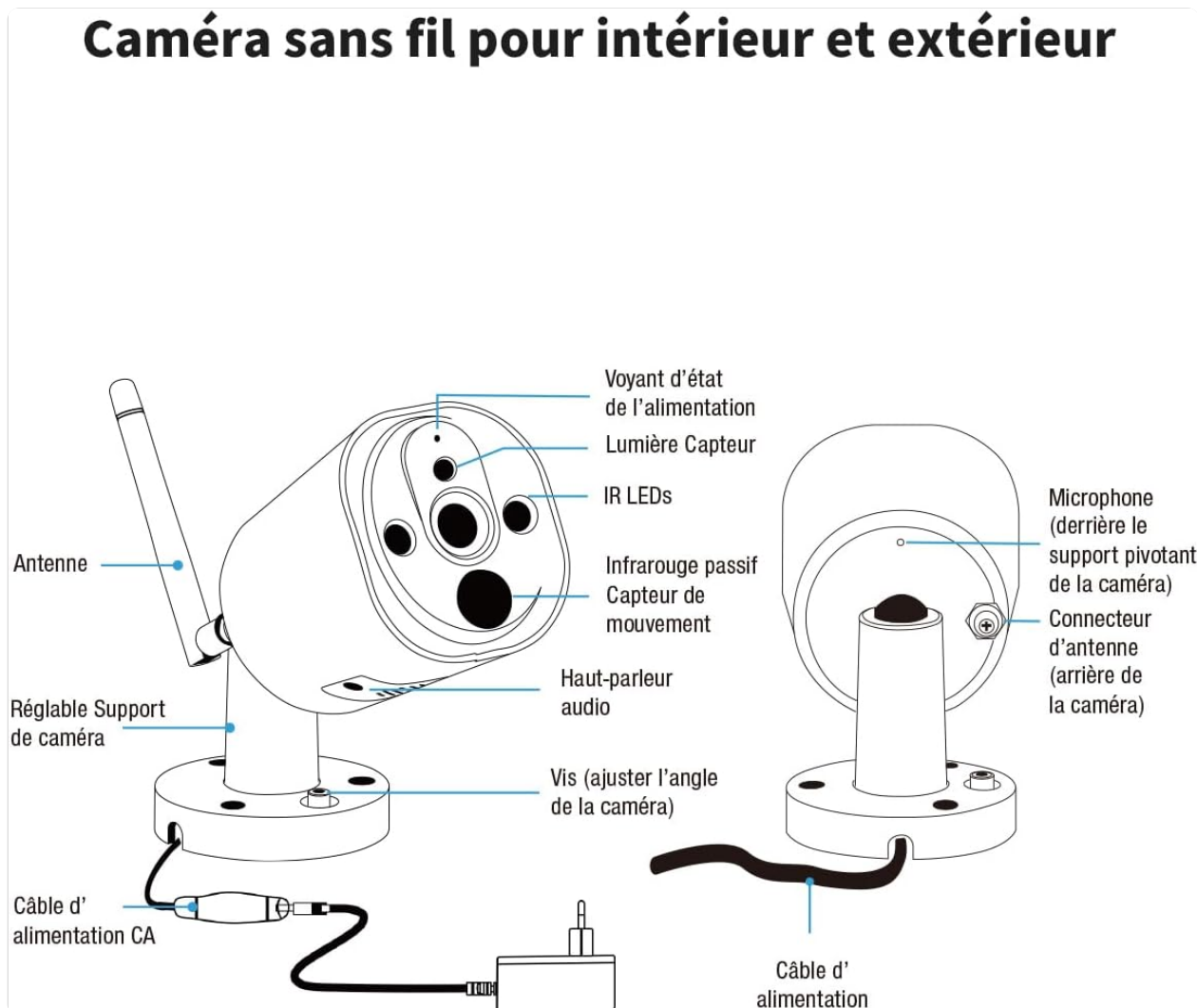

Image: The monitor's screen displaying the playback menu, showing a list of recorded events with timestamps.

5.4. Motion Detection and Alerts

The cameras feature AI + PIR thermal motion detection for accurate alerts.

- Configure motion detection zones directly on the monitor.
- Set up push notifications to your mobile device via the "Observer HD+" app for real-time alerts.
- Adjust alarm volume and siren settings through the monitor's interface.



Image: The monitor screen showing a house with a "PRIVACY" overlay, illustrating the privacy zone masking feature.



Image: The monitor screen showing a pathway with a "Zone" overlay, illustrating the motion detection zone configuration.

5.5. Night Vision

The cameras are equipped with infrared (IR) LEDs for clear night vision, automatically activating in low-light conditions.

Résolution de 3 mégapixels

Autrui

SecuFIRST

1080P / 2 MP



2K / 3MP



Noir/blanc



Noir/blanc



Image: A comparison image showing the camera's 2K/3MP resolution in daylight (color) and its clear night vision in black and white.

6. MAINTENANCE

6.1. Cleaning

- Gently wipe the monitor screen and camera lenses with a soft, dry, lint-free cloth.
- For stubborn smudges, slightly dampen the cloth with water. Avoid harsh chemicals or abrasive cleaners.

6.2. Storage

When not in use for extended periods, store the system in a cool, dry place, away from direct sunlight and extreme temperatures.

6.3. Storage Expansion

The system comes with a 64GB MicroSD card. Storage can be expanded by replacing the MicroSD card with up to a 128GB card, or by connecting an external hard drive or USB stick up to 2TB.

7. TROUBLESHOOTING

Problem	Possible Cause	Solution
No image on monitor	Power issue; Camera out of range; Camera not paired	Check power connections for monitor and cameras. Ensure cameras are within range. If necessary, re-pair cameras (refer to Quick Start Guide for pairing instructions).
Poor image quality	Dirty lens; Low light; Interference	Clean camera lens. Ensure adequate lighting or check night vision functionality. Reduce interference by moving cameras or monitor away from other electronic devices.
No remote access via app	Monitor not connected to internet; Incorrect app settings	Verify monitor's internet connection (Ethernet or Wi-Fi). Check app settings and ensure correct device pairing.
Motion detection not working	Sensitivity too low; Incorrect zone settings	Adjust motion detection sensitivity on the monitor. Review and reconfigure motion detection zones.

8. SPECIFICATIONS

- **Brand:** SecuFirst
- **Model:** 1 Monitor + 4 Camera (White)
- **Manufacturer:** ALC Electronics B.V.
- **Product Dimensions:** 28.4 x 25.8 x 19.4 cm; 3.44 kilograms
- **Power Type:** Corded Electric
- **Voltage:** 12 Volts
- **Wattage:** 12 Watts
- **Special Features:** Two-way audio, local recording, night vision, app control, motion sensor, 7-inch touch screen monitor, Plug-and-play, pre-paired cameras and monitor.
- **Video Recording Resolution:** 2K (3MP)
- **Number of Channels:** 4
- **Memory Storage Capacity:** Up to 2TB (via external HDD/USB), 64GB MicroSD included (expandable to 128GB)
- **Connectivity Technology:** Wired (Ethernet) and Wireless (Proprietary for camera-monitor, Wi-Fi for monitor-internet)
- **Operating System:** Proprietary

9. WARRANTY AND SUPPORT

For warranty information and technical support, please contact SecuFirst directly.

Seller: [SecuFirst \(A2JD6PPEF2M5NQ\)](#)

Return Policy: 30-day refund/replacement policy through Amazon.

For further assistance, refer to the official SecuFirst website or contact their customer service.

© 2024 SecuFirst. All rights reserved.