

Simply SF8x24x1-6pkM08

Simply 8x24x1 Air Filter Instruction Manual

Brand: Simply | Model: SF8x24x1-6pkM08

INTRODUCTION

This manual provides essential information for the installation, operation, and maintenance of your Simply 8x24x1 MERV 8 Air Filters. Designed for universal compatibility, these filters are a key component in maintaining a healthier indoor environment by effectively capturing airborne particles.



Image: Simply Filters promoting a healthier living space.

PRODUCT FEATURES

- **Universal Compatibility:** Measuring 8x24x1 inches (actual size: 7.75"x23.75"x0.75"), these filters are designed to fit most residential and commercial HVAC systems, comparable to 3M Filtrete MPR 600, Filterbuy AFB Silver, and Honeywell FPR 5.
- **Cleaner Air:** MERV 8 rating effectively captures 90% of airborne particles including dust, mold, pet dander, lint, and pollen, promoting fresh and clean indoor air.
- **Advanced Pleated Technology:** Features a higher pleat count than many retail filters, enhancing capture coverage, optimizing airflow, and improving efficiency.
- **Long-lasting Performance:** Provides resilient filtration for up to 3 months under normal conditions.
- **Made in USA:** Proudly manufactured in the USA using 100% American components, including recycled materials,

ensuring superior quality and supporting local manufacturing.

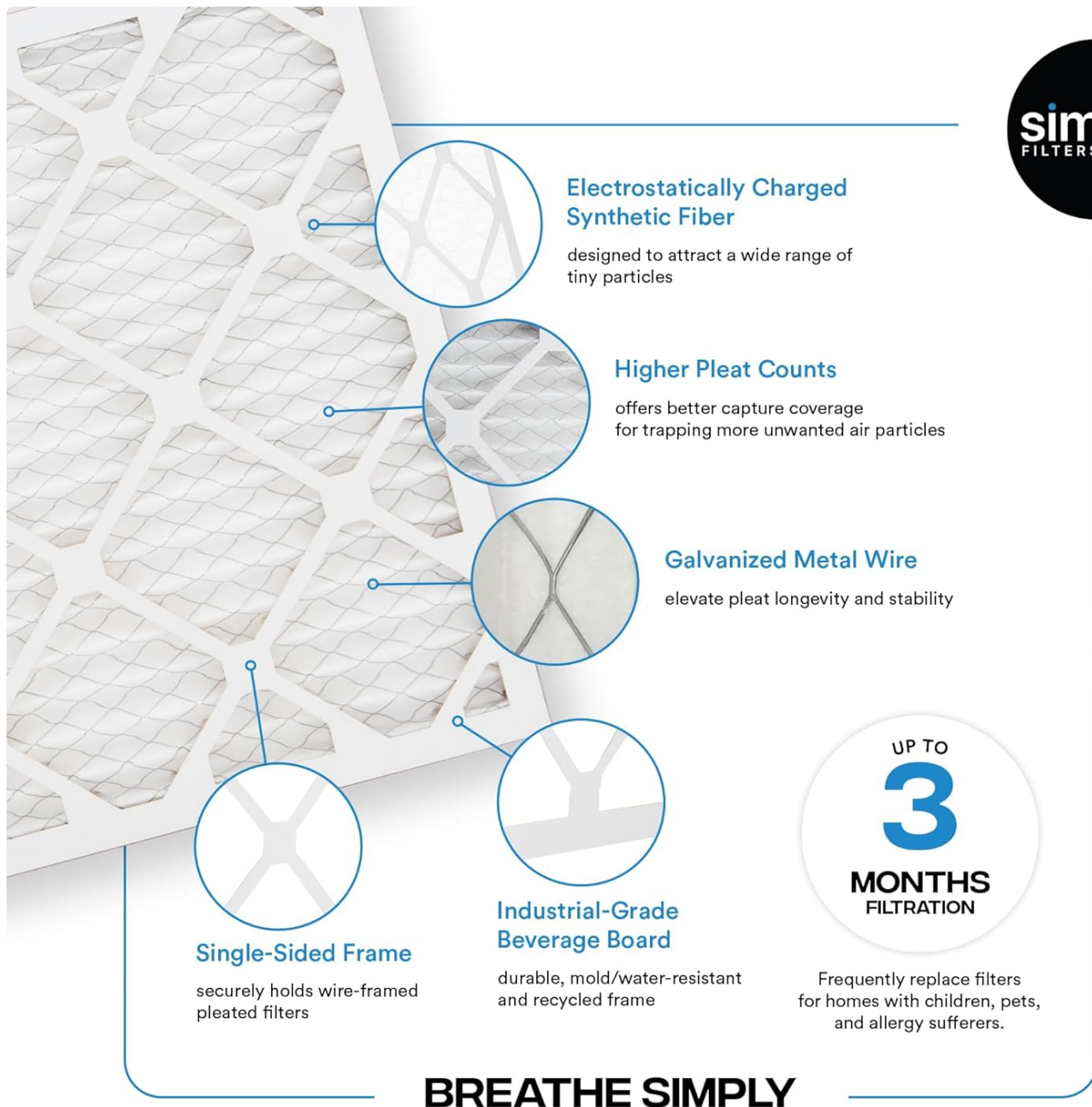

Image: Detailed view of Simply Air Filter's internal construction and materials.

SETUP & INSTALLATION

Proper installation ensures optimal performance and air quality. Follow these steps:

1. Remove the new Simply air filter from its heat-sealed shrink wrap packaging.
2. Locate the "AIR FLOW" arrow printed on the filter's frame. This arrow indicates the direction air should flow through the filter.
3. For central HVAC units, slide the filter into the designated filter slot, ensuring the "AIR FLOW" arrow points towards the furnace or air handler (in the direction of the airflow).
4. For return grilles, insert the filter into the grille with the "AIR FLOW" arrow pointing inward, towards the ductwork.

EASY TO INSTALL



Remove simply air filter from packaging

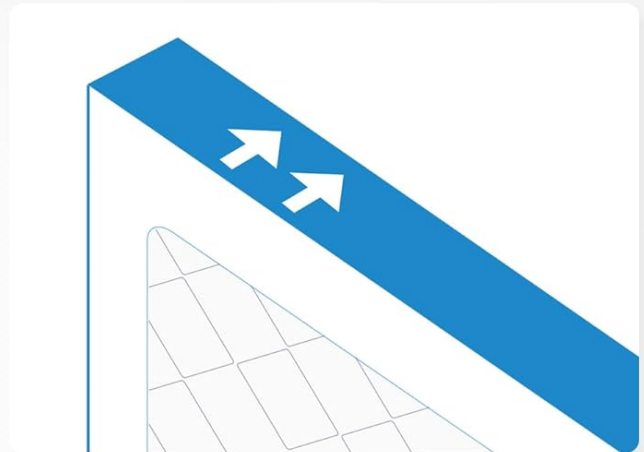

Locate the arrow & point it in the direction of the fan

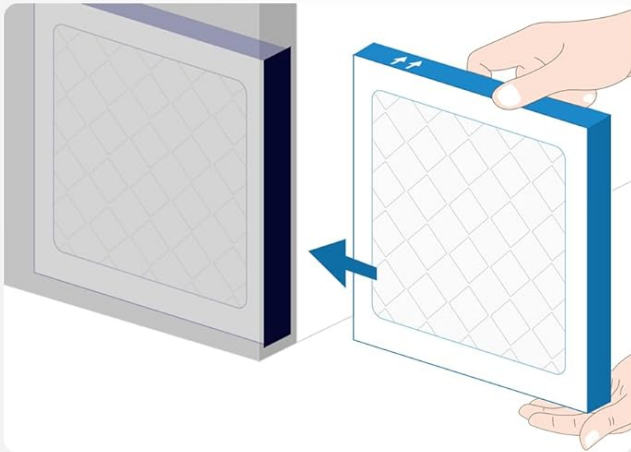

For central units slide the filter into the filter slot of your unit

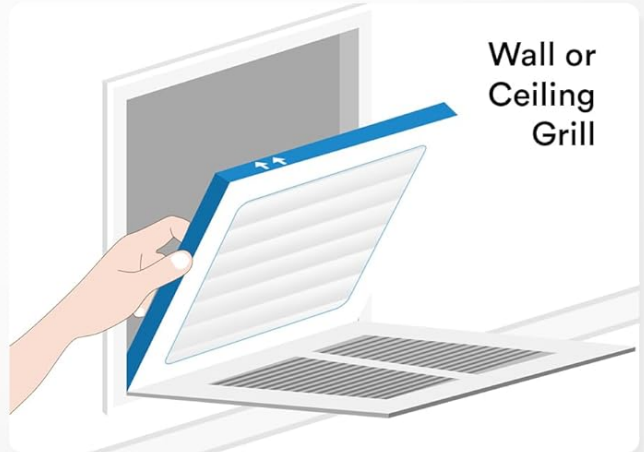

For return grills just insert the filter into the grill with the arrow pointing inward

Image: Visual guide for filter installation.

OPERATING INSTRUCTIONS

Once installed, your Simply air filter will continuously work to clean the air circulating through your HVAC system. The MERV 8 rating provides a balance of effective filtration and optimal airflow, ensuring your system operates efficiently while improving indoor air quality.



Image: Simply 8x24x1 Air Filters, 6-pack.

MAINTENANCE

Regular filter replacement is crucial for maintaining air quality and HVAC system efficiency. It is recommended to replace your Simply air filter every 1 to 3 months, depending on usage and environmental factors such as:

- Presence of pets (especially those that shed)
- Number of occupants in the home
- Local air quality (e.g., pollen count, construction dust)
- Frequency of HVAC system operation

A good practice is to visually inspect the filter monthly. If it appears heavily soiled or clogged with dust and debris, replace it sooner. A clogged filter can restrict airflow, reduce system efficiency, and potentially lead to higher energy bills or system strain.

FIND THE RIGHT MERV FOR YOUR HOME

MATCHING FILTERS TO YOUR INDOOR AIR CONTAMINANTS

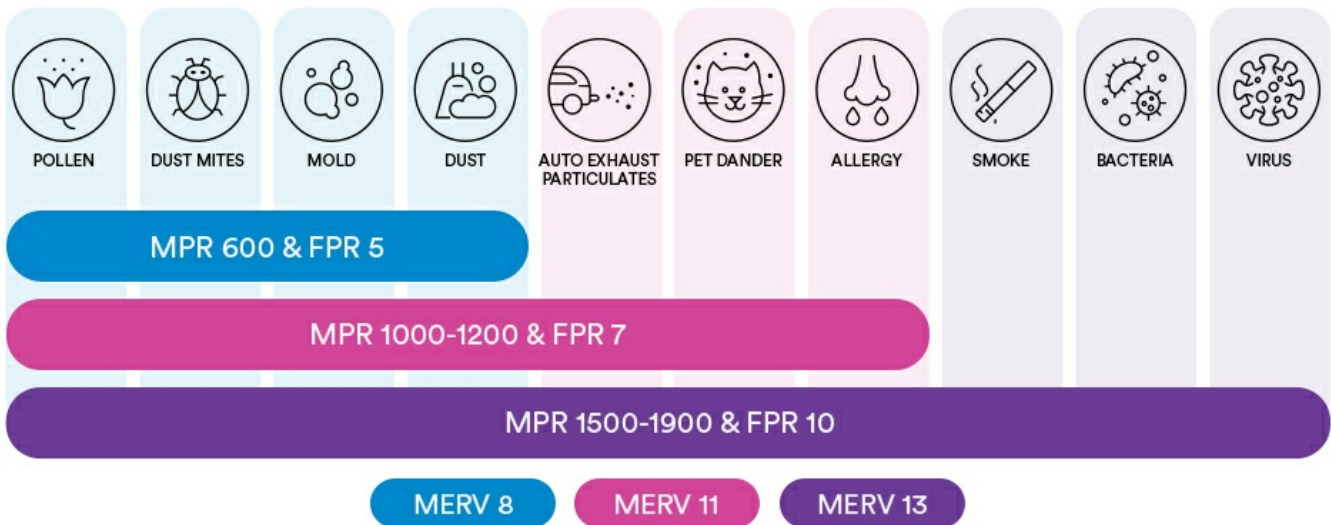

If any of your selections fall into another color zone, we recommend choosing the hierarchy.

Image: Filters are delivered heat-sealed for cleanliness.

TROUBLESHOOTING

Issue	Possible Cause	Solution
Reduced Airflow	Clogged or dirty filter.	Replace the air filter immediately. Ensure the airflow arrow is pointing correctly.
Poor Air Quality / Lingering Odors	Filter is saturated or not effectively capturing pollutants.	Replace the filter. Consider more frequent changes if odors persist or if there are new sources of pollutants (e.g., new pets, smoking).
Filter Doesn't Fit Properly	Incorrect filter size purchased.	Verify the nominal and actual dimensions required for your HVAC system. The actual size of this filter is 7.75"x23.75"x0.75".

SPECIFICATIONS

Brand: Simply

Model Number: SF8x24x1-6pkM08

Nominal Size: 8x24x1 inches

Actual Size: 7.75"L x 23.75"W x 0.75"Th

MERV Rating: 8.00

Material: Paper, Cardboard

Item Weight: 3 pounds (for the 6-pack)

Compatible Devices: Air Conditioner, Heat Pump, Furnace

Country of Origin: USA

Included Components: 6 x Air Filter

MERV
8
MPR 600 / FPR 5

24"

8"

7.75"x23.75"x0.75"

Actual Size
7.75"x23.75"x0.75"

DIMENSIONS

Nominal Size: 8x24x1
Actual Size: 7.75x23.75x0.75

UP TO
3
MONTHS
FILTRATION

Frequently replace filters for homes
with children, pets, and allergy sufferers

Image: Filter dimensions explained.

WARRANTY & SUPPORT

For any questions regarding product warranty, returns, or technical support, please contact the manufacturer, MervFilters, directly or refer to the seller's policies on the platform where the product was purchased. You can also visit the [Simply Filters Brand Store](#) for more information and product offerings.