

Manuals+

[Q & A](#) | [Deep Search](#) | [Upload](#)

Manuals.plus /

› [LYNKBEY](#) /

› LYNKBEY M20 Pro Robot Vacuum and Mop Combo Instruction Manual

LYNKBEY M20 Pro

LYNKBEY M20 Pro Robot Vacuum and Mop Combo Instruction Manual

Model: M20 Pro | Brand: LYNKBEY

1. INTRODUCTION

Welcome to the LYNKBEY M20 Pro Robot Vacuum and Mop Combo instruction manual. This advanced cleaning system is designed to provide a comprehensive and hands-free floor cleaning experience. Featuring intelligent navigation, powerful suction, and automated maintenance, the M20 Pro simplifies your home cleaning routine.

Please read this manual thoroughly before operating the device to ensure safe and efficient use. Keep this manual for future reference.

2. KEY FEATURES

- **15-in-1 Multifunctional Dock:** A fully automated maintenance system that handles dustbin emptying, tank refilling, mop washing, and hot air drying, minimizing manual intervention.

15-IN-1 ROBOTIC VACUUM CLEANER

A complete auto-maintenance cleaning system that frees your hands.



Auto Dust Emptying



Auto Tank Refilling



Auto Hot Air Drying

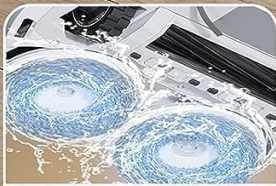

Auto Mop Washing



Image: The LYNKBHEY M20 Pro docking station, showcasing its integrated tanks for clean water, dirty water, and dust collection, along with the robot vacuum docked for charging and maintenance.

- **Ultra-Thin Body & Compact Design:** Equipped with a built-in radar and advanced laser-based navigation, allowing the robot to access tighter spaces and cover larger areas efficiently. Its compact design adapts well to various installation needs.

ULTRA-SLIM DESIGN

Gets into tighter spaces while covering a larger sweeping area



LYNKBEY



OTHER



Image: The LYNKBHEY M20 Pro robot vacuum easily navigating under furniture, highlighting its ultra-thin profile compared to other models.

- **AI 3.0 Obstacle Avoidance:** Detects and avoids objects on the floor, eliminating the need for pre-cleaning. Advanced AI Action learns your home layout, tailors cleaning strategies, and generates optimal paths based on obstacles, flooring, and room type.

AI 3.0 OBSTACLE AVOIDANCE

Says goodbye to pre-cleaning, advanced AI system detects and avoids objects on the floor



Image: The LYNKBAY M20 Pro robot vacuum using AI obstacle avoidance to navigate around various items on the floor, illustrating its intelligent path planning.

- **Revolutionary Rotating & Lifting Mopping System:** Distinguishes between hard floors and carpets. Dual rotary mops spin at 180 RPM under 10N pressure for thorough scrubbing. Mops automatically lift 15mm when encountering carpets to prevent wetting.

REVOLUTIONARY ROTATING MOPPING SYSTEM

Apply a pressure of 10N downward and raise the height of 15mm upward, perfect for Carpet cleaning and tackling sticky mess and oil stains.



Image: Close-up of the LYNKBHEY M20 Pro's dual rotating mop pads, demonstrating their pressure and lifting capabilities for effective cleaning on different floor types.

- **Multi-Directional Floating Brush:** Adjusts its height to maintain close contact with various floor surfaces, ensuring effective cleaning on both carpets and hard floors. The rubber brush automatically lifts 10mm when mopping to prevent dust transfer to wet areas.

ESPECIALLY PROFESSIONAL FOR CLEANING

others

our

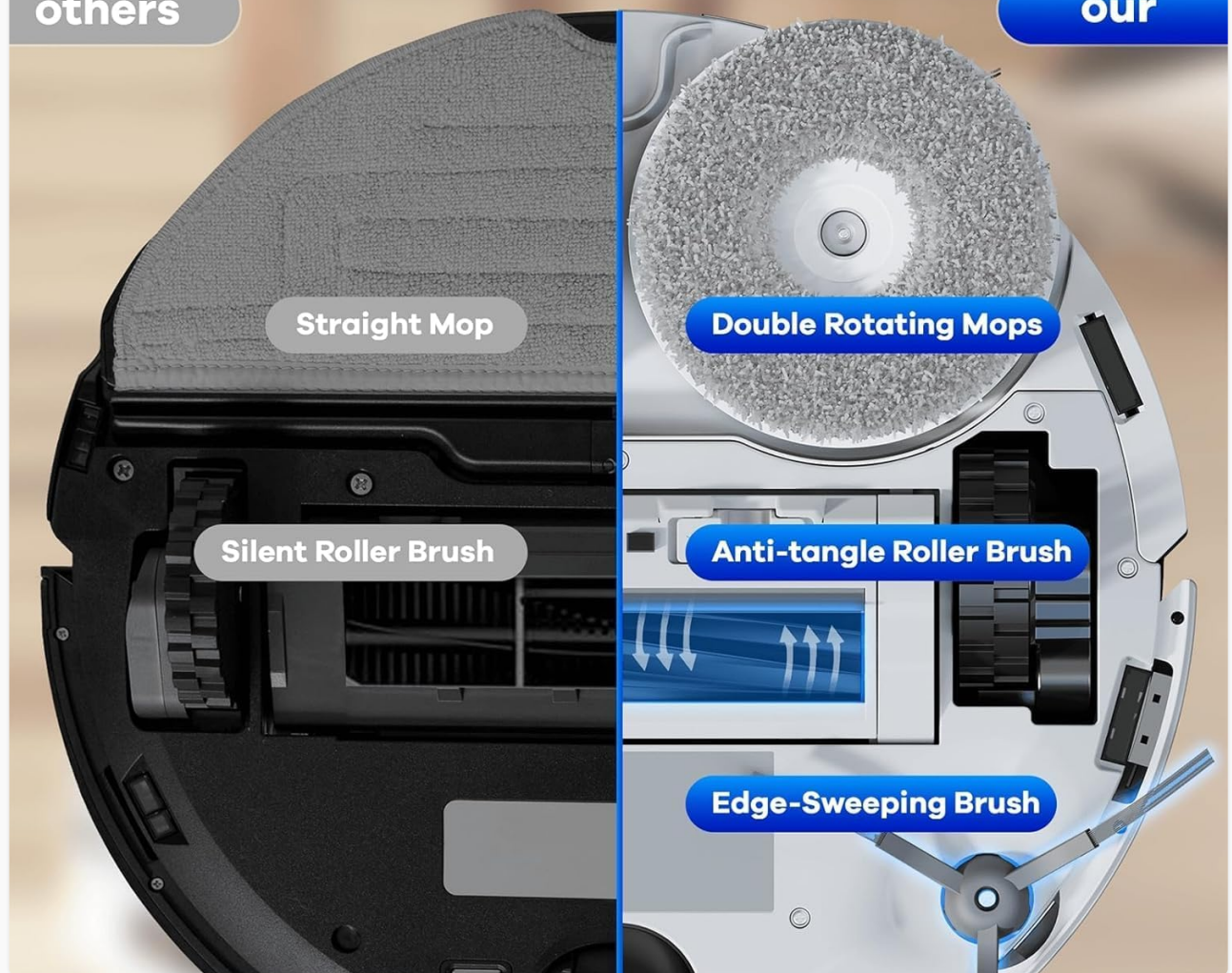

Image: An underside view of the LYNKBHEY M20 Pro, highlighting its multi-directional floating brush and double rotating mops for comprehensive cleaning.

3. PRODUCT COMPONENTS

- LYNKBHEY M20 Pro Robot Vacuum
- Multifunctional Docking Station
- Clean Water Tank (4L capacity)
- Dirty Water Tank
- Dustbin (integrated into robot)
- Rotating Mop Pads (2 sets)
- Side Brushes
- Main Brush (Anti-tangle rubber brush)
- Power Cord
- User Manual & Quick Start Guide
- Cleaning Brush
- Disposable Dust Bag (extra)

4. SETUP GUIDE

1. **Unpack the Device:** Carefully remove all components from the packaging. Ensure all protective films and packing materials are removed from the robot and docking station.
2. **Place the Docking Station:**
 - Place the dock on a hard, level ground against a wall.
 - Ensure there is at least 0.5 meters (1.6 ft) of clear space on both sides and 1.5 meters (4.9 ft) in front of the dock for optimal robot navigation.
 - Avoid placing the dock in direct sunlight or near heat sources.
3. **Connect Power:** Plug the power cord into the docking station and then into a wall outlet. The indicator light on the dock will illuminate.
4. **Prepare Water Tanks:**
 - Remove the Clean Water Tank from the dock. Fill it with clean tap water up to the MAX level mark. (Optional: Add LYNKBHEY original cleaning solution).
 - Place the Clean Water Tank back into the dock.
 - Ensure the Dirty Water Tank is empty and properly seated in the dock.
5. **Install Robot:** Open the top cover of the robot, remove the anti-collision foam, and turn on the power switch. Place the robot onto the docking station. The robot will automatically start charging.
6. **Download and Connect to Mobile App:**
 - Scan the QR code in the Quick Start Guide or search for "LYNKBEY" in your app store to download the app.
 - Follow the in-app instructions to connect your robot to your home Wi-Fi network (2.4GHz only).

5. OPERATING INSTRUCTIONS

5.1 Initial Mapping

After initial setup, the robot will perform a quick mapping of your home. This map will be saved in the app and used for efficient cleaning and navigation.

5.2 App Control & Customization

The LYNKBHEY app provides comprehensive control over your robot:

- **Cleaning Modes:** Select from various cleaning modes to suit your needs:
 - Sweep Only Mode
 - Mop Only Mode
 - Sweep Before Mop Mode
 - Sweep and Mop Mode (simultaneous)
- **Suction Intensity:** Adjust suction power (Quiet, Standard, Strong, Hurricane) based on floor type and cleaning requirements. Quiet mode operates at approximately 50-60 decibels.
- **Water Amount for Mopping:** Control the water output for mopping (Low, Medium, High) to optimize cleaning for different floor surfaces.
- **Restricted Zones:** Set virtual walls or no-go zones on the map to prevent the robot from entering specific areas.
- **Scheduling:** Create custom cleaning schedules for specific times and days.

- **Real-time Monitoring & Video Call:** Use the app to view your home through the robot's camera. The two-way voice call function allows you to speak through the robot. You can also capture screenshots or video recordings.

5.3 Manual Operation

The robot also features physical buttons for basic operations:

- **Start/Stop Button:** Press to start or pause cleaning.
- **Home Button:** Press to send the robot back to the docking station for charging or self-maintenance.

6. MAINTENANCE

Regular maintenance ensures optimal performance and longevity of your LYNKBHEY M20 Pro.

- **Self-Emptying Dustbin:** The robot automatically empties its dustbin into the docking station's rubbish tank after each cleaning cycle. The rubbish tank can hold debris for up to 60 days (actual interval depends on usage).
- **Auto Mop Washing:** The docking station automatically washes the mop pads with clean water, simulating a hand-wash effect.
- **Hot Air Drying:** After washing, the mop pads are dried with hot air within 3 hours to prevent odors and mildew.
- **Cleaning Brushes:** Regularly check and clean the main brush and side brushes to remove tangled hair or debris. The anti-tangle rubber brush minimizes hair entanglement. Use the provided cleaning brush for this task.
- **Cleaning Sensors:** Wipe the cliff sensors and other navigation sensors with a clean, dry cloth to ensure accurate navigation and obstacle avoidance.
- **Water Tanks:** Empty the Dirty Water Tank after each use. Refill the Clean Water Tank as needed.

7. TROUBLESHOOTING

If you encounter issues with your LYNKBHEY M20 Pro, please refer to the following common solutions:

- **Robot not charging:** Ensure the docking station is powered on and the robot is properly aligned with the charging contacts. Clean the charging contacts on both the robot and the dock.
- **Error messages:** Refer to the specific error code displayed on the robot or in the app. Common issues include jammed brushes, dirty sensors, or full dustbins/tanks. Follow the app's instructions to resolve.
- **Poor cleaning performance:** Check if the dustbin is full or the mop pads are dirty. Clean or replace as necessary. Ensure the main brush and side brushes are free of debris. Adjust suction intensity and water amount in the app.
- **Robot gets stuck frequently:** Clear obstacles from the cleaning path. Use the app to set restricted zones for areas where the robot frequently gets stuck. Ensure sufficient clearance around the docking station.
- **App connectivity issues:** Ensure your Wi-Fi network is 2.4GHz. Restart your router, the robot, and the app. Re-pair the robot with the app if necessary.

For more detailed troubleshooting or persistent issues, please consult the full user manual or contact LYNKBHEY customer support.

8. SPECIFICATIONS

Feature	Detail
Brand	LYNKBEY
Model Name	M20 Pro
Color	White
Product Dimensions	19.75"L x 20.47"W x 20.08"H
Item Weight	41.6 pounds
Power Source	Battery Powered
Battery Life	4 Hours
Filter Type	Cartridge
Special Feature	Corded (refers to the dock's power connection)
Compatible Devices	Smartphones (for app control)
Connectivity	2.4GHz WiFi only

9. WARRANTY AND SUPPORT

The LYNKBHEY M20 Pro comes with a manufacturer's warranty. For specific warranty terms, registration, and support, please refer to the official LYNKBHEY website or the warranty card included in your product packaging. For technical assistance, troubleshooting, or spare parts, please contact LYNKBHEY customer service through the contact information provided in your user manual or on the official LYNKBHEY support channels.