

## OnLyee CR1024

# OnLyee Projection Alarm Clock

Model: CR1024

Brand: OnLyee

## INTRODUCTION

This manual provides detailed instructions for the setup, operation, and maintenance of your OnLyee Projection Alarm Clock. Please read this manual thoroughly before using the product to ensure proper function and longevity.



Image: The OnLye Projection Alarm Clock, showing its main display with time, date, temperature, and humidity. A red projection of the time is visible above the clock, and a smartphone is connected for charging via one of the clock's USB ports.

## PACKAGE CONTENTS

---

Upon unpacking, please ensure all items listed below are present and in good condition:

- OnLye Projection Alarm Clock (Model CR1024)
- Power Adapter
- USB Power Cable
- User Manual

Anti-Slip Design

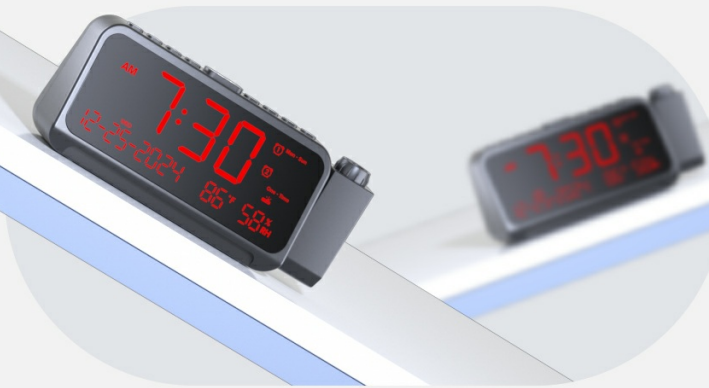


Image: An illustration showing the contents of the product box: the OnLyee Projection Alarm Clock, an instruction manual, a power adapter, and a USB power cable.

SETUP

Power Connection

- 1. Connect the provided USB power cable to the clock's DC input port.
- 2. Plug the power adapter into a standard 100-240V AC outlet. The clock display will illuminate.

Battery Backup Installation

The clock requires 2 AAA batteries (not included) for memory backup. These batteries preserve your time and alarm settings during a power outage. Note that the display will not be active and alarms will not sound when operating on battery backup alone.

- 1. Locate the battery compartment on the bottom of the clock.
- 2. Open the battery compartment cover.
- 3. Insert 2 AAA batteries, ensuring correct polarity (+/-).
- 4. Close the battery compartment cover securely.

Calendar Function



Image: A visual guide demonstrating how to install two AAA batteries into the battery backup compartment located on the

bottom of the alarm clock.

## OPERATING INSTRUCTIONS

### Time and Date Setting

Refer to the detailed instructions provided in the included user manual for specific button functions and sequences to set the time and date.

### 12/24 Hour Format & DST

The clock features a dedicated 12/24 Hour & DST button. Press this button to toggle between 12-hour and 24-hour time formats, or to activate/deactivate Daylight Saving Time (DST).

#### 5-Level Adjustable Dimmer Brightness



Image: A graphic showing examples of the time display in 12-hour format (with AM/PM), 24-hour format, and how DST (Daylight Saving Time) is indicated on the clock's display.

### Dual Alarm Settings

This alarm clock supports two independent alarms with four wake-up modes:

- **Mon-Sun:** Alarm sounds every day.
- **Mon-Fri:** Alarm sounds on weekdays only.
- **Sat-Sun:** Alarm sounds on weekends only.
- **One-Time:** Alarm sounds once and then deactivates.

Use the alarm setting buttons to configure each alarm's time and desired mode.

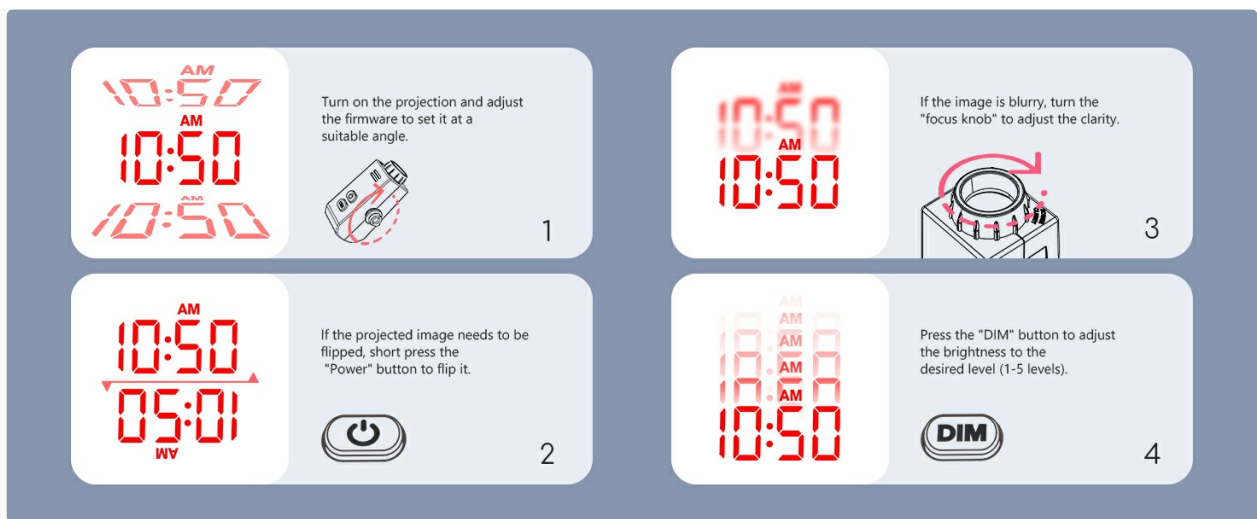


Image: An illustration detailing the dual alarm functionality, showing how to set two separate alarms (Alarm 1 and Alarm 2) with various scheduling options like Mon-Sun, Mon-Fri, Sat-Sun, and One-Time.

## Snooze Function

When an alarm sounds, press the large **SNOOZE** button on the top of the clock to temporarily silence the alarm for 9 minutes. The alarm will sound again after the snooze period.

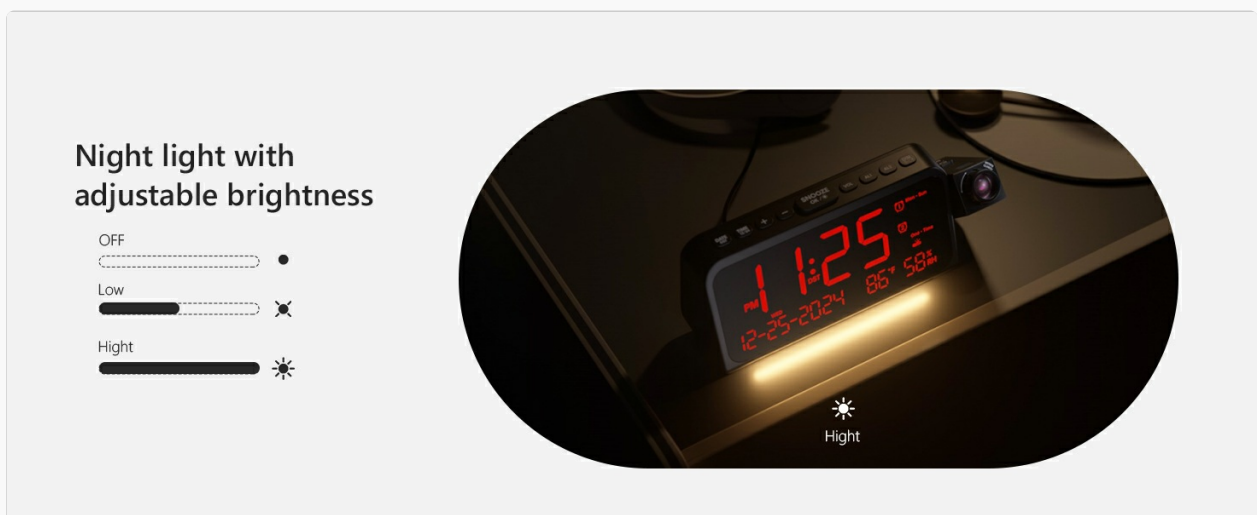


Image: A close-up view of a hand pressing the prominent 'SNOOZE' button located on the top surface of the alarm clock.

## Projection Features

The integrated projector can display the time on your ceiling or wall. It features a 350° adjustable swivel and a rotating focus ring for optimal clarity.

1. **Adjust Angle:** Manually adjust the projector arm to direct the time display to your desired location. The projector can rotate 350 degrees.
2. **Focus Adjustment:** Rotate the focus ring on the projector lens to achieve a clear and sharp image.
3. **Flip Projection:** If the projected image is upside down, short press the 'Power' button to flip its orientation 180 degrees.
4. **Projection Brightness:** Press the 'DIM' button to cycle through 5 levels of projection brightness.



9 Mins Snooze Function

Easily press the snooze button



Image: A four-panel diagram illustrating how to operate the projection feature: 1) Adjusting the projector angle, 2) Flipping the projected image with the power button, 3) Adjusting the focus with the focus knob, and 4) Adjusting the projection brightness with the DIM button.

7-Level Adjustable Volume



Image: A graphic illustrating the 350-degree rotatable projector, indicating its range of motion for directing the time display.



Image: A visual representation of the five distinct brightness levels available for the time projection, from Level 1 (dimmiest) to Level 5 (brightest).

Display Brightness

The main LED display has 5 adjustable brightness levels. Use the appropriate button (often labeled 'DIM' or

similar) to cycle through these levels to suit your preference.



Image: A graphic demonstrating the five adjustable brightness levels for the main LED screen display, ranging from Level 1 (dimnest) to Level 5 (brightest).

## Adjustable Volume

The alarm volume can be adjusted across 7 levels, from 45dB to 116dB. This feature is designed to accommodate various preferences, including heavy sleepers, by offering a progressive buzzer volume.



Image: A visual representation of the 7-level adjustable volume range for the alarm, indicating sound levels from 45dB to 116dB.

## Indoor Temperature & Humidity Monitor

The clock includes a high-precision sensor to display indoor temperature and humidity. This helps in monitoring your environment for comfort and health.

- Temperature Range: -50°C to 70°C (-58°F to 158°F) with  $\pm 1^\circ\text{C}$  accuracy.
- Humidity Range: 1% to 99% RH with  $\pm 2\%$  accuracy.

## 350°Rotatable Projector

Image: A graphic illustrating the indoor temperature and humidity monitoring feature of the clock, displaying the temperature in both Fahrenheit and Celsius, and the relative humidity percentage.

## Calendar Function

The clock displays the current date, including the day of the week, month, and year.

### Indoor Temperature and Indoor Humidity

Assist you in creating a more comfortable space

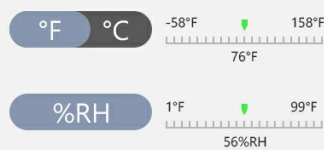


Image: A visual representation of the clock's calendar function, showing the current day of the week, month, and day, with a small calendar icon.

## Charging Ports

The clock is equipped with one USB-A and one Type-C charging port, allowing you to charge external devices such as smartphones and tablets.





Image: An illustration highlighting the dual charging ports (USB-A and Type-C) on the back of the alarm clock, demonstrating their use for charging a smartphone and wireless earbuds.

## Night Light

The clock features an adjustable night light. Use the dedicated button to turn it on/off and adjust its brightness.



Image: A graphic demonstrating the night light feature of the clock, showing its adjustable brightness settings: Off, Low, and High, with the light emanating from the base of the clock.

## MAINTENANCE

- **Cleaning:** Use a soft, dry cloth to clean the clock's surface. Avoid abrasive cleaners or solvents.
- **Power:** Always disconnect the power adapter before cleaning or if the clock will not be used for an extended period.
- **Environment:** Keep the clock away from direct sunlight, extreme temperatures, and high humidity.

## TROUBLESHOOTING

Problem	Possible Cause	Solution
Clock display is off.	No power connection.	Ensure the power adapter is securely plugged into the clock and a working electrical outlet.
Projection is blurry.	Focus is not adjusted correctly.	Rotate the focus ring on the projector lens until the image is clear.
Projected time is upside down.	Projection orientation needs adjustment.	Short press the 'Power' button to flip the projection 180 degrees.
Alarm settings lost after power outage.	No battery backup or batteries are dead.	Install 2 new AAA batteries in the battery compartment for memory backup.
Cannot charge devices via USB ports.	Clock is not powered by AC adapter.	Ensure the clock is connected to AC power. USB charging ports are only active when the clock is powered by the adapter.

## SPECIFICATIONS

**Brand:** OnLyee

**Model Number:** CR1024

**Color:** Red Projection

**Display Type:** Digital LED

**Product Dimensions:** 7.87 x 2.36 x 3.43 inches (20 x 6 x 8.7 cm)

**Item Weight:** 0.53 lbs (240 grams) / 11.7 ounces

**Power Source:** Corded Electric, Battery Powered (2 AAA batteries for backup, not included)

**Material:** Acrylonitrile Butadiene Styrene (ABS)

**Special Features:** Digital Clock, Dual Alarm (4 Wake-up Modes), Daylight Saving Time, USB/Type-C Charging Ports, Snooze, 5-Level Adjustable Display Brightness, 7-Level Adjustable Volume, Large Display, Super Clear Projection (350° Rotatable, 360° Focus Adjustable, 180° Flip), Temperature Humidity Monitor, Calendar, Night Light

**Indoor/Outdoor Usage:** Indoor

**Mounting Type:** Tabletop

## WARRANTY AND SUPPORT

OnLyee is committed to providing high-quality products and customer satisfaction.

- **Warranty:** This product comes with an 18-month limited warranty from the date of purchase.
- **Email Support:** We aim to respond to all email inquiries within 8 hours.
- **Lifetime Support:** OnLyee provides lifetime technical support for this product.

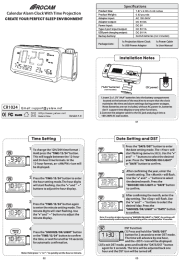
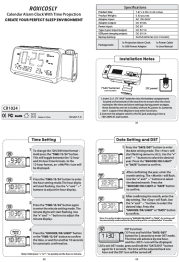
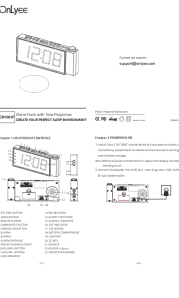
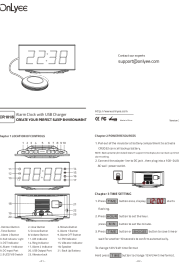
For any questions, technical assistance, or warranty claims, please contact OnLyee customer service through the retailer where you purchased the product or visit the official OnLyee brand store.

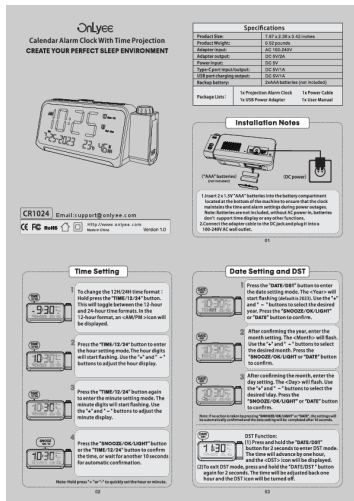


Image: OnLyee brand information highlighting 6,000,000+ units sold worldwide, 18 months warranty, 8-hour email reply service, and lifetime support.

Related Documents - CR1024

	<p><a href="#">Mesqool CR1024 Projection Alarm Clock User Manual</a></p> <p>User guide for the Mesqool CR1024 Projection Alarm Clock, detailing time setting, date setting, DST function, alarm settings, brightness control, temperature/humidity display, night light, projection mode, and device charging.</p>
	<p><a href="#">CR1024 Projection Alarm Clock User Manual</a></p> <p>User manual for the CR1024 Projection Alarm Clock, detailing setup, time and date settings, alarm functions, projection features, brightness control, temperature/humidity display, and device charging capabilities.</p>

	<p><a href="#">ROCAM CR1024 Calendar Alarm Clock with Time Projection User Manual</a></p> <p>Comprehensive user manual for the ROCAM CR1024 Calendar Alarm Clock, detailing its features including time projection, alarm settings, date configuration, DST function, brightness control, temperature/humidity monitoring, night light, and device charging capabilities.</p>
	<p><a href="#">Roxicosly CR1024 Projection Alarm Clock User Manual</a></p> <p>User manual for the Roxicosly CR1024 projection alarm clock. Features include a large display, date, day, temperature, humidity, dual alarms, USB charging, snooze, and backlight. Projects time onto walls and ceilings.</p>
	<p><a href="#">OnLyee CR1001F Alarm Clock with Time Projection User Manual</a></p> <p>User manual for the OnLyee CR1001F Alarm Clock with Time Projection, detailing its features, controls, setup, and operation.</p>
	<p><a href="#">OnLyee CR1018i Alarm Clock with USB Charger User Manual</a></p> <p>User manual for the OnLyee CR1018i Alarm Clock with USB Charger. Learn about its features, controls, power resources, time setting, alarm setting, DST, USB charging, dimmer, and vibrator functions.</p>



[\[pdf\]](#) User Manual

Onlyee CR1024 UserManual 2023 7 31 V1 cdr KUN Projection Alarm Clock for Bedroom with 350° Rotatable Projector 5 Brightness Dual Weekday Weekend Mode Temp Humidity Snooze Bedside Heavy Sleepers BlueUser ManualCR1024 User Manual Blue B0CKYQJWJG B0CJRNFDMG B0CLD4D8GG B0CJRJFFS4Projection Digital Level Dimmer Adjustable Volume Temperature Monitor Calendar 12 24H DST Battery Backup Home KitchenB1226U5DOGLB1226U5DOGLm media amazon images | B1226U5DOGLm B1226U5DOGL |||

Email:support onlyee.com Http://www.onlyee.com Pressthe AL1 or SNOOZE/OK/LIGHT buttontosavethealarmsettingsand exitthealarmsettingmode.  
Note: ...

lang: **score:13** filesize: 2.31 M page\_count: 2 document date: 2023-07-31