

OnLye CR1024

OnLye CR1024 Projection Alarm Clock User Manual

Model: CR1024 | Brand: OnLye

INTRODUCTION

Thank you for choosing the OnLye CR1024 Projection Alarm Clock. This device is designed to provide convenient timekeeping, dual alarm functions, and environmental monitoring with a unique projection feature. This manual will guide you through the setup, operation, and maintenance of your new alarm clock.

WHAT'S IN THE BOX

- OnLye CR1024 Projection Alarm Clock Unit
- Power Adapter (100-240V AC)
- USB Power Cord
- User Manual (this document)

9 Mins Snooze Function

Easily press the snooze button



Figure 1: Contents of the product packaging, including the alarm clock, power adapter, and power cord.

PRODUCT OVERVIEW

The OnLye CR1024 features a large LED display and an integrated projector for time display on walls or ceilings. It includes various buttons for setting time, alarms, and adjusting display settings.



Figure 2: Front view of the OnLye CR1024 Projection Alarm Clock, showing the main display and a phone connected for charging.

Key Features:

- **Large LED Display:** 5.9-inch ultra-clear display for easy readability.
- **Ultra-Clear Projection:** 350° rotatable projector with 360° focus adjustment for time display on ceiling or wall (optimal distance 1.64-11.4ft).
- **Adjustable Brightness:** 5-level adjustable screen brightness and 5-level projection brightness.
- **Dual Alarm:** Set two independent alarms with four wake-up modes (weekend, workdays, all seven days, one-time).
- **Temperature & Humidity Monitor:** High-precision indoor temperature and humidity display.
- **Snooze Function:** 9-minute snooze.
- **Charging Ports:** 1 USB and 1 Type-C charging port for external devices.
- **Battery Backup:** Requires 2 AAA batteries (not included) for memory backup during power outages.

SETUP

1. **Power Connection:** Connect the provided power adapter to the DC input port on the back of the alarm clock and plug it into a standard 100-240V AC outlet. The display will light up.
2. **Battery Backup (Optional but Recommended):** Open the battery compartment on the bottom of the unit and insert 2 AAA batteries (not included). This will preserve your time and alarm settings in case of a power interruption.
Note: The display will not show time and alarms will not sound on battery power alone.
3. **Initial Time Setting:**
 - Press and hold the "TIME SET" button to enter time setting mode.
 - Use the "+" or "-" buttons to adjust the hour, then press "TIME SET" to confirm.
 - Repeat for minutes, year, month, and day.
 - Press "TIME SET" again to exit.
4. **12/24 Hour Format & DST:**
 - Short press the "12/24H & DST" button to switch between 12-hour and 24-hour time formats.
 - Press and hold the "12/24H & DST" button to activate or deactivate Daylight Saving Time (DST).

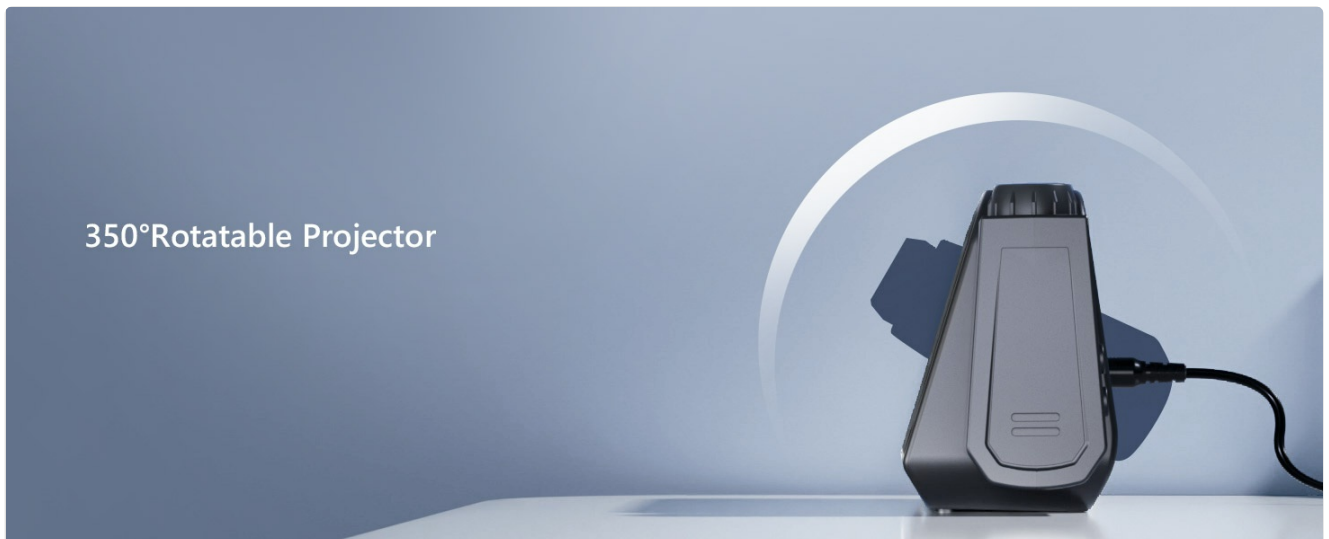

Figure 3: Adjusting 12/24 hour format and DST.

OPERATING INSTRUCTIONS

Setting Alarms (Dual Alarm Function)

The clock supports two independent alarms (Alarm 1 and Alarm 2).

1. **Set Alarm 1:**
 - Press and hold the "AL1" button. The hour will flash.
 - Use "+" or "-" to adjust the hour, then press "AL1" to confirm.
 - Repeat for minutes.
 - Select the alarm mode (Mon-Sun, Mon-Fri, Sat-Sun, One-Time) using "+" or "-". Press "AL1" to confirm.
 - The alarm icon for Alarm 1 will appear on the display, indicating it is active.
2. **Set Alarm 2:** Follow the same steps as Alarm 1, using the "AL2" button.
3. **Adjust Alarm Volume:** While an alarm is sounding or in alarm setting mode, use the "VOL" button to adjust the 7-level progressive buzzer volume (45-116dB).



Figure 4: Setting up dual alarms for different schedules.

Snooze Function

When an alarm sounds, press the large "SNOOZE/OK/+" button on top of the clock to activate the 9-minute snooze function. The alarm will sound again after 9 minutes.

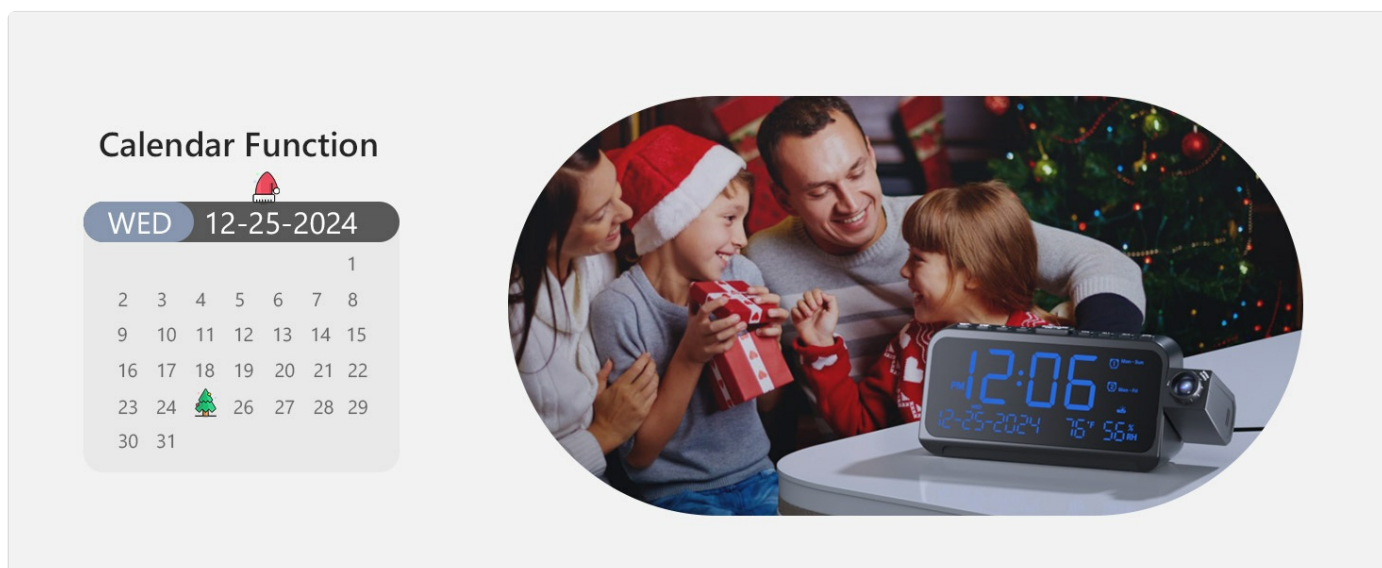

Figure 5: Activating the snooze function by pressing the top button.

Projection Feature

1. **Activate/Deactivate Projection:** Press the "PROJECTOR" button to turn the projection on or off.
2. **Adjust Projection Angle:** The projector arm can be rotated 350° to direct the time display where desired.
3. **Adjust Focus:** Rotate the focus ring on the projector lens to achieve a clear and sharp image.
4. **Flip Projection:** If the projected image is upside down, short press the "Power" button (often integrated with the projector control) to flip it 180°.
5. **Adjust Projection Brightness:** Press the "DIM" button to cycle through 5 levels of projection brightness.

Battery Backup

Use AAA batteries to save your time settings



ON



OFF



(Two hours later)
Power ON



Figure 6: Steps for adjusting the projection display.

Dual Charging Port

Type-C



Input
Output

DC



Input
/

USB



/
Output



Figure 7: Different brightness levels for the projected time.

Display Brightness and Night Light

The main LED display brightness can be adjusted to suit your preference.

- **Adjust Display Brightness:** Press the "DIM" button (if separate from projection dimming, or the same button if it cycles both) to cycle through 5 levels of display brightness.
- **Night Light:** The clock features an adjustable night light. Use the dedicated night light button (if available, or a long press on DIM/SNOOZE) to turn it on/off and adjust its brightness.



Figure 8: Adjusting the main display brightness.

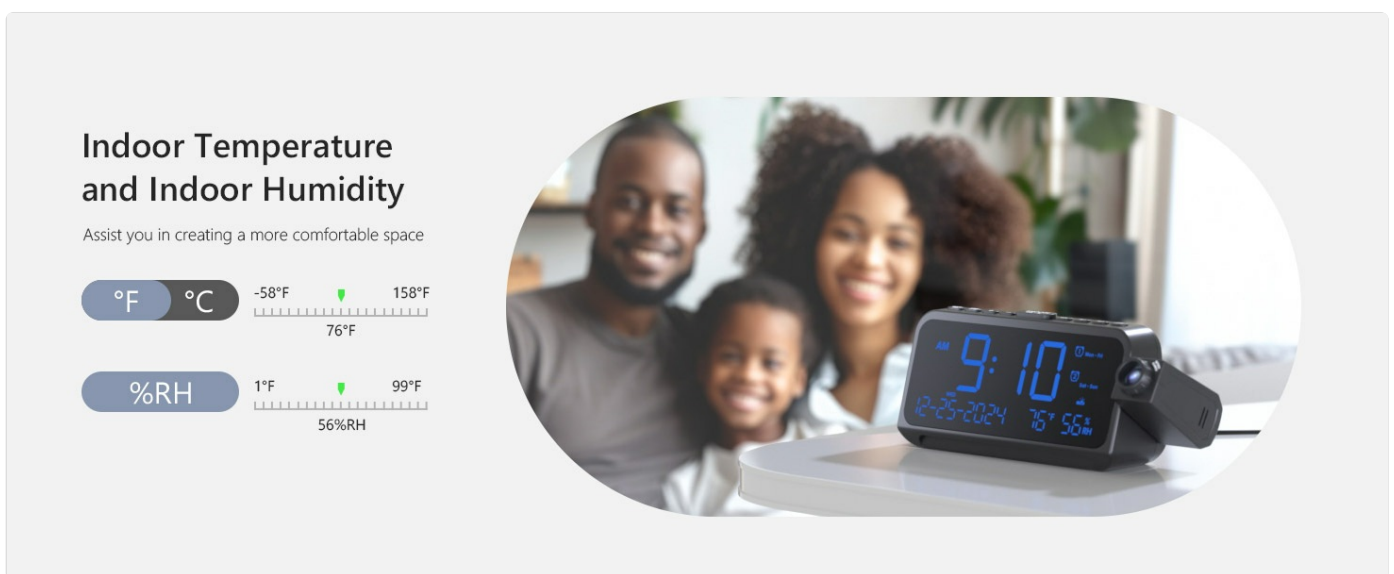

Figure 9: The integrated night light with adjustable intensity.

Charging External Devices

The alarm clock is equipped with a USB-A and a Type-C charging port.

- Connect your device's charging cable to the appropriate USB-A or Type-C port on the back of the alarm clock.
- Ensure the alarm clock is powered via the AC adapter for charging functionality.

WHAT'S IN THE BOX



Figure 10: Using the dual charging ports for external devices.

MAINTENANCE

- **Cleaning:** Use a soft, dry cloth to clean the surface of the alarm clock. Do not use abrasive cleaners or solvents.
- **Placement:** Place the alarm clock on a stable, flat surface. Avoid direct sunlight, excessive heat, or moisture.
- **Battery Replacement:** If using battery backup, replace the AAA batteries annually or when the backup function is no longer reliable.

TROUBLESHOOTING

Problem	Possible Cause	Solution
Clock display is off.	No power connection or power outage.	Ensure the power adapter is securely plugged into the clock and a working outlet. Check for power outages.
Alarm does not sound.	Alarm not set, alarm volume too low, or battery backup only.	Verify alarm settings and ensure the alarm icon is displayed. Increase alarm volume. Ensure the clock is powered by AC for alarm function.
Projected time is blurry.	Focus not adjusted correctly.	Rotate the focus ring on the projector lens until the image is clear.
Projected time is upside down.	Projection orientation needs adjustment.	Short press the "Power" button (often near the projector) to flip the image 180°.
Temperature/Humidity readings are inaccurate.	External factors affecting sensors.	Ensure the clock is not placed near heat sources, direct sunlight, or in areas with extreme drafts. Allow time for readings to stabilize after relocation.

SPECIFICATIONS

Model Number:	CR1024
Display Type:	Digital LED

Power Source:	Corded Electric (AC 100-240V), Battery Powered (2 x AAA for backup, not included)
Product Dimensions:	7.87 x 2.36 x 3.43 inches (20 x 6 x 8.7 cm)
Item Weight:	7 ounces (240 grams)
Material:	Acrylonitrile Butadiene Styrene (ABS)
Temperature Range:	-50°C to 70°C (-58°F to 158°F)
Humidity Range:	1% to 99% RH
Projection Distance:	1.64-11.4 feet (0.5-3 meters)

WARRANTY & SUPPORT

OnLyee provides the following support for your CR1024 Projection Alarm Clock:

- **Warranty:** 18 Months Limited Warranty.
- **Email Support:** Responses typically within 8 hours.
- **Lifetime Support:** Ongoing assistance for the product's lifespan.

For further assistance, please visit the [OnLyee Store on Amazon](#) or refer to the official user manual PDF available at [this link](#).

PRODUCT VIDEO

Your browser does not support the video tag.

Video 1: An overview of the OnLyee CR1024 Projection Alarm Clock, demonstrating its features including the projection, dual alarms, and display brightness adjustments. This video provides a visual guide to the clock's main functionalities and ease of use.

Related Documents - CR1024

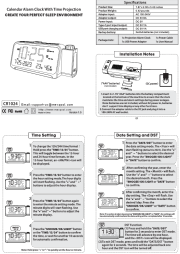
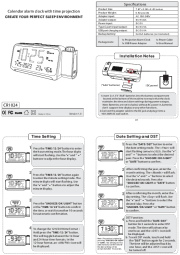
	<p>Mesqool CR1024 Projection Alarm Clock User Manual</p> <p>User guide for the Mesqool CR1024 Projection Alarm Clock, detailing time setting, date setting, DST function, alarm settings, brightness control, temperature/humidity display, night light, projection mode, and device charging.</p>
	<p>CR1024 Projection Alarm Clock User Manual</p> <p>User manual for the CR1024 Projection Alarm Clock, detailing setup, time and date settings, alarm functions, projection features, brightness control, temperature/humidity display, and device charging capabilities.</p>

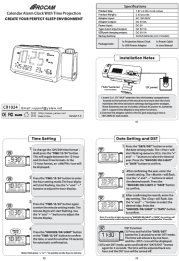
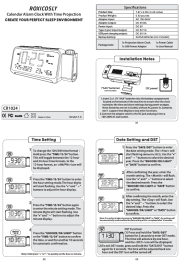
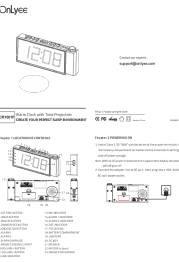
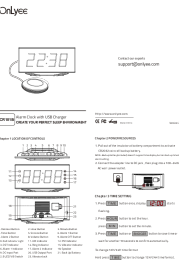
	<p>ROCAM CR1024 Calendar Alarm Clock with Time Projection User Manual</p> <p>Comprehensive user manual for the ROCAM CR1024 Calendar Alarm Clock, detailing its features including time projection, alarm settings, date configuration, DST function, brightness control, temperature/humidity monitoring, night light, and device charging capabilities.</p>
	<p>Roxicosly CR1024 Projection Alarm Clock User Manual</p> <p>User manual for the Roxicosly CR1024 projection alarm clock. Features include a large display, date, day, temperature, humidity, dual alarms, USB charging, snooze, and backlight. Projects time onto walls and ceilings.</p>
	<p>OnLyee CR1001F Alarm Clock with Time Projection User Manual</p> <p>User manual for the OnLyee CR1001F Alarm Clock with Time Projection, detailing its features, controls, setup, and operation.</p>
	<p>OnLyee CR1018i Alarm Clock with USB Charger User Manual</p> <p>User manual for the OnLyee CR1018i Alarm Clock with USB Charger. Learn about its features, controls, power resources, time setting, alarm setting, DST, USB charging, dimmer, and vibrator functions.</p>

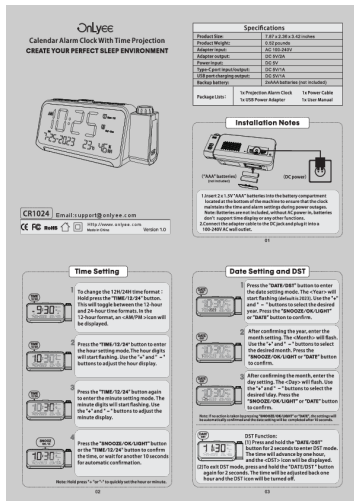

[\[pdf\]](#) User Manual

Onlyee CR1024 UserManual 2023 7 31 V1 cdr KUN Projection Alarm Clock for Bedroom with 350° Rotatable Projector 5 Brightness Dual Weekday Weekend Mode Temp Humidity Snooze Bedside Heavy Sleepers BlueUser ManualCR1024 User Manual Blue B0CKYQJWJG B0CJRNFDMG B0CLD4D8GG B0CJRJFFS4Projection Digital Level Dimmer Adjustable Volume Temperature Monitor Calendar 12 24H DST Battery Backup Home KitchenB1226U5DOGLB1226U5DOGLm media amazon images I B1226U5DOGLm B1226U5DOGL |||

Email:support onlyee.com Http://www.onlyee.com Pressthe AL1 or SNOOZE/OK/LIGHT buttontosavethealarmsettingsand exitthealarmsettingmode. Note: ...

lang: **score:13** filesize: 2.31 M page_count: 2 document date: 2023-07-31