



[Manuals.plus](#) /

› [Podofu](#) /

› Podofu Portable 9.3-inch Carplay Android Auto Multimedia Player User Manual

## Podofu Portable 9.3-inch Multimedia Player

# Podofu Portable 9.3-inch Carplay Android Auto Multimedia Player

User Manual

### INTRODUCTION

This manual provides detailed instructions for the installation, operation, and maintenance of your Podofu Portable 9.3-inch Carplay Android Auto Multimedia Player. Please read this manual thoroughly before using the device to ensure proper functionality and safety. Keep this manual for future reference.

### PRODUCT DEMONSTRATION VIDEO

Your browser does not support the video tag.

Video: A demonstration of the Podofu Portable Multimedia Player's features, including its physical design, wireless CarPlay and Android Auto connectivity, voice control for calls and navigation, and dual camera display for driving and reversing.

### PACKAGE CONTENTS

Verify that all items listed below are present in your package:

- 1x Portable 9.3-inch Multimedia Player
- 1x Reversing Camera (if included in your specific model)
- 1x Universal Mount
- 1x Camera Power Cable
- 1x Set of Camera Installation Screws
- 1x 64GB TF Card

- 1x Cigarette Lighter Power Plug
- 1x Auxiliary (AUX) Cable
- 1x User Manual

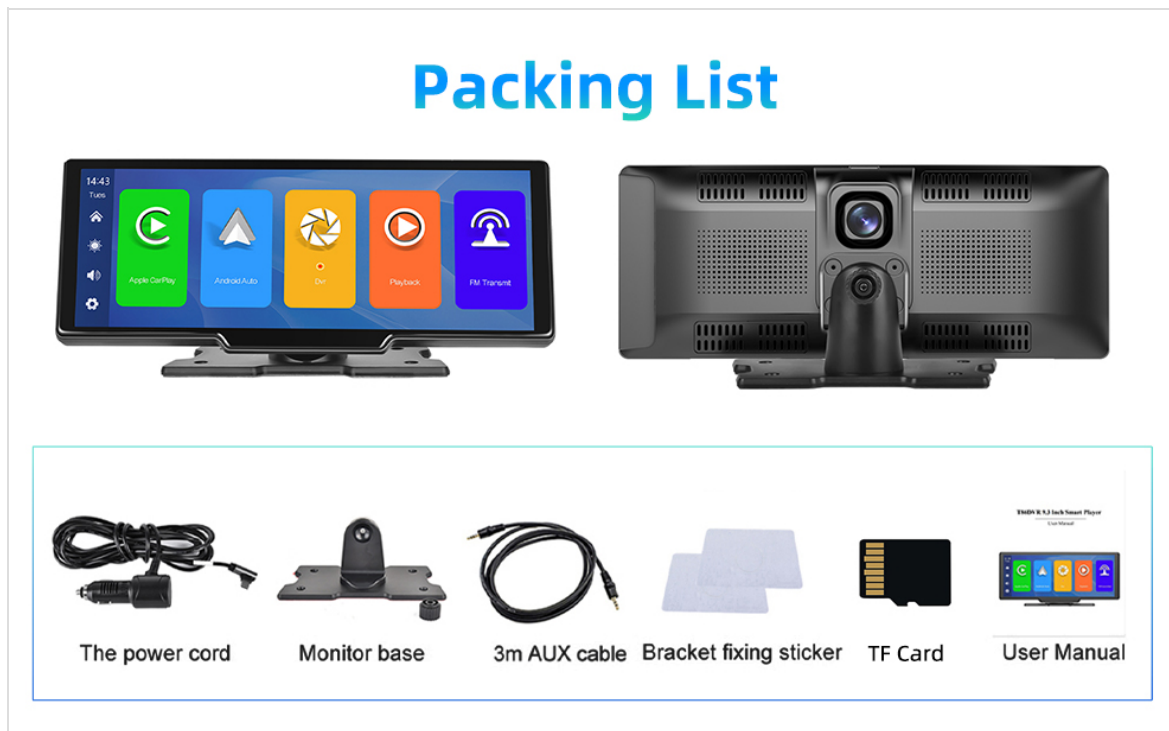

Image: Contents of the product package, including the main unit, power cable, monitor base, AUX cable, bracket fixing stickers, TF card, and user manual.

## PRODUCT OVERVIEW

The Podofu Portable Multimedia Player offers a range of features designed to enhance your driving experience. It includes a 9.3-inch capacitive touch screen, wireless Apple CarPlay and Android Auto compatibility, Bluetooth connectivity, FM transmission, and support for front and rear cameras.

### Key Features:

- **Wireless CarPlay & Android Auto:** Seamless integration with your smartphone for navigation, music, calls, and messages.
- **9.3-inch HD Touch Screen:** Provides a clear and responsive interface for all functions.
- **Bluetooth Connectivity:** For hands-free calling and audio streaming.
- **FM Transmitter:** Broadcast audio to your car's existing radio system.
- **Dual Split Function:** Display two applications simultaneously on the screen.
- **Reversing Camera & Driving Recorder:** Enhances safety with parking assistance and continuous recording.
- **Voice Control:** Operate functions using voice commands for a safer driving experience.

# Wireless CarPlay & Android Auto & Bluetooth

No need to worry about messy wires anymore, the Adapter can easily convert your wired Apple CarPlay /Android Auto to wireless!

 Music  Voice Control  Navigation  Messages



Image: The Podofu portable multimedia player displaying wireless CarPlay and Android Auto interfaces, highlighting music, voice control, navigation, and messaging features.

# Multifunctional Portable Car Radio

## Built-in Speaker



## Aux Connected



## FM Transmitter



## 64G TF Card



Image: Four panels illustrating key features: built-in speaker, AUX connection, FM transmitter, and 64GB TF card slot.

# 2.5D HD 9.3 Inch Capacitive Touch Screen



Image: Detailed view of the product dimensions (239mm x 100mm) and various ports, including power, rear camera, forward camera, storage slot, and AUX hole. Also shows compatibility with various vehicle types.

## SETUP

### 1. Mounting the Device:

1. Choose a suitable location on your dashboard that does not obstruct your view or interfere with airbags.
2. Clean the dashboard surface thoroughly.
3. Attach the universal mount to the desired location using the provided adhesive or suction cup. Ensure it is securely fixed.
4. Mount the multimedia player onto the universal mount. Adjust the angle for optimal viewing.



Image: Illustration showing the adjustable angle of the multimedia player's screen on its mount.

## 2. Power Connection:

1. Insert the cigarette lighter power plug into your vehicle's 12V power outlet.
2. Connect the power cable to the designated power input port on the multimedia player.
3. Route the cable neatly to avoid obstruction.

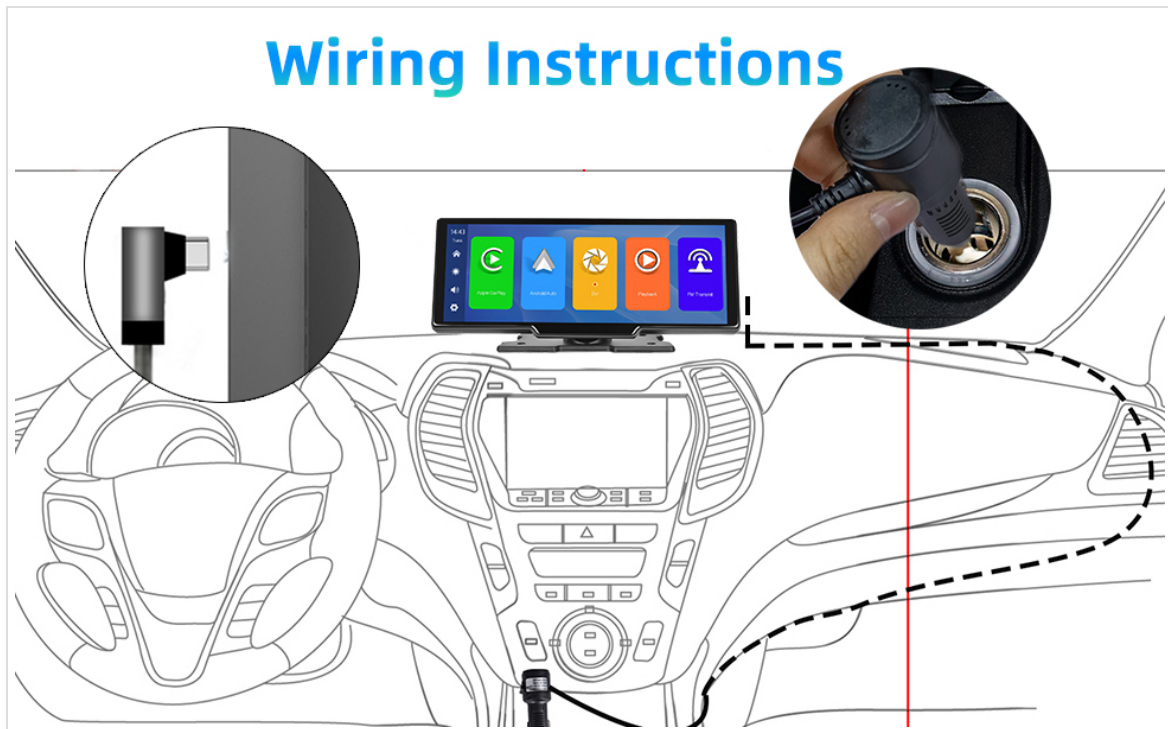

Image: Diagram illustrating how to connect the power cable from the multimedia player to the car's cigarette lighter socket and route the cable.

## 3. Camera Installation (Optional):

1. If your package includes a reversing camera, install it at the rear of your vehicle according to the camera's specific instructions.
2. Connect the camera's power cable to the vehicle's reverse light circuit for automatic activation when reversing.
3. Connect the camera's video cable to the designated rear camera input on the multimedia player.
4. For a front camera (if applicable), connect it to the forward camera input.

## OPERATING INSTRUCTIONS

### 1. Initial Power On:

Once connected to power, the device should automatically turn on. If not, press the power button (location may vary, refer to product diagram) to start the system.

### 2. Wireless CarPlay / Android Auto:

1. On the device's main screen, select the "CarPlay" or "Android Auto" icon.
2. Enable Bluetooth and Wi-Fi on your smartphone.
3. On your smartphone, search for and connect to the device's Bluetooth name (e.g., "Podofu\_Carplay").
4. Confirm the pairing request on both devices.
5. Once connected via Bluetooth, the device will prompt you to enable CarPlay or Android Auto via Wi-Fi. Confirm to establish the wireless connection.
6. Your smartphone interface will now be displayed on the multimedia player's screen.



Image: The multimedia player screen displaying the Apple CarPlay interface with various app icons, and a smartphone showing the CarPlay connection.

### 3. Bluetooth Audio and Hands-Free Calling:

1. Ensure your phone is paired via Bluetooth as described in the CarPlay/Android Auto section.
2. To play music, select the "Bluetooth Music" option on the device or play music directly from your phone.
3. For hands-free calls, incoming calls will be displayed on the screen. You can answer, reject, or end calls directly from the player's interface or using voice commands.



Image: The multimedia player screen showing a music playback interface, with icons for Bluetooth and phone calls, and a smartphone displaying a call screen.

#### 4. FM Transmitter:

1. Select the "FM Transmitter" icon on the main screen.
2. Choose an unused FM frequency on the multimedia player.
3. Tune your car's FM radio to the same frequency.
4. Audio from the multimedia player will now be broadcast through your car's speakers.



Image: The multimedia player screen displaying the FM transmitter interface with a frequency selection and an FM radio icon.

#### 5. Voice Control:

When CarPlay or Android Auto is active, you can use voice commands (e.g., "Hey Siri" or "OK Google") to control navigation, make calls, send messages, and play music. This feature enhances safety by allowing you to keep your hands on the wheel.



Image: The multimedia player screen showing a navigation map with voice command prompts like "Hi, Siri" and "Open Maps."

## 6. Camera Functions (Driving Recorder & Reversing Display):

The device supports both front and rear cameras for driving recording and reversing assistance. The included 64GB TF card stores recorded footage.

- **Driving Recorder:** The front camera continuously records footage while driving. Footage is saved to the TF card.
- **Reversing Display:** When the vehicle is put into reverse, the screen will automatically switch to the rear camera view, displaying parking guidelines for assistance.

## 2 . 5K + 1080P Recording



Image: The multimedia player screen showing a front camera view of a road and a rear camera view with parking lines in a parking lot, illustrating 2.5K + 1080P recording capabilities.

### Front Rear camera



Image: Two screens showing front and rear camera views, indicating the device supports both for comprehensive monitoring.

## MAINTENANCE

- **Cleaning:** Use a soft, dry cloth to clean the screen and exterior of the device. Avoid using

abrasive cleaners or solvents.

- **Temperature:** Do not expose the device to extreme temperatures (hot or cold) for extended periods.
- **Storage:** If storing the device for a long time, disconnect it from power and store it in a cool, dry place.
- **Software Updates:** Periodically check the manufacturer's website for any available firmware updates to ensure optimal performance and new features.

## TROUBLESHOOTING

Problem	Possible Cause	Solution
Device does not power on.	No power connection; faulty power cable; vehicle's power outlet issue.	Check power cable connection. Ensure cigarette lighter socket is functional. Try a different power source if available.
CarPlay/Android Auto not connecting.	Bluetooth/Wi-Fi off on phone; incorrect pairing; software glitch.	Ensure Bluetooth and Wi-Fi are enabled on your phone. Forget the device in your phone's Bluetooth settings and re-pair. Restart both devices.
No audio from car speakers via FM.	Incorrect FM frequency; car radio not tuned correctly.	Verify the FM frequency on the player and your car radio match. Choose a clear, unused frequency.
Reversing camera not displaying.	Camera not connected; power issue to camera; faulty camera.	Check camera cable connections. Ensure the camera is receiving power (e.g., from reverse light).
Touch screen unresponsive.	Temporary software issue; screen damage.	Restart the device. If the issue persists, contact customer support.

## SPECIFICATIONS

Feature	Detail
Brand	Podofu
Display Type	9.3-inch Capacitive Touch Screen
Connectivity Technology	Auxiliary, Bluetooth, Wireless CarPlay, Wireless Android Auto
Tuning Technology	FM Transmitter

Feature	Detail
Power Source	Cable Electric (Cigarette Lighter Plug)
Supported Radio Bands	FM
Compatible Devices	Smartphone, MP3 Player, Tablet, Laptop
Voltage	16 Volts (DC)
Audio Output Mode	Stereo
Included Components	Multimedia Player, Reversing Camera, Universal Mount, Camera Power Cable, Camera Installation Screws, 64GB TF Card, Cigarette Lighter Plug, Auxiliary Cable, User Manual

---

## WARRANTY AND SUPPORT

For warranty information, technical support, or service inquiries, please refer to the warranty card included in your package or visit the official Podofu website. Please retain your proof of purchase for warranty claims.

**Podofu Official Website:** [Visit Podofu Store on Amazon](#)

---