

Manuals+

[Q & A](#) | [Deep Search](#) | [Upload](#)

[manuals.plus](#) /

- › [Smart Ball](#) /
- › [Smart Ball Soccer Bot - Ultimate Indoor Soccer Game Instruction Manual](#)

Smart Ball 1001CB

Smart Ball Soccer Bot - Ultimate Indoor Soccer Game

Model: 1001CB | Brand: Smart Ball

INTRODUCTION

The Smart Ball Soccer Bot is an advanced indoor football trainer designed to enhance dribbling, control, and overall soccer skills. Featuring sensor technology, multiple speed modes, and an integrated score tracker, it provides an engaging and effective training experience for players of all levels.

SAFETY INFORMATION

WARNING: CHOKING HAZARD--Small parts. Not intended for children under 3 years.

Recommended for ages 6 years and up.

WHAT'S IN THE BOX

- 1x Soccer Bot
- 1x Soccer Ball
- 4x Discs



Image: The Soccer Bot, a green soccer ball, and one of the green smart discs, illustrating the main components included in the box.



***SIZE I PVC FOOTBALL WITH
SENSOR TECHNOLOGY***

Ball may require some inflation. Pump not included

Image: A close-up of the green Smart Ball, highlighting its 'SMART BALL' branding and indicating its sensor technology.

SETUP

1. **Battery Installation**

The Soccer Bot requires 4 AA batteries and the Soccer Ball requires 3 AAA batteries. Ensure batteries are inserted with correct polarity.



Image: The underside of the Soccer Bot, clearly showing the battery compartments for 4 AA batteries in the main unit and 3 AAA batteries for the ball's internal mechanism.

2. **Setting Up the Training Area**

Use the four smart discs to define a training area. Keep the Soccer Bot and ball within a 1.5m (approximately 5 feet) area for optimal performance.



Image: A training setup showing the Soccer Bot, ball, and four green discs on the floor, indicating a recommended 1.5m square play area.

OPERATING INSTRUCTIONS

1. Power On and Mode Selection

Switch the Soccer Bot on using the toggle switch. Select between 'Standard' mode for smooth surfaces or 'Boost' mode for carpets to ensure optimal performance.



Image: The Soccer Bot and ball on a carpet, demonstrating the 'Boost Mode' for enhanced movement on softer surfaces.

2. **Choosing Speed Modes**

The Soccer Bot offers three customizable speed settings to match different skill levels and abilities. Adjust the speed using the control buttons on the bot.

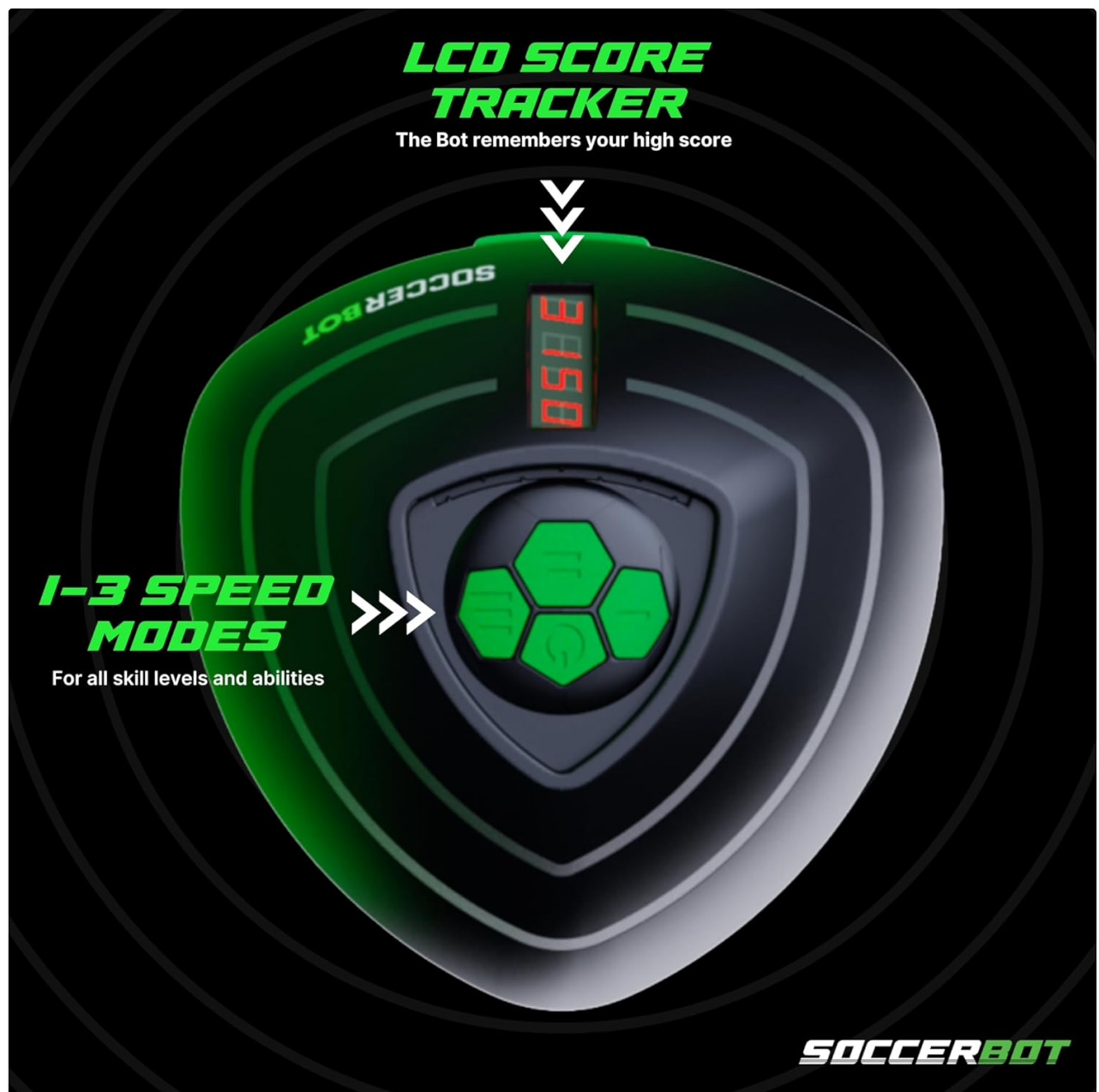

Image: A detailed view of the Soccer Bot's control panel, highlighting the LCD score tracker and the buttons for selecting one of the three speed modes.

3. **Gameplay and Score Tracking**

The objective is to keep the ball away from the Soccer Bot for as long as possible, up to 5 minutes. You have 3 lives. The built-in LCD screen tracks your current score and records your highest score, encouraging continuous improvement.

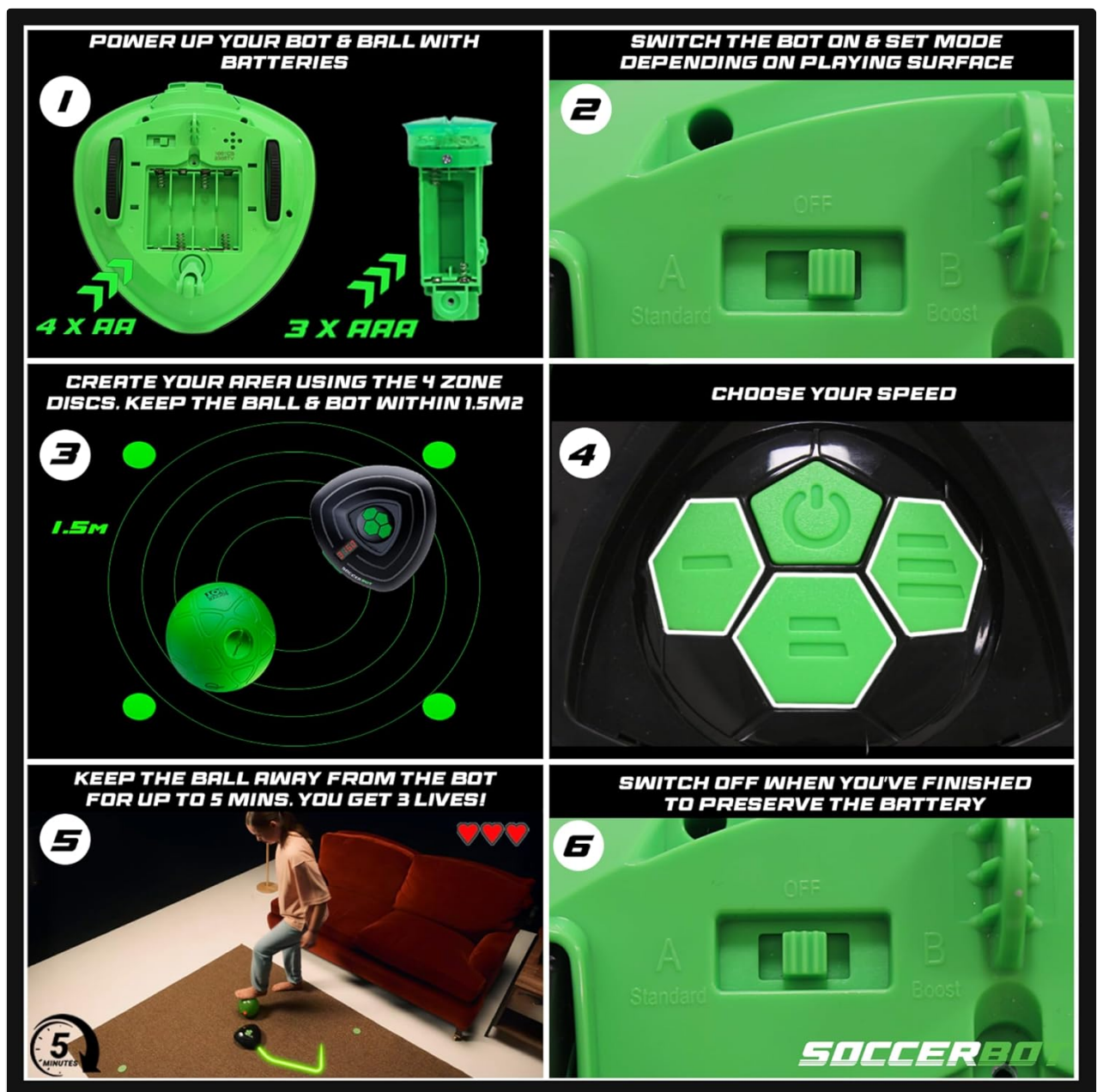

Image: A visual guide detailing the steps from powering on and setting up the play area to engaging in gameplay with the Soccer Bot, emphasizing the time limit and lives system.

Official Product Videos

Your browser does not support the video tag.

Video: A comprehensive overview of the Smart Ball Soccer Bot, demonstrating its features, setup, and various play modes for an engaging indoor soccer experience.

Your browser does not support the video tag.

Video: A detailed product overview of the Soccer Bot, showcasing its design, functionality, and how it helps users improve their soccer skills indoors.

MAINTENANCE

- **Cleaning:** Wipe the Soccer Bot and ball with a dry, soft cloth. Do not use abrasive cleaners or immerse in water.
- **Battery Replacement:** Replace batteries when the unit's performance diminishes or the lights/sounds indicate low power. Refer to the "Battery Installation" section for proper replacement.
- **Storage:** Store the product in a cool, dry place away from direct sunlight when not in use.

TROUBLESHOOTING

Problem	Possible Cause	Solution
Soccer Bot spins in a circle or does not move straight.	Low batteries; Obstruction in wheels; Incorrect surface mode.	Replace all batteries; Check wheels for debris and clean; Ensure correct mode (Standard/Boost) is selected for the playing surface.
Ball does not register with the bot.	Ball or bot out of range; Sensor obstruction; Low ball battery.	Ensure ball and bot are within the 1.5m training area; Check for anything blocking the sensors; Replace ball batteries.
LCD score tracker is not working.	Low batteries; Malfunction.	Replace batteries in the Soccer Bot; If problem persists, contact customer support.

SPECIFICATIONS

Feature	Detail
Product Dimensions	7.48 x 7.48 x 6.5 inches
Item Weight	12.3 ounces
Item Model Number	1001CB
Manufacturer Recommended Age	6 years and up
Batteries Required	4 AA batteries (Bot), 3 AAA batteries (Ball)
Material	Durable PVC and ABS Plastic
Manufacturer	Golden Bear
Country of Origin	China

WARRANTY AND SUPPORT

For warranty information or technical support, please contact the manufacturer, Golden Bear, directly. Refer to the product packaging or their official website for contact details.

Related Documents - 1001CB



[Golden Bear Smart Soccer Bot Indoor Instructions](#)

Official instructions for the Golden Bear Smart Soccer Bot. Learn how to power up, set up the game zone, play the game, and understand the display screen and tips for this interactive indoor soccer toy.

fisher-price



[Fisher-Price HFT70 4-in-1 Game Experience Assembly and User Guide](#)

This guide provides comprehensive instructions for assembling and using the Fisher-Price HFT70 4-in-1 Game Experience. It includes step-by-step assembly, battery installation, mode explanations, and important safety information.



[Madden NFL 19: Official Game Guide and Controls](#)

Explore the features, game modes, controls, player development, and online features of Madden NFL 19 with this comprehensive official guide.



[Electronic Arcade Alley Ball: Setup, Play, and Troubleshooting Guide](#)

Comprehensive instructions for setting up and playing the Electronic Arcade Alley Ball game. Learn about manual mode, launcher mode, 1-player and 2-player modes, battery installation, and troubleshooting common issues.



[LISKA SV-22DF Smartwatch: User Instructions and Features](#)

Comprehensive guide to the LISKA SV-22DF smartwatch, covering app download, charging, pairing, touch screen operation, phone calls, and key features like blood pressure monitoring, SpO2, sleep tracking, and sports modes.

fisher-price



Keep these instructions in future editions, as they contain important information.

GTJ60

[Fisher-Price Learning Bot GTJ60: User Manual, Features, and Play Guide](#)

Explore the Fisher-Price Learning Bot (GTJ60) with this comprehensive guide. Learn about SMART STAGES™, battery replacement, play modes, assembly, tips, and safety. Ideal for toddlers aged 6 months and up.