

GHome Smart K10-01

GHome Smart Door Knob Fingerprint Door Lock User Manual

Model: K10-01 | Brand: GHome Smart

1. INTRODUCTION

The GHome Smart Door Knob Fingerprint Door Lock (K10-01) offers a modern and secure solution for accessing your private spaces. Designed for convenience and peace of mind, this smart lock integrates multiple unlocking methods and smart features to enhance your home or office security.

Key Features:

- **3 Ways to Unlock:** Fingerprint, App control, and Mechanical back-up keys.
- **Smart App Control:** Manage fingerprints (up to 20), lock/unlock remotely (within Bluetooth range), check unlock records, and mute volume.
- **3-Mode Thumb Turn:** Easily switch between Passage mode (always unlocked), Normal Mode (auto-locking in 5s), and Privacy mode (only admin fingerprint/app unlock).
- **Rechargeable Battery:** Built-in 400mAh lithium battery with Type-C charging port. Provides low battery alerts.
- **Easy Installation:** Designed for quick installation with a screwdriver, fitting most US doors (35-55mm thickness).

2. WHAT'S INCLUDED

Your GHome Smart Door Knob package includes the following components:

- GHome Smart Door Knob (Exterior and Interior Knobs)
- Latch Bolt
- Strike Plate

- Mounting Screws
- Mechanical Keys (2)
- USB Type-C Charging Cable
- User Manual



Figure 2.1 : Overview of GHome Smart Door Knob components.

App Smart Control



Figure 2.2: App Smart Control features including App Unlock, User Management, Unlock Records, and Volume Mute.

3. SETUP & INSTALLATION

The GHome Smart Door Knob is designed for easy installation. Follow these steps for a smooth setup:

3.1 Pre-Installation Check

Before beginning installation, ensure your door dimensions are compatible:

- **Door Thickness:** 1 3/8" to 2 1/8" (35mm-55mm)
- **Door Hole Diameter:** 2 1/8" (55mm)
- **Hole Diameter in Door Edge:** 1" (25mm)
- **Backset:** 2 3/4" or 2 3/8" (60mm or 70mm)

Check Size Before Purchase

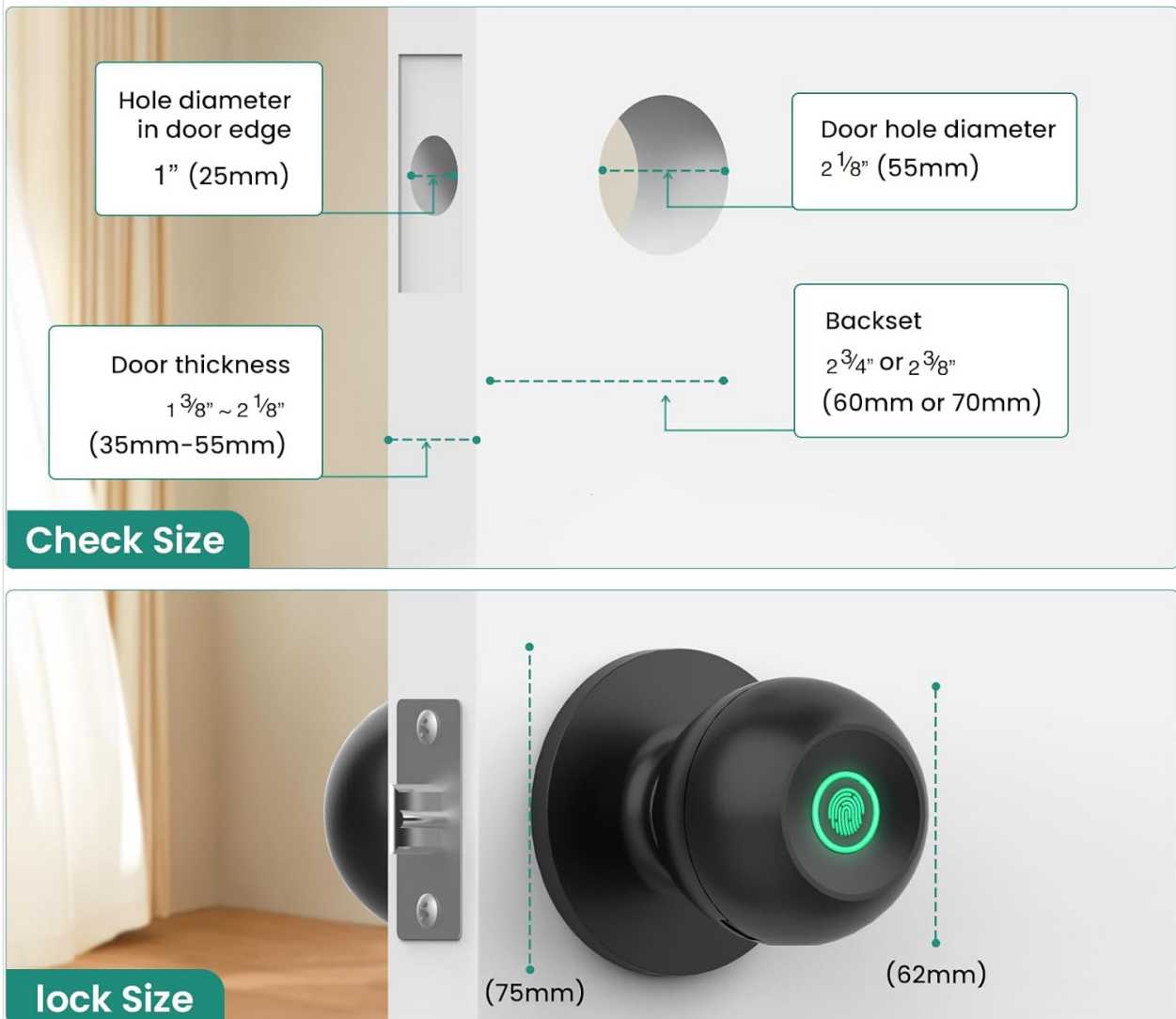

Figure 3.1: Verify your door dimensions before installation.

3.2 Installation Steps

1. Remove your existing door knob.
2. Install the new latch bolt into the door edge.
3. Insert the exterior knob (with fingerprint sensor) through the door hole, ensuring the spindle aligns with the latch bolt.
4. Attach the interior knob, aligning the screws and securing it firmly. Ensure the 'UP' arrow on the interior knob's base is pointing upwards.
5. Test the knob's operation to ensure smooth turning and latch engagement.

Video 3.1: Watch a demonstration of the 3-in-1 Smart Door Knob features and installation overview.

4. OPERATING INSTRUCTIONS

The GHome Smart Door Knob offers multiple convenient ways to unlock and manage access.

4.1 Unlocking Methods

- **Fingerprint Unlock:** Place your registered finger on the sensor. The lock will unlock in less than 0.5 seconds with a 99% recognition rate.
- **App Control Unlock:** Use the dedicated GHome Smart app on your smartphone to unlock the door via Bluetooth connection.
- **Mechanical Key Unlock:** In case of emergency or battery depletion, use the provided mechanical keys to unlock the door.



Figure 4.1: The lock supports fingerprint, app, and mechanical key unlocking.

Biometric Fast-Fingerprint ID Unlock



Figure 4.2: Fast and reliable fingerprint recognition with local data storage.

4.2 Thumb Turn Modes

The interior knob features a 3-in-1 thumb turn to adjust the lock's behavior:

- **Passage Mode:** Rotate the thumb turn to the unlocked position. The door knob will remain unlocked, allowing free entry and exit without requiring a fingerprint or app.
- **Normal Mode (Auto-lock):** Rotate the thumb turn to the auto-lock position. After unlocking with a fingerprint or app, the door will automatically re-lock after 5 seconds.
- **Privacy Mode:** Rotate the thumb turn to the privacy position. The door cannot be opened from the outside, except by an admin's registered fingerprint or via the app (both members and admin can unlock via app).

Energy Conservation



Figure 4.3: Easily switch between Normal, Passage, and Privacy modes.

5. BATTERY & CHARGING

The K10-01 Smart Door Knob is equipped with a built-in 400mAh rechargeable lithium battery.

- **Charging:** The lock features a Type-C port for convenient charging. A full charge typically takes approximately 3 hours.
- **Battery Life:** Battery life varies based on usage frequency. A fully charged battery can support over 10,000 unlocks.
- **Low Battery Alert:** The lock will provide a low battery alarm when power is running low, prompting you to recharge. The app also displays the battery percentage.
- **Emergency Power:** In case the battery completely depletes, you can use the mechanical keys for access or connect a Type-C power source for temporary power to unlock electronically.

3-IN-1 Thumb Turn



**Normal mode
(Auto-lock)**



Passage Mode



Privacy mode



Figure 5.1: The lock features low battery alarm and Type-C emergency charging.

Video 5.1: Learn how to monitor and manage the battery life of your smart door knob using the app.

6. MAINTENANCE

To ensure the longevity and optimal performance of your GHome Smart Door Knob, follow these maintenance guidelines:

- **Cleaning:** Wipe the lock surface with a soft, dry cloth. Avoid using abrasive cleaners or solvents that could damage the finish or electronic components.
- **Battery Care:** Recharge the battery promptly when a low battery alert is received. Avoid completely depleting the battery frequently to prolong its lifespan.
- **Fingerprint Sensor:** Keep the fingerprint sensor clean and dry for accurate recognition.
- **Mechanical Parts:** Periodically check screws and connections to ensure they are secure. Do not over-tighten.

7. TROUBLESHOOTING

If you encounter issues with your GHome Smart Door Knob, refer to the following common problems and solutions:

Problem	Possible Cause	Solution
Fingerprint not recognized consistently.	Fingerprint sensor dirty, finger wet/oily, unregistered fingerprint, environmental factors (cold).	Clean the sensor. Ensure finger is clean and dry. Re-register fingerprint if recognition remains poor. Use mechanical key or app as backup.
App connectivity issues (Bluetooth drops).	Out of Bluetooth range, app permissions, app glitch.	Ensure you are within Bluetooth range. Check app permissions on your phone. Restart the app or phone. Reinstall the app if necessary.
Battery not charging or depleting quickly.	Faulty charging cable/adapter, internal battery issue, high usage frequency.	Try a different Type-C cable and power adapter. Ensure the charging port is clean. If the issue persists, contact customer support.
Knob is physically too big/knuckles hit door frame.	Product design, specific door frame dimensions.	This is a design characteristic. Ensure proper door dimensions were checked prior to purchase. No direct solution for physical size.

8. SPECIFICATIONS

Feature	Detail
Brand	GHome Smart
Model Name	K10-01
Lock Type	Biometric
Special Feature	Fingerprint, Lockable, Auto-Lock
Material	Aluminum
Color	Black
Item Dimensions (L x W x H)	2.28 x 2.87 x 2.95 inches
Item Weight	1.3 Pounds
Connectivity Protocol	Bluetooth
Control Method	App, Hand Control, Mechanical knob
Battery Type	Lithium Polymer (400mAh, included)

Feature	Detail
---------	--------

Door Thickness Compatibility	35-55mm
------------------------------	---------

9. WARRANTY & SUPPORT

GHome Smart is committed to providing excellent customer service. If you encounter any problems with your smart door knob lock, please do not hesitate to contact us.

- **Technical Support:** 24-hour technical support is available via email or phone. Refer to the product packaging or official GHome Smart website for contact details.
 - **Warranty Information:** Specific warranty details are not provided in this manual. Please refer to your purchase documentation or contact GHome Smart customer service for warranty terms and conditions.
-