

[Manuals.plus](#) /

› [CHUANYUE](#) /

› CHUANYUE T2 Motorcycle Bluetooth Headset User Manual

CHUANYUE T2

CHUANYUE T2 Motorcycle Bluetooth Headset User Manual

Model: T2

[Introduction](#)

[What's in the Box](#)

[Installation](#)

[Operation](#)

[Specifications](#)

[Troubleshooting](#)

[Warranty & Support](#)

1. INTRODUCTION

The CHUANYUE T2 Motorcycle Bluetooth Headset is designed to enhance communication and entertainment for motorcycle riders. This device features Bluetooth 5.0 technology, supporting two-rider intercom communication up to 1000 meters, music sharing, DSP and CVC noise cancellation for clear audio, FM radio, and one-click pairing. It is built with an IP67 waterproof rating and utilizes a Type-C charging port for convenience.



Image: Four CHUANYUE T2 Motorcycle Bluetooth Headsets, illustrating the product units.

2. WHAT'S IN THE BOX

Ensure all components are present before installation:

- Mainframe Equipment
- Headset Microphone Sets
- Fixed Installation Bracket
- Sticky Installation Bracket
- Type-C Charging Cable
- User Manual

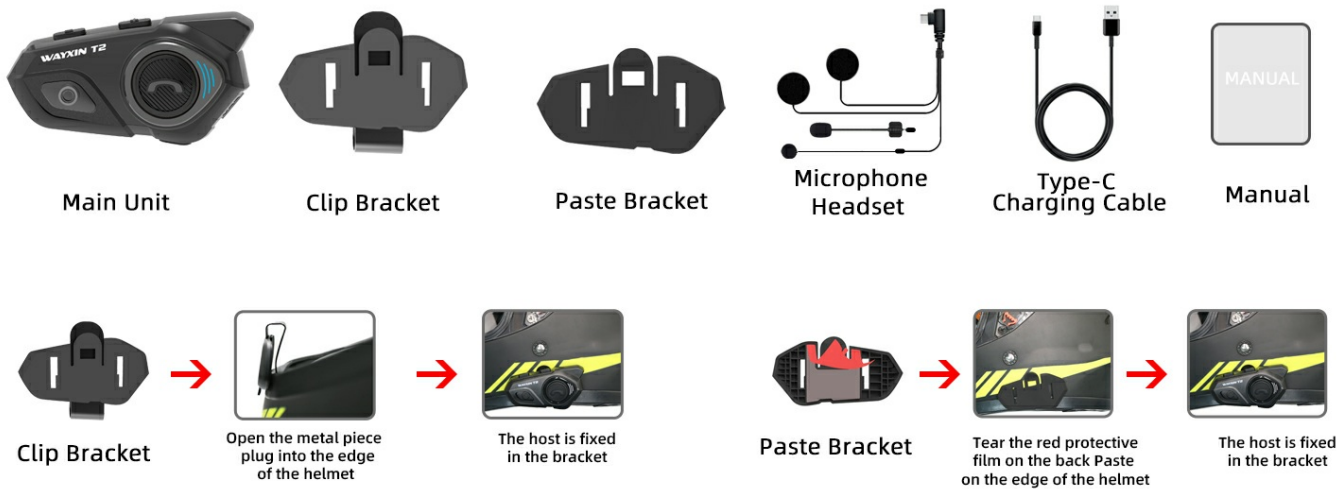

Image: Overview of included components and a visual guide for installing the clip and paste brackets.

3. INSTALLATION

3.1. Headset Unit Installation

1. **Prepare Helmet:** Carefully remove the inner padding of your helmet to access the ear areas.
2. **Speaker Placement:** Attach the headset speakers to the inside of the helmet using the provided adhesive pads. Ensure they are positioned directly over your ears for optimal audio quality. The short line speaker is for the left side, and the long line speaker is for the right side.
3. **Microphone Placement:** Secure the microphone inside the helmet, positioning it close to your mouth but away from direct wind.
4. **Cable Management:** Route all cables neatly under the helmet padding to prevent discomfort and ensure they are not exposed.



Image: A motorcycle helmet with the T2 headset installed, connected to a GPS device, demonstrating integrated use.

3.2. Main Unit Mounting

Choose between the fixed clip bracket or the adhesive paste bracket:

3.2.1. Clip Bracket Installation

1. Open the metal piece of the clip bracket.
2. Slide the bracket onto the edge of the helmet shell, ensuring a secure fit.
3. Insert the main unit into the clip bracket until it locks into place.

3.2.2. Paste Bracket Installation

1. Clean the desired mounting area on the helmet surface thoroughly.
2. Peel off the red protective film from the adhesive on the paste bracket.
3. Firmly press the bracket onto the helmet surface for at least 30 seconds. Allow sufficient time for the adhesive to cure before use.
4. Slide the main unit into the paste bracket until it clicks securely.

4. OPERATING INSTRUCTIONS

4.1. Power On/Off

- **Power On:** Press and hold the multi-function button for approximately 3 seconds until the indicator light illuminates.
- **Power Off:** Press and hold the multi-function button for approximately 3 seconds until the indicator light turns off.

4.2. Bluetooth Pairing with Mobile Device

1. Ensure the T2 headset is powered off.
2. Press and hold the multi-function button for approximately 5-7 seconds until the red and blue indicator lights flash alternately, indicating pairing mode.
3. On your mobile phone, enable Bluetooth and search for available devices.
4. Select "T2" from the list of devices to connect. Once connected, the blue indicator light will flash slowly.

4.3. Intercom Pairing (2 Riders)

1. Ensure both T2 headsets are powered off.
2. On both headsets, press and hold the multi-function button for approximately 5-7 seconds until the red and blue indicator lights flash alternately.
3. On one of the headsets, short press the intercom button. The headsets will search for each other and automatically pair.
4. Once paired, the indicator lights on both headsets will turn solid blue, indicating a successful intercom connection.

2 Riders Communicator Intercomunicador



Image: Two riders on motorcycles, illustrating the two-way intercom communication feature.

4.4. Music Playback and Sharing

- **Play/Pause:** Short press the multi-function button to play or pause music.
- **Next Track:** Rotate the multi-function knob clockwise.
- **Previous Track:** Rotate the multi-function knob counter-clockwise.
- **Volume Adjustment:** Press and hold the volume up/down buttons.
- **Music Sharing:** (Specific instructions for music sharing between two T2 units would be here if available, but are not detailed in the provided data. Generally, this involves a specific button press on both devices after they are paired.)

4.5. Phone Calls

- **Answer Call:** Short press the multi-function button when a call comes in.
- **End Call:** Short press the multi-function button during a call.
- **Reject Call:** Press and hold the multi-function button for 2 seconds when a call comes in.
- **Voice Dial (Siri/Google Assistant):** Long press the multi-function button for 2 seconds to activate your phone's

voice assistant.



Image: A helmet with the T2 headset, showing a smartphone screen with voice assistant commands, highlighting the voice control feature.

4.6. FM Radio

- **Turn On/Off FM:** Double-click the multi-function button to activate or deactivate the FM radio.
- **Change Station:** Rotate the multi-function knob clockwise or counter-clockwise to scan for stations.

5. MAINTENANCE

- **Cleaning:** Use a soft, damp cloth to clean the exterior of the headset. Avoid harsh chemicals or abrasive materials.
- **Water Resistance:** The T2 headset is IP67 waterproof. While it can withstand rain and splashes, avoid submerging it in water for extended periods.
- **Charging:** Use the provided Type-C charging cable. Ensure the charging port is dry before connecting the cable.
- **Storage:** Store the headset in a cool, dry place when not in use.

Waterproof IP67



Image: The T2 headset shown with water splashing, highlighting its IP67 waterproof feature.

6. TROUBLESHOOTING

- **No Power:** Ensure the battery is charged. Connect the headset to the charger and check the indicator light.
- **Cannot Pair:** Make sure the headset is in pairing mode (red and blue lights flashing alternately). Ensure your phone's Bluetooth is on and visible. Try restarting both devices.
- **Intercom Disconnection:** If the intercom disconnects, try re-pairing the units. Ensure they are within the specified range.
- **Poor Audio Quality:** Check speaker placement inside the helmet. Ensure the microphone is not obstructed. Verify that noise cancellation features (DSP & CVC) are active.
- **Voice Assistant Not Responding:** Ensure your phone is connected via Bluetooth and the voice assistant is enabled on your device.

7. SPECIFICATIONS

Feature	Detail
Model Name	T2
Brand	CHUANYUE
Connectivity Technology	Bluetooth, Wireless
Bluetooth Version	5.0
Bluetooth Range	30 Meters (device to phone)
Intercom Range	Up to 1000M (2 riders)
Noise Control	Active Noise Cancellation (DSP & CVC)
Water Resistance Level	IP67 Waterproof
Battery Life	15 Hours (usage)
Charging Time	2.5 Hours
Headphones Jack	Type-C
Material	Acrylonitrile Butadiene Styrene (ABS)
Item Weight	6.7 ounces
Product Dimensions	3.54 x 1.77 x 1.02 inches

8. WARRANTY AND SUPPORT

For warranty information, technical support, or any inquiries regarding your CHUANYUE T2 Motorcycle Bluetooth Headset, please refer to the contact details provided in the packaging or visit the official CHUANYUE website. Keep your purchase receipt for warranty claims.

