

PULITUO DC-51933

PULITUO DC-51933 Cordless Reciprocating Saw Instruction Manual

Model: DC-51933 | Brand: PULITUO

1. INTRODUCTION

Thank you for choosing the PULITUO DC-51933 Cordless Reciprocating Saw. This manual provides essential information for the safe operation, proper maintenance, and effective use of your new tool. Please read these instructions carefully before operating the saw and keep them for future reference.

2. SAFETY INFORMATION

Always follow basic safety precautions to reduce the risk of fire, electric shock, and personal injury. Keep this manual handy for quick reference.

- **Work Area Safety:** Keep the work area clean and well-lit. Cluttered or dark areas invite accidents. Do not operate power tools in explosive atmospheres, such as in the presence of flammable liquids, gases, or dust.
- **Electrical Safety:** Avoid body contact with earthed or grounded surfaces. Do not expose power tools to rain or wet conditions.
- **Personal Safety:** Always wear eye protection, hearing protection, and appropriate work gloves. Dress properly; avoid loose clothing or jewelry. Secure long hair.
- **Tool Use and Care:** Do not force the power tool. Use the correct power tool for your application. Disconnect the battery pack from the power tool before making any adjustments, changing accessories, or storing power tools.
- **Battery Tool Use and Care:** Recharge only with the charger specified by the manufacturer. Use power tools only with specifically designated battery packs.
- **Service:** Have your power tool serviced by a qualified repair person using only identical replacement parts.

Warning: This saw features a double safety switch. Both the protection button and the switch button must be pressed simultaneously for operation to prevent accidental startup.

3. PACKAGE CONTENTS

Verify that all items listed below are included in your package:

- PULITUO Cordless Reciprocating Saw (Model: DC-51933)
- 2 x 2000mAh Li-Ion Batteries (12V)
- 1-Hour Fast Charger
- 1 x Clamp Jaw
- 2 x Metal Cutting Blades
- 2 x Wood Cutting Blades
- 1 x Toolbox
- User Manual

PULITUO Reciprocating Saw Kit



Reciprocating Saw



2 pcs metal cutting blades



2 pcs 2000mAh Lithium Battery & Fast charger



2 pcs wood cutting blades



Extra Gifts

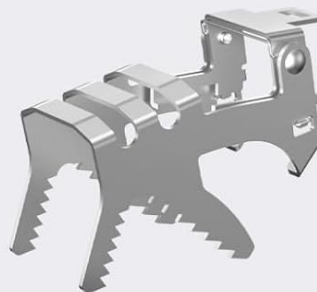

Clamping Jaw



Toolbox

Image 3.1: All components included in the PULITUO Reciprocating Saw Kit.

The image above displays the complete kit, including the saw, two batteries, a charger, various blades, a clamping jaw, and a storage toolbox.

4. SETUP

4.1. Battery Installation and Charging

Ensure the battery is fully charged before first use. The charger is designed for 12V Li-Ion batteries.

1. Insert the battery into the charger. The indicator light on the charger will show charging status.
2. Once fully charged, remove the battery from the charger.
3. Align the charged battery with the base of the saw handle and slide it in until it clicks securely into place.
4. To remove the battery, press the release button on the battery and slide it out.



Image 4.1: The saw features a battery indicator to show remaining power and a safety switch.

The saw is equipped with a built-in battery indicator to display the remaining power level.

4.2. Blade Installation and Removal (Tool-Free)

The PULITUO reciprocating saw features a tool-free blade change system for quick and easy blade replacement.

1. To install a blade, turn the locking sleeve counter-clockwise (approximately 90 degrees) and hold it.
2. Push the saw blade into the saw blade holder until it is fully seated.
3. Release the locking sleeve. The blade is now fixed.
4. To remove a blade, repeat step 1, then pull the blade out.



Image 4.2: Turn the locking sleeve counter-clockwise to open the blade holder.



Image 4.3: Insert the saw blade into the holder and release the sleeve to secure.

4.3. Clamping Jaw Installation and Removal

The clamping jaw provides stability when cutting branches or other materials.

1. If you need to use the clamping jaw, install it before attaching the saw blade.
2. Tilt the claw about 45 degrees into the front of the machine.
3. Push it into the shield slot.
4. Press the lock button to clamp the jaw tightly.
5. To remove the claw, press the button and pull it out.



Image 4.4: The clamping jaw attaches to the front of the saw for improved stability during cuts.

5. OPERATING INSTRUCTIONS

5.1. Powering On/Off and Variable Speed

The saw is equipped with a double safety switch and a variable speed trigger.

1. To start the saw, press the protection button (safety switch) and then simultaneously press the main trigger switch.
2. The saw features a variable speed trigger, allowing you to control the cutting speed from 0 to 3000 RPMs by varying the pressure on the trigger.
3. Release the trigger to stop the saw.



Image 5.1: The saw includes a security lock and a tool-free blade change system.

The double swing structure design significantly reduces vibration during operation, enhancing user control.

5.2. Cutting Techniques

Select the appropriate blade for the material you are cutting (wood or metal blades are included).

- **General Cutting:** Ensure the workpiece is securely clamped. Hold the saw firmly with both hands, or one hand if using the clamping jaw for stability.
- **Wood Cutting:** Use wood-specific blades. The saw is suitable for pruning branches and cutting various wood types.
- **Metal Cutting:** Use metal-specific blades. The saw can cut aluminum pipes and other metal materials.
- **PVC Cutting:** Use appropriate blades for plastic. The saw is effective for cutting PVC pipes.



Image 5.2: The saw is versatile for cutting wood, metal, PVC pipes, and branches.

The compact and lightweight design (2.3 pounds without battery) allows for easy one-handed operation in many situations.

5.3. Product Features Overview

3500SPM

POWERFUL DURABLE MOTOR



Image 5.3: The saw features a powerful 3500 SPM motor, designed for low noise, long life, and smooth operation.

The saw is equipped with a powerful motor capable of up to 3500 strokes per minute (SPM), ensuring efficient cutting with low noise and smooth operation.



Image 5.4: The lightweight and convenient design of the saw allows for easy handling and reduced fatigue.

The ergonomic design with a soft rubber handle improves grip and reduces visual fatigue during extended use.

5.4. Working Principle

This video demonstrates the internal working principle of the reciprocating saw, highlighting how the double swing bars counteract vibration for smoother operation.

Video 5.1: PULITUO Reciprocating Saw Working Principle. This video illustrates the internal mechanics of the saw, specifically the double swing structure that minimizes vibration during use.

6. MAINTENANCE

Regular maintenance ensures the longevity and optimal performance of your reciprocating saw.

- **Cleaning:** After each use, clean the saw body and blades with a dry cloth. Remove any sawdust or debris from the ventilation openings.

- **Blade Care:** Inspect blades for wear or damage. Replace dull or bent blades immediately to ensure efficient and safe cutting.
- **Battery Care:** Store batteries in a cool, dry place away from direct sunlight. Do not store batteries in a discharged state for extended periods.
- **Storage:** Store the saw and its accessories in the provided toolbox in a dry, secure location out of reach of children.

7. TROUBLESHOOTING

| Problem | Possible Cause | Solution |
|-----------------------------|---|--|
| Saw does not start | Battery not charged or improperly installed; Safety switch not engaged. | Ensure battery is charged and correctly inserted. Press both the protection button and trigger simultaneously. |
| Reduced cutting performance | Dull or incorrect blade for material; Low battery charge. | Replace blade with a sharp, appropriate one. Recharge battery. |
| Excessive vibration | Loose blade; Improper cutting technique. | Ensure blade is securely installed. Adjust cutting angle and pressure. |
| Battery not charging | Charger not plugged in; Faulty battery or charger. | Check power connection. Test with another battery/charger if available. Contact support if issue persists. |

8. SPECIFICATIONS

| Feature | Specification |
|-----------------------------|---|
| Brand | PULITUO |
| Model Number | DC-51933 |
| Power Source | Battery Powered |
| Voltage | 12 Volts |
| Wattage | 240.00 W |
| No-Load Speed | 0-3000 RPM |
| Item Weight | 2.3 Pounds (without battery) |
| Item Dimensions (L x W x H) | 11"L x 4"W x 13"H |
| Blade Material | High Carbon Steel |
| Handle Material | Rubber |
| Included Components | Batteries, Battery Charger, Blades, Clamp Jaw, Case |

9. WARRANTY AND SUPPORT

For warranty information or technical support, please refer to the contact details provided in your product packaging or visit the official PULITUO website. Keep your purchase receipt as proof of purchase.

