

FIREHOFF Nouveau Modele

FIREHOFF Pellet Stove Igniter - Instruction Manual

Model: Nouveau Modele

INTRODUCTION

This manual provides essential information for the safe and effective installation, operation, and maintenance of your FIREHOFF Pellet Stove Igniter. Please read these instructions carefully before use and retain them for future reference.

SAFETY INFORMATION

Your safety is paramount. Please observe all warnings and precautions.

WARNINGS:

- **High-Temperature Electric Heating Element:** This igniter reaches temperatures up to 860 °C (1580 °F). Direct contact can cause severe burns.
- **Electrical Shock Hazard:** Any contact with live electrical connections can result in electric shock. Ensure power is disconnected before handling.
- **Fire Hazard:** Proximity to flammable materials (paper, fabrics, liquids) can cause a fire. Maintain adequate clearance.

PRECAUTIONS:

1. Handle, connect, or install the igniter only when the appliance is completely disconnected from the power supply.
2. Allow the igniter to cool down completely before attempting any intervention or removal.
3. Wear insulating gloves and, if necessary, protective eyewear to prevent injuries during installation or maintenance.
4. Do not modify the igniter or its electrical connections. Unauthorized modifications can compromise safety and void the warranty.
5. Use appropriate tools for installation and removal to avoid damaging the components.

Istruzioni per l'uso

INSTALLAZIONE:

1. Spegnerne l'alimentazione elettrica della stufa prima di qualsiasi operazione.
2. Rimuovere con cautela la resistenza difettosa.
3. Installare la nuova resistenza assicurandosi che sia ben avvitata.
4. Ricollegare e verificare i collegamenti elettrici.
5. Riaccendere l'apparecchio per verificare il corretto funzionamento.

Consigli di sicurezza

ATTENZIONE:

- Resistenza elettrica riscaldante ad alta temperatura (fino a 850 °C).
Può causare ustioni gravi in caso di contatto diretto.
- Rischio elettrico: qualsiasi contatto con collegamenti sotto tensione può provocare una scossa elettrica.
- Rischio di incendio: la vicinanza a materiali infiammabili (carta, tessuti, liquidi) può causare un incendio.

PRECAUZIONI:

1. Manipolare, collegare o installare solo quando l'apparecchio è scollegato dall'alimentazione.
2. Attendere che la resistenza si raffreddi completamente prima di intervenire.
3. Indossare guanti isolanti e, se necessario, occhiali protettivi per evitare lesioni.
4. Non modificare la resistenza o i collegamenti elettrici per garantire la sicurezza e preservare la garanzia.
5. Utilizzare strumenti appropriati per evitare di danneggiare i componenti.

Image: Detailed instructions for use and safety advice, highlighting warnings and precautions.

PRODUCT OVERVIEW & FEATURES

The FIREHOFF Pellet Stove Igniter is designed for reliable and efficient pellet ignition.

- **High-Quality Materials:** Constructed with specialized materials such as Incoloy800, magnesium powder, and brass for enhanced durability and resistance.
- **Professional Quality:** Manufactured to high standards with precise dimensions, ensuring it functions as a reliable replacement part.
- **Fast Heating:** This igniter cartridge provides rapid and consistent heating, reaching temperatures up to 860 °C for quick pellet ignition.



Flangia di montaggio in ottone:

Filettatura 3/8,
Il montaggio avviene con
una chiave da 17 mm.

Riscaldamento rapido:

Raggiunge fino a 860 °C e
accende i pellet in modo
rapido e uniforme.

Tubo in Incoloy 800:

Questa lega ferro-nichel-cromo
offre un'eccellente resistenza
all'ossidazione e alla carburazione
ad alta temperatura.

Elemento riscaldante Cr20Ni80:

La resistenza è immersa in
polvere di magnesio per
una migliore conduzione
del calore.

Image: Exploded view illustrating the igniter's components, including the brass mounting flange, Incoloy 800 tube, and Cr20Ni80 heating element.

TECHNICAL SPECIFICATIONS

Feature	Specification
Power	280 W
Voltage	230 V
Total Length	150 mm
Length Under Nut	140 mm
Diameter	9.9 mm
Thread	3/8 inch
Wire Length	500 mm
Male Terminal Width	6.3 mm
Weight	90 g
Product Dimensions	16 x 2 x 2 cm
Model Number	Nouveau Modele

Dettagli tecnici:

Potenza: **280 W**

Tensione: **230V**

Diametro: **9,9 mm**

Filettatura della flangia: **3/8 di pollice**

Lunghezza totale: **150 mm**

Lunghezza sotto dado: **140 mm**

Lunghezza dei fili: **500 mm**

Larghezza dei terminali maschi: **6,3 mm**



Image: Visual representation of the igniter with key technical specifications and dimensions.

Realizzato su misura per le vostre esigenze

Dimensioni precise per la massima
affidabilità e prestazioni

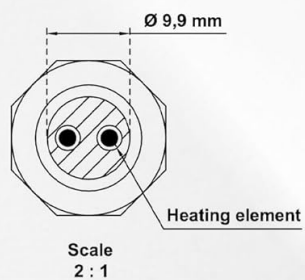
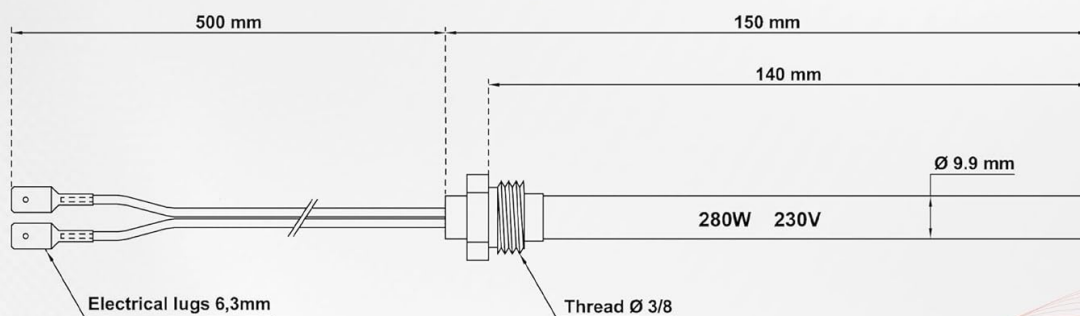

Pellet stove igniter 230V 280W $\varnothing 9,9$ mm 150mm 3/8	
FIREHOFF	CE

Image: Technical drawing showing precise dimensions including total length, length under nut, diameter, and thread size.

COMPATIBILITY

This igniter is compatible with various pellet stove models. Please refer to the image below for a detailed list of compatible brands and models.

Compatible con :

INTERSTOVES

Marina

INVICTA

Serino 7

JOLLY MEC

EKO+

FREEPOINT

Alessia, Confort, Easy, Elan, Gioia, Glass, Globe, Joy, Kami, Mary, Milka, Miriam, Pretty

KAUSIFLAM

XUO, Bacara, Ambre, Agate, Camilla, Lea, Kara, Diana, Nacre, Jade, Kefren, Quadra, Small, Baya, Wind, Topaze, Gaia, Keops, Rubis, Laura, Gaya, Xuoest, Rubie

MCZ

Athos, Face, Flair, Flat, Flux, Gea, Kaika, Mercury 6kW / 8kW, Nova, Omega, Planet, Polar, Swing

PIAZZETTA

P944, P950, P955, P956, P957, P958, P959, P960, P961, P962, P963, P964, Stubotto-04

SKIA DESIGN

Fusion, Eclypse, Smart, Tower

RED

Compact 18 / 24 / 35, Compact Easy Clean 18 / 24 / 35, Compact Slim 15 / 15 High Efficiency, Lotus Dalia Air, Dalia Air 2014, Dalia Oyster Air, Edera Multi Air, Dalia, Edera MULTIAIR, Oyster Air 2025

SUPERIOR

Cléo, Gioia, Lia, Lisa, Maira, Marcella, Mia, Milly, Mina, Monia, Monica, Sabrina, Solange

Image: A comprehensive chart listing compatible pellet stove brands such as INTERSTOVES, INVICTA, JOLLY MEC, FREEPOINT, KAUSIFLAM, MCZ, PIAZZETTA, SKIA DESIGN, RED, and SUPERIOR, along with specific models for each brand.

INSTALLATION GUIDE

Follow these steps for proper installation of the igniter. Always prioritize safety by following the precautions listed above.

- 1. Disconnect Power:** Turn off the electrical power supply to the pellet stove at the main breaker before beginning any work.
- 2. Remove Old Igniter:** Carefully remove the defective or old igniter from its housing. Note its orientation and connections.
- 3. Install New Igniter:** Insert the new igniter into the designated slot. Ensure it is securely screwed in or fastened according to your stove's design.
- 4. Reconnect Electrical:** Reconnect the electrical wires. The igniter is supplied with 2 quick connectors for ease of installation. Verify all connections are secure and correct.
- 5. Test Operation:** Restore power to the stove and restart the appliance to verify the correct functioning of the new igniter.

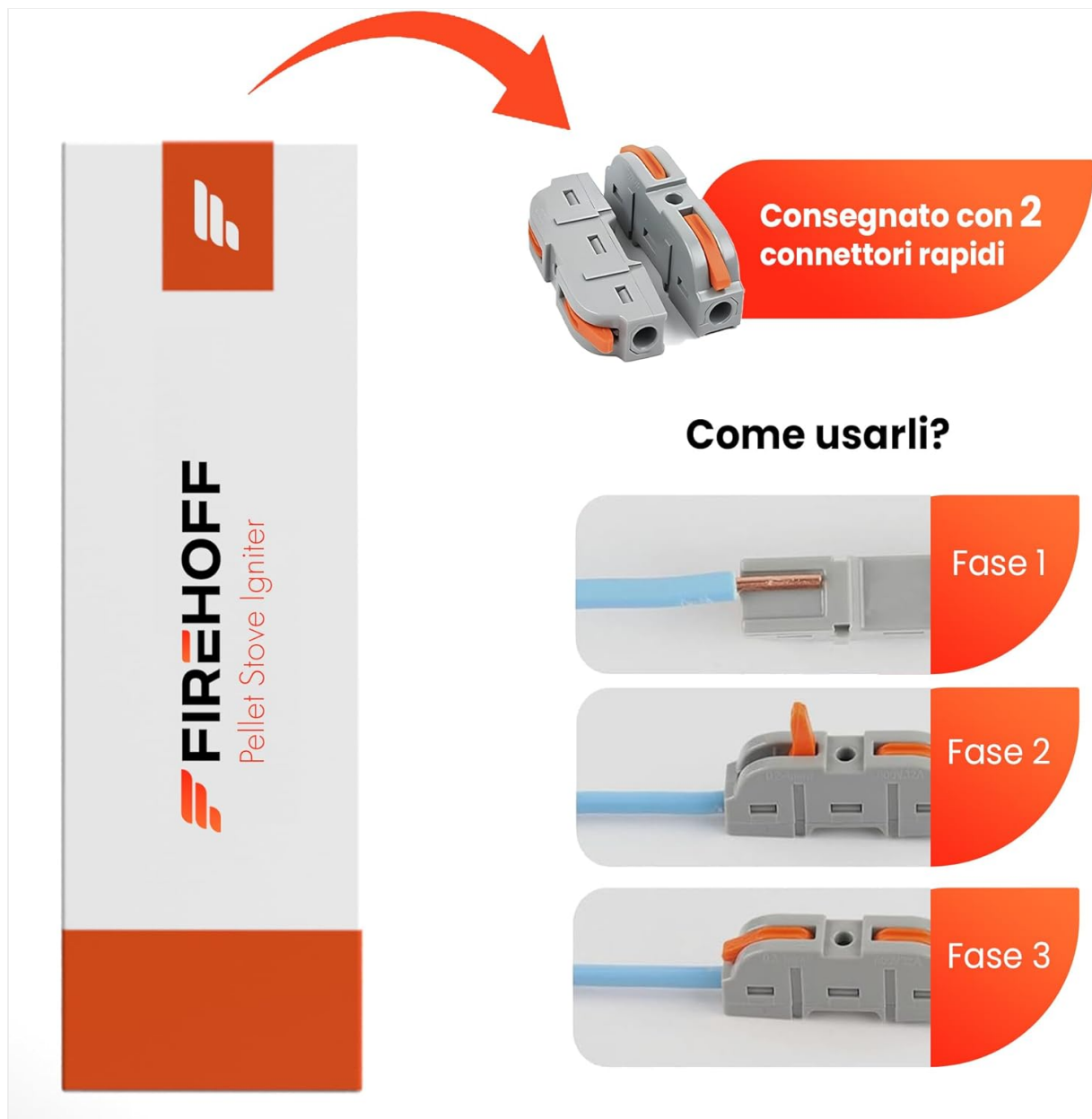

Image: Visual guide demonstrating the three steps to properly use the included quick connectors for electrical wiring.

OPERATING INSTRUCTIONS

The FIREHOFF Pellet Stove Igniter operates automatically as part of your stove's ignition sequence. Once installed, its function is to heat rapidly and ignite the pellets when the stove is started.

- Ensure your pellet stove is loaded with appropriate pellets.
- Initiate the stove's start-up sequence according to your stove manufacturer's instructions.
- The igniter will heat up, bringing the pellets to combustion temperature.
- Once ignition is confirmed, the igniter will typically switch off, and the stove will continue its normal operation.

MAINTENANCE

Regular maintenance of your pellet stove, including the igniter, can extend its lifespan and ensure efficient operation.

- **Inspection:** Periodically inspect the igniter for any signs of wear, damage, or excessive carbon buildup. Always ensure the stove is cold and disconnected from power before inspection.

- **Cleaning:** If carbon buildup is observed, gently clean the igniter surface with a soft brush. Avoid using abrasive materials or harsh chemicals that could damage the element.
- **Electrical Connections:** Check electrical connections for tightness and corrosion during routine stove maintenance.
- **Replacement:** The igniter is a consumable part. Replace it if it fails to heat or ignite pellets reliably, or if physical damage is evident.

TROUBLESHOOTING

If your pellet stove is not igniting, consider the following common issues related to the igniter:

- **No Ignition:** If the stove attempts to start but pellets do not ignite, the igniter may be faulty or not receiving power.
- **Check Power:** Ensure the stove has power and the igniter's electrical connections are secure.
- **Igniter Not Heating:** If the igniter remains cold during the start-up cycle, it may have failed and requires replacement.
- **Pellet Feed Issues:** Ensure pellets are feeding correctly into the burn pot. An igniter cannot work if there are no pellets to ignite.
- **Stove Error Codes:** Consult your pellet stove's manual for specific error codes related to ignition failure.

If troubleshooting steps do not resolve the issue, contact qualified service personnel or customer support.

WARRANTY INFORMATION

The FIREHOFF Pellet Stove Igniter comes with a **1-year warranty** from the date of purchase. This warranty covers defects in materials and workmanship under normal use.

The warranty does not cover damage resulting from improper installation, misuse, unauthorized modifications, accidents, or normal wear and tear. Please retain your proof of purchase for warranty claims.

CUSTOMER SUPPORT

For technical assistance, warranty claims, or any questions regarding your FIREHOFF Pellet Stove Igniter, please contact our customer support team.

Email: support@firehoff.com

Website: www.firehoff.com

When contacting support, please have your product model number (Nouveau Modele) and purchase date available.