



Manuals.plus /

› VEVOR /

› VEVOR Come Along Winch User Manual

## VEVOR 5 Ton

# VEVOR Come Along Winch User Manual

Model: 5 Ton

## INTRODUCTION

---

This user manual provides essential information for the safe and effective operation, maintenance, and troubleshooting of your VEVOR 5 Ton Come Along Winch. Please read this manual thoroughly before using the product to ensure proper handling and to prevent injury or damage.

## SAFETY INFORMATION

---

Always prioritize safety when operating heavy-duty equipment. Failure to follow these instructions may result in serious injury or property damage.

- Ensure the winch's load capacity is suitable for the task. Do not exceed the 11,023 lbs (5 Ton) pulling capacity.
- Inspect the winch, cable, and hooks for any signs of wear, damage, or corrosion before each use. Do not use if damaged.
- Wear appropriate personal protective equipment (PPE), including gloves and eye protection.
- Keep hands and body clear of the cable, hooks, and moving parts during operation.
- Ensure the load is securely attached and balanced before applying tension.
- Avoid sudden jerking motions. Apply tension smoothly and gradually.
- Do not use the winch for lifting people or as a primary lifting device where overhead lifting is required.
- Store the winch in a dry, clean place away from direct sunlight and moisture.

## PRODUCT FEATURES

---

- **5 Ton Load Capacity:** Designed for secure and powerful pulling actions up to 11,023 lbs (5 Ton), suitable for vehicle rescue, material handling, tree stump removal, and furniture transport.
- **11.5 ft Steel Cable:** Features a durable 11.5 ft steel cable, allowing for versatile use in single or double rope modes. The cable is designed to be non-tangling, non-loosening, tensile-resistant, and anti-twisting.
- **Integrated Dual-Gear Structure:** Equipped with a one-piece dual-gear mechanism for smooth, jam-free operation and enhanced durability, preventing common issues like foreign objects jamming in gaps or rust.

- **Anti-Reverse Mechanism & Spring Latches:** Incorporates an anti-reverse mechanism to prevent cable slip-ups and ensure stability. Hooks are fitted with built-in spring latches for secure attachment.
- **Extended Handle for Easy Operation:** Features a 20-inch extended non-slip handle with a rubberized grip, designed for comfortable and secure one-hand operation, making pulling tasks easier.

## WHAT'S IN THE BOX

---

- 1 x VEVOR 5 Ton Power Puller
- 1 x User Manual (this document)

## SETUP

---

Before initial use, familiarize yourself with the components of the VEVOR Come Along Winch.



Figure 1: VEVOR 5 Ton Come Along Winch. This image shows the complete winch assembly, including the main body, extended handle, steel cable, and two hooks, ready for use.

1. **Unpack:** Carefully remove the winch and all accessories from the packaging.
2. **Inspect:** Check for any visible damage from shipping. Ensure all parts listed in "What's in the Box" are present.
3. **Cable Readiness:** The steel cable comes pre-installed. Ensure it is not tangled or kinked.

## OPERATING INSTRUCTIONS

---

Follow these steps for safe and effective operation of your VEVOR Come Along Winch.

### Choosing Rope Mode (Single vs. Dual)

The winch can be used in two configurations depending on the required pulling force and distance.



Figure 2: Single/Dual Rope Switching. This diagram illustrates how to configure the winch for either single rope mode (longer reach, standard pulling force) or dual rope mode (shorter reach, stronger pulling force).

- **Single Rope Mode (2.3-11.8 ft span):** Provides the maximum cable length for longer pulls. Attach one hook to the anchor point and the other hook directly to the load.
- **Dual Rope Mode (2.3-6.6 ft span):** Provides increased pulling force by creating a mechanical advantage. Attach one hook to the anchor point, loop the cable through the pulley on the other hook, and then attach the second hook to the load. This effectively halves the cable length but doubles the pulling power.

### General Operation Steps

# EFFORTLESSLY TIGHTEN STEEL WIRE

20" extended non-slip handle for easier operation



1 Release the spring latch lock



2 Lift the handle

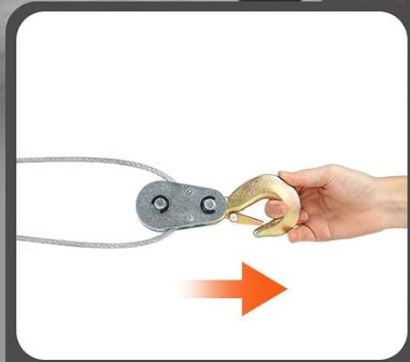

3 Pull out the steel cable to the desired length



4 Lock with the spring latch



5 Swing the handle back and forth to tighten the line

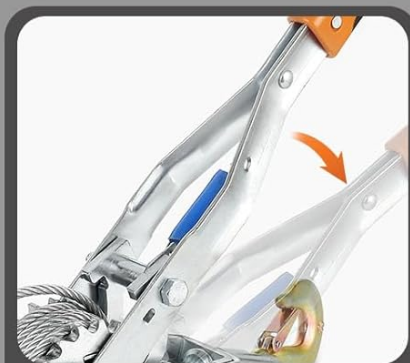

6 Lift the handle upwards to release the handle load

Figure 3: Effortlessly Tighten Steel Wire. This visual guide demonstrates the six key steps for operating the winch, from releasing the latch to tightening the line and releasing the load.

1. **Release Spring Latch Lock:** Locate the spring latch lock on the winch mechanism. Press or pull it to disengage the locking mechanism, allowing the cable to be freely extended.
2. **Lift the Handle:** Lift the main operating handle upwards to further disengage the internal gears for cable release.
3. **Pull Out Steel Cable:** Manually pull the steel cable out to the desired length, ensuring there is enough slack to connect to both the anchor point and the load.
4. **Lock with Spring Latch:** Once the cable is extended to the correct length and hooks are attached, ensure the spring latch is engaged to secure the cable.
5. **Swing Handle Back and Forth:** With the handle in the operating position, swing it back and forth in a pumping motion. This action engages the dual-gear mechanism to progressively tighten the line and pull the load.
6. **Lift Handle Upwards to Release Load:** To release tension or the load, lift the handle upwards. This disengages the gears, allowing the cable to retract slowly. Always maintain control during release.

# ANTI-REVERSE & ANTI-LOOSENING

Safer and more secure towing



Figure 4: Anti-Reverse & Anti-Loosening Features. This image highlights the gear with brake device, thickened embedded tongue hook, and quick-locking spring switch, all contributing to safer and more secure towing operations.

## MAINTENANCE

Regular maintenance ensures the longevity and safe operation of your VEVOR Come Along Winch.

- **Cleaning:** After each use, clean the winch to remove dirt, mud, and debris. Use a damp cloth and mild detergent if necessary. Dry thoroughly.
- **Lubrication:** Periodically apply a light lubricant to the moving parts, such as the gears and pawls, to ensure smooth operation and prevent rust.
- **Inspection:** Regularly inspect the steel cable for fraying, kinks, or broken strands. Check hooks for deformation or damage to the spring latches. Inspect the main body for cracks or bends.
- **Storage:** Store the winch in a dry, cool place, protected from direct sunlight and extreme temperatures. Coil the cable neatly to prevent tangles.

## TROUBLESHOOTING

This section addresses common issues you might encounter with your winch.

Problem	Possible Cause	Solution
Cable not extending/retracting smoothly.	Cable is tangled, kinked, or dirty. Gears are dry or obstructed.	Untangle/straighten cable. Clean and lubricate gears. Ensure spring latch is fully disengaged.
Winch slips under load.	Overload. Pawls not engaging properly.	Reduce load to within capacity. Inspect pawls for wear or obstruction; clean and lubricate.
Handle is difficult to operate.	Lack of lubrication. Mechanism is dirty.	Clean and lubricate all moving parts.

## SPECIFICATIONS

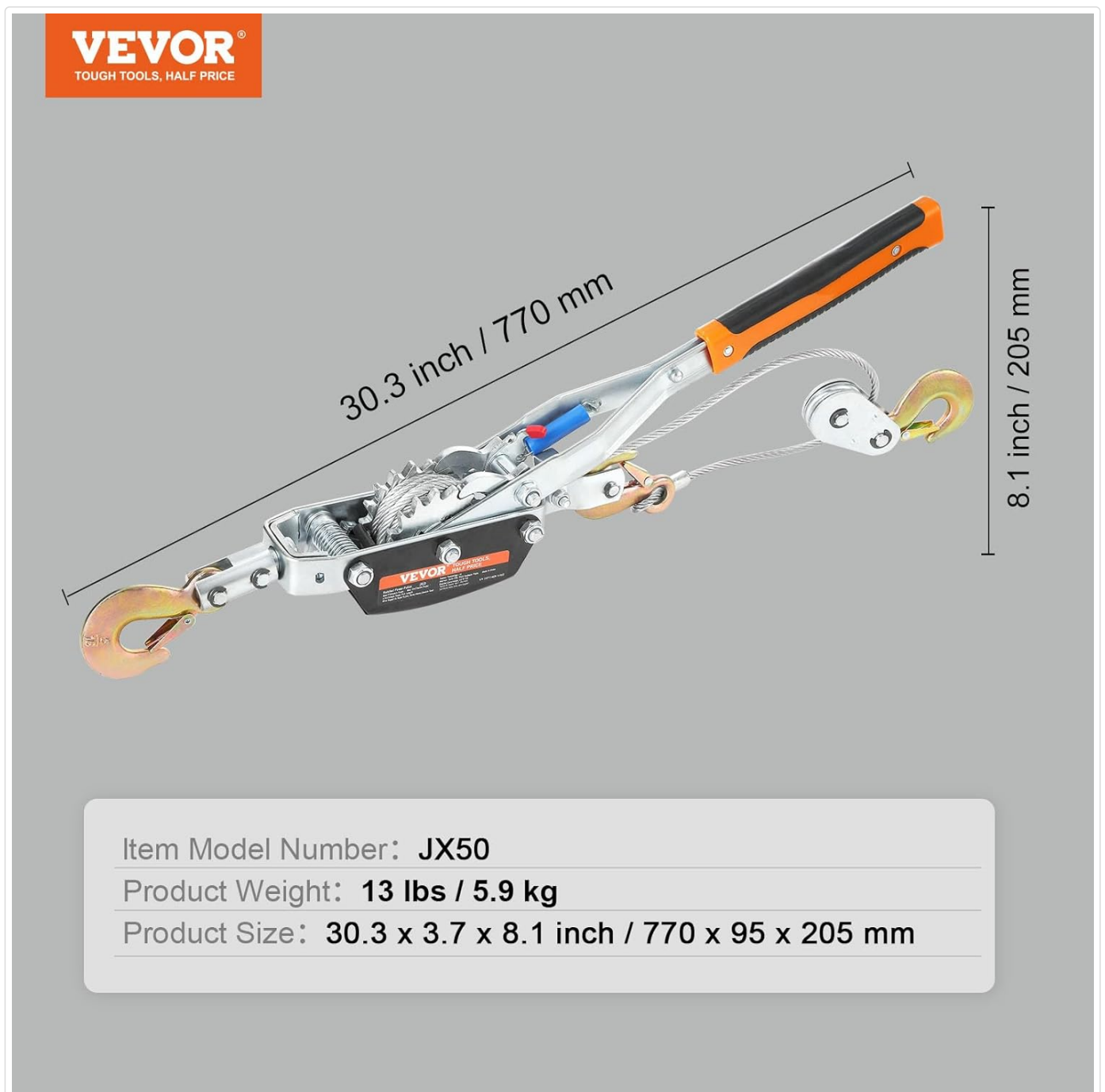

Figure 5: Product Dimensions and Weight. This image provides a visual representation of the winch's physical size and its overall weight.

- **Model Number:** JX50 (5 Ton)
- **Pulling Capacity:** 5 Ton (11,023 lbs)
- **Cable Length:** 11.5 ft (Steel Cable)
- **Product Dimensions:** 30.31 x 3.74 x 8.07 inches (770 x 95 x 205 mm)
- **Product Weight:** 13.01 lbs (5.9 kg)
- **Manufacturer:** VEVOR

## WARRANTY & SUPPORT

---

VEVOR products are designed for durability and performance. For warranty information, technical support, or to purchase replacement parts, please visit the official VEVOR website or contact their customer service department.

You can also refer to the official User Manual PDF for more detailed information. [VEVOR Come Along Winch User Manual \(PDF\)](#)