



[Manuals.plus](#) /

› [DEPSTECH](#) /

› DEPSTECH Endoscope Camera User Manual

DEPSTECH NTC53Y

DEPSTECH Endoscope Camera User Manual

Model: NTC53Y | Brand: DEPSTECH

1. PRODUCT OVERVIEW

The DEPSTECH NTC53 Endoscope Camera is a versatile inspection tool designed for iOS 12.0+ devices. It features a slim 7mm probe, Bluart 3.0 technology for enhanced image clarity, and adjustable LED lights for optimal visibility in various environments. Its 16.4ft semi-rigid cable and IP67 waterproof rating make it suitable for inspecting hard-to-reach and wet areas. This manual provides detailed instructions for setup, operation, and maintenance.



Figure 1: DEPSTECH NTC53 Endoscope Camera connected to an iPhone.

Key Features:

- **Revolutionary Illumination & Bluart 3.0 Tech:** Experience unparalleled clarity with Bluart 3.0 tech, featuring six adjustable LED lights, ensuring optimal visibility in various environments. Enjoy a wide FOV 80° field of view for exceptional image quality, enhancing your inspection precision.
- **Capture and Record Details:** With a 90° flip button, and a wide FOV 80° field of view, this NTC53 borescope camera is perfect for capturing the most critical details every time. Easily capture high-resolution images and videos to analyze and share your findings, perfect for documenting repairs or assessments.
- **Swift Performance & Durable:** Powered by the fifth-generation chipset, this endoscope camera delivers lightning-fast processing. Featuring a 16.4ft semi-rigid cable and IP67 waterproof, it can withstand wet conditions and rugged environments, making it an indispensable tool for mechanics, technicians, and DIYers.
- **Broad Compatibility & Versatile:** With a slender 7mm probe, our snake camera navigates tight spaces effortlessly, offering unparalleled access for inspections. Compatible with iOS 12.0+ iPhone and iPad (Except for iPhones 15 series with type-c interface), simply download the "DEPSTECHCAM" app for easy and intuitive connectivity. Ideal for beginners and experts alike. (Note: this usb borescope cannot be connected to android phone using an adapter. It is not compatible with android phone.)
- **User-Focused Design:** Manual focus 0.79 to 3.93 inches empower you to customize view, ensuring nothing escapes your inspection. The borescope cable connected to the phone port uses 0.65ft soft wire,

which can prevent tilting caused by pulling and protect your phones. Accessories like hooks and magnets are included, making it a comprehensive gadget for all inspection needs.

2. PACKAGE CONTENTS

Please check the package contents upon unboxing to ensure all items are present and undamaged.



Figure 2: Contents of the DEPSTECH NTC53 package.

Included Items:

- DEPSTECH NTC53 Endoscope Camera (with 16.4ft semi-rigid cable and Lightning connector)
- User Manual
- Accessory Kit (includes hook and magnet attachments)



Figure 3: Endoscope probe with magnet and hook accessories.

3. SETUP GUIDE

3.1 Compatibility

The DEPSTECH NTC53 Endoscope Camera is designed exclusively for iOS devices. It is compatible with iPhones and iPads running iOS 12.0 and above. Please note that it is **not compatible** with iPhone 15 series (due to Type-C interface) or any Android devices, even with an adapter.

Only Compatible with IOS Devices



iPhone ios 12.0+



iPad ios 12.0+



NOTE: **Except for the iPhone 15 series.** This USB endoscope is not compatible with Android phones. It cannot connect to Android phones using an adapter.

Figure 4: Compatibility overview for DEPSTECH NTC53.

3.2 App Download and Installation

To use the endoscope camera, you need to download the official "DEPSTECHCAM" app from the Apple App Store.

1. **Method 1 (Recommended):** Scan the QR code provided in the user manual or on the product packaging to directly download the app.
2. **Method 2:** Open the App Store on your iOS device, search for "DEPSTECHCAM", and download the app.



Figure 5: App download guidance and initial connection.

3.3 Connecting the Endoscope

1. Ensure the "DEPSTEHCAM" app is installed on your iOS device.
2. Plug the Lightning connector of the endoscope cable directly into your iPhone or iPad's charging port.
3. Upon first connection, your device may prompt you to download the app if not already installed, or to allow access to photos and videos. Grant the necessary permissions for full functionality.
4. Open the "DEPSTEHCAM" app. The live view from the endoscope camera should appear on your screen.

Video 1: Demonstrates the compatibility and connection process for the NTC53 endoscope with iOS devices. This video highlights common issues related to USB borescope compatibility.

Video 2: Addresses a frequently asked question regarding saving photos and videos within the DEPSTEHCAM app, providing solutions for potential issues.

4. OPERATING INSTRUCTIONS

4.1 Understanding the Controls

The endoscope features an in-line control unit with a brightness adjustment knob for the LED lights and a soft cable section near the connector to prevent tilting.

Ease of use, Superior imagery



Plug and Play



7mm Probe



No Charging



No Need Wifi



Figure 6: Detailed view of the endoscope cable and control unit.

4.2 Adjusting Illumination and Image Clarity

The endoscope is equipped with six adjustable LED lights and Bluart 3.0 technology to provide clear images even in dark or confined spaces. Use the brightness adjustment knob on the control unit to increase or decrease the light intensity as needed for optimal viewing.

Advanced 5th Gen Chip

200%
FASTER

DEPSTECH

Other Brand



30FPS



FHD Pixel



Photo & Video

Figure 7: Adjustable LED lights for enhanced visibility.



Figure 8: Bluart 3.0 technology for superior image quality.

4.3 Using the DEPSTECHCAM App

The app provides a user-friendly interface for controlling the endoscope and managing captured media.



Figure 9: DEPSTECHCAM app interface and functions.

- **Live View:** Once connected, the app displays a real-time video feed from the endoscope.
- **Photo/Video Capture:** Use the dedicated buttons within the app to take high-resolution photos or record videos of your inspection.
- **Zoom Function:** The app allows for 1.0X, 1.5X, and 2.0X digital zoom to get a closer look at details.
- **Screen Rotation:** Rotate the screen view by 90 degrees for optimal orientation during inspections.
- **File Management:** Access your captured photos and videos directly from the app's file section. You can view, share, or delete media.

4.4 Practical Applications

The NTC53 endoscope is ideal for various inspection tasks due to its slim probe and flexible cable.

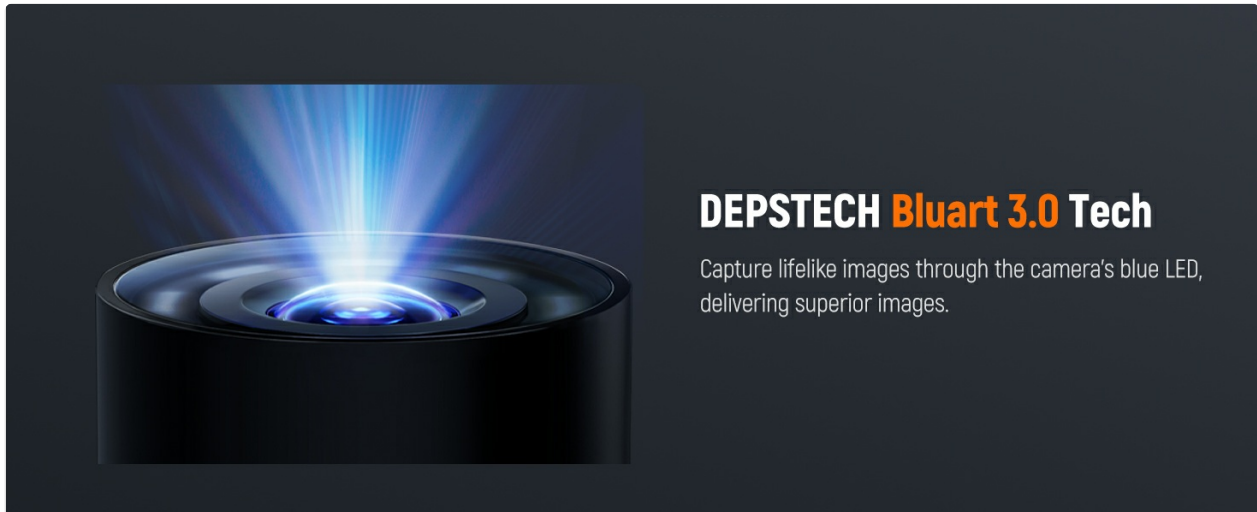

Figure 10: Inspecting an engine bay with the endoscope.

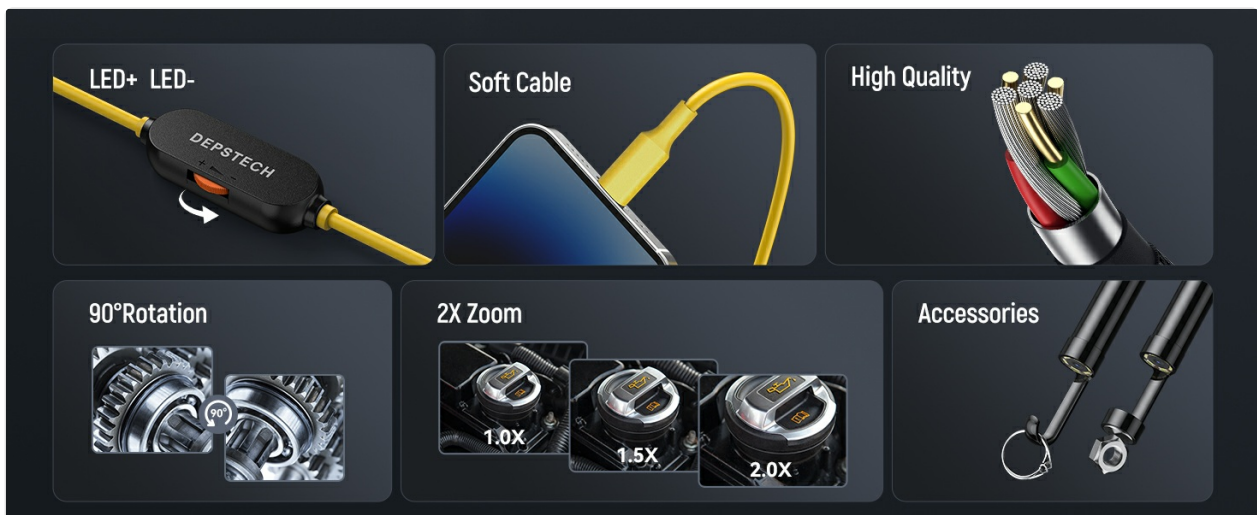

Figure 11: Inspecting a wall cavity with the endoscope.

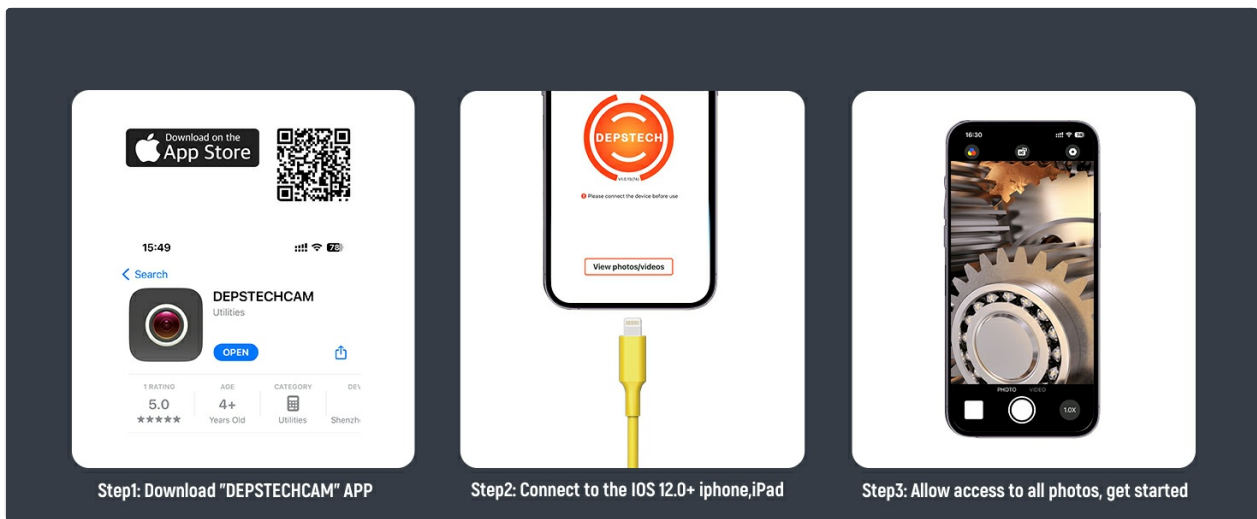

Figure 12: Inspecting a sink drain with the endoscope.

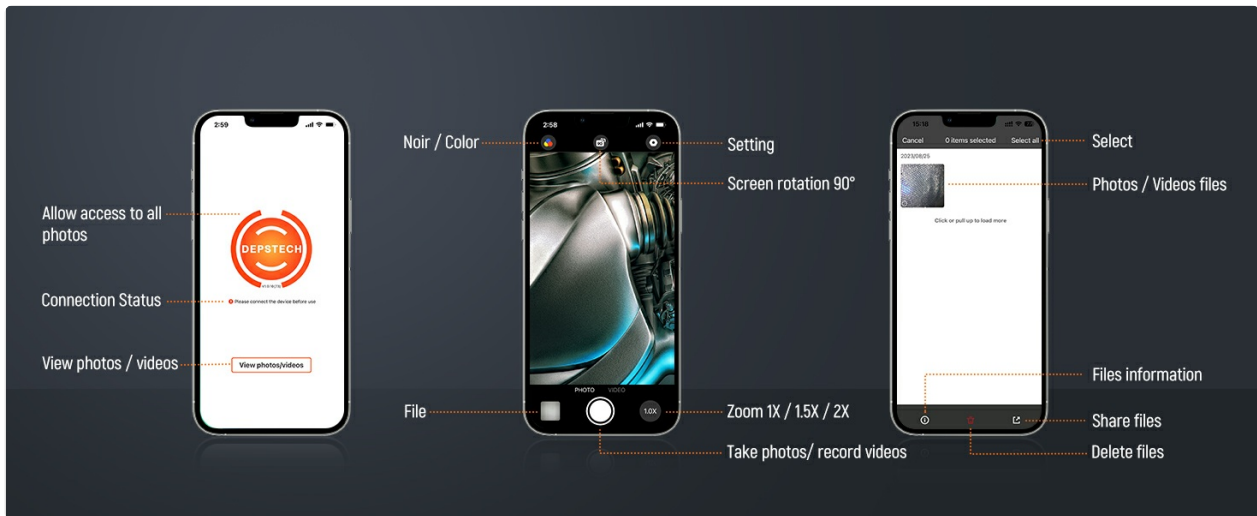

Figure 13: Inspecting a washing machine with the endoscope.

Video 3: Showcases various DIY uses for the NTC53 borescope, demonstrating its versatility in different household and automotive inspection scenarios.

Video 4: A comparative video highlighting the superior image quality of DEPSTECH NTC53 with Bluart 3.0 technology compared to other endoscopes.

5. MAINTENANCE

5.1 Cleaning the Probe

The endoscope probe is IP67 waterproof, allowing it to be used in wet environments. After use, especially in dirty or wet conditions, gently wipe the probe with a soft, damp cloth. For stubborn dirt, a mild soap solution can be used. Ensure the probe is dry before storing.

5.2 Storage

Store the endoscope camera in a cool, dry place away from direct sunlight and extreme temperatures. Coil the cable neatly to prevent kinks or damage. Keep accessories in their designated storage to avoid loss.

6. TROUBLESHOOTING

If you encounter issues with your DEPSTECH NTC53 Endoscope Camera, please refer to the common troubleshooting tips below. For more detailed solutions, consult the full User Manual (PDF) available via the product page or DEPSTECH support.

Common Issues:

- **No Image on Screen:**

- Ensure the endoscope is securely plugged into your iOS device's Lightning port.
- Verify that the "DEPSTECHCAM" app is open and has permission to access your device's camera and photos.
- Check device compatibility (iOS 12.0+ only, not iPhone 15 series or Android).

- **Unable to Save Photos/Videos:**

- Ensure the app has permission to access your device's photo library. Go to iOS Settings > DEPSTECHCAM > Photos > Select "All Photos".
- Check available storage space on your device.

- **Poor Image Quality:**

- Adjust the LED light brightness using the in-line control knob.
- Ensure the camera lens is clean and free from debris.
- Maintain the optimal focal distance (0.79 to 3.93 inches) from the object.

7. SPECIFICATIONS

| Feature | Specification |
|--------------------------|---|
| Model Number | NTC53Y |
| Probe Diameter | 7mm |
| Cable Length | 16.4ft |
| Waterproof Rating | IP67 |
| Compatibility | iOS 12.0+ (iPhone, iPad, except iPhone 15 series) |
| Illumination | 6 Adjustable LED Lights with Bluart 3.0 Tech |
| Field of View (FOV) | 80° |
| Manual Focus Range | 0.79 to 3.93 inches (2-10 cm) |
| Video Capture Resolution | 1080p |
| Item Weight | 8.4 ounces |
| Package Dimensions | 6.73 x 5.91 x 1.54 inches |
| Manufacturer | DEPSTECH |

| Feature | Specification |
|-------------------|---------------|
| Country of Origin | China |

8. WARRANTY AND SUPPORT

For detailed warranty information, product registration, and technical support, please refer to the official DEPSTECH website or the comprehensive User Manual (PDF) provided with your product. You can also contact DEPSTECH customer service directly for assistance with any product-related inquiries or issues.

User Manual (PDF): [Download Here](#)