

Manuals+

[Q & A](#) | [Deep Search](#) | [Upload](#)

[manuals.plus](#) /

› [NICE DIGI](#) /

› [Smart Keypad Door Lock with Handle: NICE DIGI Keyless Entry Digital Lock for Front/Interior Door, Electronic Code Knob, Easy Installation](#)

NICE DIGI Z1A

NICE DIGI Smart Keypad Door Lock

Model: Z1A

PRODUCT OVERVIEW

The NICE DIGI Smart Keypad Door Lock offers a secure and convenient keyless entry solution for your home. Designed for easy installation, it features a backlit keypad, multiple user codes, and smart locking functionalities.



Image: Front view of the NICE DIGI Smart Keypad Door Lock in black, showing the keypad and handle.

KEY FEATURES

- **Keyless Entry:** Supports up to 20 unique passcodes (4-8 digits) for family and friends, plus temporary codes for guests. Physical keys are also included for traditional access.
- **Easy Installation:** Designed for quick 5-minute DIY installation on most American home front wooden doors with just a screwdriver. No extra drilling required. The reversible handle fits both left and right-handed doors.
- **Advanced Keypad:** Features an upgraded backlit keyboard for visibility, a low battery alert, silent mode, and vacation mode. It is water-resistant and requires 4 AA batteries (not included) with up to one year of battery life.
- **Smart Locking Functions:** Customizable auto-lock duration from 5-99 seconds. Includes a one-touch locking

feature by pressing any keypad number for 2 seconds.

- **Enhanced Security:** Incorporates an anti-peeping password function, allowing random digits to be entered before or after the actual code to protect privacy.

SETUP GUIDE

1. Preparing the Door

Ensure your door meets the specified dimensions for installation. The lock fits door thicknesses between 1 $\frac{3}{8}$ " - 2" (35mm-50mm) and bore hole diameters of 2 $\frac{1}{8}$ " (54mm). The latch backset is adjustable between 2 $\frac{3}{8}$ " (60mm) or 2 $\frac{3}{4}$ " (70mm).



Image: Diagram showing door dimensions and latch backset adjustment for proper fit.

2. Installation Steps

1. Install the latch bolt into the door edge. Ensure the latch's square hole is placed horizontally. An inclined position will cause the smart lock to get stuck when unlocked.
2. Install the exterior assembly (keypad side) by feeding the spindle hub and electrical wire through the door's bore hole.
3. Connect the electrical wire from the exterior assembly to the interior assembly.
4. Secure the interior assembly to the exterior assembly using the provided screws.
5. Insert 4 AA alkaline batteries (not included) into the battery compartment.
6. Install the battery cover.

For a visual guide on installation, refer to the "Easy install" video by NICE-DIGI.

Your browser does not support the video tag.

Video: A step-by-step guide demonstrating the physical installation of the smart lock on a door.

3. Initial Programming (Master Code)

The default master code is 12345678. It is required that you change it to a code of your own before programming any other settings.

1. Press the "NICE DIGI" button twice.
2. Enter the current master code (12345678).
3. Press the "NICE DIGI" button. The green light will turn on and you will hear a beep.
4. Press '1'. The green light will flash and you will hear a beep.
5. Enter your new master code (4-8 digits).
6. Press the "NICE DIGI" button. The green light will flash and you will hear a beep.
7. Re-enter your new master code.
8. Press the "NICE DIGI" button. A successful green light flash and beep indicates the master code has been changed.

Your browser does not support the video tag.

Video: Demonstrates the programming steps for setting up the smart lock, including changing the master code.

OPERATING INSTRUCTIONS

Adding User Codes

1. Press the "NICE DIGI" button twice.
2. Enter your master code.
3. Press the "NICE DIGI" button. The green light will turn on and you will hear a beep.
4. Press '2'. The green light will flash and you will hear a beep.
5. Enter the new user code (4-8 digits).
6. Press the "NICE DIGI" button. The green light will flash and you will hear a beep.
7. Re-enter the new user code.
8. Press the "NICE DIGI" button. A successful green light flash and beep indicates the user code has been added.

Deleting User Codes

1. Press the "NICE DIGI" button twice.
2. Enter your master code.
3. Press the "NICE DIGI" button. The green light will turn on and you will hear a beep.
4. Press '3'. The green light will flash and you will hear a beep.
5. Enter the unwanted user code.
6. Press the "NICE DIGI" button. A successful green light flash and beep indicates the user code has been deleted.

Silent Mode

To enable or disable keypad beeping sounds:

1. Press the "NICE DIGI" button twice.
2. Enter your master code.
3. Press the "NICE DIGI" button. The green light will turn on and you will hear a beep.
4. Press '6'. The green light will flash and you will hear a beep.
5. To disable silent mode (enable sound), press '1'. To enable silent mode (disable sound), press '2'.
6. Press the "NICE DIGI" button. A successful green light flash and beep confirms the setting.

Auto Lock Function



Image: Illustration of the silent mode feature, showing a sleeping person next to the lock with a mute icon.

Auto-Lock Function

To enable or disable the automatic locking feature:

1. Press the "NICE DIGI" button twice.
2. Enter your master code.
3. Press the "NICE DIGI" button. The green light will turn on and you will hear a beep.
4. Press '7'. The green light will flash and you will hear a beep.
5. To enable auto-lock, press '1'. To disable auto-lock, press '2'.
6. Press the "NICE DIGI" button. A successful green light flash and beep confirms the setting.

Long Battery Life & Durability



Backlit Keypad



Low Battery Alarm



1 Year Battery Life
(Not Included)



Image: A person entering their home with boxes, illustrating the auto-lock feature engaging the deadbolt automatically.

Setting Auto-Lock Time Delay

To adjust the duration before auto-lock engages (5-99 seconds):

1. Press the "NICE DIGI" button twice.
2. Enter your master code.
3. Press the "NICE DIGI" button. The green light will turn on and you will hear a beep.
4. Press '0'. The green light will flash and you will hear a beep.
5. Enter the desired duration time (e.g., 05 for 5 seconds, 99 for 99 seconds).
6. Press the "NICE DIGI" button. A successful green light flash and beep confirms the setting.

Adding One-Time Codes

For temporary access, a one-time code can be created that expires after a single use.

1. Press the "NICE DIGI" button twice.
2. Enter your master code.

3. Press the "NICE DIGI" button. The green light will turn on and you will hear a beep.
4. Press '9'. The green light will flash and you will hear a beep.
5. Enter the new one-time user code (4-8 digits).
6. Press the "NICE DIGI" button. The green light will flash and you will hear a beep.
7. Re-enter the new one-time user code.
8. Press the "NICE DIGI" button. A successful green light flash and beep indicates the one-time code has been added.

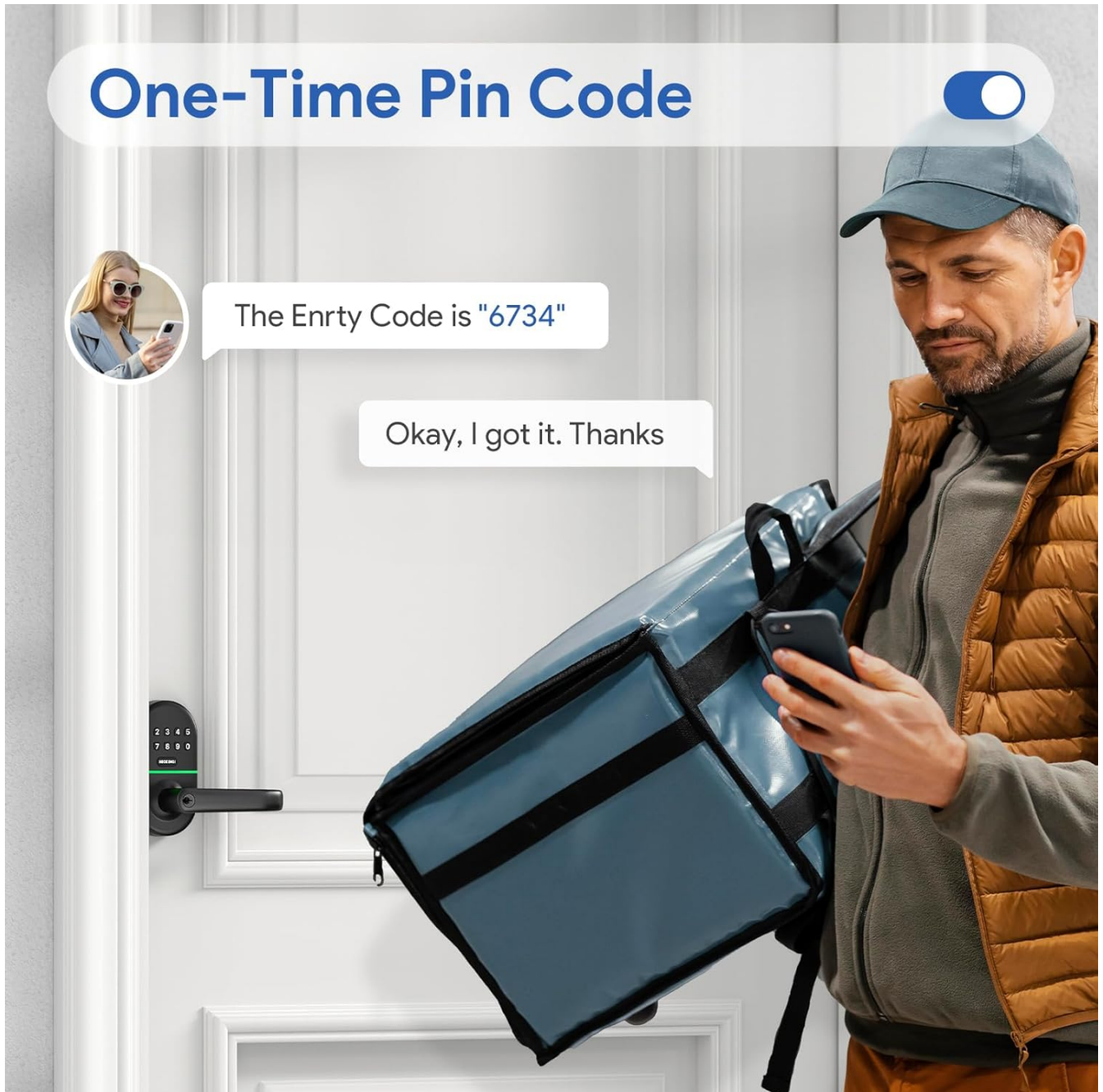

Image: A delivery person checking their phone for a one-time pin code to access the door.

Vacation Mode

To enable vacation mode, which restricts access to only the master code:

1. Press the "NICE DIGI" button twice.
2. Enter your master code.
3. Press the "NICE DIGI" button. The green light will turn on and you will hear a beep.

4. Press '8'. The green light will flash and you will hear a beep.
5. Press the "NICE DIGI" button. Vacation mode is enabled.

When vacation mode is on, only the master code can be used to unlock the door. This mode will be automatically disabled after unlocking.



Image: A family preparing for vacation with luggage, indicating the use of vacation mode for security.

MAINTENANCE

Battery Replacement

The keypad door lock requires 4 AA batteries (not included). The lock features a low battery alert to notify you when replacement is needed. Battery life is approximately one year.

Fits Most Standard Doors



Left Open



Right Open

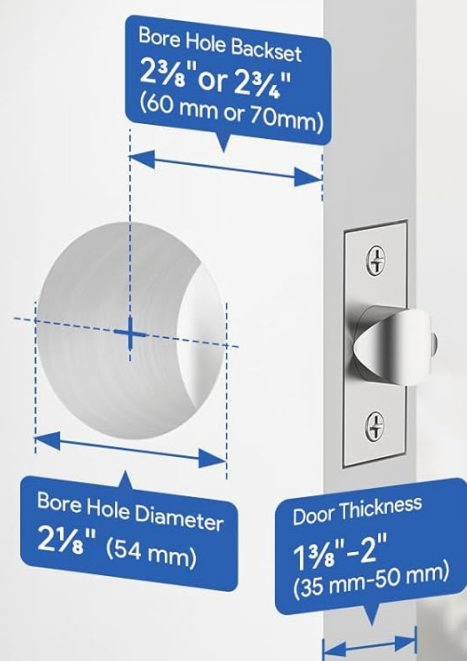

Lock Size



Compatibility

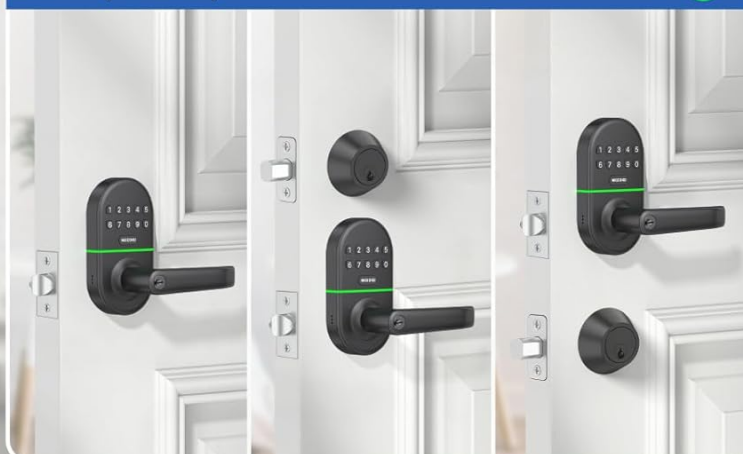

Image: Visual representation of the lock's 1-year battery life and low battery alarm indicator.

Emergency Power

In case of complete battery depletion, the lock is equipped with a Type-C port for emergency backup power, allowing you to temporarily power the lock and enter your code.



Image: Close-up of the lock showing the Type-C port for emergency backup power.

TROUBLESHOOTING

Lock Handle Not Functioning Correctly

If the handle only unlocks in one direction (e.g., upward but not downward), ensure the latch's square hole is placed horizontally during installation. An inclined position can cause the smart lock to get stuck when unlocked.

Indicator Light Flashes Red

If setting is unsuccessful, the indicator light will flash red. Re-check your steps and ensure the master code is correctly entered.

SPECIFICATIONS

Feature	Detail
Brand	NICE DIGI
Model Name	Z1A
Lock Type	Keypad

Material	Aluminum
Color	Black
Item Dimensions (L x W x H)	5.39 x 2.79 x 2.7 inches
Item Weight	2.68 pounds
Power Source	4 AA batteries (Not Included)
Special Features	Easy Installation, One-Touch Lock, Back-Lit Keypad, Passcode Unlock, Anti-Peeping Password





WARRANTY & SUPPORT

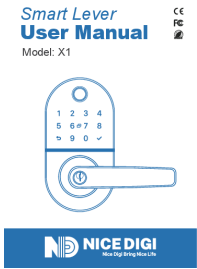

NICE DIGI smart locks come with a 30-day money-back guarantee, 1-year product coverage, and lifetime after-sales support. For any inquiries or assistance, please contact NICE DIGI customer service.

You can also refer to the official User Manual (PDF) available online for more detailed information [User Manual \(PDF\)](#)

© 2025 NICE DIGI. All rights reserved.

Related Documents - Z1A

	Nice Digi Smart Lever X1 User Manual Comprehensive user manual for the Nice Digi Smart Lever X1, covering installation, setup, app usage, features, and troubleshooting for this keyless entry smart lock.
	NICE DIGI Smart Knob Y1 User Manual and Installation Guide Comprehensive user manual and installation guide for the NICE DIGI Smart Knob Y1, covering setup, app pairing, and usage instructions for smart home security.
	NICE DIGI Smart Lever Z1A User Manual and Installation Guide This user manual provides comprehensive installation and programming instructions for the NICE DIGI Smart Lever Model Z1A. Learn how to install, set up, and operate your smart lock for enhanced home security.
	NICE DIGI Smart Lever X1 User Manual and Installation Guide Comprehensive user manual and installation guide for the NICE DIGI Smart Lever X1, covering setup, product features, app integration, and troubleshooting. Learn how to install and operate your smart lock.

	<p>NICE DIGI Smart Gateway User Manual and Setup Guide</p> <p>Comprehensive user manual for the NICE DIGI Smart Gateway, detailing product features, installation, connection to the NICE DIGI app, and integration with Alexa for smart home control.</p>
	<p>Kucacci Smart Lock Troubleshooting Guide and FAQs</p> <p>Comprehensive troubleshooting guide and frequently asked questions (FAQs) for the Kucacci Smart Lock, covering setup, connectivity, power, and operational issues. Learn how to resolve common problems with your smart door lock.</p>